

**M101 NOTES**

- COMMON CONDENSATE DRAIN LINE WITH 1% SLOPE ROUTED ABOVE CEILING. TERMINATE AT JANITOR'S SERVICE SINK. INSULATE PER SPECIFICATION SECTION 230719.
- CONDENSATE DRAIN LINE WITH 1% SLOPE ROUTED ABOVE CEILING. TERMINATE OUTSIDE AT GRAVEL FILLED DRY WELL. SEAL PENETRATION THROUGH EXTERIOR WALL WATER TIGHT. INSULATE PER SPECIFICATION SECTION 230719.
- INSTALL MAHU ON WALL AS HIGH AS POSSIBLE BUT BELOW CEILING. INSTALL CONDENSATE LINE PUMP (TYPE: HARVEY MINI OR APPROVED EQUIVALENT) AND ROUTE CONDENSATE DRAIN LINE UP THROUGH CEILING AND TIE INTO COMMON CONDENSATE DRAIN LINE IN CORRIDOR. CONCEAL EXPOSED PUMP, PIPING AND CONDUIT.
- 16"x16" EXHAUST AIR DUCT UP TO ERU-1. TRANSITION TO UNIT CONNECTION SIZE - RE: 1/M102 FOR CONTINUATION.
- 16"x14" SUPPLY AIR DUCT UP TO ERU-1. TRANSITION TO UNIT CONNECTION SIZE - RE: 1/M102 FOR CONTINUATION.
- 20"x20" RETURN AIR DUCT UP TO RTU-1. TRANSITION TO UNIT CONNECTION SIZE - RE: 1/M102 FOR CONTINUATION.
- 18"x16" SUPPLY AIR DUCT UP TO RTU-1. TRANSITION TO UNIT CONNECTION SIZE - RE: 1/M102 FOR CONTINUATION.
- 14"x14" SUPPLY AIR DUCT UP TO RTU-1. TRANSITION TO UNIT CONNECTION SIZE - RE: 1/M102 FOR CONTINUATION.
- 20"x20" RETURN AIR DUCT UP TO RTU-2. TRANSITION TO UNIT CONNECTION SIZE - RE: 1/M102 FOR CONTINUATION.
- 18"x16" SUPPLY AIR DUCT UP TO RTU-2. TRANSITION TO UNIT CONNECTION SIZE - RE: 1/M102 FOR CONTINUATION.
- INSTALL MANUAL VOLUME DAMPER IN DUCT - TO BE ACCESSIBLE IN ELECTRICAL ROOM 829.
- ROUTE MINI-SPLIT CONDENSATE DRAIN LINE FROM SIZE OF UNIT CONNECTION TO COMMON DRAIN. MINIMUM CONDENSATE DRAIN LINE SIZE IS 3/4".
- MOUNT WALL ELECTRICAL WATER AT 6'-0" A.F.F.

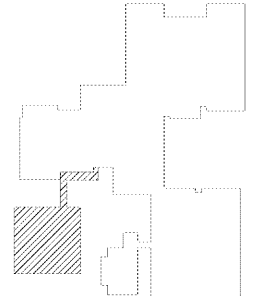

KEYPLAN

1 CLASSROOM ADDITION - FLOOR PLAN  
1/8" = 1'-0"

SA&E PROJECT NUMBER	01-782-115
BID PACKAGE	SINGLE
ISSUED FOR CONSTRUCTION	03/04/2019
<b>Southern A&amp;E</b> 7951 Troon Circle Austell, Ga 30168 (770) 812-7777 architects & engineers	REVISIONS
	R# Doc# Date
<small>© COPYRIGHT 2019 BY SOUTHERN A&amp;E, LLC. ALL RIGHTS RESERVED.          THIS DOCUMENT IS THE PROPERTY OF SOUTHERN A&amp;E, LLC AND SHALL NOT BE COPIED OR          REPRODUCED IN WHOLE OR IN PART WITHOUT EXPRESS WRITTEN PERMISSION FROM SOUTHERN          A&amp;E, LLC.</small>	
FACILITY CODE NUMBER: 3550 RENOVATIONS, MODIFICATIONS & ADDITIONS TO: <b>CHAPEL HILL MIDDLE SCHOOL</b> 3989 CHAPEL HILL ROAD, DOUGLASVILLE, GA 30135 DOUGLAS COUNTY SCHOOLS 9030 HIGHWAY 5, DOUGLASVILLE GA 30134	
	DRAWING NUMBER
	M101