

Drawing name: L237002 - Mullate Properties, LLC - Bojangles' - Stockbridge, GA\ACAD\CONSTR\237002_07_GRADING.dwg Date: 22/07/2018 2:56pm by: henn.evans

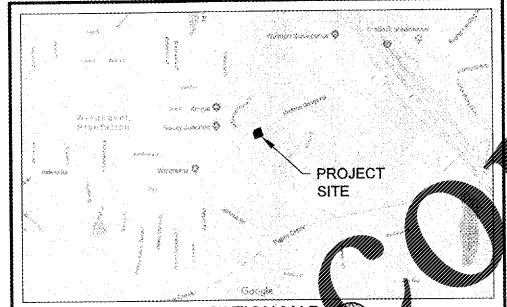
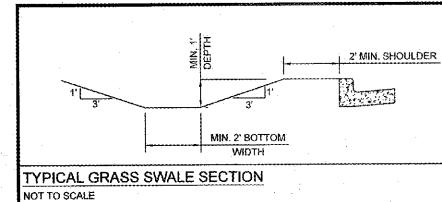
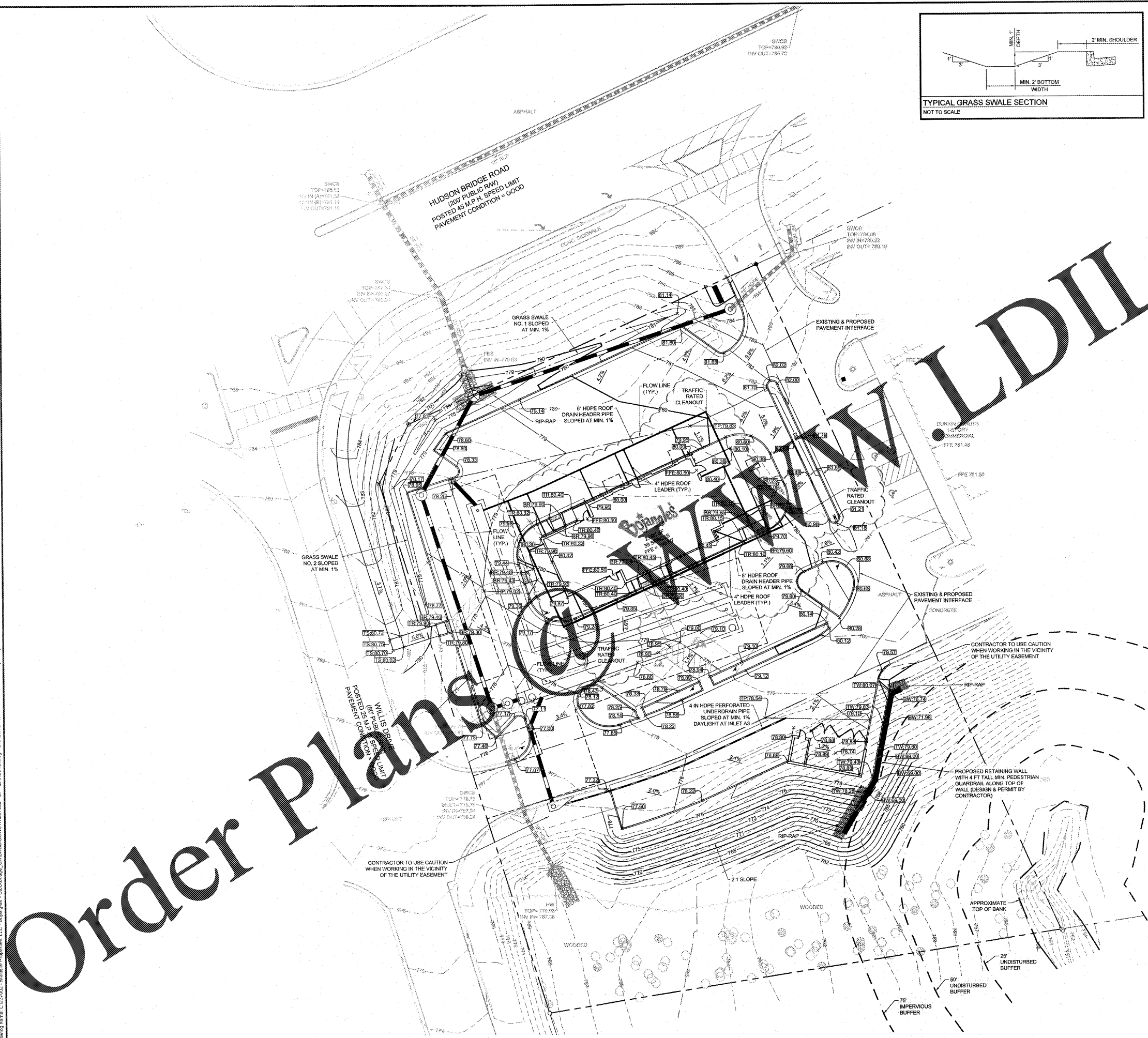

- GENERAL GRADING NOTES:**
- 1) ALL CRITICAL SPOT GRADING ALONG THE BOTTOM OF CURB ELEVATIONS UNLESS OTHERWISE NOTED.
 - 2) SLOPES SHOULD BE STEEPER THAN 2:1.
 - 3) ALL LAND DISTURBANCE TO BE STABILIZED WITH VEGETATION UPON COMPLETION OF DEMOLITION.
 - 4) ALL TREES TO HAVE PROPER PROTECTION UNLESS APPROVED PLANS INDICATE OTHERWISE.
 - 5) TOPOGRAPHIC INFORMATION FROM SURVEY BY LeCraw Engineering, Inc., RECEIVED ON 08/24/2018.
 - 6) FLOOD PLAIN IS NOT PRESENT ON THIS SITE AS SHOWN ON THE FEMA FIRM MAP NUMBER 13151C0088D, OCTOBER 9, 2016.
 - 7) EROSION AND SEDIMENT CONTROL MEASURES ARE TO BE ACCOMPLISHED PRIOR TO ANY OTHER CONSTRUCTION ON THE SITE AND MAINTAINED UNTIL PERMANENT GROUND COVER IS ESTABLISHED.
 - 8) OWNER IS RESPONSIBLE FOR MAINTENANCE OF ALL STORM SEWER ON PRIVATE PROPERTY.
 - 9) THE OWNER IS RESPONSIBLE FOR OBTAINING ANY NECESSARY AGREEMENTS FROM ADJACENT PROPERTY OWNERS IN ORDER TO PERFORM THE REQUIRED OFFSITE WORK, INCLUDING, STORM DRAINAGE, CURB AND GUTTER AND PAVEMENT TIES AND GRADING.
 - 10) VERTICAL DEPTH OF ALL DRY AND PRESSURIZED UTILITIES IS UNKNOWN. CONTRACTOR TO NOTIFY OWNER AND ENGINEER IMMEDIATELY IF ANY CONFLICTS ARE FOUND.
 - 11) SIDEWALKS ADJACENT TO BUILDING AND ALONG ADA ROUTES TO HAVE MAXIMUM CROSS SLOPE OF 2%.

- HENRY COUNTY- STORMWATER NOTES:**
1. OWNER IS RESPONSIBLE FOR MAINTENANCE OF THE STORMWATER MANAGEMENT SYSTEM POST-CONSTRUCTION.
 2. PRIOR TO ISSUANCE OF CERTIFICATE OF OCCUPANCY, AN AS-BUILT OF THE SWMM SHOWING DESIGN DATA AND ROUTING JUXTAPOSITIONED TO AS-BUILT DATA MUST BE SUBMITTED AND APPROVED BY STORMWATER.

AS-BUILT NOTE:
CONTRACTOR SHALL PROVIDE THE NECESSARY SIGNED/SEALED AS-BUILT SURVEY(S) TO ENGINEER AS REQUIRED FOR FINAL APPROVAL BY THE LOCAL JURISDICTION AT LEAST 30 DAYS PRIOR TO PROJECT COMPLETION. AS-BUILT SURVEY(S) SHALL INCLUDE ALL RIM ELEVATIONS, INVERTS, PIPE SIZES & MATERIALS, AND PIPE SLOPES FOR ALL STORM AND SANITARY SEWERS. IN JURISDICTIONS WHERE AN AS-BUILT HYDROLOGY ANALYSIS OR STORMWATER "CERTIFICATION" IS REQUIRED BY THE ENGINEER OF RECORD, THE CONTRACTOR SHALL ALSO SUPPLY ALL NECESSARY DOCUMENTATION REQUIRED FOR THE ENGINEER TO DETERMINE UNDERGROUND POND(S), IF APPLICABLE, PROVIDE THE ADEQUATE STORAGE VOLUMES. SUCH DOCUMENTATION MAY INCLUDE, BUT SHALL NOT BE LIMITED TO, PHOTOGRAPHS OF SYSTEM INSTALLATION, COMPACTION REPORTS UNDER AND ABOVE THE SYSTEM, DELIVERY TICKETS, SHOP DRAWINGS, ELEVATIONS OF STONE BEDDING (TOP AND BOTTOM), AS WELL AS THE HORIZONTAL LIMITS OF STONE.

- SPOT ELEVATION LEGEND:**
- FFE: FINISHED FLOOR ELEVATION
 - HP: HIGH POINT
 - TR: TOP OF RAMP
 - BR: BOTTOM OF RAMP
 - TP: TOP OF PAVEMENT
 - TS: TOP OF SIDEWALK
 - TW: FINISHED GRADE ELEVATION AT TOP OF WALL
 - BW: FINISHED GRADE ELEVATION AT BOTTOM OF WALL

NOTE: SPOT ELEVATIONS ALONG WALL REPRESENT THE FINISHED GRADE ELEVATION ALONG THE FACE OF THE WALL, NOT THE ACTUAL BOTTOM AND TOP OF WALL ELEVATIONS OF THE WALL, AND ARE PROVIDED FOR INFORMATIONAL PURPOSES ONLY. THE CONTRACTOR SHOULD REFER TO THE WALL DESIGN PLANS BY OTHERS, FOR ACTUAL TOP AND BOTTOM WALL ELEVATIONS DURING CONSTRUCTION.

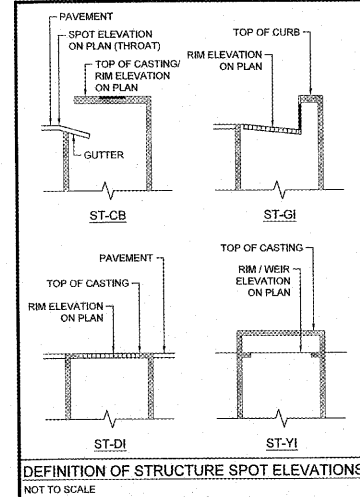

LeCraw Engineering, Inc.
2018 LeCraw Engineering, Inc.
3000 Peachtree Dunwoody Road, Suite A
Duluth, GA 30096
Phone: 770.546.8100
www.lecrawengineering.com
PEF050768

NO.	DATE	BY	CHECKED
1	07/30/2018	TKS	FDE
2	07/30/2018	TKS	FDE

PROJECT:
BOJANGLES' - STOCKBRIDGE
HUDSON BRIDGE ROAD & WILLIS DRIVE
LAND LOT 21, DISTRICT 6, PARCEL 032-01012001
HENRY COUNTY, GA

SEAL:

DESIGN TEAM:
DRAWN BY: FDE
DESIGNED BY: FDE
REVIEWED BY: TKS

GEORGIA811
www.Georgia811.com
Know what's below. Call before you dig.

SCALE & NORTH ARROW:

SCALE: 1"=20'

JOB #: 237002
DATE: JULY 30, 2018
GRADING PLAN
C-4.0