

MY SALON
Salon

ISSUE INFORMATION	
1.10.2019	
REVISIONS	

PROJECT INFORMATION	
Marketplace Center	
MSS #5158	
1948 Old Fort Hwy Murfreesboro, TN 37129	
PROJECT #:	20884

SHEET INFORMATION	
SPECIAL SYSTEMS PLAN	
DRAWN BY:	DMT
REVIEWED BY:	LGf
SCALE:	As Noted
AUTHORIZED FOR:	Bid/Permit/LL

E-4.0	
--------------	--

TECHNOLOGY LEGEND	
SYMBOL	DESCRIPTION
TECHNOLOGY (ROUGH-IN ONLY)	
COORDINATE WITH SYSTEM INSTALLERS PRIOR TO INSTALLATION FOR LOCATIONS, HEIGHTS, CONDUIT TERMINATIONS, ETC. ALL OUTLET BOXES FOR ROUGH-IN SHALL BE MINIMUM 2-1/4" DEEP.	
	COMMUNICATION OUTLET - VOICE, DATA, VOICE/DATA RESPECTIVELY LEFT TO RIGHT - PROVIDE 4"x4" OUTLET BOX WITH 1-GANG RING AND (1) 1" CONDUIT TO ABOVE ACCESSIBLE CEILING UNLESS NOTED OTHERWISE.
	DOOR CONTACT, PROVIDE 3/4" CONDUIT WITH PULLSTRING TO ACCESSIBLE CEILING SPACE
	CARD READER, PROVIDE 3/4" CONDUIT WITH PULLSTRING TO ACCESSIBLE CEILING SPACE
	SECURITY KEYPAD, PROVIDE 3/4" CONDUIT WITH PULLSTRING TO ACCESSIBLE CEILING SPACE
	INTERCOM AND SPEAKER, PROVIDE 3/4" CONDUIT WITH PULLSTRING TO ACCESSIBLE CEILING SPACE
	DOOR ACCESS PUSH BUTTON, PROVIDE 3/4" CONDUIT WITH PULLSTRING TO ACCESSIBLE CEILING SPACE

GENERAL SYSTEMS PLAN NOTES

- INSTALLATION SHALL CONFORM TO ALL APPLICABLE NATIONAL, STATE AND LOCAL CODES.
- CONDUIT LAYOUTS SHOWN ON THE PLANS ARE DIAGRAMMATIC AND DO NOT INDICATE THE ROUTING REQUIRED. CONTRACTOR SHALL ROUTE CONDUITS AS REQUIRED BY THE CONDITIONS OF THE PROJECT.
- DEVICE LOCATIONS SHOWN ON THE PLANS ARE APPROXIMATE. REFER TO ARCHITECTURAL PLANS FOR EXACT DEVICE LOCATIONS.
- ALL CONDUITS SHALL CONTAIN A CODE SIZE EQUIPMENT GROUND CONDUCTOR.
- ALL CONDUCTORS SHALL BE COPPER THHN OR XHHW-2 RATED FOR 90 DEGREES CELSIUS.
- UNLESS SPECIFICALLY NOTED OTHERWISE, CONTRACTOR SHALL PROVIDE FINAL CONNECTIONS TO ALL UTILIZATION EQUIPMENT SHOWN ON PLANS. VERIFY FINAL CONNECTION AND PROVIDE APPROPRIATE WIRING METHOD. REFER TO SHEET E-4.0 FOR TYPICAL DEVICE MOUNTING LOCATION DETAIL FOR DEVICES IN SUITES.
-

KEYED NOTES

S01 PROVIDE A 48" X 96" X 3/4" FIRE-RETARDANT PLYWOOD BACKBOARD (TMB) FOR TELECOMMUNICATIONS EQUIPMENT. PROVIDE GROUND BAR MOUNTED ON BACKBOARD WITH #6 BARE COPPER EQUIPMENT GROUNDING CONDUCTOR CONNECTED TO POWER SYSTEM'S GROUNDING ELECTRIFIED SYSTEM.

S02 CONTRACTOR SHALL PROVIDE 1" EMPTY CONDUIT WITH PULL STRING FOR THE DATA SYSTEM FROM TELEPHONE UTILITY COMPANY MAIN POINT OF CONNECTION TO BACKBOARD (TMB). VERIFY EXACT POINT OF CONNECTION LOCATION AT SITE.

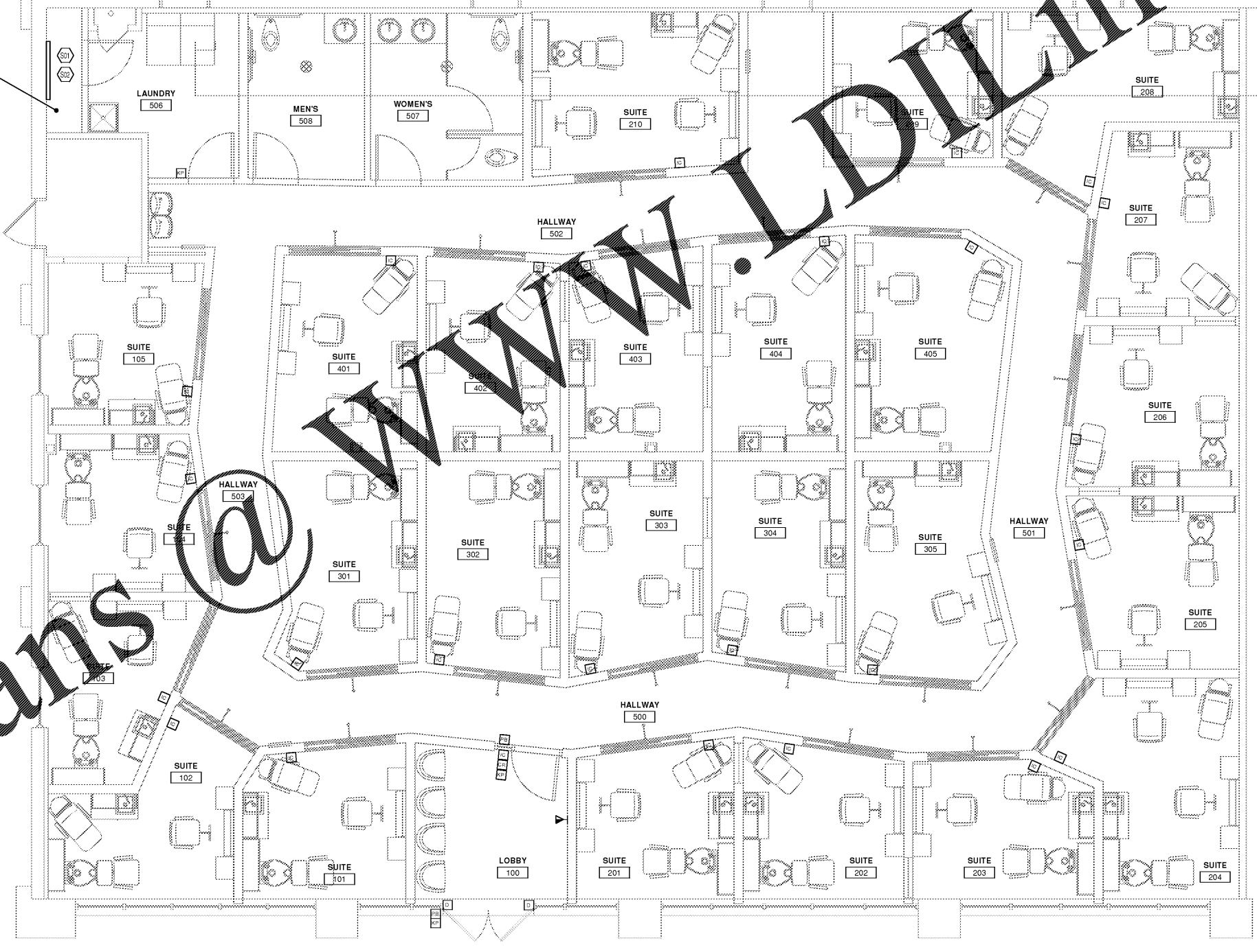

① SPECIAL SYSTEMS PLAN
 1/4" = 1'-0"

Order Plans @ www.LDOnline.com