

USER: RPH\GERS PLOTTED: 16/01/19 6:38 PM P:\0500002666\000565ch\0500002666\0500002666\A-121\FinishPlan.dwg LAYOUT: A-121

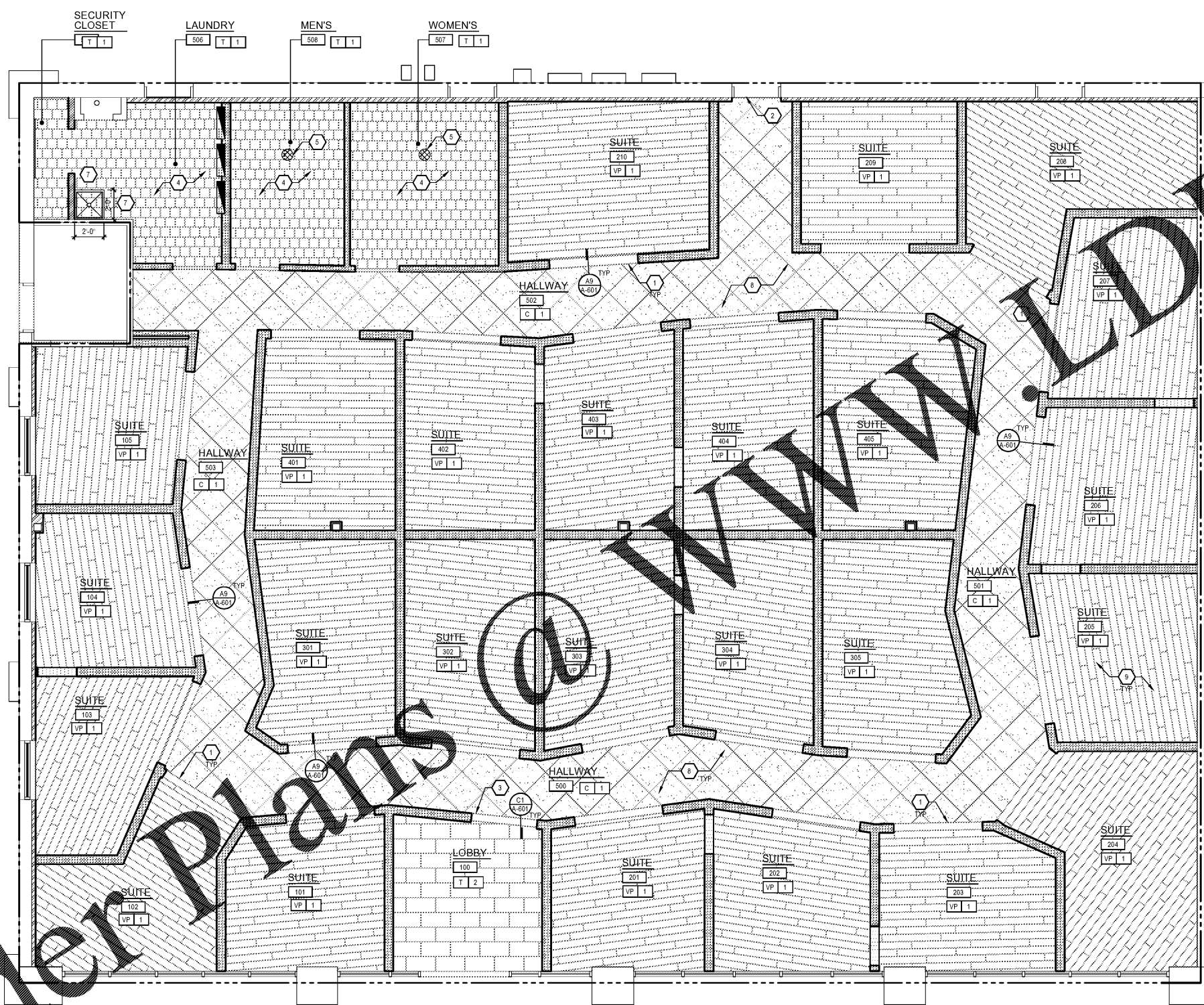

- GENERAL NOTES**
1. [XX] [XX] INDICATES TYPICAL FINISHES WITHIN ROOM U.O.N.
  2. ALL FLOOR COVERING MATERIALS TO BE INSTALLED PER MANUFACTURER'S STANDARD DETAILS AND SPECIFICATIONS. VERIFY W/ MANUFACTURER PRIOR TO INSTALLATION.
  3. ALL MATERIAL TRANSITIONS AT DOOR THRESHOLDS TO TAKE PLACE AT DOOR CENTERLINE U.O.N.
  4. ALL DIMENSIONS ARE TO CENTERLINE OF TRANSITION BETWEEN FLOORING MATERIALS OR FINISH COLOR OF SAME MATERIAL. PLANS DO NOT SHOW ALL TILES OF SAME MATERIALS.
  5. DOORS MUST REMAIN OPEN DURING ALL HOURS OF HALL OPERATIONS.
  6. ALL FINISHES SHALL COMPLY W/ CLASS 'C' FLAME SPREAD REQUIREMENTS PER IFC SECTION 803, TABLE 803.5
  7. GC TO PROVIDE PROTECTION FOR ALL FLOORING AFTER INSTALLATION TO PREVENT ANY DAMAGE.
  8. GC TO PROVIDE A LEVEL FLOOR OR LANDING ON EACH SIDE OF A DOOR NOT MORE THAN 1/2" LOWER THAN THE THRESHOLD OF THE DOORWAY.
  9. CONCRETE POURBACK MUST MATCH LANDLORD'S SPECS OR MATCH EXISTING FIELD, WHICHEVER IS MORE STRINGENT. NOTIFY LANDLORD OF ANY DEVIATIVE MINIMUM 48 HOURS PRIOR TO POURING. REFER TO D4-A-502 FOR TYPICAL SAWCUT POURBACK DETAIL.
  10. ALL CARPET TILES SHALL BE INSTALLED WITH A 1/4" TURN LIFT.
  11. ALL FLOOR AND WALL TRANSITIONS ARE TO BE SEALED PER APPLICABLE CODES. SHEET VINYL AND CARPET TRANSITIONS PER MANUFACTURER'S GUIDELINES PRIOR TO INSTALL.

- K&L NOTES**
1. SLIDING DOOR TRACKS TO FINISH TO TERMINATE TIGHT TO METAL DOOR TRACK, TYPICAL.
  2. METAL THRESHOLD RECEIVED W/ DOOR FRAME. GC TO VERIFY UPON RECEIPT.
  3. CARPET TO BE INSTALLED OVER TRANSITION SCHLUTER STRIP. SEE DETAIL ON SHEET A-601.
  4. WATERPROOFING: 30 MIL POLYETHYLENE CLEAVAGE MEMBRANE (EQUAL TO NOBELSEAL) TO BE INSTALLED PER MFG'S RECOMMENDATIONS AND ANSI A106. EXTEND WATERPROOFING UP WALLS 6" BEHIND WALL BASE (BEHIND FRP WALL FINISH) & MINIMUM 8" UNDER FLOORING.
  5. NEW FLOOR DRAIN. SEE PLUMBING DRAWINGS FOR MORE INFO.
  6. STRIPE FLOOR AROUND ELECTRICAL EQUIPMENT. PROVIDE SIGN STATING NO STORAGE - # MARKED AREAS.
  7. EXTENTS OF FRP WALL FINISH. FRP TO EXTEND FROM TOP OF MOP SINK TO 48" A.F.F.
  8. CARPET AT 45 DEGREE ANGLE FROM FRONT DOOR. GC TO ENSURE NO STRAIGHT SEAMS RUN THROUGH CENTER OF HALL.
  9. VINYL PLANK TO RUN PARALLEL TO DOOR, TYP.

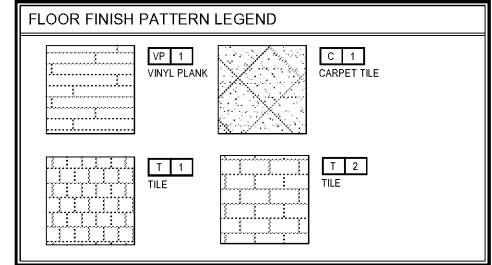

**FRCH**  
DESIGN WORLDWIDE

384 Elm Street Suite 600  
Cincinnati OH 45202  
513.263.9000  
www.frch.com

**MY SALON** Suite®

**ISSUE INFORMATION**

**REVISIONS**

FRCH Nelco Architecture, Inc.

**PROJECT INFORMATION**

Marketplace Center  
MSS #5158

1948 Old Fort Pkwy  
Murfreesboro, TN 37129

PROJECT #:  
035986.000

**SHEET INFORMATION**

Finish Plan

DRAWN BY:  
KRP

REVIEWED BY:  
SA / RR

SCALE:  
As Noted

AUTHORIZED FOR:  
Bid/Permit/LL

**A-121**



Order Plans

Finish Plan  
A-121 SCALE: 1/4" = 1'-0"