

POPEYES
1009 BARATARIA BLVD.
MARRERO, LOUISIANA
LOUISIANA KITCHEN LK-PLUS DESIGN STANDARDS
60 SEATS / DUAL-LINE PRODUCTION



POPEYES

REVISIONS:

EGRESS PLAN
DATE: 12/19/18

A2.1

CHECKED: JS

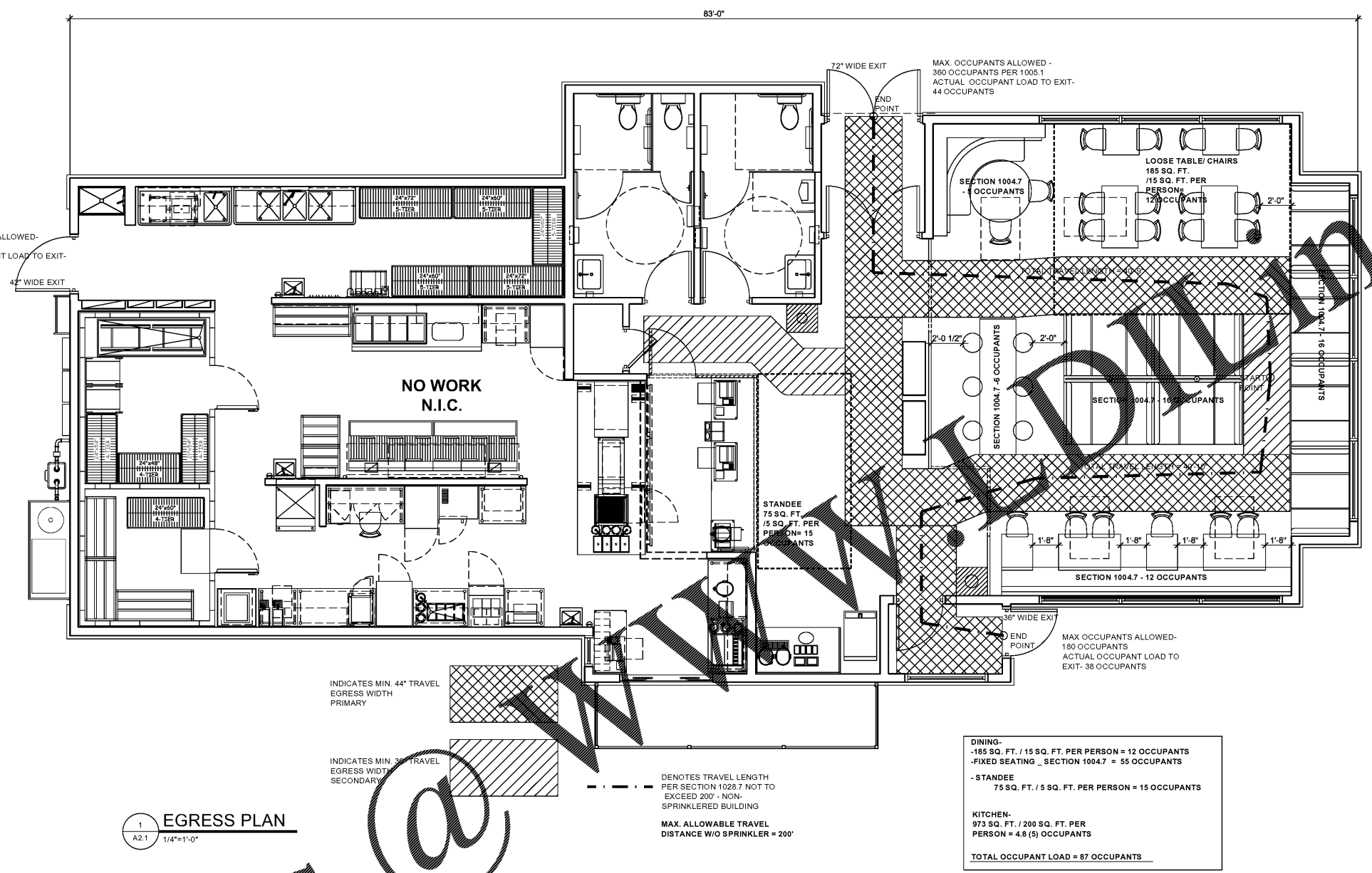

MAX OCCUPANTS ALLOWED-
210 OCCUPANTS
ACTUAL OCCUPANT LOAD TO EXIT-
5 OCCUPANTS

MAX. OCCUPANTS ALLOWED -
360 OCCUPANTS PER 1005.1
ACTUAL OCCUPANT LOAD TO EXIT-
44 OCCUPANTS

MAX OCCUPANTS ALLOWED-
180 OCCUPANTS
ACTUAL OCCUPANT LOAD TO
EXIT- 38 OCCUPANTS

INDICATES MIN. 44" TRAVEL
EGRESS WIDTH
PRIMARY

INDICATES MIN. 36" TRAVEL
EGRESS WIDTH
SECONDARY

DENOTES TRAVEL LENGTH
PER SECTION 1028.7 NOT TO
EXCEED 200' - NON-
SPRINKLERED BUILDING
MAX. ALLOWABLE TRAVEL
DISTANCE W/O SPRINKLER = 200'

DINING-
-185 SQ. FT. / 15 SQ. FT. PER PERSON = 12 OCCUPANTS
-FIXED SEATING_SECTION 1004.7 = 55 OCCUPANTS
-STANDEE
75 SQ. FT. / 5 SQ. FT. PER PERSON = 15 OCCUPANTS
KITCHEN-
973 SQ. FT. / 200 SQ. FT. PER
PERSON = 4.8 (5) OCCUPANTS
TOTAL OCCUPANT LOAD = 87 OCCUPANTS

1 EGRESS PLAN
A2.1 1/4"=1'-0"

Order Plans @