

Architrave GROUP PC
127 Road Street, Suite 1007
Metairie, LA 70002
Phone: (713) 212-4007 Fax: (713) 212-4005
JOSE C. SANTOS, P.E. - IN ALIBRIS
PA 14892929 LA 141000
LA 001

POPEYES (EXTERIOR - PHASE II)
1009 BARATARIA BLVD.
MARRERO, LOUISIANA
LOUISIANA KITCHEN LK-PLUS DESIGN STANDARDS
60 SEATS / DUAL-LINE PRODUCTION

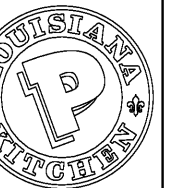

POPEYES

REVISIONS:

FLOOR PLAN

DATE: 1/15/19

A1

CHECKED: JS

SPECIFICATIONS

DIVISION 9: FINISHES

SECTION 9A: GYPSUM WALLBOARD

GENERAL PROVISIONS

1. SCOPE: FURNISH AND INSTALL GYPSUM WALLBOARD AS A SUBSTRATE FOR OTHER FINISH MATERIALS ON ALL INTERIOR WALLS AND THE INTERIOR PORTIONS OF EXTERIOR WALLS. FURNISH AND INSTALL GYPSUM BOARD SUSPENDED CEILING WITH HANGERS AND SUPPORTS.

1. MATERIALS

1. MATERIAL NAMES ARE BASED ON A NATIONAL GYPSUM GOLD BOND STA-SMOOTH BEVEL EDGE SYSTEM. USE GOLD BOND OR EQUAL SYSTEM BY U.S. GYPSUM.

WALLS (EXCEPT WHERE NOTED): 1/2" STA-SMOOTH GYPSUM WALLBOARD

WALLS WHERE NOTED: 1/2" THICK TAPE-ON MOISTURE RESISTANT GYPSUM WALLBOARD

DROPPED CEILING WHERE NOTED: 1/2" STA-SMOOTH GYPSUM WALLBOARD

FIRE RATED WHERE NOTED OR REQUIRED BY CODE: 5/8" FIRE SHIELD (GYPSUM WALLBOARD)

2. FASTENERS

A. GYPSUM: 1-5/8" LONG MINIMUM SHANK NAILS MEETING THE REQUIREMENTS OF ASTM A307.

1-1/4" LONG TYPE-W WALL SCREWS TO WOOD STUDS.

1-1/4" LONG TYPE-S DW WALL SCREWS TO INTERIOR METAL STUDS.

1-1/4" LONG TYPE-S CORROSION RESISTANT SCREWS FOR EXTERIOR GYPSUM SHEATHING TO METAL STUDS.

E. JOINT TREATMENT COMPOUND SHALL BE READY MIXED. JOINT TAPE SHALL BE CALVANEZ FIBERED, PERFORATED, FEATHER EDGED. CORNER BEADS SHALL BE CALVANEZ STEEL ROLL-FORMED U-SHAPED CHANNELS.

F. HANGERS AND SUPPORTS: 2X4 WOOD FRAMING. SUBSTITUTION: FOR STEEL TRUSS BUILDINGS 1-1/2" CARRYING CHANNELS, 3/4" FURRING CHANNELS, 8 GAGE HANGER WIRES, 16 GAGE TIE WIRES, AND 1" TYPE S SCREWS.

PERFORMANCE

1. INSTALLATION

A. CUTTING WALLBOARD: GYPSUM WALLBOARD SHALL BE CUT BY SCORING AND BREAKING, OR BY SAWING, WORKING FROM THE FACE SIDE. WHERE BOARD MEETS PROJECTING SURFACES, IT SHALL BE SCRIBED NEATLY.

B. INSTALLING WALLBOARD: GYPSUM WALLBOARD SHALL BE APPLIED AT RIGHT ANGLES TO FRAMING MEMBERS. BOARDS OF MAXIMUM PRACTICAL LENGTH SHALL BE USED SO THAT AN ABSOLUTE MINIMUM NUMBER OF END JOINTS OCCUR. WALLBOARD JOINTS AT OPENINGS SHALL BE LOCATED SO THAT NO END JOINT SHALL ALIGN WITH EDGES OF OPENINGS. END JOINTS SHALL BE STAGGERED.

C. FASTENING WALLBOARD: ATTACH WITH SCREWS OR NAILS SPACED APPROXIMATELY 8" o.c. THE NAILS SHALL BE DRIVEN HOME WITH THE HEAD SLIGHTLY BELOW THE SURFACE OF THE BOARD IN A DIMPLE FORMED BY THE DRIVING TOOL.

D. FASTENING EXTERIOR GYPSUM SHEATHING: ATTACH TO METAL STUDS WITH SCREWS @ 12" o.c. WITH HEAD FLUSH WITH SURFACE.

E. JOINTS FINISHING: JOINT COMPOUND, QUICK-TREAT, AND TOPPING COMPOUND SHALL BE APPLIED IN ACCORDANCE WITH PRINTED INSTRUCTIONS CONTAINED IN THE PACKAGE. A UNIFORMLY THIN LAYER OF JOINT COMPOUND SHALL BE APPLIED OVER THE JOINT UNDER THE TAPE TO PROVIDE PROPER BOND. CEILING AND WALL ANGLES AND INSIDE CORNER ANGLES SHALL BE REINFORCED WITH THE TAPE FOLDED TO CONFORM TO THE ANGLE AND EMBEDDED IN THE COMPOUND. AFTER THE COMPOUND IS THOROUGHLY DRY, APPROXIMATELY TWENTY FOUR (24) HOURS FOR REGULAR COMPOUND, 2-1/2 HOURS FOR QUICK TREAT, THE TAPE SHALL BE COVERED WITH A COAT OF JOINT COMPOUND OR TOPPING COMPOUND SPREAD OVER THE TAPE APPROXIMATELY 3" ON EACH SIDE OF TAPE, AND FEATHERED OUT AT THE EDGE. AFTER THOROUGHLY DRY, APPLY ANOTHER COAT OVER JOINTS. THIS COAT SHALL BE SMOOTH AND THE EDGES FEATHERED APPROXIMATELY 3" BEYOND THE PRECEDING COAT. ALLOW EACH APPLICATION OF COMPOUND TO JOINTS AND NAIL HEADS TO DRY, THEN SAND IF NECESSARY. ALL WALLBOARD AND TREATED AREAS SHALL BE SMOOTH AND READY FOR PAINTING OR WALLCOVERING.

GENERAL CONSTRUCTION NOTES

GYPSUM BOARD / EXTERIOR SHEATHING NOTES:

1. 1/2" GYPSUM BOARD TO BE INSTALLED ON ALL INTERIOR WALLS WHERE PLYWOOD IS NOT REQUIRED. ALL JOINTS ARE TO BE TAPED.

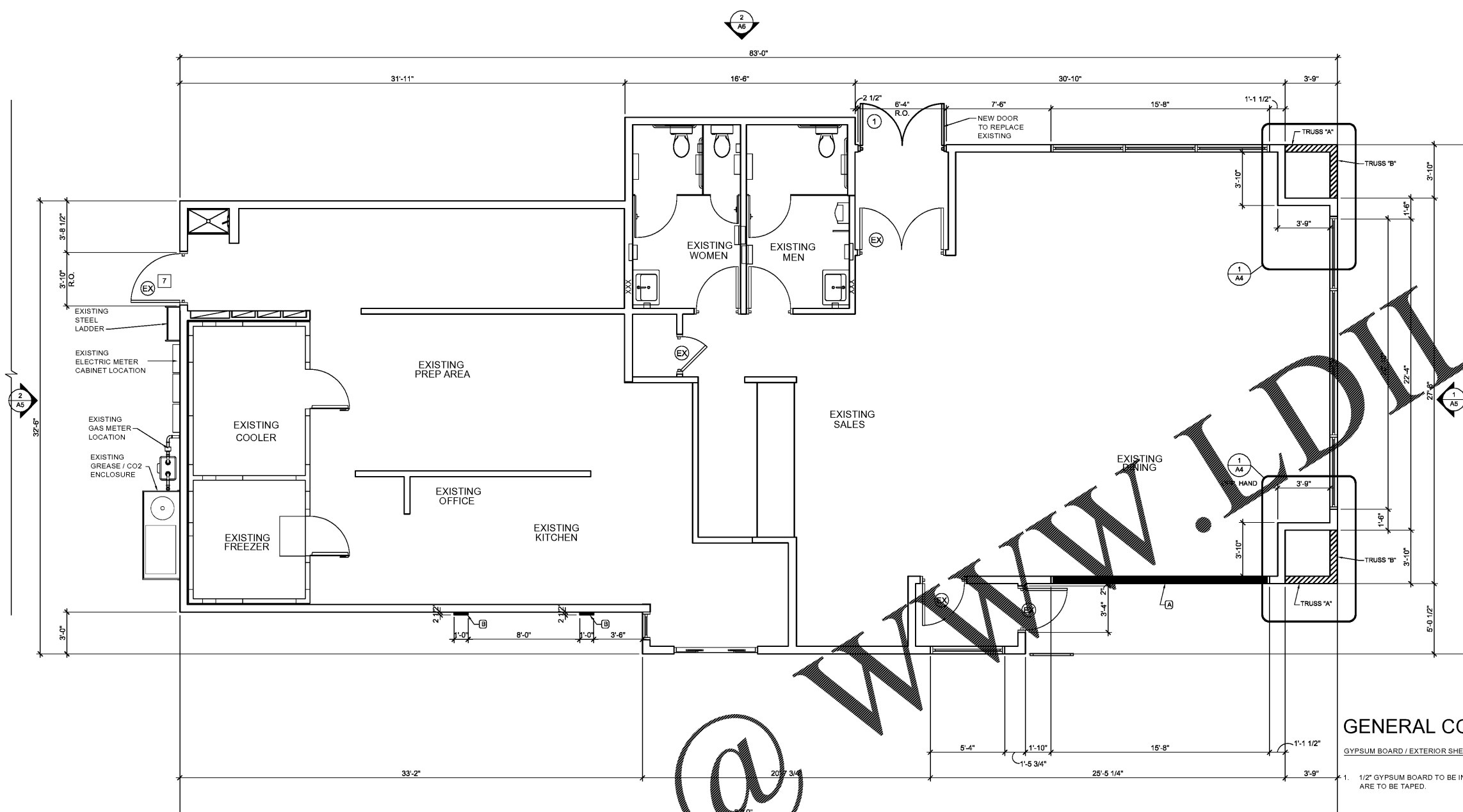

1 FLOOR PLAN
A1 1/4"=1'-0"

FRAMING SYMBOLS

- [Symbol] 16" WOOD STUD FRAMING @ 16" O.C.
- [Symbol] 16" WOOD STUD FRAMING @ 12" O.C.

[Symbol] DOOR NUMBER
EX DENOTES EXITING TO REMAIN

[Symbol] DETAIL NUMBER
A12 SHEET NUMBER
PLAN DETAIL

[Symbol] DETAIL NUMBER
A3 SHEET NUMBER
SECTION DETAIL - ARROW INDICATES DIRECTION OF VIEW

XXX DENOTES BLOCKING AS REQUIRED

CONSTRUCTION KEY NOTES

- DIMENSIONS ARE SHOWN:
1) EXTERIOR WALLS, FROM THE FACE OF FINISH WALL TO THE FACE OF FINISH WALL, U.N.O..
- 2) ALL GYPSUM BOARD BELOW FINISHED CEILING HEIGHT IS TO BE PREPARED FOR PAINTING OR WALLCOVERING AS INDICATED ON INTERIOR ELEVATIONS AND FINISH SCHEDULE. SEE GEN. CONSTR. NOTES FOR DINING AREA.
- 3) ALL DOORS SHALL BE ABLE TO BE OPENED FROM THE EGRESS SIDE WITHOUT THE USE OF A KEY, SPECIAL KNOWLEDGE OR EFFORT. MANUALLY OPERATED FLUSH BOLTS OR SURFACE BOLTS SHALL NOT BE USED.
- 4) PROVISIONS FOR EXISTING EXIT DISCHARGE LIGHTING ARE SHOWN ON THE LIGHTING PLAN SHALL BE EXISTING TO REMAIN.

Order Plans