

Order Plans

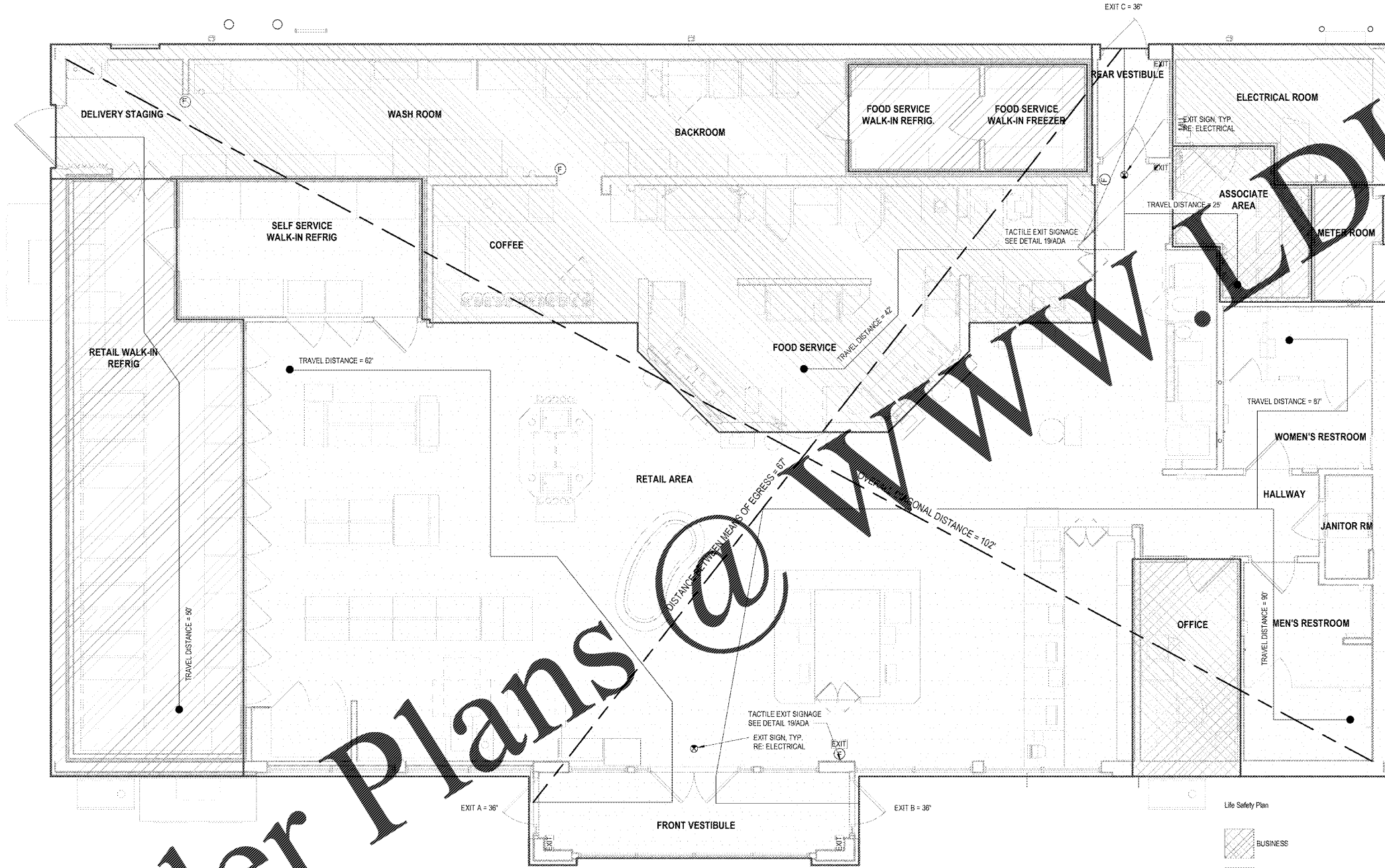

Life Safety Plan

	BUSINESS
	MERCANTILE
	MERCANTILE (FOOD PREP)
	STORAGE
	Calculating...

EGRESS DATA:

MINIMUM EGRESS CAPACITY (IBC 1004.2.1)
 REQUIRED = 32' (OCCUPANT LOAD MULTIPLIED BY 0.2 OR MIN. CLEAR DOOR WITH AS REQUIRED BY CODE)
 PROVIDED = 122' (EXIT A = 36', EXIT B = 36', EXIT C = 36')

OCCUPANCY TYPE	AREA	OCC. / SF	OCC. LOAD
BUSINESS	193 SF	100	2
MERCANTILE	2626 SF	60	44
MERCANTILE (FOOD PREP)	1258 SF	200	6
STORAGE	699 SF	300	2
	4736 SF		54

EGRESS CAPACITY:
 MINIMUM EGRESS CAPACITY (IBC 1004.2.1)
 REQUIRED = 32' (OCCUPANT LOAD MULTIPLIED BY 0.2 OR MIN. CLEAR DOOR WITH AS REQUIRED BY CODE)
 PROVIDED = 122' (EXIT A = 36', EXIT B = 36', EXIT C = 36')

ARRANGEMENT OF EXITS
 SEPARATION DISTANCE (IBC 1015.2.1) AT LEAST TWO EXITS SHALL HAVE A MINIMUM SEPARATION NOT LESS THAN ONE-HALF OF THE OVERALL LENGTH OF THE SPACE.
 OVERALL DIAGONAL DISTANCE = 102 FEET
 MIN. REQ'D DISTANCE BETWEEN EXITS = 51 FEET (100/2)
 PROVIDED DISTANCE BETWEEN EXITS = 67 FEET

TRAVEL DISTANCES
 MAXIMUM TRAVEL DISTANCE FOR OCCUPANCY M, UNSPRINKLERED = 200 FEET (IBC 1016.2)
 ACTUAL LONGEST TRAVEL DISTANCE = 90 FEET

EMERGENCY SIGNAGE AND LIGHTING

- REFER TO SHEET E2 FOR EMERGENCY LIGHTING AND EXIT SIGN LOCATION
- EXIT LIGHTS ARE TO BE MOUNTED AT THE GREATEST HEIGHT ALLOWABLE AND IN COMPLIANCE WITH CODES. EXIT LIGHTS LEADING FROM THE SALES FLOOR SHALL BE VISIBLE ABOVE STOCK AISLES.

FINISH CLASSIFICATIONS

- CLASS B FINISHES AT EXIT ENCLOSURES & EXIT PASSAGEWAYS (FLAME SPREAD 28-75, SMOKE DEVELOPMENT 0-450)
- CLASS B FINISHES AT CORRIDORS (FLAME SPREAD 26-75, SMOKE DEVELOPMENT 0-450)
- CLASS C FINISHES AT ROOMS AND ENCLOSED SPACES (FLAME SPREAD 75-200, SMOKE DEVELOPMENT 0-450)

1925 Prospect Ave.
 Oakwood, VA 22651
 (407) 668-1100
 (407) 668-9101
 www.c-p.com

4
 Chhaci & Peterson
 Architects Engineers Planners

CLIENT NAME: **WAWA**
 280 W. BALTIMORE PIKE
 WAWA, PA 19083

PROJECT NAME: **U45-VA V2018 01-MA STORE #6647-PHM**
 PARRHAM RD. & THREE CHOFT RD.
 HENRICO, VA

REVISION SCHEDULE

No.	Description	Date
PERMIT SET		09/21/2018
REV V2018 01		01/29/2019
BID SET		01/29/2019

PROJECT NO: 2180133
 DATE: 09-21-2018
 DRAWN: []
 CHECKED: []
 RS

LS

14" = 1'-0"

1
 LS
 LIFE SAFETY PLAN