

Created By: [unclear] Location: [unclear] Date: 08/24/2018 09:02:25am  
 This document, together with the contents and design presented herein, is intended only for the specific purpose and client for which it was prepared. Review of this document without authorization is prohibited.

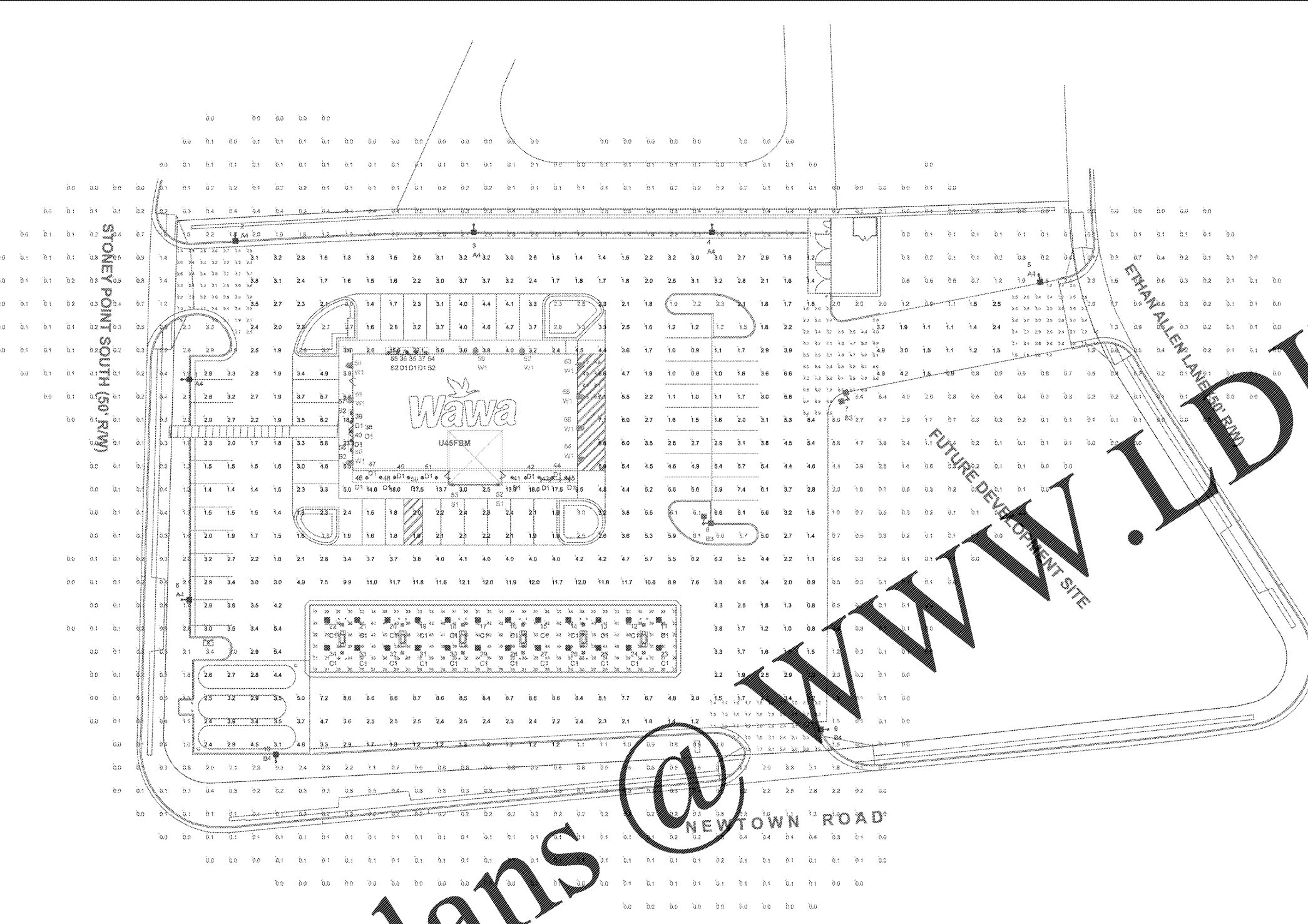

LUM. NO.	LABEL	MTG. HT.
1	A4	20.5
2	A4	20.5
3	A4	20.5
4	A4	20.5
5	A4	20.5
6	A4	20.5
7	B3	20.5
9	B4	20.5
10	B4	20.5
11	C1	18.21
12	C1	18.21
14	C1	18.21
15	C1	18.21
16	C1	18.21
17	C1	18.21
18	C1	18.21
19	C1	18.21
20	C1	18.21
21	C1	18.21
22	C1	18.21
23	C1	16.21
24	C1	16.21
25	C1	16.21
26	C1	16.21
27	C1	16.21
28	C1	16.21
29	C1	16.21
30	C1	16.21
31	C1	16.21
32	C1	16.21
33	C1	16.21

LUM. NO.	LABEL	MTG. HT.
34	C1	16.21
35	D1	9
36	D1	9
37	D1	9
38	D1	9
39	D1	9
40	D1	9
41	D1	9
42	D1	9
43	D1	9
44	D1	9
45	D1	9
46	D1	9
47	D1	9
48	D1	9
49	D1	9
50	D1	9
51	D1	9
52	S1	7.5
53	S1	7.5
54	S2	7.5
55	S2	7.5
56	S2	7.5
57	S2	7.5
58	W1	15
59	W1	15
60	W1	15
61	W1	15
62	W1	15
63	W1	15
64	W1	15
65	W1	15
66	W1	15

**NOTE:**  
 - FOOTCANDLE LEVELS CALCULATED AT GRADE USING PREDICTED LUMEN VALUES AFTER 25K HOURS OF OPERATION  
 - ALL AREA LIGHTS ON 20 FT. POLES MOUNTED ON 6 IN. CONCRETE BASES

SYMBOL	QTY	LABEL	ARRANGEMENT	LUMENS	LLF	ARR. WATTS	TOTAL WATTS	MANUFACTURER	DESCRIPTION
A4	2	A4	SINGLE	8891	1.000	134	804	CREE, INC.	ARE-EDG-3MB-DA-06-E-UL-WH-700-57K
B3	2	B3	2 @ 90 DEGREES	12678	1.000	268	536	Cree Inc.	ARE-EDG-4M-DA-06-E-UL-WH-700-57K
C1	2	C1	SINGLE	9549	1.000	134	268	CREE, INC.	ARE-EDG-4MB-DA-06-E-UL-WH-700-57K
D1	2	D1	SINGLE	10912	0.980	101	2424	CREE, INC.	CAN-304-SL-RD-06-E-UL-WH-525-57K
S1	4	S1	SINGLE	1548	1.000	27.6	469.2	PHILIPS LIGHTOLIER	C6L1520DW30KCLW/C6L15N1 (CAN LIGHT)
S2	4	S2	SINGLE	2011	1.000	46.9	93.8	SCOTT ARCHITECTURAL LIGHTING	WC1 SCOTT ITL61322 S9131 9x20
W1	9	W1	SINGLE	1119	1.000	22.6	90.4	SCOTT ARCHITECTURAL LIGHTING	WC2 SCOTT ITL61321 S9130 9x16
W1	9	W1	SINGLE	4210	0.980	43	387	CREE, INC.	SEC-EDG-3M-WM-04-E-UL-WH-350-57K

LABEL	AVG	MAX	MIN	AVG/MIN	MAX/MIN
CANOPY	33.73	46	16	2.11	2.88
DELIVERY	5.48	6.9	4.2	1.30	1.64
ENTRANCES & EXITS	3.31	8.0	1.1	3.01	7.27
PAVED	3.82	23.3	0.8	4.78	29.13
UNDEFINED	0.58	6.1	0.0	N.A.	N.A.

NO.
REVISIONS
DATE

**Kimley»Horn**

© 2018 KIMLEY-HORN AND ASSOCIATES, INC.  
 1700 WILLOW LANE DR., SUITE 200, RICHMOND, VA 23230  
 PHONE: 804-673-3882  
 WWW.KIMLEY-HORN.COM

KHA PROJECT 116607003  
 DATE 08/24/2018  
 SCALE AS SHOWN  
 DESIGNED BY LEY  
 DRAWN BY LEY  
 CHECKED BY JY

PHOTOMETRIC PLAN

WAWA AT NEWTOWN AND STONEY POINT PREPARED FOR WAWA

CITY OF NORFOLK VIRGINIA

SHEET NUMBER
CP-100