

F = FEET G = GAGE
 I = INCHES O = OPERATION
 E = EIGHTHS C = FIN/COLOR

PANEL/COVERING
 W 1 3 1 1 7 2 6 1 K T D
 * F F I I E G G O C C C
 LENGTH CODE

INSULATION
 I B 1 3 0 1 0 3 5 0 3 0 W V
 ** F F F I I I I I I E C C
 LENGTH WIDTH THK CODE

SECONDARY (STANDARD)
 O B Z 1 9 1 1 4 1 7 - - - - -
 * * * F F I I E G G * * * * *
 DEPTH LENGTH GAGE ADJUST.CODES
 S-SHAPE

SECONDARY (SPECIAL)
 0 0 1 0 8 2 1 9 1 1 4 1 7 - - - -
 * * * * * F F I I E G G * * * * *
 COUNTER DEPTH & LENGTH GAGE ADJUST CODES
 SHAPE

ROD BRACING
 0 3 R S 2 5 1 0
 I E * * F F I I
 DIA LENGTH

RS = THREADS BOTH ENDS
 RT = THREADS ONE END - CLEVIS ONE END
 RU = CLEVIS BOTH ENDS
 RP = THREAD BOTH ENDS - NO HILLSIDES

CX*** = COLUMN (PLATE)
 CGX*** = COLUMN (GAGE)
 WCX*** = COLUMN (HOTROLL)

RBX*** = RAFTER (PLATE)
 BCX*** = RAFTER (GAGE)
 WRX*** = RAFTER (HOTROLL)
 TRX*** = TRUSS RAFTER

ICX*** = INTERIOR COLUMN
 PCX*** = PIPE COLUMN
 TCX*** = TUBE COLUMN

EPX*** = ENDPOST (PLATE)
 EGX*** = ENDPOST (GAGE)

CBX*** = CANOPY (PLATE)
 CBX*** = PIGGYBACK CANOPY

DCC*** = 8 1/2" GAGE POST
 DCE*** = 10" GAGE POST

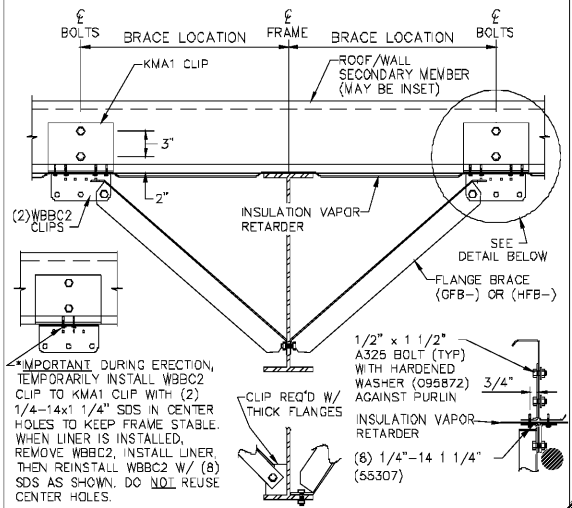
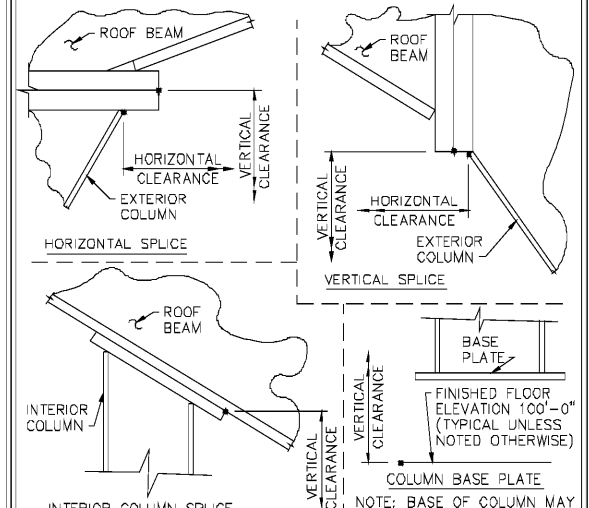
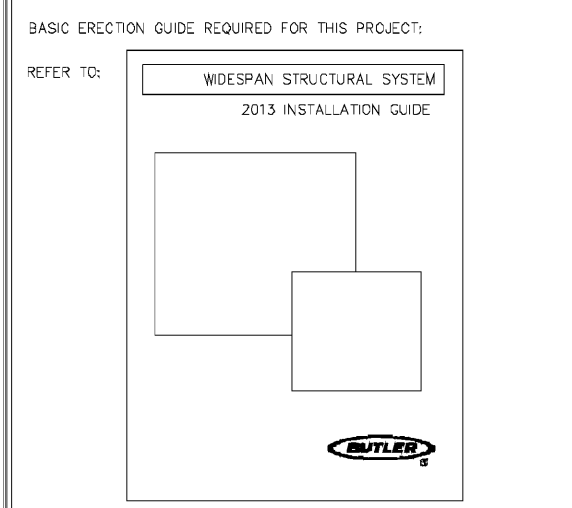

REV. DATE: 06/29/12 REV. NO. 01
 EN50B1 MARK NUMBER KEY
 COMMON GENERATED MARK NUMBERS

REV. DATE: 07/26/14 REV. NO. 02
 ENB002 BASIC ERECTION GUIDE - STRUCTURAL

REV. DATE: 06/12/15 REV. NO. 03
 PFR007 CLEAR HEIGHT DIMENSION WORK POINTS
 AS SHOWN ON FRAME CROSS SECTION DRAWINGS

REV. DATE: 10/24/17 REV. NO. 04
 BR06K3 ROOF/WALL FLANGE BRACING
 PURLIN/BRT WITH INSULATION VAPOR RETARDER

www.LDILine.com

Order Plans @

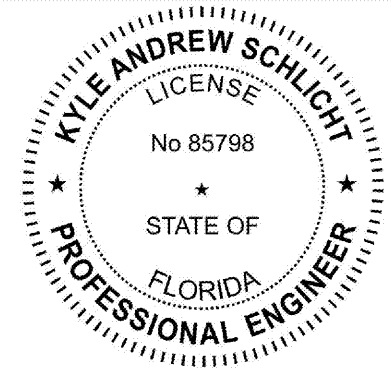

DRAWING PREPARED BY:
 BUTLER MANUFACTURING, A DIVISION OF
 BLUESCOPE BUILDINGS NORTH AMERICA
 1540 GENESSEE STREET
 KANSAS CITY, MO 64102
 FLORIDA CERTIFICATE OF AUTHORIZATION
 NUMBER 30427

KYLE ANDREW SCHLICHT
 1540 GENESSEE STREET
 KANSAS CITY, MO 64102
 FLORIDA, PE #85798

PERMIT SET- For Building Dept. Approval

1. USE 1/2" x 1/2" (ST BOLT #49080) AND NUT (#1920) W/O WASHERS. SNIP HIGH IN BOLTS ON ALL SECONDARY CONNECTIONS, SECONDARY CLIP CONNECTIONS, AND FLANGE BRACE CONNECTIONS, UNLESS NOTED OTHERWISE.
 2. SLOT FOR REINFORCEMENT PLATE NEED NOT BE LOCATED ON THE SAME SIDE OF THE WEB AS THE HILLSIDE WASHER.

THE BUTLER MFG. ENGINEER'S SEAL APPLIES ONLY TO THE WORK PRODUCT OF BUTLER MFG. AND DESIGN AND PERFORMANCE REQUIREMENTS SPECIFIED BY BUTLER. THE BUTLER MFG. ENGINEER'S SEAL DOES NOT APPLY TO THE PERFORMANCE OR DESIGN OF ANY OTHER PRODUCT OR COMPONENT FURNISHED BY BUTLER EXCEPT TO ANY DESIGN OR PERFORMANCE REQUIREMENTS SPECIFIED BY BUTLER.

THIS DRAWING, INCLUDING THE INFORMATION HEREON, REMAINS THE PROPERTY OF BUTLER MFG. IT IS PROVIDED SOLELY FOR ERECTING THE BUILDING DESCRIBED IN THE APPLICABLE PURCHASE ORDER AND MAY BE REPRODUCED ONLY FOR THAT PURPOSE. IT SHALL NOT BE MODIFIED, REPRODUCED OR USED FOR ANY OTHER PURPOSE WITHOUT PRIOR WRITTEN APPROVAL OF BUTLER MFG.

THE GENERAL CONTRACTOR AND/OR ERECTOR IS SOLELY RESPONSIBLE FOR ACCURATE GOOD QUALITY WORKMANSHIP IN ERECTING THIS BUILDING IN ACCORDANCE WITH THIS DRAWING, DETAILS REFERENCED IN THIS DRAWING, ALL APPLICABLE BUTLER MFG. ERECTION GUIDES, AND INDUSTRY STANDARDS PERTAINING TO PROPER ERECTION, INCLUDING THE CORRECT USE OF TEMPORARY BRACING.

B BUTLER MANUFACTURING 1540 GENESSEE ST. KANSAS CITY, MO 64102			
REV:	DATE:	BY:	DESCRIPTION:
DRAWING SCALE: NTS			

PRIMARY BRACING SED'S		 Butler Manufacturing VPC VERSION 2018.1b	JOB # 18-047559-01
BUILDER:	O'Reilly Automotive Stores, Inc.		DATE: 12/25/2018
CUSTOMER:	O'Reilly Automotive Stores, Inc.		DRAWING CHECK: JS / SW
LOCATION:	Panama City, Florida		PAGE: 9
PROJECT:	Panama City, FL (PM1)		
BUILDER'S PO#:	PM1		