

RECEIVED
JAN 10 2018
738E SANDHURST STREET
ATLANTA, GA 30328

EXTERIOR LIGHT FIXTURE SCHEDULE

ALL ITEMS LISTED ON THE "LIGHT FIXTURE SCHEDULE" WILL BE SUPPLIED BY THE OWNER (O'REILLY). ITEMS SHALL BE DIRECT ORDERED AND OR RELEASED FROM THE LISTED ELECTRICAL EQUIPMENT DISTRIBUTOR.											
GRAYBAR ELECTRIC CO. INC. 11885 LACKLAND ROAD ST. LOUIS, MO 63146											
GRAYBAR O'REILLY TEAM EMAIL: oreilly@graybar.com TOLL FREE: (314) 573-2080											
MARK	MFR.	CATALOG NUMBER	SUPPLY VOLTAGE	FINISH	SURFACE WALL	CEILING	FLUORESCENT	LED	QUANTITY	NOTES	
LED EXTERIOR LIGHTS											
WS1	LSI	XWM-FT-LED-06L-50-UE-BRZ	120	DARK BRONZE	X			X	1	59	FULL CUT-OFF, BUG RATING B1-UO-G1. ARCHITECTURAL ELEVATIONS SHOW DIMENSIONED LOCATIONS.
LED POLE LIGHTS											
P1	LSI	MRM-LED-18L-SIL-FT-LNV-DIM-50-80CR-BRZ-IL	120	DARK BRONZE		X	X		1	154	25' POLE LENGTH, ADVANCE BALLASTS, FULL CUT-OFF, NO SUBSTITUTIONS, ANCHOR BOLTS W/HARDWARE & TEMPLATE, WITH INTERNAL LOUVER HOUSE SIDE SHIELD, BUG RATING B2-UO-G3.
P2	LSI	MRM-LED-18L-SIL-FT-LNV-DIM-50-80CR-BRZ-IL	120	DARK BRONZE		X	X		2	154	25' POLE LENGTH, ADVANCE BALLASTS, FULL CUT-OFF, NO SUBSTITUTIONS, ANCHOR BOLTS W/HARDWARE & TEMPLATE, WITH INTERNAL LOUVER HOUSE SIDE SHIELD, 2 FIXTURES MOUNTED 180° FROM EACH OTHER, BUG RATING B2-UO-G3.
LED DECORATIVE EXTERIOR WALL LIGHT											
GNS	LSI	XDLSB-FT-LED-SS-CW-UE-BRZ-CH-W	120	DARK BRONZE	X			X	1	71	FULL CUT-OFF, ARCHITECTURAL ELEVATIONS SHOW DIMENSIONED LOCATIONS.

BACKLIGHT-UPLIGHT-GLARE (BUG) RATING / FULL CUTOFF

SEE CUT-SHEET ON SP SHEETS AND SCHEDULE BELOW FOR EXTERIOR LIGHT FIXTURES. ALL OF THE LSI MRM & XWM LED FIXTURES HAVE ZERO UPLIGHT AND ARE CONSIDERED "FULL CUT OFF" AND DARKSKY COMPLIANT. SP SHEETS AND BELOW DELIVERED LUMENS SCHEDULE HAS "BUG" RATINGS, AS TESTED TO IDENTIFY HOW MUCH OF THE LIGHT GOES BACKWARDS, UPWARDS AND TO THE GROUND. THE CHART SHOWS THAT THESE FIXTURES HAVE BUG RATINGS WITH (UPLIGHT) U = 0.

Fixture	Lumens	Watts	Lumens/Watt	IES Class	Long. Class	BUG Rating
XWM-3-LED-06-50	6,571	54	122	Type III	Medium	B1-UO-G2
XWM-FT-LED-06-50	6,523	54	121	Type IV	Short	B1-UO-G2

Statistics

Description	Symbol	Avg	Max	Min	Max/Min	Avg/Min	Avg/Max
Parking	+	1.5 fc	8.7 fc	0.0 fc	N/A	N/A	N/A

AUTOMATIC LIGHTING CONTROL

COMPLIANCE WITH ENERGY CODE IS ACHIEVED BY:

- ONCE THE EMS HAS BEEN PROGRAMMED, THE INTERIOR AND EXTERIOR LIGHTS WILL TURN ON AND OFF USING THE FOLLOWING LOGIC: SEE EM SHEETS.
 - INTERIOR WORK LIGHTS WILL TURN ON WITH FIRST MOTION IN THE STORE AND WILL TURN OFF 15 MINUTES AFTER LAST MOTION ONCE THE STORE IS CLOSED.
 - INTERIOR SALES LIGHTS WILL TURN ON AT STORE OPENING AND TURN OFF 15 MINUTES AFTER STORE CLOSING.
 - EXTERIOR SIGN LIGHTS WILL TURN ON WHEN IT IS DARK ENOUGH OUTSIDE ANYTIME DURING STORE HOURS, AND WILL TURN OFF AT STORE CLOSING.
 - EXTERIOR SITE LIGHTS WILL TURN ON WHEN IT IS DARK ENOUGH OUTSIDE AND IT IS WITHIN STORE HOURS OR THERE IS MOTION IN THE STORE. THEY WILL TURN OFF 30 MINUTES AFTER LAST MOTION ONCE THE STORE IS CLOSED.
 - FOR NEW CONSTRUCTION LOCATIONS ONLY, THERE IS A TEMPORARY PROGRAM TO KEEP SIGN AND SITE LIGHTS ON UNTIL MIDNIGHT RATHER THAN THE TIMES INDICATED ABOVE. O'REILLY WILL DISABLE THIS PROGRAM ONE YEAR AFTER STORE OPENING.
- RESTROOMS AND OFFICES: ALL LIGHTING IN THESE AREAS ARE CONTROLLED BY OCCUPANT-SENSING DEVICES.

LED LIFESTYLE SMALL DECORATIVE AREA LIGHTS (XDLS)

SMARTSTEP™ - LED lifestyle lighting fixture with remote control dimmer and ambient temperature sensor and motion sensor.

ENERGY SAVING CONTROL OPTION - DIM - 0-10V dimming enabled with controls by others. 0-8 level switching responds to external line voltage signal from separate 100-277V controller or sensor (by others), with low light level dimmed to 30% maximum dim level.

LEDs - Select high-brightness LEDs in Cool White (5000K), Neutral White (4000K) or Warm White (3000K) color temperatures. 70-90 CRI (90 and 95).

DISTRIBUTION PATTERN - Types S, F1 and S. Exceptional uniformity creates light trespass at lower light levels. Improved high-light cutoff minimizes light trespass.

CROWNS - Cast aluminum. Wiring emerges from crown through compression seal fitting to prevent water entry. One-piece stainless steel crown to match the motor and foot-light construction.

SHADES - Spot aluminum. Two shade styles available - A - Angle and B - Bell.

OPTICAL LIMIT - Optical unit and aluminum dome frame recessed into shade and sealed with one-piece silicone gasket. Clear tempered lens glass lens sealed with silicone gasket to clear frame (prevents pressure-equalizing benefits). Optical unit is fabricated and provides access to driver. Clear frame retaining fasteners are visible.

BRACKETS - Brackets are included and cast aluminum assemblies or fabrications. All decorative elements are die-cast or extruded aluminum.

MOUNTING - Classic Hook (CH), Side Arm (SA) - 4" O.D. minimum pole top required, Vial Mount (VM) for use with D1 or SA type. Pendant (PD) and Universal Pole Clamp (UPC) available. See Chart Fixture Pole and Aluminum Round Pole data sheets for pole selection information. Side Arm pole mount requires 2" minimum ceiling plating. Classic Hook mount requires a 4" O.D. pole or more.

ELECTRICAL - Two-wire single-pole installation (including separate master protection built into electronic driver) meets NEC 410-2.2(b)(2), Luminaires Category C. Available with universal voltage power supply 120-277VAC (K - 50/60Hz eqvt), and 247-480 VAC. Optional touch-free photocell (PTC) are available in 100, 200, 240, 300, 375 or 347' with (supply voltage must be specified).

DRIVERS - Available in 50 (Super Green) and 100 (High Output) drive currents (drive currents are factory programmed). Components are fully sealed in pre-drilled material for moisture resistance. Driver complies with FCC standards. Driver and key electronic components can easily be accessed.

OPERATING TEMPERATURE - -40°F to 60°F (-40°F to 142°F).

FINISH - Cast finish is finished with LED's Densify polymer powder coat process. The Densify finish withstands extreme weather changes without cracking or peeling.

WARRANTY - LSI LED fixtures carry a limited 5-year warranty.

PHOTOMETRICS - Please visit our web site at www.lsi.com for detailed photometric data.

SHIPPING WEIGHT (IN CARTONS) - 24 lbs. (10.0 kg)

LIGHTS - UL listed to U.S. and Canadian safety standards. Suitable for wet locations.

This product is a partial version of this product, and the electronic driver below. Please consult factory for specific requirements.

Light Output (lm)	Beam Angle	Beam Diameter (ft)	Beam Diameter (in)
100	15°	0.5	6
200	20°	0.7	8
300	25°	0.9	11
400	30°	1.1	13
500	35°	1.3	16
600	40°	1.5	18
700	45°	1.7	21
800	50°	1.9	23
900	55°	2.1	25
1000	60°	2.3	28

Printed Name: _____ Fixture Type: _____

Drawing #: _____

LED LIFESTYLE SMALL DECORATIVE AREA LIGHTS (XDLS)

PRODUCT DIMENSIONS INFORMATION

GENERAL DIMENSIONS: XDLSB-3 LED SS CW UE BLK CH S PCI120

Photo: [Image of fixture]

Dimensions: [Diagram showing dimensions: 1.5" height, 1.5" width, 1.5" depth]

ACCESSORY DIMENSION INFORMATION

Dimensions on Individual Parts:

Mounting: [Diagram showing mounting options: Classic Hook, Side Arm, Vial Mount, Pendant, Universal Pole Clamp]

Dimensions: [Diagram showing mounting dimensions]

LUMINAIRE DATA CHART - XDLS

Model	Beam Angle	Beam Diameter (ft)	Beam Diameter (in)
XDLSB-3	15°	0.5	6
XDLSB-3	20°	0.7	8
XDLSB-3	25°	0.9	11
XDLSB-3	30°	1.1	13
XDLSB-3	35°	1.3	16
XDLSB-3	40°	1.5	18
XDLSB-3	45°	1.7	21
XDLSB-3	50°	1.9	23
XDLSB-3	55°	2.1	25
XDLSB-3	60°	2.3	28

Printed Name: _____ Fixture Type: _____

Drawing #: _____

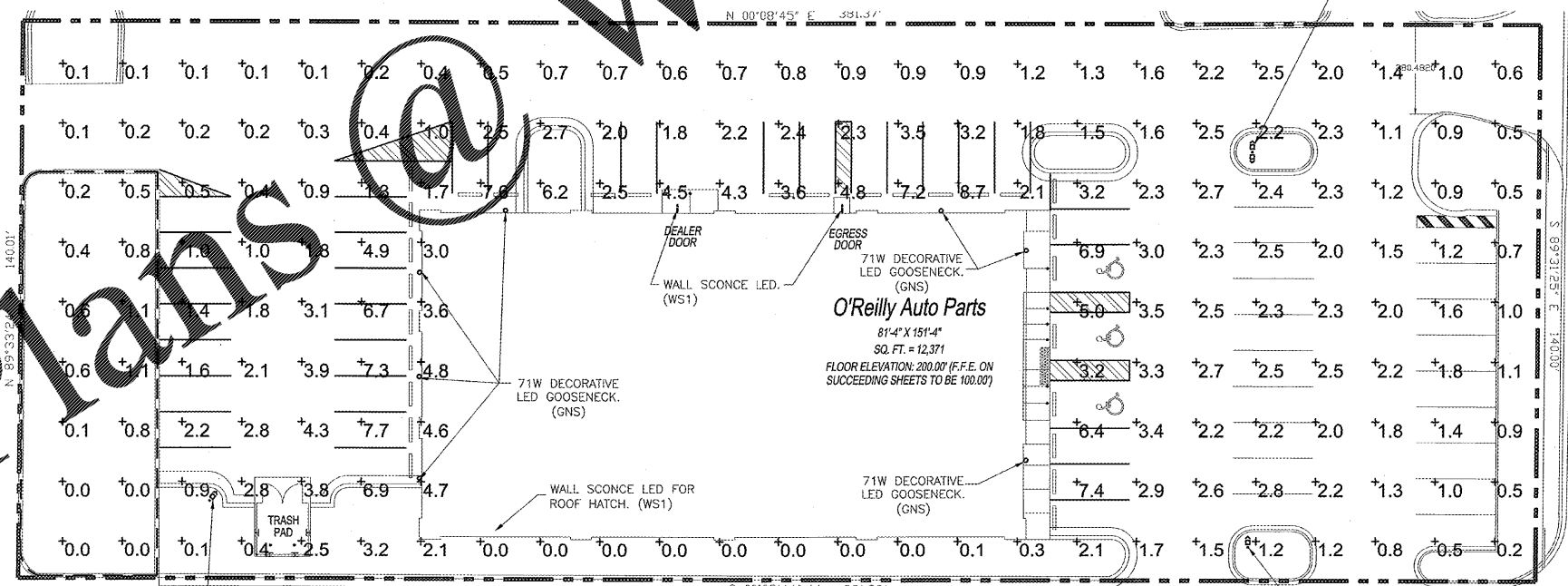

27'-6" OVERALL HEIGHT WITH 1-154W LED FIXTURE (P1).

27'-6" OVERALL HEIGHT WITH 1-154W LED FIXTURE (P1).

SITE LIGHTING PHOTOMETRICS

SCALE: 1" = 20'-0"



01-15-19
SHEET CHANGED IN ITS ENTIRETY.



3855 S. JEFFERSON AVE. P: 417-882-2200
SPRINGFIELD, MO 65807 F: 417-882-1188
WWW.SMITHGOTH.COM

PROJECT:
NEW O'REILLY AUTO PARTS STORE
1345 15TH STREET
PANAMA CITY, FL #1
SITE LIGHTING PHOTOMETRICS

O'Reilly AUTO PARTS
CORPORATE OFFICES
233 SOUTH PALM SPRINGFIELD, MISSOURI 65802
(417) 862-2674 TELEPHONE

COMM # 4275
DATE: 01-04-19
REVISION
DATE: 01-15-19

C COPYRIGHT 2018-2019 - DESIGNS, DRAWINGS AND SPECIFICATIONS ARE INSTRUMENTS OF SERVICE AND ARE THE PROPERTY OF THE DESIGN PROFESSIONAL. REPRODUCTION PROHIBITED WITHOUT THE EXPRESSED WRITTEN CONSENT OF THE DESIGN PROFESSIONAL.

CRAIG A. SCHNEIDER, AIA
ARCHITECT
1756 East Sunshine, Suite 417
Springfield, Missouri 65804
417.862.9558
417.862.9285
e-mail: carchitect@craftyschneider.com

Norman E. Goth
FL Lic # 57809
Firm Lic # 27905

SMITH-GOTH ENGINEERS, INC.
No. 57809
STATE OF MISSOURI
PROFESSIONAL ENGINEER
01/15/19

DRAWN BY: CEV