

ZONED GENERAL COMMERCIAL

NEW YORK LIFE INSURANCE COMPANY  
C/O MR. JIM ACKERMAN  
LARGO, FLORIDA 33777-1230  
18673-005-000

DRIVE THRU  
FOR ECKERDS

S 82°47'28"  
192.56'

N 00°08'45" E 381.37'

SEWAGE TREATMENT PLANT  
TOP=197.24  
INVERT IN(8" PVC)=193.16  
INVERT OUT(8" PVC)=193.00

ADDITIONAL MANHOLE  
MANHOLE MAY BE A STUB  
OUT FOR FUTURE CONSTRUCTION

S 99°33'24" E 221.02'

S 89°36'25" E 140.00'

30.00.06 N

S 00°08'44" W 381.29'

ZONED GENERAL COMMERCIAL  
K MART CORPORATION  
1329 15th STREET WEST  
PANAMA CITY, FLORIDA  
18673-010-000

15th STREET 80' R.O.W.

ZONED GENERAL COMMERCIAL

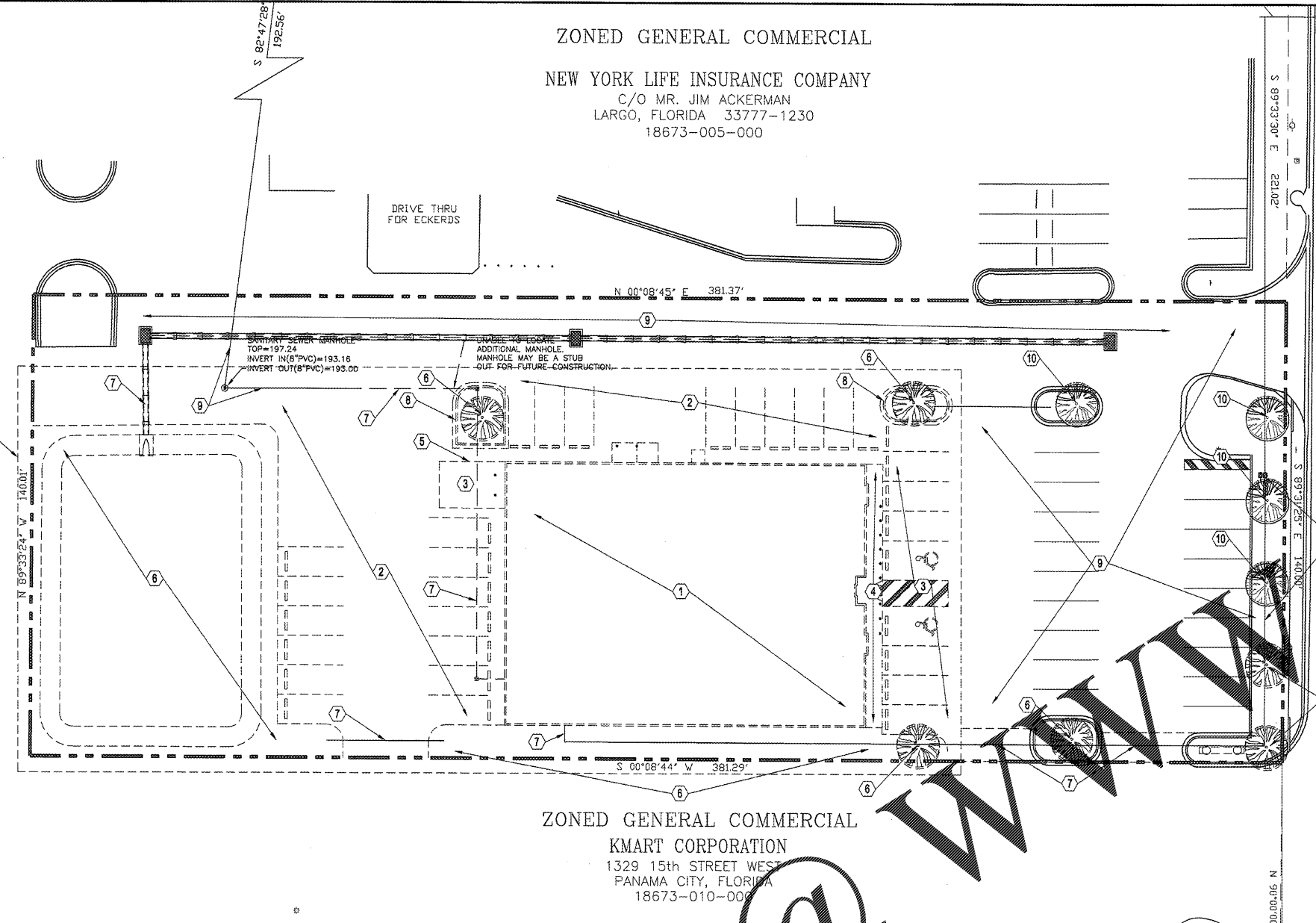

**1 SITE DEMOLITION PLAN**  
D1.1 SCALE: 1" = 20'-0"

**GENERAL NOTES**

- (A) REFER TO PROJECT MANUAL FOR ADDITIONAL REQUIREMENTS.
- (B) SITE CONDITIONS BASED UPON SURVEY PROVIDED BY OWNER. FIELD VERIFY EXISTING CONDITIONS BY DETAILED INSPECTION PRIOR TO SUBMITTING BID AND BEGINNING CONSTRUCTION. NOTIFY ARCHITECT IF EXISTING CONDITIONS DEVIATE SUBSTANTIALLY FROM THOSE INDICATED HEREIN.
- (C) REMOVE ALL EXISTING SITE CONSTRUCTION AND DELETERIOUS MATERIALS UNLESS OTHERWISE NOTED.
- (D) EXISTING CONSTRUCTION TO REMAIN TO BE PROTECTED AS REQUIRED. REPLACE AND/OR REPAIR EXISTING CONSTRUCTION DAMAGED DUE TO CONTRACTOR'S ACTIVITIES.
- (E) ALL DEMOLITION MATERIALS SHALL BECOME PROPERTY OF CONTRACTOR FOR PROPER DISPOSAL UNLESS OTHERWISE NOTED.
- (F) REFER TO SITE SAFETY PLAN FOR PROTECTION OF EXISTING UTILITIES.
- (G) EXISTING UNDERGROUND INSTALLATION SUCH AS WATER MAINS, MAINTENANCE SEWERS, TELEPHONE LINES, POWER LINES, AND GAS LINES IN THE VICINITY OF THE WORK AREA. INDICATED ON DRAWINGS ONLY TO THE EXTENT SUCH INFORMATION HAS BEEN MADE AVAILABLE. THERE IS NO GUARANTEE AS TO THE ACCURACY OR COMPLETENESS OF SUCH INFORMATION AND ALL RESPONSIBILITY FOR THE ACCURACY AND COMPLETENESS IS EXPRESSLY DISCLAIMED. GENERALLY SERVICE CONNECTIONS ARE NOT INDICATED ON THE DRAWINGS. CONTRACTOR SHALL BE RESPONSIBLE FOR DISCOVERY OF EXISTING UNDERGROUND INSTALLATIONS IN ADVANCE OF EXCAVATING OR TRENCHING BY CONTRACTING LOCAL UTILITIES.

**KEY NOTES**

- (1) EXISTING BUILDING AND FOUNDATION CONSTRUCTION TO BE REMOVED.
- (2) EXISTING PAVEMENT TO BE REMOVED.
- (3) EXISTING CONCRETE TO BE REMOVED.
- (4) EXISTING SIDEWALK TO BE REMOVED.
- (5) EXISTING FENCING TO BE REMOVED.
- (6) EXISTING TREES, BUSH, PLANTINGS, GROUND COVER AND DEBRIS TO BE REMOVED.
- (7) PORTION OF EXISTING UTILITIES TO BE REMOVED. REFER TO CIVIL AND MEP SHEETS FOR ADDITIONAL INFORMATION.
- (8) EXISTING CURB AND GUTTER TO BE REMOVED.
- (9) EXISTING TO REMAIN. PROTECT AS REQUIRED.
- (10) EXISTING TREE TO REMAIN. PROTECT AS REQUIRED. REFER TO DETAIL 7/L12.

**ENVIRONMENTAL GENERAL NOTES**

- (A) AN ENVIRONMENTAL ANALYSIS HAS BEEN PERFORMED ON THE EXISTING SITE. REFER TO PROJECT MANUAL.
- (B) IF THIS PROJECT CONTAINS HAZARDOUS MATERIALS, CONTRACTOR TO PROVIDE WORK REQUIRED FOR PROPER REMOVAL, HANDLING, AND DISPOSAL PER ENVIRONMENTAL ANALYSIS RECOMMENDATIONS.

**SYMBOLS LEGEND**

NOTE: REFER TO SURVEY FOR EXISTING CONDITIONS SYMBOLS LEGEND.

————— EXISTING CONDITIONS TO REMAIN.

- - - - - EXISTING CONDITIONS TO BE REMOVED.

CAUTION:  
INFORMATION ON THIS DRAWING CONCERNING TYPE AND LOCATION OF UNDERGROUND AND OTHER UTILITIES IS NOT GUARANTEED TO BE ACCURATE OR ALL INCLUSIVE. THE CONTRACTOR IS RESPONSIBLE FOR MAKING HIS OWN DETERMINATION AS TO THE TYPE AND LOCATION OF UNDERGROUND AND OTHER UTILITIES AS MAY BE NECESSARY TO AVOID DAMAGE THERETO.

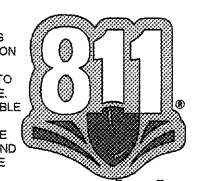

Know what's below  
Call before you dig.

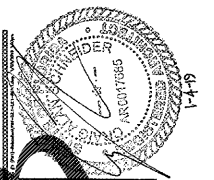

**CRAIG A. SCHNEIDER, AIA**  
ARCHITECT  
417.862.0100  
417.862.3265  
e-mail: architect@estetschneider.com

PROJECT:  
**NEW O'REILLY AUTO PARTS STORE**  
1345 15TH STREET  
PANAMA CITY, FL #1  
**SITE DEMOLITION PLAN**

**O'Reilly AUTO PARTS**  
CORPORATE OFFICES  
233 SOUTH PATTERSON  
SPRINGFIELD, MISSOURI 65802  
(417) 862-2674 TELEPHONE

COMM #	4275
DATE:	1-4-19
REVISION	
DATE:	

Order Plans @