



PANDA EXPRESS, INC.  
 1683 Walnut Grove Ave.  
 Rosemead, California  
 91770  
 Telephone: 626.799.9898  
 Facsimile: 626.372.8288

All ideas, designs, arrangement and plans indicated or represented by this drawing are the property of Panda Express Inc. and were created for use on this specific project. None of these ideas, designs, arrangements or plans may be used by or disclosed to any person, firm, or corporation without the written permission of Panda Express Inc.

REVISIONS:

ISSUE DATE:

1st	ISSUE FOR BUILDING PERMIT	08-16-18
2nd	ISSUE FOR BID	11-29-18

DRAWN BY: RR

PANDA PROJECT # S8-19-D6558  
 ARCH PROJECT # 1804



PANDA EXPRESS  
 US 98 and PORTSIDE DRIVE  
 3868 GULF BREEZE PARKWAY  
 GULF BREEZE, FL  
 2200 TRUE - R1 - DAB 12

E-106  
 HOT - MEDIUM  
 SITE PHOTOMETRIC PLAN

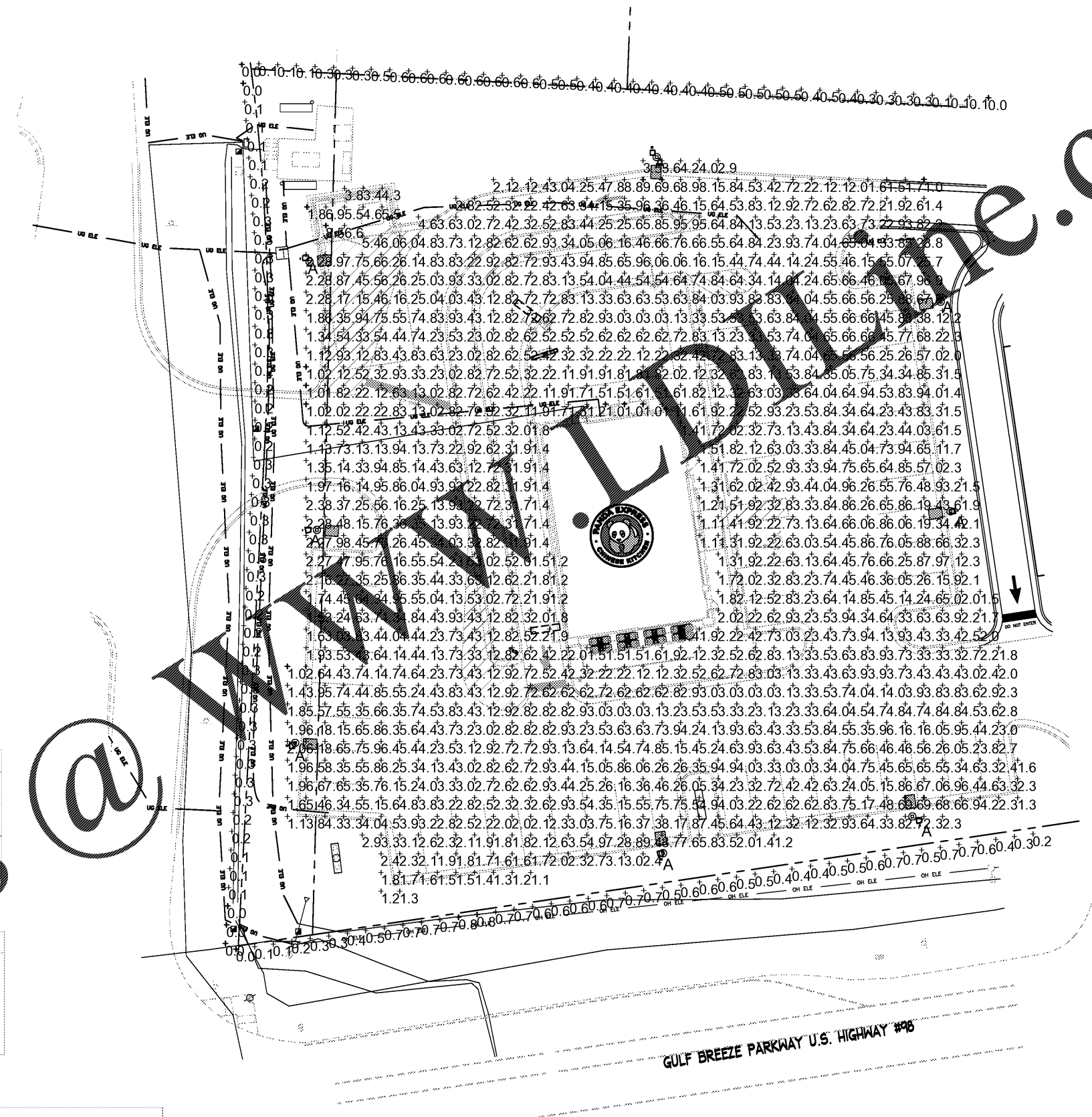

Statistics

Description	Symbol	Avg	Max	Min	Max/Min	Avg/Min
CALC SUMMARY- PANDA EXPRESS	+	3.8 fc	9.6 fc	1.0 fc	9.6:1	3.8:1
CALC SUMMARY- PROPERTY LINE	+	0.4 fc	0.8 fc	0.0 fc	N/A	N/A
TRASH ENCLOSURE	+	5.1 fc	8.5 fc	1.8 fc	4.7:1	2.8:1

Note

1. Mounting height of 22' (20' pole)
2. Calculations taken at ground level
3. Contact Villa Lighting- Ryan Zinselmeier-ryan.zinselmeier@villalighting.com 615.531-2600

Schedule

Symbol	Label	Quantity	Catalog Number	Description	Number Lamps	Lumens Per Lamp	Light Loss Factor	Wattage
	A	8	VILLA LIGHTING-XGBM-FT-LED-HO-NW-HSS	CONTACT RYAN ZINSELMEIER- 314-531-2600	1	17194	1	288.8