

- NOTES:
1. ALL CONCRETE TO BE 4000 P.S.I.
 2. PRECAST UNITS TO CONFORM TO A.S.T.M. SPECIFICATIONS, DESIGNATION C 478, LATEST EDITION.
 3. SUBGRADE TO BE COMPACTED TO 98% STD. PROCTOR DENSITY.

CONTRACTOR RESPONSIBLE FOR DESIGNING AND PROVIDING ANTI-FLOTATION DESIGN FOR STRUCTURES WITHIN CONFINES OF POND.

STORM PROFILE C3 - C1

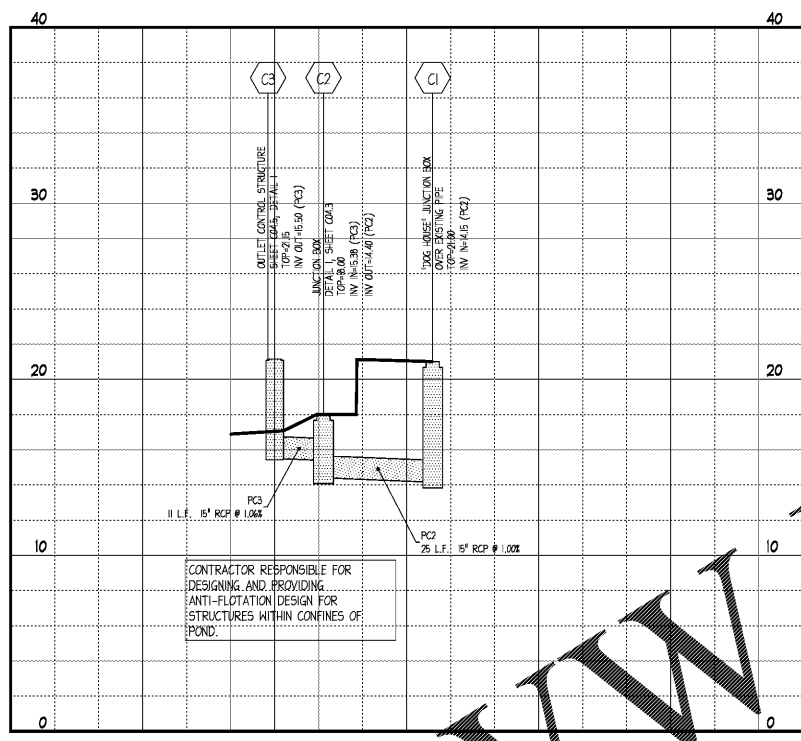

HORIZONTAL SCALE: 1"=5'
VERTICAL SCALE: 1"=5'

SANITARY PROFILE S4.2 - S4

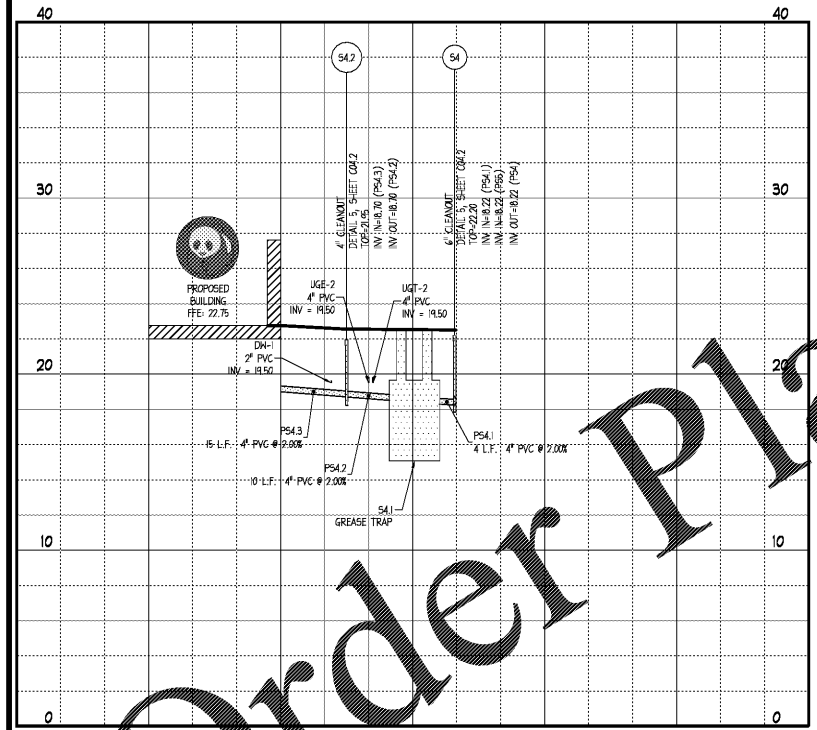

HORIZONTAL SCALE: 1"=20'
VERTICAL SCALE: 1"=5'

SANITARY PROFILE S8 - S1.3

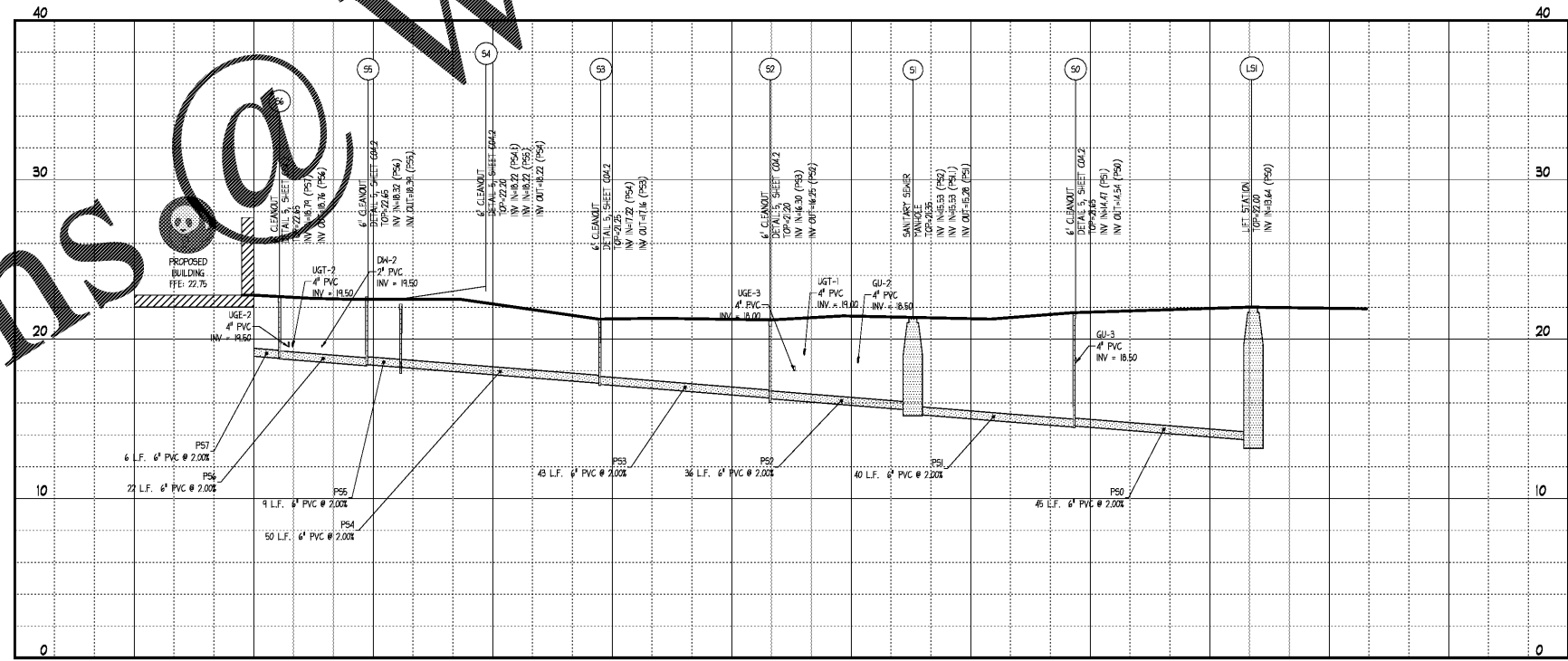

HORIZONTAL SCALE: 1"=20'
VERTICAL SCALE: 1"=5'

PROFILE NOTES

1. CONTROLLED BACK FILL TO BE PLACED IN 6" LOOSE LIFT AND COMPACTED TO 100% ASTM D4958 PRIOR TO STORM AND SANITARY SEWER CONSTRUCTION. BACK FILL SHALL BE PLACED TO A MINIMUM OF 2' ABOVE THE CROWN ELEVATION OF THE PIPES.
2. STORM DRAIN AND SANITARY SEWER LENGTHS ARE MEASURED FROM CENTER LINE OF STRUCTURE TO CENTERLINE OF STRUCTURE OR FACE OF HEADWALL.
3. ALL PIPE LENGTHS SHOWN ARE ROUNDED TO THE NEAREST FOOT.
4. ALL STORM DRAIN PIPING SHALL BE TRENCHED, BEDED AND BACK FILLED ACCORDING WITH DETAIL 4 ON SHEET C04.2 UNLESS SPECIFICALLY NOTED OTHERWISE.
5. ALL SANITARY SEWER PIPING SHALL BE TRENCHED, BEDED AND BACK FILLED ACCORDING WITH DETAIL 4 ON SHEET C04.2 UNLESS SPECIFICALLY NOTED OTHERWISE.
6. UNOBSERVED SUBSURFACE CONDITIONS SHALL BE BROUGHT TO OWNER'S AND ENGINEER'S ATTENTION IMMEDIATELY UPON DETECTION. CORRECTIVE MEASURES WITHOUT THE OWNER'S APPROVAL SHALL BE AT THE CONTRACTOR'S OWN RISK AND AT AN ADDITIONAL COMPENSATION.
7. EXISTING GRADES SHOWN ARE APPROXIMATE AND DO NOT REFLECT TOP SOIL REMOVAL, CLEARING, AND GRADING OPERATIONS. THE CONTRACTOR SHALL ASCERTAIN FOR HIMSELF THE EXTENT OF DISTURBANCE FOR THESE ACTIVITIES.
8. THE CONTRACTOR SHALL REFER TO THE GEOLOGICAL REPORT PREPARED BY THE OWNER FOR SUBSURFACE CONDITIONS. THE GEOLOGICAL REPORT IS NOT A PART OF THESE CONTRACT DOCUMENTS.
9. EXCAVATIONS FOR STRUCTURES SHALL BE TAKEN AS A TRENCHING AND SHALL BE SUBJECT TO GENERAL NOTES.
10. SEE SHEET C01 FOR GENERAL NOTES.

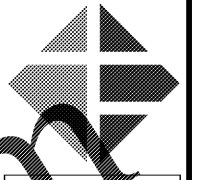

Ingenium
PLANNING & ENGINEERING
221 ROSWELL ST.
SUITE 100
ALPHARETTA, GA 30009
770.687.9950
WWW.INGENIUMTEAM.COM



THIS ITEM HAS BEEN DIGITALLY SIGNED AND SEALED BY JAMES D. NEFF, PE ON THE DATE ADJACENT TO THE SEAL.
PRINTED COPIES OF THIS DOCUMENT ARE NOT CONSIDERED SIGNED AND SEALED AND THE SIGNATURE MUST BE VERIFIED ON ANY ELECTRONIC COPIES.

STATE OF FLORIDA
AUTHORIZATION NUMBER
8370

PLANS PREPARED BY INGENIUM ENTERPRISES FORMERLY GRIFFAL CRAWFORD

PANDA EXPRESS/CFT PLAZA
3868 GULF BREEZE PARKWAY
GULF BREEZE, FLORIDA



CLIENT:
CFT NV DEVELOPMENTS, LLC
1120 N. TOWN CENTER DR., SUITE 150
LAS VEGAS, NV 89144
PHONE: (626) 799-8899

REVISION HISTORY	
1	ISSUE FOR BIDDING

THE CIVIL ENGINEER REGULARLY UPDATES ELECTRONIC FILES DURING THE DEVELOPMENT OF A PROJECT. AS A RESULT, THE DATA INCLUDED IN ANY CAD FILE OR DRAWING PRIOR TO ITS FINAL RELEASE DOES NOT NECESSARILY REFLECT THE COMPLETE SCOPE OR CONTENT AS PROVIDED IN THE CONTRACT. THE CONTENTS IN THESE FILES MAY THEREFORE BE INCOMPLETE, INACCURATE, OR OUT OF DATE AND SUBJECT TO CHANGE. FURTHERMORE, THE INFORMATION CONTAINED HEREIN IS THE SOLE PROPERTY OF THE CIVIL ENGINEER. THE ORIGINAL DESIGN REPRESENTED HEREIN BY THIS INFORMATION SHALL NOT BE USED, ALTERED, OR REPRODUCED IN ANY MANNER WITHOUT THE EXPRESSED WRITTEN CONSENT OF THE CIVIL ENGINEER. THESE PLANS ARE SUBJECT TO FEDERAL COPYRIGHT LAWS. ANY USE OF SAME WITHOUT EXPRESS WRITTEN PERMISSION OF THE CIVIL ENGINEER IS PROHIBITED.

PROJ # 17006
DWG NAME 17006_COLDING
ISSUE DATE 11/21/2008
PROJ MGR LF

PROFILES 1

C04.5
SHEET NUMBER

ISSUE FOR BIDDING