



PANDA RESTAURANT GROUP INC.  
1683 Walnut Grove Ave.  
Rosemead, California  
91770  
Telephone: 626.799.9898  
Facsimile: 626.372.8288

All ideas, designs, arrangement and plans indicated or represented by this drawing are the property of Panda Express Inc. and were created for use on this specific project. None of these ideas, designs, arrangements or plans may be used by or disclosed to any person, firm or corporation without the written permission of Panda Express Inc.

REVISIONS:  
ARCH/CIVIL/OWNER COORD. 01/30/19

ISSUE DATE:  
ISSUED FOR BID 01/30/19

DRAWN BY: P. Ranucci

PANDA PROJECT # S8-19-06573  
ARCH PROJECT # P7336

**gph**  
www.gphcorp.com  
A Full Service A & E Firm

Plans Prepared By:  
GPH, Inc.  
5200 Balford Road, Suite 220  
Jacksonville, FL 32256  
Ph: 904.332.0909  
Licenses:  
Eng. C.O.A. No. 3215  
Survey L. B. No. 1143  
Arch. Lic. No. AA2800928  
Landscape Lic. No. LC0600938

BRIAN P. CASSIDY, P.E.  
FL P.E. No. 67373

**PANDA EXPRESS**  
TRUE WARM & WELCOME 2200  
ATLANTIC & KERNAN  
CITY OF JACKSONVILLE, FLORIDA

**C5.1**

CONSTRUCTION DETAILS SHEET

TRUE WARM & WELCOME 2200

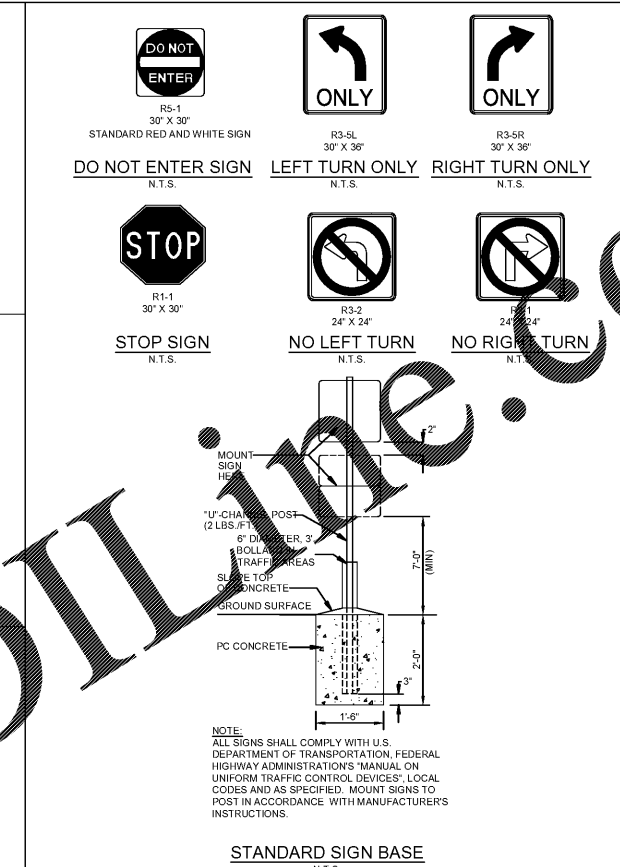

**CONCRETE NOTES:**

- F<sub>c</sub> = 5,000 PSI
- PROVIDE CONTROL JOINTS AT 5' O.C.
- PROVIDE EXPANSION JOINTS ONLY WHERE CONCRETE PAVEMENT ABUTS FIXED OBJECTS, CURBS AND GUTTER, AND OTHER PAVEMENT TYPES.
- 6"X6" W/M MAY BE SUBSTITUTED WITH EQUIVALENT STRENGTH FIBER MESH.

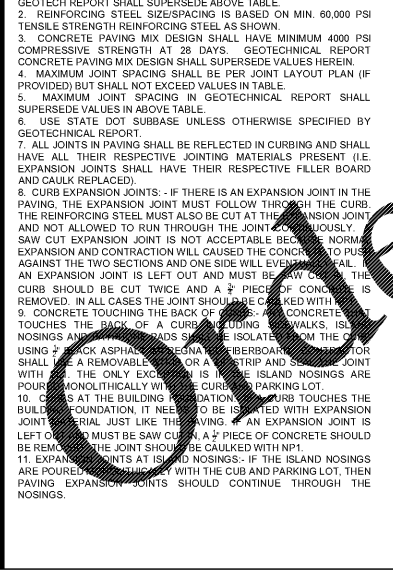
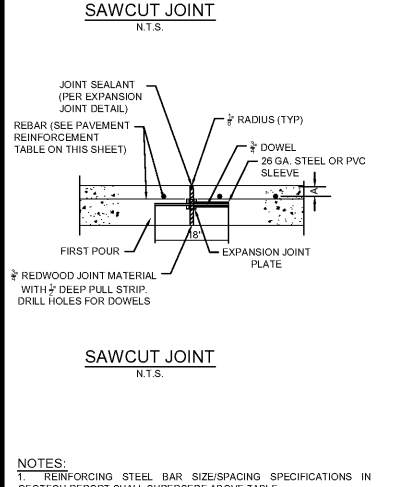
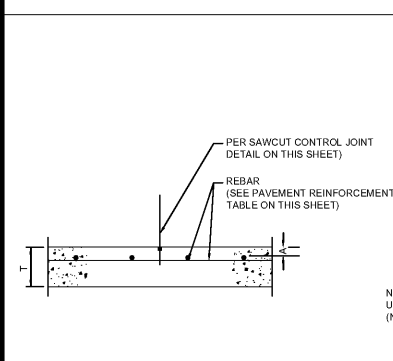
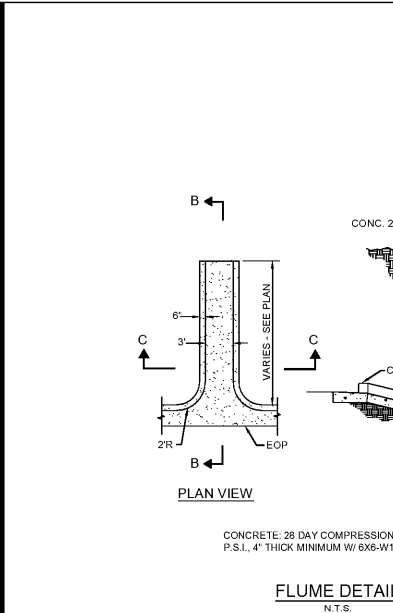
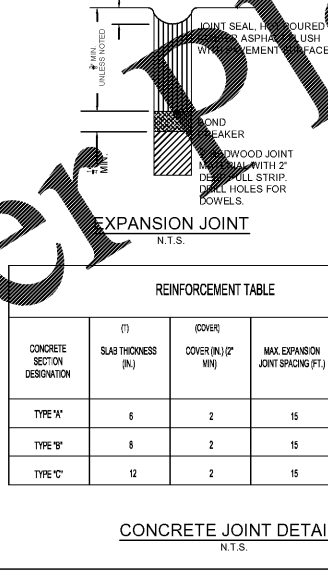
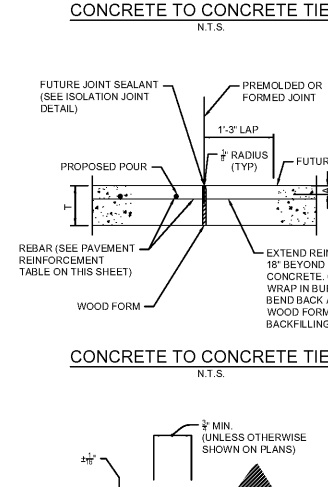
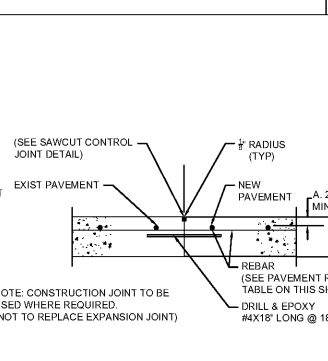
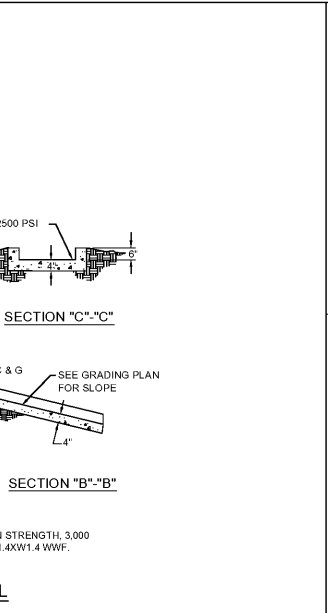
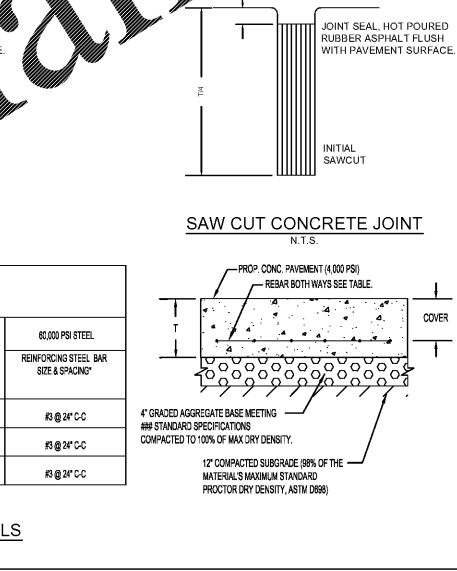
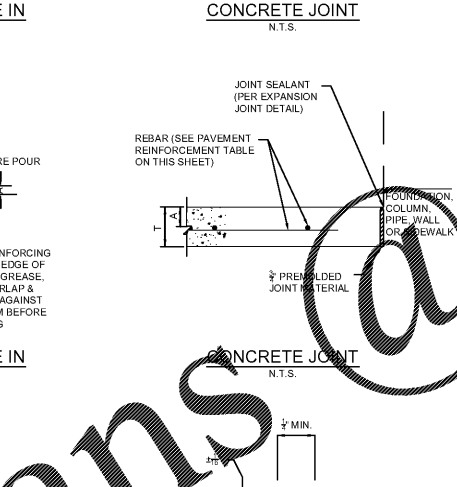
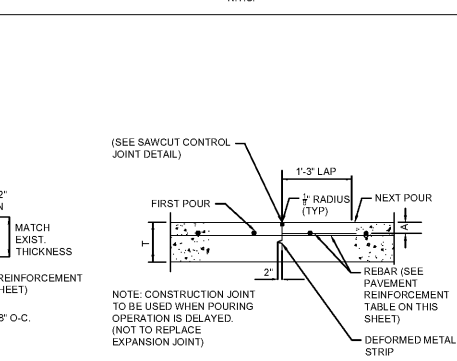
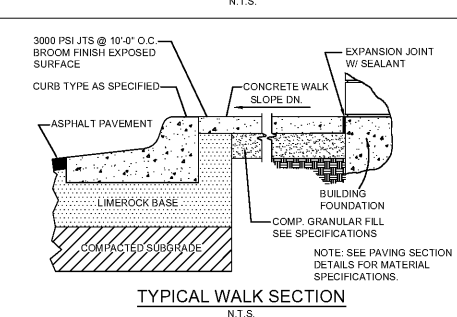
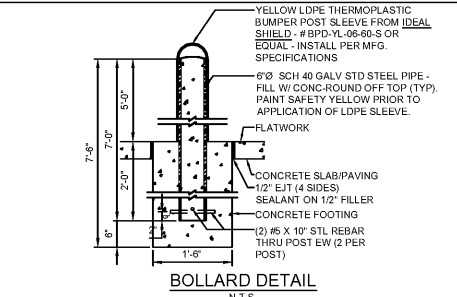
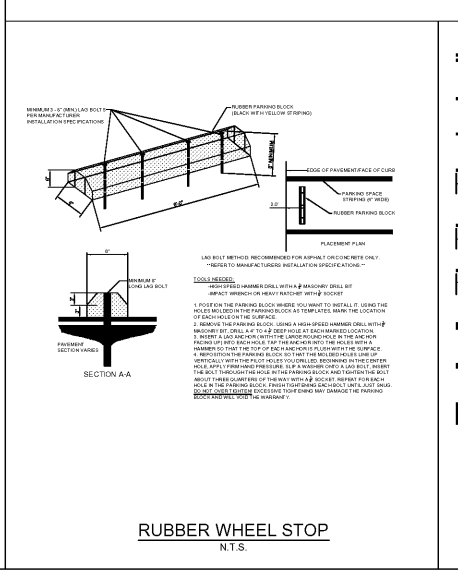
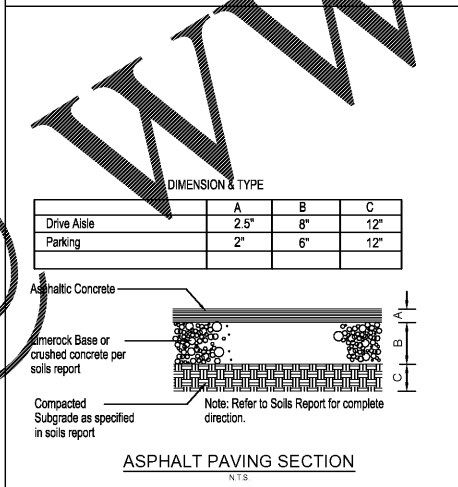
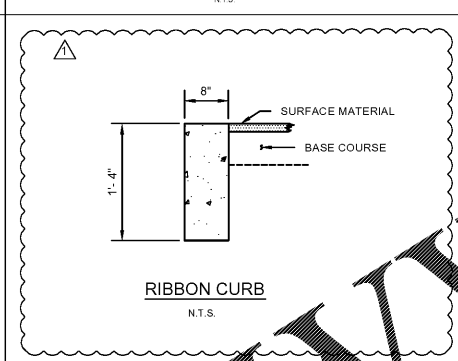
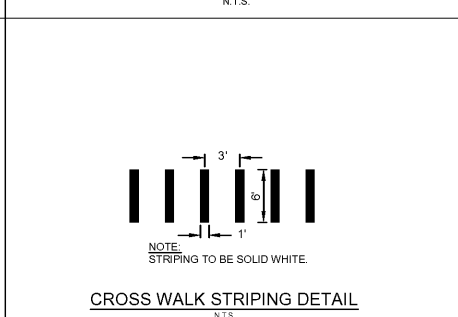
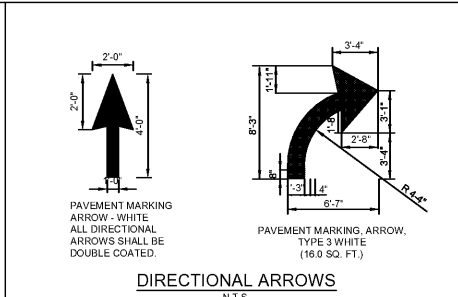
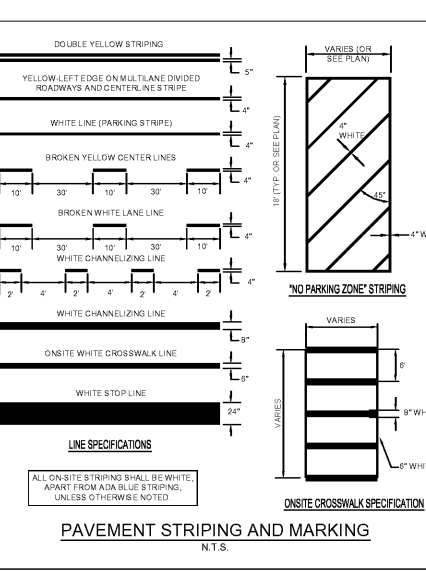
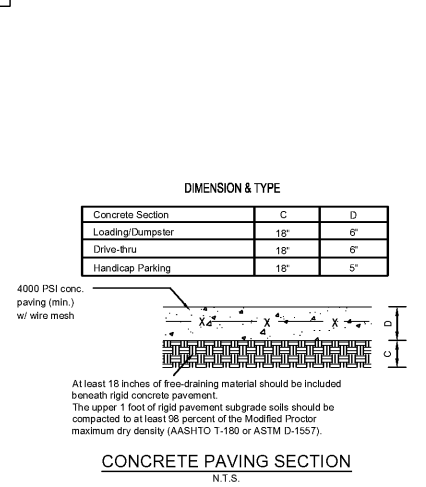
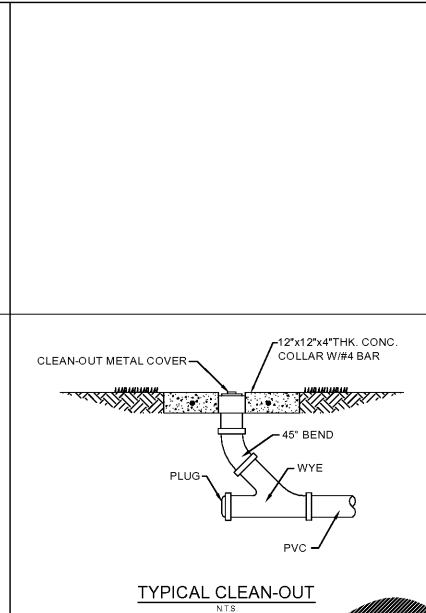
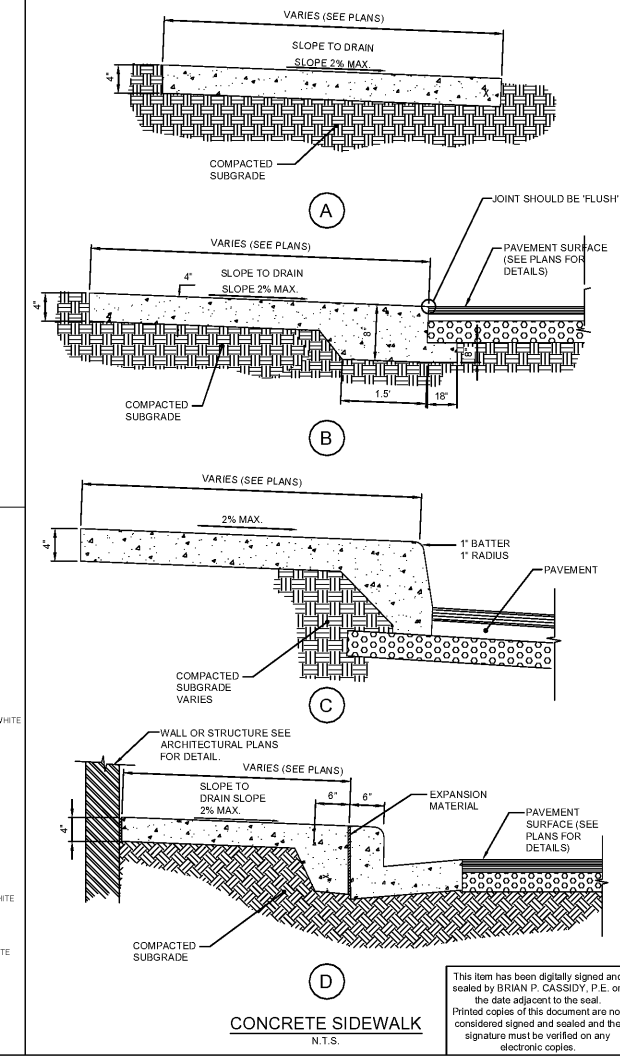

**REINFORCEMENT TABLE**

CONCRETE SECTION DESIGNATION	SLAB THICKNESS (IN)	COVER (IN) (2' MIN)	MAX. EXPANSION JOINT SPACING (FT)	REINFORCING STEEL BAR SIZE & SPACING
TYPE 'A'	6	2	15	#3 @ 24" CC
TYPE 'B'	6	2	15	#3 @ 24" CC
TYPE 'C'	12	2	15	#3 @ 24" CC

**NOTES:**

- REINFORCING STEEL BAR SIZE/SPACING SPECIFICATIONS IN GEOTECH REPORT SHALL SUPERSEDE ABOVE TABLE.
- REINFORCING STEEL SIZE/SPACING IS BASED ON MIN. 60,000 PSI TENSILE STRENGTH REINFORCING STEEL AS SHOWN.
- CONCRETE PAVING MIX DESIGN SHALL HAVE MINIMUM 4000 PSI COMPRESSIVE STRENGTH AT 28 DAYS. GEOTECHNICAL REPORT CONCRETE PAVING MIX DESIGN SHALL SUPERSEDE VALUES HEREIN.
- MAXIMUM JOINT SPACING SHALL BE PER JOINT LAYOUT PLAN (IF PROVIDED) BUT SHALL NOT EXCEED VALUES IN TABLE.
- MAXIMUM JOINT SPACING IN GEOTECHNICAL REPORT SHALL SUPERSEDE VALUES IN ABOVE TABLE.
- USE STATE DOT SUBBASE UNLESS OTHERWISE SPECIFIED BY GEOTECHNICAL REPORT.
- ALL JOINTS IN PAVING SHALL BE REFLECTED IN CURBING AND SHALL HAVE ALL THEIR RESPECTIVE JOINTING MATERIALS PRESENT (I.E. EXPANSION JOINTS SHALL HAVE THEIR RESPECTIVE FILLER BOARD AND CAULK REPLACED).
- CURB EXPANSION JOINTS - IF THERE IS AN EXPANSION JOINT IN THE PAVING, THE EXPANSION JOINT MUST FOLLOW THROUGH THE CURB. THE REINFORCING STEEL MUST ALSO BE CUT AT THE EXPANSION JOINT AND NOT ALLOWED TO RUN THROUGH THE JOINT UNUSUALLY.
- AN EXPANSION JOINT IS LEFT OUT AND MUST BE REINFORCED. THE CURB SHOULD BE CUT TWICE AND A 1/2" PIECE OF CONC. TO BE REMOVED. IN ALL CASES THE JOINT SHOULD BE CAULKED WITH NIP-1.
- CONCRETE TOUCHING THE BACK OF CURB OR TOUCHING THE BACK OF A CURB ISLAND SHALL BE ISOLATED FROM THE CURB USING 2" BACK ASPHALT OR BENTONITE FIBERBOARD. JOINTOR SHALL BE A REMOVABLE STRIP AND AN EXPANSION JOINT WITH THE ONLY EXP. JOINT IS IN THE ISLAND NOSINGS ARE POURING MONOLITHICALLY WITH CURB AND PARKING LOT.
- CURBS AT THE BUILDING FOUNDATION OR CURBS TOUCHES THE BUILDING FOUNDATION, IT NEED TO BE ISOLATED WITH EXPANSION JOINT MATERIAL JUST LIKE THE PAVING. AN EXPANSION JOINT IS LEFT OUT AND MUST BE SAW CUT AND A 1/2" PIECE OF CONCRETE SHOULD BE REMOVED. THE JOINT SHOULD BE CAULKED WITH NIP-1.
- EXPANSION JOINTS AT ISLAND NOSINGS - IF THE ISLAND NOSINGS ARE POURED TOGETHER WITH THE CURB AND PARKING LOT, THEN PAVING EXPANSION JOINTS SHOULD CONTINUE THROUGH THE NOSINGS.