

THIS DRAWING IS THE PROPERTY OF AEC SERVICES, INC. AND HAS BEEN PREPARED SPECIFICALLY FOR THE OWNER OF THIS PROJECT AT THIS SITE. IT MAY NOT BE USED FOR ANY OTHER PURPOSE, LOCATION, OR OWNER.

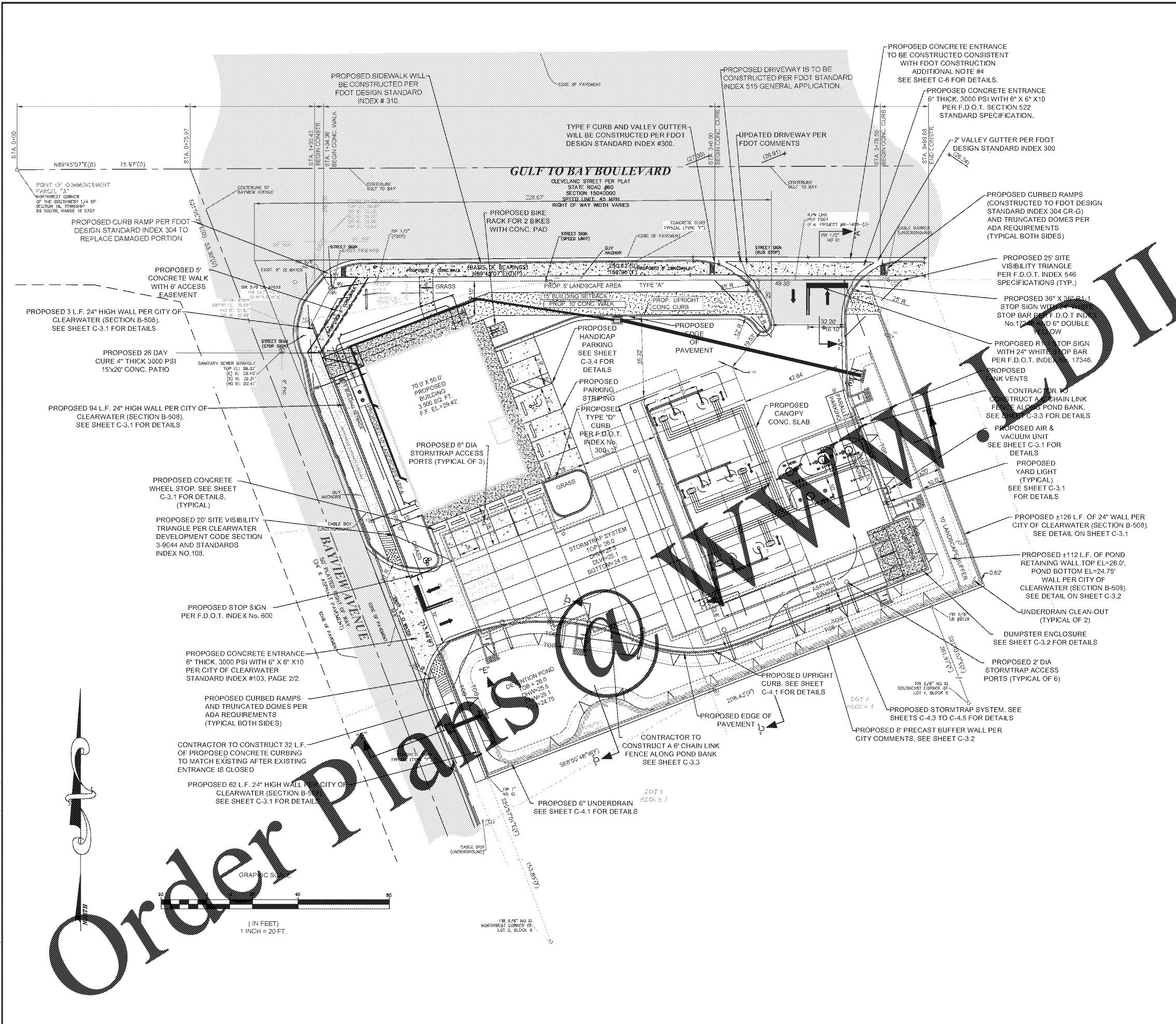

SITE DATA TABLE

PROPOSED USE:	GAS SERVICE STATION	
LOT AREA:	43,959 SQ. FT. (1.01 Ac.)	
SITE ADDRESS:	3009 GULF TO BAY BLVD. CLEARWATER, FL. 34619	
PARCEL ID:	16-29-16-05292-008-0130 16-29-16-53892-003-0010 16-29-16-53892-003-0020	
SITE DATA TOTALS:	EXISTING	PROPOSED
BUILDING HEIGHT:	16'	19'
OPEN AREA:	32,794 SQ. FT. = 74.6%	8,447 SQ. FT. = 19.3%
TOTAL IMPERVIOUS AREA:	11,165 SQ. FT. = 25.4%	30,012 SQ. FT. = 68.2%
DRAINAGE POND AREA:	0	5,500 SQ. FT. = 12.5%
PARKING SPACES:	0	4 SPACES PER 1,000 S.F. OF BUILDING, 3,500 S.F. OF BUILDING DIVIDED BY 1,000=3.5X4=14 SPACES
BUILDING SETBACKS:		
FRONT (NORTH)	15'	15'
REAR (SOUTH)	10'	10'
SIDE (WEST)	15'	15'
SIDE (EAST)	10'	10'
FLOOD ZONE:	PROJECT LIES WITHIN FLOOD ZONE X AS DELINEATED IN FEMA FLOOD INSURANCE RATE MAP, COMMUNITY PANEL NUMBER 12103C0129G, INDEX DATED SEPTEMBER 3, 2003.	
LEGAL DESCRIPTION:	(AS SURVEYED)	
PARCEL A:	TRACT A, BAY VIEW CITY SUBDIVISION, AS RECORDED IN PLAT BOOK 9, PAGE 43, PUBLIC RECORDS OF PINELLAS COUNTY, FLORIDA, TOGETHER WITH ONE-HALF OF A VACATED RIGHT-OF-WAY BEING DESCRIBED AS FOLLOWS: FROM THE NORTHWEST CORNER OF THE SOUTHWEST 1/4 OF SECTION 16, TOWNSHIP 29 SOUTH, RANGE 16 EAST, RUN N 89°45'07" E, ALONG THE CENTERLINE OF GULF-TO-BAY BOULEVARD (S. R. 60) 75.97 FEET, THENCE S 21°05'29" E, ALONG THE CENTERLINE OF BAYVIEW AVENUE 53.50 FEET; THENCE N 89°45'07" E, 26.75 FEET TO THE POINT OF INTERSECTION WITH THE SOUTH RIGHT-OF-WAY LINE OF GULF-TO-BAY BOULEVARD AND THE EAST RIGHT-OF-WAY LINE OF BAYVIEW AVENUE, SAID POINT BEING THE POINT OF BEGINNING; THENCE CONTINUE N 89°45'07" E ALONG SAID SOUTH RIGHT-OF-WAY LINE OF GULF-TO-BAY BOULEVARD (S. R. 60) 250.62 FEET; THENCE S 21°05'29" E, 14.46 FEET; THENCE S 69°01'11" W, 234.22 FEET TO A POINT ON THE EAST RIGHT-OF-WAY LINE OF BAYVIEW AVENUE; THENCE N 21°05'29" W, ALONG SAID EAST RIGHT-OF-WAY LINE, 103.20 FEET TO THE POINT OF BEGINNING. LESS ANY PART THEREOF LYING WITHIN LANDS DESCRIBED IN OFFICIAL RECORDS BOOK 6893, PAGE 338 AND OFFICIAL RECORDS BOOK 6997, PAGE 1573, PUBLIC RECORDS OF PINELLAS COUNTY, FLORIDA, CONTAINING 0.316 ACRES MORE OR LESS.	
PARCEL B:	LOT ONE (1) OF BLOCK THREE (3) OF McMULLEN'S BAY VIEW SUBDIVISION, ACCORDING TO THE MAP OR PLAT THEREOF AS RECORDED IN THE PUBLIC RECORDS OF PINELLAS COUNTY, FLORIDA, TOGETHER WITH THE SOUTHERLY 1/2 OF THE RIGHT OF WAY VACATED BY THE CITY OF CLEARWATER, FLORIDA IN RESOLUTION 75-4 FILED 1/16/75 IN OR BOOK 4251, PAGE 153, LYING TO THE NORTH OF AND ADJACENT TO SAID LOT 1, ACCORDING TO THE PLAT THEREOF RECORDED IN PLAT BOOK 6, PAGE 23, OF THE PUBLIC RECORDS OF HILLSBOROUGH COUNTY, FLORIDA, OF WHICH PINELLAS COUNTY WAS FORMERLY A PART.	
	LOT 2, OF BLOCK 3 TOWN OF BAY VIEW AND KNOWN AS McMULLEN'S BAYVIEW SUBDIVISION, TOGETHER WITH THE SOUTHERLY 1/2 OF THE RIGHT OF WAY VACATED BY THE CITY OF CLEARWATER, FLORIDA IN RESOLUTION 75-4 FILED 1/16/75 IN OR BOOK 4251, PAGE 153, LYING TO THE NORTH OF AND ADJACENT TO SAID LOT 2, ACCORDING TO THE PLAT THEREOF RECORDED IN PLAT BOOK 6, PAGE 23, OF THE PUBLIC RECORDS OF HILLSBOROUGH COUNTY, FLORIDA, OF WHICH PINELLAS COUNTY WAS FORMERLY A PART.	
	TOGETHER WITH THE WEST 1/2 OF A VACATED RIGHT-OF-WAY, BEING MORE PARTICULARLY DESCRIBED AS FOLLOWS: COMMENCE AT THE NORTHWEST CORNER OF THE SOUTHWEST 1/4 OF SECTION 16, TOWNSHIP 29 SOUTH, RANGE 16 EAST, PINELLAS COUNTY, FLORIDA; THENCE N 89°45'07" E, ALONG THE CENTERLINE OF GULF-TO-BAY BOULEVARD, (S.R. NO.60), FOR A DISTANCE OF 75.97 FEET; THENCE S 21°05'29" E, ALONG THE CENTERLINE OF BAYVIEW AVENUE, FOR A DISTANCE OF 53.50 FEET; THENCE N 89°45'07" E, 26.75 FEET TO A POINT OF INTERSECTION WITH THE SOUTH RIGHT-OF-WAY LINE OF GULF-TO-BAY BOULEVARD AND THE EAST RIGHT-OF-WAY LINE OF BAYVIEW AVENUE; THENCE CONTINUE N 89°45'07" E, ALONG SAID SOUTH RIGHT-OF-WAY LINE OF GULF-TO-BAY BOULEVARD, FOR A DISTANCE OF 223.87 FEET TO THE POINT OF BEGINNING; THENCE CONTINUE N 89°45'07" E, ALONG SAID SOUTH RIGHT-OF-WAY LINE OF GULF-TO-BAY BOULEVARD, FOR A DISTANCE OF 26.75 FEET; THENCE S 21°05'29" E, FOR A DISTANCE OF 143.65 FEET; THENCE S 69°01'11" W, FOR A DISTANCE OF 250.00 FEET; THENCE N 21°05'29" W, FOR A DISTANCE OF 153.12 FEET TO THE POINT OF BEGINNING.	

GIANT OIL INC.
1806 N. FRANKLIN STREET
TAMPA, FLORIDA 33602

BP STATION
3009 GULF TO BAY BLVD.
CLEARWATER, FLORIDA 34619

AEC Services, Inc.
RON FAIR, P.E.
FL # 50738 License No. 9277 QB #001445

1619 ALLISON WOODS LANE
TAMPA, FL 33619
(813) 964-1234
www.aecservicesinc.com

NO.	DATE	DESCRIPTION	REVISIONS

SITE PLAN

C-3

Order Plans @

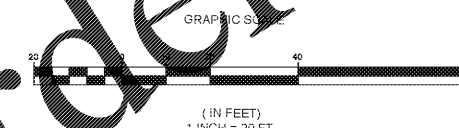

www.dline.com