

NO	REVISION / SUBMISSIONS	DATE

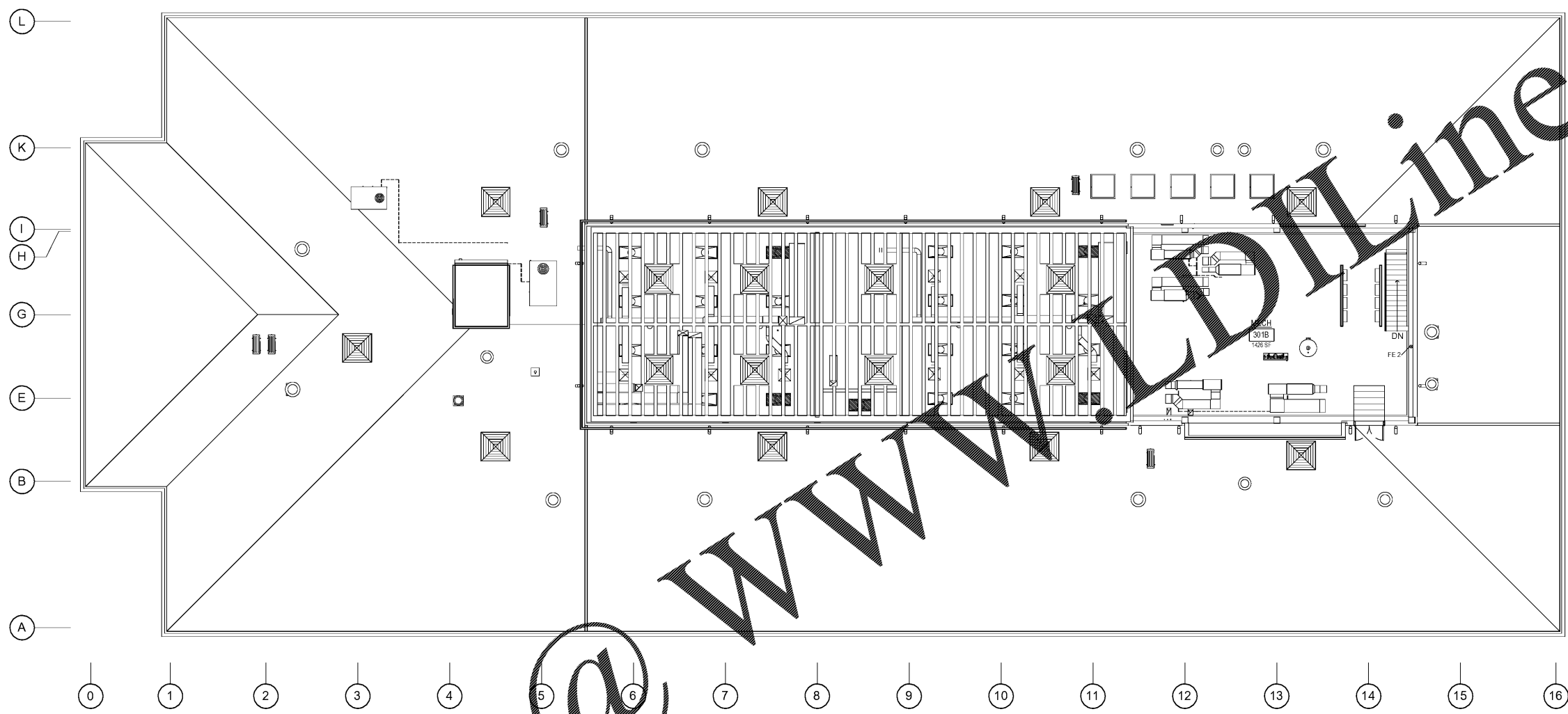

1 PENTHOUSE FLOOR PLAN - LIFE SAFETY
 A13 SCALE: 1/8" = 1'-0"

LEGEND	
FIRE RATED WALLS AND BARRIERS	
	ONE HOUR RATED BARRIER (IBC SECTION 8.2.3, IBC SECTION 705 AND/OR 708)
	TWO HOUR RATED BARRIER
	TWO HOUR RATED FIRE WALL (IBC SECTION 705)
	THREE HOUR RATED BARRIER (IBC SECTION 8.2.3, IBC SECTION 705 AND/OR 708)
PARTITIONS AND NON-RATED WALLS	
	SMOKE PARTITION (IBC SECTION 8.2.4)
	TYPICAL WALL (UNLESS NOTED OTHERWISE) EXTEND TO BOTH FLOOR OR ROOF DECK ASSEMBLY UNLESS BEARING WALL
	CABINET WITH MULTIPURPOSE DRY CHEMICAL EXTINGUISHER (MULTIPURPOSE)
	CABINET WITH CARBON DIOXIDE EXTINGUISHER (ELECTRICAL FRES)
	CABINET WITH DRY CHEMICAL EXTINGUISHER (KITCHEN FRES)
	BRACKET MOUNTED MULTIPURPOSE DRY CHEMICAL EXTINGUISHER (MULTIPURPOSE)
	BRACKET MOUNTED CARBON DIOXIDE EXTINGUISHER (ELECTRICAL FRES)
	BRACKET MOUNTED DRY CHEMICAL EXTINGUISHER (KITCHEN FRES)

LIFE SAFETY NOTES

- A. GENERAL NOTES**
- IT SHALL BE THE RESPONSIBILITY OF THE GENERAL CONTRACTOR TO HAVE, ON SITE, A COPY OF ANY AND ALL UL DESIGNS OR REGULATIONS CITED BY, BUT NOT LIMITED TO ARCHITECT ENGINEER, MANUFACTURER OR SUBCONTRACTOR
 - CODES ENFORCED BUT NOT LIMITED TO THE FOLLOWING - IBC, IECC, IFC, IMC, IPC, OF THE ICC 2006 ED. WITH GEORGIA DCA AMENDMENTS; NFPA 801, 2000 ED., NATIONAL FIRE CODE 2006 ED. W/ 120-3-3 GEORGIA MIN. FIRE SAFETY STD., 2010 ADA STANDARDS FOR ACCESSIBLE DESIGN.
 - FIRE EXTINGUISHER, INDICATED AS "FE 3", TO BE LOCATED NO LESS THAN 15 FEET FROM ANY RESIDENTIAL STOVE OR COMMERCIAL COOKING EQUIPMENT.
 - FIRE EXTINGUISHER, INDICATED AS "FE 2 OR FE 2", TO BE LOCATED IN ALL ELECTRICAL AND MECHANICAL ROOMS
- B. SMOKE PARTITIONS AND NON RATED WALLS**
- ALL WALLS (CONC. MASONRY AND METAL STUD WITH GYPSUM BOARD) SHALL EXTEND TO THE FLOOR OR ROOF DECK ASSEMBLY ABOVE (UNLESS NOTED OTHERWISE).
 - IF C.M.U. IS NOT REQUIRED STRUCTURALLY, THE WALL MAY CHANGE FROM C.M.U. TO METAL STUD 8" ABOVE CEILING UNLESS NOTED OTHERWISE. METAL STUD SIZE SHOULD MEET THE MINIMUM SPECIFIED REQUIREMENT WITH GYPSUM BOARD ON BOTH SIDES AND ACCOUSTICAL BATT. SEAL OPENINGS, PENETRATIONS AND INTERSECTIONS TO RESIST SOUND TRANSFER.
 - SMOKE PARTITIONS SHALL EXTEND TO FLOOR OR ROOF ASSEMBLY ABOVE. IF CMU IS NOT REQUIRED STRUCTURALLY, THE WALL MAY CHANGE FROM CMU TO METAL STUDS 8" ABOVE CEILING UNLESS NOTED OTHERWISE. SEAL OPENINGS, PENETRATIONS, AND INTERSECTIONS TO RESIST PASSAGE OF SMOKE. DOORS IN SMOKE PARTITIONS SHALL BE SELF-CLOSING OR AUTOMATIC CLOSING (EXCEPT IN CLASSROOMS)
 - ALL CORRIDORS TO BE SMOKE PARTITIONS. ALL GLAZING IN SMOKE PARTITION CORRIDOR WALLS TO BE SMOKE RESISTANT.
- C. RATED WALLS/BARRIERS**
- EXTEND ALL FIRE RATED PARTITIONS TO FLOOR OR ROOF DECK ASSEMBLY (UNLESS NOTED OTHERWISE). SEAL BETWEEN PARTITIONS AND THE ASSEMBLIES WITH MATERIALS SPECIFIED & REQUIRED TO MAINTAIN INDICATED RATING.
 - SEAL ALL PENETRATIONS THROUGH RATED PARTITIONS AND ASSEMBLIES WITH MATERIAL AND METHODS REQUIRED TO MAINTAIN RATINGS AND AS REQUIRED BY LOCAL AUTHORITIES.
 - 1 HR. RATED METAL STUD WALLS SHALL COMPLY WITH UL #465. 2 HR. RATED METAL STUD WALLS SHALL COMPLY WITH UL #425.

JOHN A. TUTEN & ASSOCIATES
 ARCHITECTS
 4680 U.S. HIGHWAY 17
 BRUNSWICK, GEORGIA 31525
 www.jatuten.com

GLYNN ACADEMY HIGH SCHOOL
 SCIENCE BLDG. (5015) MODERNIZATION
 1001 MANSFIELD ST. BRUNSWICK GA, 31520
 GLYNN COUNTY BOARD OF EDUCATION

CAPITAL OUTLAY
 PROJECT # TRD
 SYSTEM CODE: 663
 SCHOOL CODE: 4752
 FTE: 1798

PENTHOUSE FLOOR PLAN - LIFE SAFETY



ISSUED FOR:
 BID SET

DRAWN BY:
 CHECKED BY:
 APPROVED BY:
 01/19/19
 PROJECT DATE:
 1802
 PROJECT NUMBER

SHEET NUMBER:
A1.3
 Copyright (c) 2019
 All Rights Reserved

1/18/2019 11:22:25 C:\Users\jmt\Documents\1802_GA_Science Building\1802_Science Building.dwg