

NO	REVISION / SUBMISSIONS	DATE

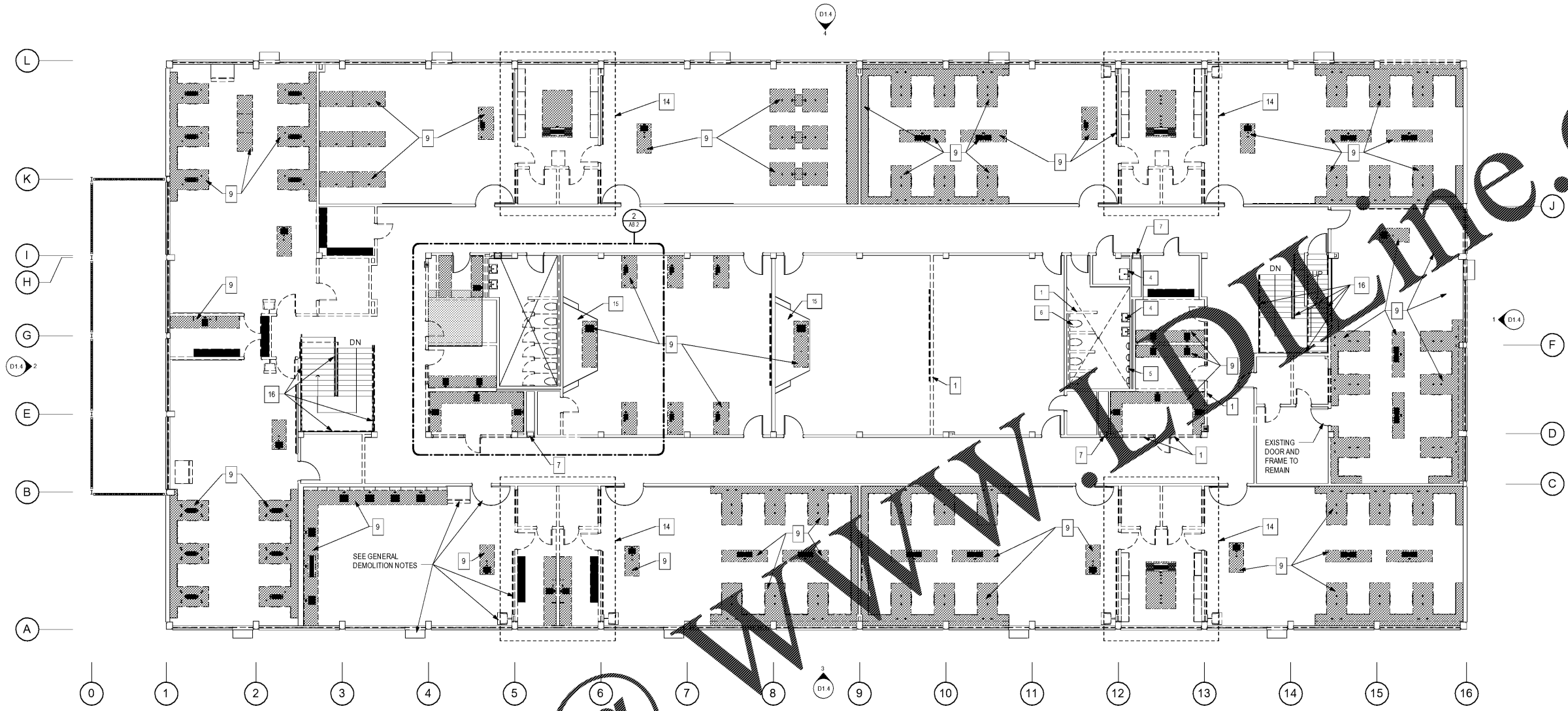

1 DEMOLITION -SECOND FLOOR
 D12 SCALE: 1/8" = 1'-0"

GENERAL DEMOLITION NOTES

- REMOVE ALL EXISTING PLUMBING, HVAC AND ELECTRICAL SYSTEMS AND COMPONENTS OF THE BUILDING. REMOVE ALL DEVICES, BRACKETS AND FASTENERS FROM INTERIOR AND EXTERIOR SURFACES. PATCH BRICK MASONRY, CONCRETE MASONRY, WOOD AND ALL SURFACE MATERIALS WHERE DEVICES ARE REMOVED TO MATCH ADJACENT FINISHED MATERIALS OF SAME COMPOSITION.
- REFER TO CIVIL DRAWINGS FOR ADDITIONAL REQUIREMENTS RELATED TO DEMOLITION.
- REMOVE COMPLETELY EXISTING HVAC SYSTEMS. COVER WINDOW OPENINGS AND ALL OTHER BUILDING ENVELOPE OPENINGS CREATED BY REMOVING HVAC EXISTING SYSTEMS TO KEEP BUILDING WATER TIGHT.
- REMOVE COMPLETELY EXISTING ELECTRICAL SYSTEMS, **LOW VOLTAGE SYSTEMS (SEE EXISTING DATA ROOM INFORMATION DRAWING) HOWEVER, KEEP EXISTING LIGHTING SYSTEMS IN SERVICE UNTIL NEW TEMPORARY LIGHTS ARE INSTALLED.**
- REMOVE ALL EXISTING DOORS UNLESS NOTED OTHERWISE. ALL DOOR FRAMES TO REMAIN UNLESS NOTED OTHERWISE. SEE DOOR SCHEDULE FOR ADDITIONAL INFORMATION.
- REMOVE ALL EXISTING EXTERIOR WINDOW SYSTEMS UNLESS NOTED OTHERWISE. COVER WINDOW OPENINGS AND ALL OTHER BUILDING ENVELOPE OPENINGS CREATED BY REMOVING EXISTING EXTERIOR WINDOW SYSTEMS TO KEEP BUILDING WATER TIGHT.
- REMOVE EXISTING LOW SLOPED METAL ROOFING SYSTEM OVER THE CENTER ROOF AND PERIMETER DOWN TO EXISTING CONCRETE SURFACE IN PREPARATION FOR NEW ROOFING SYSTEM.
- REMOVE CLASSROOM MILLWORK INCLUDING, BUT NOT LIMITED TO, CASES AND SHELVES, TEACHER CABINETS, STORAGE CABINET, SHELVING UNITS, BOOKCASE, BASE AND OVERHEAD CABINETS, WHERE INDICATED. REPAIR HOLES OR OTHER DAMAGES TO SURFACES AND STRUCTURE.
- CHALKMARKER/TACK BOARD: REMOVE EXISTING CHALKBOARD AND TACK BOARDS COMPLETELY, INCLUDING BOARD, TRIM AND ADHESIVE. REMOVE ALL BOARDS IN ONE CLASSROOM. CONTACT ARCHITECT IN WRITING FOR INSPECTION AND APPROVAL BEFORE PROCEEDING WITH REMOVAL OF CHALKMARKER/TACK BOARD DEMOLITION.
- REMOVE EXISTING WALL HUNG TV'S INCLUDING MOUNTING HARDWARE, ELECTRICAL BOXES, AND WIRING.
- REMOVE EXISTING SUSPENDED CEILING AND GRID SYSTEMS COMPLETELY INCLUDING WALL MOLD, CEILING GRID, CEILING TILE, SUPPORT WIRES, ATTACHMENT DEVICES AND RELATED ITEMS.
- THE CONTRACTOR SHALL HAVE THE OWNER REVIEW EQUIPMENT TO BE REMOVED. EQUIPMENT SELECTED BY OWNER FOR SALVAGE TO BE TURNED OVER TO OWNER. CONTRACTOR TO STORE IN OFF-SITE LOCATION DESIGNATED BY OWNER. EQUIPMENT NOT SELECTED BY OWNER FOR SALVAGE SHALL BECOME THE PROPERTY OF THE CONTRACTOR. THE CONTRACTOR SHALL DISPOSE OF SUCH EQUIPMENT IN A LEGAL MANNER OFF-SITE.

DEMOLITION NUMBERED NOTES

- REMOVE EXISTING PARTITION.
- REMOVE EXISTING TOILET PARTITIONS.
- REMOVE EXISTING COUNTERTOP AND ANY BASE OR UPPER CABINETS.
- REMOVE EXISTING SINK.
- REMOVE EXISTING URINAL(S).
- REMOVE EXISTING TOILET(S).
- REMOVE EXISTING DRINKING FOUNTAIN.
- REMOVE EXISTING LOCKER(S). REVIEW COURSE OF ACTION WITH ARCHITECT REGARDING EXISTING CONCRETE BASE.
- REMOVE EXISTING LAB TABLES AND ALL SUPPORTING UTILITY CONNECTIONS.
- REMOVE EXISTING LIBRARY SHELVING UNITS AS INDICATED IN THE DEMOLITION PLAN.
- REMOVE EXISTING COMPUTER STATION FURNITURE AT EACH EXISTING ROUND CONCRETE COLUMN.
- REMOVE EXISTING COMPUTER DESKS.
- REMOVE EXISTING WINDOW SYSTEM AND RELATED WALL.
- REMOVE EXISTING WOODEN PLATFORM.
- REMOVE EXISTING CENTER PORTION BETWEEN SCIENCE ROOMS UNLESS NOTED OTHERWISE.
- REMOVE EXISTING HANDRAILS AND GUARDRAILS.
- REMOVE EXISTING CONCRETE SIDEWALK UNDER EXISTING CANOPY.
- REMOVE EXISTING CONCRETE SLAB.
- REMOVE EXISTING GLAZED TILE AND BEDDING BACK TO EXISTING COLUMN IN PREPARATION FOR NEW FINISHES.

JOHN A. TUTEN & ASSOCIATES
 ARCHITECTS
 4680 U.S. HIGHWAY 17 NORTH
 BRUNSWICK, GEORGIA 31525
 www.jatuten.com

GLYNN ACADEMY HIGH SCHOOL
 SCIENCE BLDG. (5015) MODERNIZATION
 1001 MANSFIELD ST. BRUNSWICK GA, 31520
 GLYNN COUNTY BOARD OF EDUCATION

CAPITAL OUTLAY
 PROJECT # TBD
 SYSTEM CODE: 663
 SCHOOL CODE: 4752
 FTE: 1796

SECOND FLOOR PLAN - DEMOLITION



ISSUED FOR:
 BID SET

DRAWN BY:
 CHECKED BY:
 APPROVED BY:
 01/19/19
 PROJECT DATE:
 1802
 PROJECT NUMBER

SHEET
 NUMBER:
D1.2

Copyright (c) 2019
 All Rights Reserved

Order Plans @