

GENERAL POS NOTES:

- A. REFER TO HTTP://EXTRANET.DUNKINBRANDS.COM FOR A LISTING OF APPROVED POS VENDORS BY CONCEPT.
- B. FINAL POS DRAWINGS NEED TO BE PROVIDED TO POS VENDOR THAT IS SELECTED.
- C. POS VENDORS REQUIRE DEDICATED ISOLATED GROUNDED (DIG) OUTLETS ON A 20 AMP CIRCUIT DEDICATED ONLY TO POS EQUIPMENT. 60HZ, 120V +/-10%. ALL POS TERMINALS AND VIDEO DISPLAY DEVICES REQUIRE A DUPLEX OUTLET. THE BACK OFFICE CONTROLLER REQUIRES A QUAD OUTLET. THE NETWORK SWITCH REQUIRES A DUPLEX. IF FEDERAL, STATE, AND LOCAL WIRING CODES DO NOT MEET THIS REQUIREMENT, CONTACT THE POS VENDOR FOR INFORMATION ON ADDITIONAL EQUIPMENT THAT CAN BE PURCHASED TO MEET THIS REQUIREMENT. IF THIS REQUIREMENT IS NOT MET, THE POS SYSTEM WARRANTY IS INVALID.
- D. ALL POWER INDICATED ON THIS PLAN MUST HAVE A THIRD WIRE, ISOLATED GROUND, AND BE TERMINATED WITHIN (4) FEET OF THE DEVICE.
- E. IG-5562 RECEPTACLES MUST BE USED FOR ALL POS UNITS. VDU UNITS AND SITE CONTROLLER UNIT (IN OFFICE). LABEL RECEPTACLES "POS ONLY".
- F. LOW VOLTAGE WIRE IS REQUIRED TO BE CATEGORY 5 CABLE RUN IN 1/2" CONDUIT FOR POS EQUIPMENT ONLY, AND MUST BE TERMINATED WITH RJ45 JACKS. ALL POS EQUIPMENT LINES TERMINATE AT THE FRONT COUNTER CHASE.
- G. A 12" MINIMUM SEPARATION MUST BE MAINTAINED BETWEEN LOW VOLTAGE WIRES AND POWER WIRING (TO AVOID ELECTRICAL INTERFERENCE).
- H. BRAND REQUIREMENTS DICTATE THAT A MINIMUM OF THREE CONDUITS BE USED FOR DATA LINES BETWEEN THE OFFICE AND OTHER PARTS OF THE STORE. ONE CONDUIT IS TO BE DEDICATED TO POS WIRING, ONE FOR DIGITAL MENUBOARD DATA LINES, AND ANOTHER FOR NON-POS ITEMS (I.E. SECURITY CAMERAS, DT TIMERS, HEAD SET WIRING).
- I. EXACT # OF RECEPTACLES ON OFFICE MUST BE COORDINATED ON A PROJECT-BY-PROJECT BASIS IN TERMS OF EQUIPMENT LOCATED IN THE OFFICE.
- J. ALL CEILING MOUNTED VDUS TO BE SUSPENDED FROM UNISTRUT BY THREADED ROD W/ WHITE PVC SLEEVE. CONNECT UNISTRUT TO ROOF STRUCTURE. VDU BY POS VENDOR; UNISTRUT & THREADED ROD BY G.C. UNISTRUT TO SUPPORT MINIMUM 50 LB. WEIGHT.
- K. VDU MOUNTING HEIGHTS (TO BOTTOM OF MONITOR) ARE AS FOLLOWS:
 - A. SANDWICH STATION - 68" A.F.F.
 - B. DRIVE THRU - 61" A.F.F.
- L. DIGITAL MENUBOARD PREP WIRING:
 - A. SEE MENU BOARD DATA NOTES THIS SHEET

ROUGH-IN SHEET NOTES:

- 1. ELEVATIONS TO BE USED AS A GUIDE FOR ROUGH-IN ELEVATIONS. THE CONTRACTOR SHALL BE RESPONSIBLE FOR COORDINATING & VERIFYING PROPER ROUGH-INS REQUIRED FOR EACH ITEM.
- 2. THE ELEVATIONS ARE GENERAL IN NATURE AND ARE NOT INTENDED TO BE ALL ENCOMPASSING OR EXHAUSTIVE IN DEPICTING EVERY DEVICE REQUIRED. THE CONTRACTOR SHALL BE RESPONSIBLE FOR COORDINATING WITH FRANCHISEE, EQUIPMENT PLAN, AND ELECTRICAL PLANS FOR ALL DEVICES REQUIRED.
- 3. THE CONTRACTOR SHALL SCHEDULE A ROUGH-IN INSPECTION WITH THE FRANCHISEE, DUNKIN BRANDS CM, AND/OR ARCHITECT PRIOR TO CLOSING IN WALLS.
- 4. THE GC SHALL NOTE ALL EQUIPMENT PLUG/OUTLET TYPE AND CONFIGURATION AND ENSURE THAT ALL EXISTING EQUIPMENT TO BE RELOCATED HAVE THE APPROPRIATE OUTLET WHEN SPECIFICALLY NOTED IN THE DOCUMENTS OR NOT.
- 5. THE ROUGH IN PLAN IS NOT INTENDED TO BE UTILIZED AS AN ENGINEERED DRAWING. THE PLAN HAS BEEN PROVIDED FOR BIDDING PURPOSES AND AS A GENERAL GUIDE ONLY. THE GC SHALL BE RESPONSIBLE FOR OBTAINING TRADE PERMITS NECESSARY TO COMPLETE THE WORK FOR THE STORE AND FULLY FUNCTIONAL STORE.
- 6. THE GC SHALL COORDINATE WITH THE EQUIPMENT SCHEDULE SHEET K-1 FOR OUTLET CONDUIT ON HEIGHTS. EQUIPMENT ELECTRICAL REQUIREMENTS ARE BASED ON EQUIPMENT SHEET INFORMATION. THE GC SHALL COORDINATE TO CONFIRM ALL ELECTRICAL REQUIREMENTS WITH ALL EQUIPMENT PLANS PRIOR TO THE INSTALLATION.
- 7. 120V, 15A AND 20A RECEPTACLES (NEW AND EXISTING) IN KITCHEN AREA SERVICE VENTS SHALL BE "GFCI" PROTECTED IN ACCORDANCE WITH NEC ARTICLE 210.8(B).

ROUGH-IN PLAN KEY NOTES: (G.O.)

- 22.01 NEW FILTRATION SYSTEM - SEE PLUMBING PLANS.
- 22.02 NEW BOOSTER PUMP - SEE PLUMBING PLANS.
- 22.06 FILTERED WATER STUB-UP ROUTED INTO MILLWORK CHASE WALL; SEE DETAILS & PLUMBING PLANS.
- 22.08 DRAIN ISLAND OASIS INDIRECT TO EXISTING FLOOR SINK; SEE DETAILS & PLUMBING PLANS.
- 22.09 DRAIN COFFEE STATION INDIRECT TO OPEN SITE DRAIN; SEE DETAILS & PLUMBING PLANS.
- 22.10 DRAIN ESPRESSO INDIRECT TO OPEN SITE DRAIN; SEE DETAILS & PLUMBING PLANS.
- 22.11 DRAIN ICE MAKER CONDENSATE AND ICE BIN INDIRECT TO OPEN SITE DRAIN; SEE DETAILS & PLUMBING PLANS.
- 22.12 DRAIN RINSE SINK INDIRECT TO OPEN SITE DRAIN; SEE DETAILS AND PLUMBING PLANS.
- 22.14 DRAIN CONDENSATE FROM OVENS INDIRECT TO OPEN SITE DRAIN; SEE PLUMBING PLANS.
- 22.15 DRAIN WATER CHILLER & TAP REFRIGERATOR INDIRECT TO NEW FLOOR SINK; SEE PLUMBING PLANS.
- 22.20 DRAIN EVAP / SPILL TO GRADE.
- 23.04 NEW HVAC CONTROL PANEL. SEE MECHANICAL PLANS.
- 26.05 ELECTRIC & DATA STUB-UP ROUTED INTO MILLWORK CHASE WALL. PROVIDE CONDUIT & PULL STRING FOR NET WORK WIRING. THE CONTRACTOR SHALL BE RESPONSIBLE FOR ACTUAL ROUTING OF CONDUITS. NETWORK CONDUITS SHALL RUN BELOW SLAB TO OFFICE & TURN UP INTO OFFICE WALL. SEE OFFICE R/F ELEVATION FOR HEIGHTS.
- 26.08 PRE CHARGED REMOTE REFRIGERATION SYSTEM - DRAIN CONDENSATE TO EXTERIOR/GRADE.
- 26.13 NEW DRIVE-THRU STACKING & MENU BOARD CAMERA MOUNTED TO EXTERIOR. SEE ELECTRICAL PLANS.
- 26.15 SEE MENU BOARD DATA NOTES.
- 26.16 PROVIDE CONDUIT FROM GROUND LOOP TO 6" ABOVE CEILING - SEE ELECTRICAL PLANS.
- 26.17 WIRELESS HEADSET TRANSMITTER MOUNTED TO WALL/BULKHEAD AS INDICATED. SEE POS/OT STATION DETAIL SHEET FS-2 & ELECTRICAL PLANS.
- 26.18 USB IN CUSTOMER AREA WALL 33" ABOVE FLOOR FINISH, TYP.
- 26.28 RECESSED 3-GANG WALL BOX CENTERED ON MENU BOARDS.
- 26.29 HIGH SPEED INTERNET BY PROVIDER; COORDINATE WITH FRANCHISEE.
- 26.30 MENU BOARD DATA. GC TO PROVIDE BOX AND PLATES.
- 26.31 POWER AND DATA FLOOR OUTLET FOR GRAB-N-GO MERCHANDISER.
- 26.32 JUNCTION BOX IN WALL FOR COMMUNITY TABLE OUTLETS.
- 26.35 POWER AND DATA OUTLETS FOR ORDER KIOSKS.

MENU BOARD DATA NOTES:

- 1. DATA CONNECTION FOR DIGITAL MENU BOARD. CONFIRM REQUIREMENTS AND LOCATION WITH ARCHITECTURAL DRAWINGS.
 - 2. GC /EC TO PROVIDE (2) 1" PVC CONDUITS FOR DATA LINES- LOW VOLTAGE CAT 5 CABLING TO OFFICE.
 - 3. GC /EC TO PROVIDE (1) 1" METAL CONDUITS FOR POWER TO ELECTRICAL PANEL.
 - 4. GC ELECTRICIAN CONTRACTOR (EC) TO COORDINATE WHICH OPTION IS TO BE SELECTED BY FRANCHISEE (FEE) PRIOR TO BIDDING OR PERFORMING WORK. AUTHORITY HAVING JURISDICTION (AHJ) MAY REQUIRE FULL WIRE PREP BY GC/EC. GC TO ALERT CM, FEE, AND DMB INSTALLER (VIA PHONE AND EMAIL) IF GC/EC MUST PERFORM ALL ELECTRICAL INSTALL WORK.
- OPTIONS (GC TO COORDINATE WHICH OPTION IS TO BE SELECTED BY F'EE PRIOR TO BIDDING OR PERFORMING WORK)
- OPTION # A: (SITE PREPARATION VERIFICATION): GC/EC TO PROVIDE ALL CAT 5 CABLING AND FINAL ELECTRICAL CONNECTIONS TO DATA BOXES/PLATES.
 - OPTION # B: (FULL SITE PREPARATION) GC/EC TO PROVIDE PULL STRINGS FROM MENU BOARD SOFFIT TO OFFICE AND MENU BOARD SOFFIT TO ELECTRICAL PANEL BOARD. DMB VENDOR TO PROVIDE ALL CAT 5 CABLING AND ELECTRICAL CONNECTIONS TO DATA BOXES/PLATES.

POS-COMMUNICATIONS EQUIPMENT SCHEDULE

QTY	DESCRIPTION	LOCATION
POS EQUIPMENT		
1	4 POINT OF SALES TERMINAL (POS)	(2) FRONT COUNTERS (1) D/T POS (1) D/T OT
2	3 RECEIPT PRINTER	(2) FRONT COUNTERS (1) D/T POS
3	6 PREP PRINTER	(1) BAKERY (1) ESPRESSO (2) SANDWICH (2) BEVERAGE STATION
4	6 VDU	(2) BEVERAGE STA (2) SANDWICH STA (1) EXPEDITER @ D/T (1) EXPEDITER @ HAND OFF
5	6 VDU CONTROLLER (PC BASED)	POS COFFEE FRONT CHASE
6	1 POS NETWORK HUB/ SWITCH	OFFICE
7	1 PC SITE CONTROLLER EXTERNAL	OFFICE
7a	1 PC SITE CONTROLLER INTERNAL	OFFICE
8	1 PRINTER/FAX/COPIER (B0H)	OFFICE
9	3 SCANNER	(2) FRONT COUNTERS (1) D/T POS
10	3 PRICE CONFIRMATION DISPLAY	MOUNT OUTSIDE @ D/T WINDOW & BEHIND FRONT POS UNITS
11	0 NOT USED	
12	3 CASH DRAWER	UNDER CTR @ FRONT & ADV CTR @ D/T
13	1 COIN DISPENSER	(1) D/T COUNTER
14	3 PAYMENT TERMINAL	(2) FRONT COUNTER (1) D/T POS
14a	3 VERIFONE SWITCH	(1) FRONT COUNTER (1) D/T POS
30	1 ORDER STATUS BOARD	(1) FRONT COUNTER
OTHER COMMUNICATION DEVICES		
15	1 DRIVE THROUGH (DT) TIMER CONSOLE	OFFICE
16	1 DT TIMER VDU DISPLAY	NEAR DT, VISIBLE TO ENTIRE SERVICE AREA
PHONE & DATA LINES		
18	0 SPARE	OFFICE
19A	0 SPARE	OFFICE
20	1 FAX LINE	OFFICE
21	1 PHONE LINE	OFFICE
22	0 NOT USED	
23	1 HIGH SPEED INTERNET LINE (MMS)	OFFICE
24	1 SYSTEM SECURITY DVR	SECURITY STATION
25	8 DIGITAL MENU BOARD	OFFICE/SERVICE AREA
26	1 WIFI	OFFICE
26a	0 SECONDARY WIFI ACCESS POINT (OPTIONAL)	OFFICE
27	0 PHONE	OFFICE

CONDUIT NOTES:

- 1" PVC PROVIDE (8) CAT 5 WIRE PULLS FROM (2) QUAD DATA OUTLETS IN MENU BOARD SOFFIT TO (2) QUAD DATA OUTLETS IN OFFICE WALL.
- 2 CONDUITS MIN SHALL BE USED BETWEEN OFFICE & OTHER PARTS OF THE STORE. 1 CONDUIT FOR POS WIRING ONLY. 1 CONDUIT FOR NON-POS ITEMS.

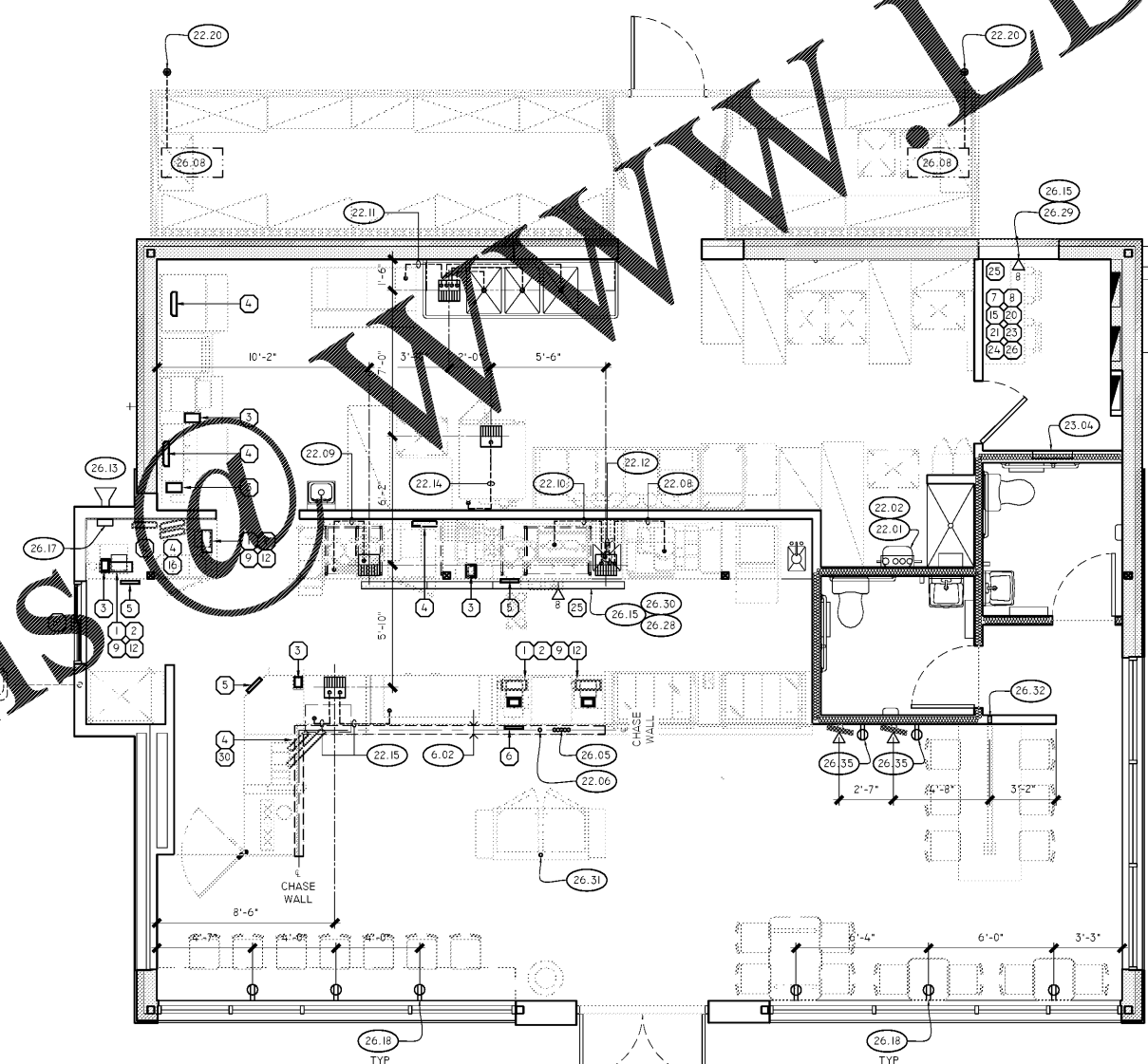

F1 ROUGH-IN PLAN

SCALE: 1/4" = 1'-0"

ARCHITECT OF RECORD
 JAMES D. SMITH, AIA
 522 BAY LN.
 CENTERVILLE, MA 02632

I CERTIFY THAT THESE DOCUMENTS WERE PREPARED OR APPROVED BY ME, AND I AM A SOLELY LICENSED ARCHITECT UNDER THE LAWS OF THE STATE OF TENNESSEE, LICENSE NO. 19897, EXPIRATION DATE 03.31.20



dunkin'
 brands.
 STORE #358032
 US-11W
 BRISTOL, TN

REVISION		
No.	DATE	DESCRIPTION

DWG DATE: 2-1-2019
 DRAWN BY: STAFF
 PROJECT No.: 17182
 DWG TITLE:

ROUGH-IN PLAN

SHEET No.
FS-I