

GENERAL FLOOR PLAN NOTES:

- TYPICAL SUBSTRATES FOR INTERIOR WALLS SHALL BE AS FOLLOWS:
 KITCHEN, OFFICE AND STORAGE AREAS:
 5/8" DUROCK FROM FLOOR TO 3'-0" A.F.F. - 5/8" PLYWOOD FROM 3'-0" A.F.F. TO 6' ABOVE CEILING.
 SERVICE & DRIVE THRU AREAS:
 1/2" DUROCK OVER 5/8" MIN. PLYWOOD ALL AREAS TO RECEIVE TILE FINISH.
 SALES AND SEATING AREAS:
 5/8" GYPSUM BOARD
 RESTROOMS:
 5/8" DUROCK BOARD FROM FLOOR TO TILE FINISH HEIGHT (CONCRETE WITH RR INTERIOR ELEVATIONS). 5/8" G.W.B. FROM TILE FINISH HEIGHT TO 6' ABOVE CEILING.
 GENERAL CONTRACTOR SHALL PROVIDE ADEQUATE LOCKERS IN BATHROOMS FOR GRAB BARS, LAVATORIES, AND TOWERS, DRS., PAPER TOWEL DISPENSERS, SOAP DISPENSERS, AND OTHER ACCESSORIES AS REQUIRED UNLESS OTHERWISE NOTED.
- ALL NEW PARTITIONS SHALL BE 3-5/8" METAL STUD @ 16" O.C. U.N.O.
- RESTROOM IDENTIFICATION SIGN AND HANDICAP ACCESSIBLE SYMBOL AND BRAILLE SUPPLIED WITH STORE FIXTURES PACKAGE. GC TO INSTALL (RESTROOM SIGN FOR WOMEN'S / 1 RESTROOM SIGN FOR MEN'S). RESTROOM SIGNAGE MUST BE MOUNTED SUCH THAT THE LOWEST BRAILLE CHARACTER IS 48" MINIMUM AFF. AND THE HIGHEST BRAILLE CHARACTER IS 60" MAXIMUM AFF. IN ALL CASES, THE SIDE OF DOOR.
- ALL INTERIOR DIMENSIONS SHOWN ARE FROM FACE OF SUBSTRATE TO FACE OF SUBSTRATE.
- SPACE FOR BOOSTER PUMP BY MANUFACTURER (MCCANN'S ENGINEERING & MANUFACTURING #16-1451, 19-1/4"W X 16"D X 14"H); SUPPLIED/ INSTALLED BY G.C.
- PROVIDE FIRE EXTINGUISHERS, TYPE ABC, WALL HUNG, TOP AT 5'-0" A.F.F. BY G.C.)
 -NUMBER AND LOCATION AS DETERMINED BY LOCAL CODE
- PROVIDE WINDOW SHADES AT GLAZING AS INDICATED ON PLANS. SEE SPECIFICATIONS.
- EQUIPMENT/CASEWORK SUPPLIER TO PLACE ALL NEW EQUIPMENT AND CASEWORK.
- G.C. TO MAKE FINAL MECHANICAL, ELECTRICAL & PLUMBING CONNECTIONS FOR ALL EQUIPMENT AS INDICATED ON PLANS.

FLOOR PLAN KEY NOTES: (0.0)

- CONCRETE WALK-IN BOX SLAB - SEE STRUCTURAL PLANS.
- INFILL EXISTING OPENING - MATCH EXISTING MATERIALS FOR FLUSH FINISH @ INTERIOR & EXTERIOR. PROVIDE INSULATION TO MATCH EXISTING AT NEW INFILL AREAS.
- PROVIDE NEW BOLLARDS AS INDICATED - SEE DETAIL SHEET AS-2.
- NEW MILLWORK PROVIDED BY MILLWORK VENDOR; COORDINATE WITH FIELD SEEKER FOR ALL HOLD TO DIMENSIONS.
- DASHED LINE OF FRONT SERVICE LINE MILLWORK CHASE WALL PROVIDED BY MILLWORK VENDOR
- PROVIDE 3 1/2" SOUND ATTENUATION BATT AT ALL RESTROOM WALLS AS INDICATED ON PLAN.
- DRIVE THRU WINDOW AS SCHEDULED - SEE DETAILS AND NATIONAL ACCOUNTS.
- PROVIDE 'D' DOOR PULL ON EACH LEAF OF THE EXTERIOR ENTRY STOREFRONT DOORS AS INDICATED - SEE DOOR AND HARDWARE SCHEDULE AND NATIONAL ACCOUNTS.
- COAT RACK PROVIDED BY THE GC.
- NEW RESTROOM ACCESSORIES EACH RESTROOM; SEE RESTROOM ACCESSORIES PLAN SHEET A-5.
- NEW FILTRATION SYSTEM. SEE PLUMBING PLANS.
- NEW BOOSTER PUMP. SEE PLUMBING PLANS.
- NEW HVAC CONTROL PANEL. SEE MECHANICAL PLANS.

I CERTIFY THAT THESE DOCUMENTS WERE PREPARED OR APPROVED BY ME, AND I AM A SOLELY LICENSED ARCHITECT UNDER THE LAWS OF THE STATE OF TENNESSEE, LICENSE NO. 19897, EXPIRATION DATE 03.31.20

DUNKIN'

dunkin'
 brands.
 STORE #358032
 US-11W
 BRISTOL, TN

REVISION		
No.	DATE	DESCRIPTION

DWG DATE: 2-1-2019
 DRAWN BY: STAFF
 PROJECT No.: 17182
 DWG TITLE:

FLOOR PLAN

SHEET No.
A-1

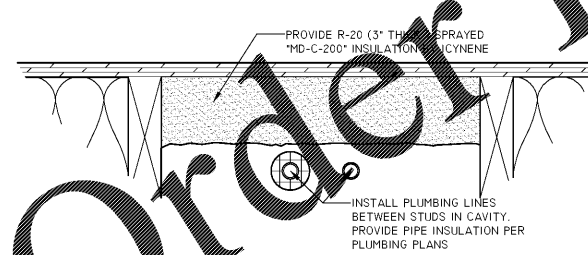
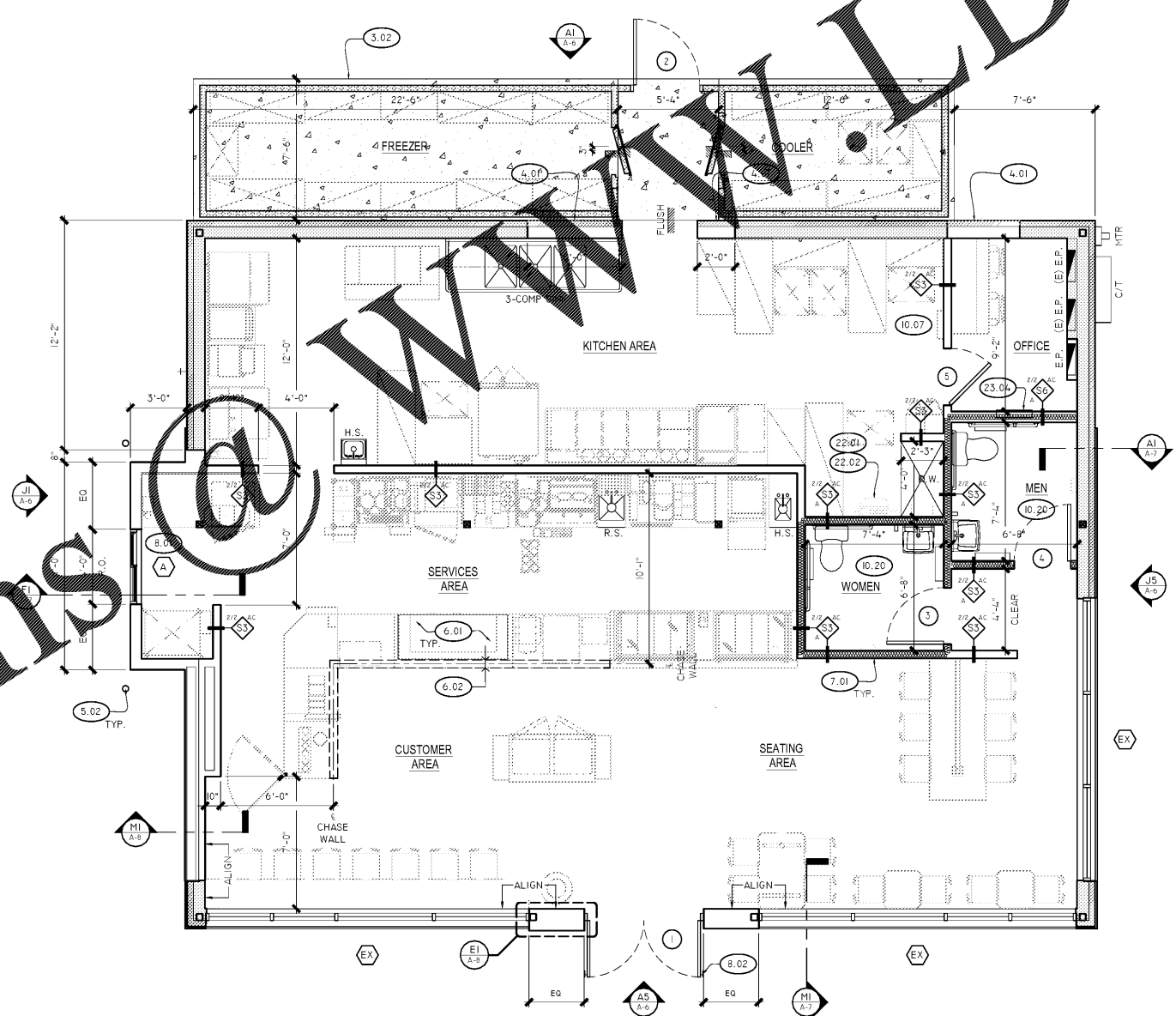

A1 PLUMBING IN EXT. WALL DETAIL

SCALE: 3" = 1'-0"

F1 FLOOR PLAN

SCALE: 1/4" = 1'-0"

Order Plans @ www.wildbuilding.com