

PARKER'S CANE BAY

THE PARKER COMPANIES  
17 WEST McDONOUGH ST.  
SAVANNAH, GA 31401

**Parkers**

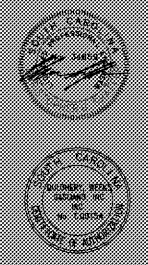

Revisions

NO.	DATE	REVISION

FIRST FLOOR PLAN LIGHTING

Scale: 1/4" = 1'-0"  
 Date: 1/21/19  
 Project: P-18  
 Drawing: E101

E101



FIRST FLOOR PLAN LIGHTING 1/4" = 1'-0"

2/1/2019 9:21:11 AM

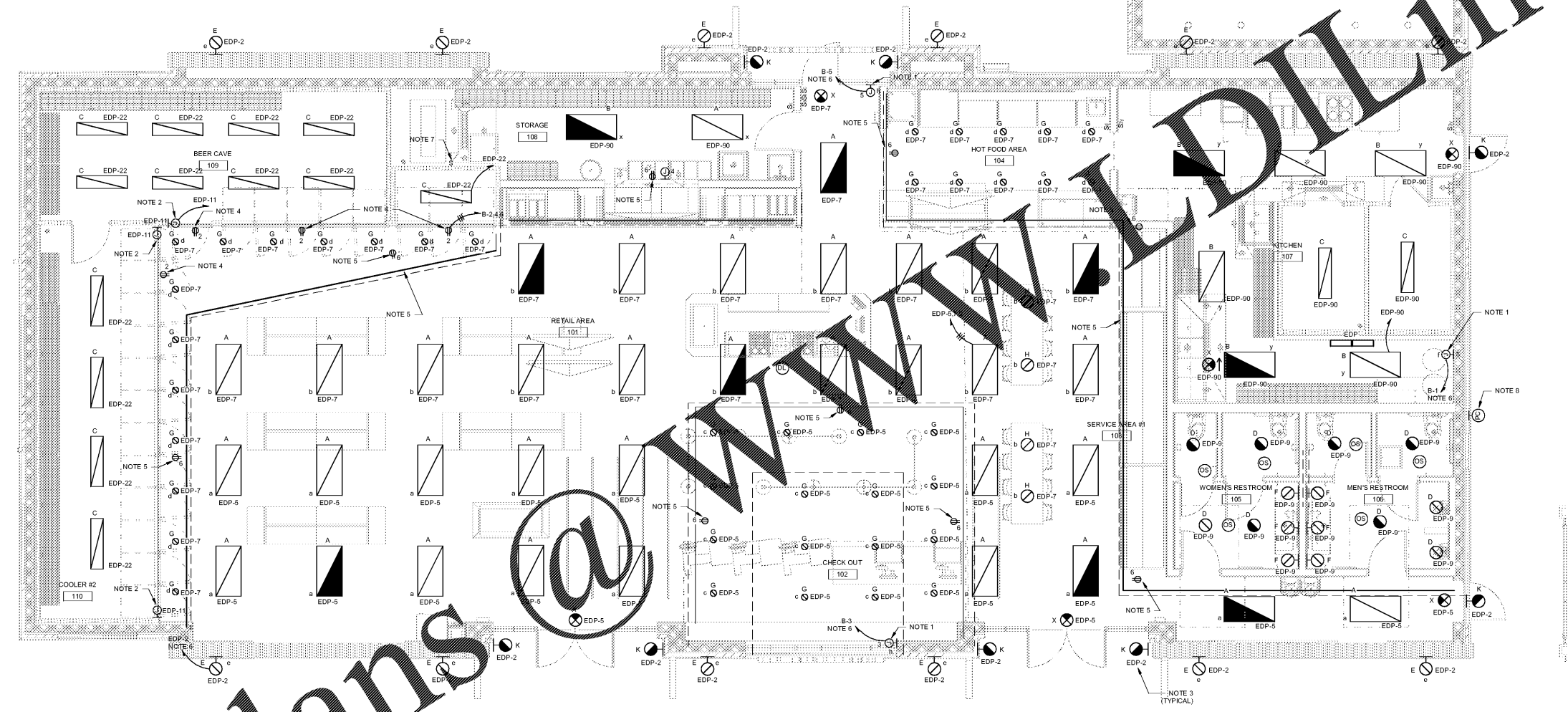

NOTES:

- FOR EXTERIOR ILLUMINATED SIGNS, ROUTE THROUGH SIGN RACEWAY. COORDINATE EXACT MOUNTING HEIGHT AND LOCATION WITH SIGN INSTALLER.
- FOR LED LIGHTS FINISHED WITH DOORS, COORDINATE EXACT CONNECTION LOCATION WITH EQUIPMENT MANUFACTURER.
- COORDINATE EXTERIOR LIGHT FIXTURE MOUNTING HEIGHTS WITH ARCHITECT'S FINAL ELEVATIONS.
- COORDINATE EXTERIOR LIGHT RECEPTACLE ABOVE FINGER SOFFIT DIRECTLY ABOVE SIGN.
- PROVIDE COVE LIGHT. PROVIDE RECEPTABLES IN FINGER SOFFIT FOR POWER SUPPLIES TO TAPE LIGHT PROVIDED BY OWNER. COORDINATE LOCATION OF RECEPTABLES WITH TAPE LIGHT POWER SUPPLY LOCATIONS. CONNECT TO B-6.
- ROUTE VIA EXTERIOR LIGHTING CONTACTOR PANEL FOR PHOTO-ONPHOTO-OFF.
- PROVIDE (3) TYPE "L" FIXTURES AND A 20A DUPLEX RECEPTACLE (CONNECT TO CIRCUIT A-30) ABOVE BEER CAVE AND COOLERS #1 AND #2. CONTRACTOR TO PROVIDE SWITCH FOR LIGHTING FIXTURES ADJACENT TO ACCESS PANEL.
- PHOTOCCELL FOR EXTERIOR LIGHTING AND LIGHTING CONTACTOR PANEL.

Order Plans @

WWW.LDLINE.COM