

A S303
3/4" - 1'-0"
TYPICAL CMU HORIZONTAL REINFORCEMENT

B S303
3/4" - 1'-0"
CMU LINTEL SCHEDULE

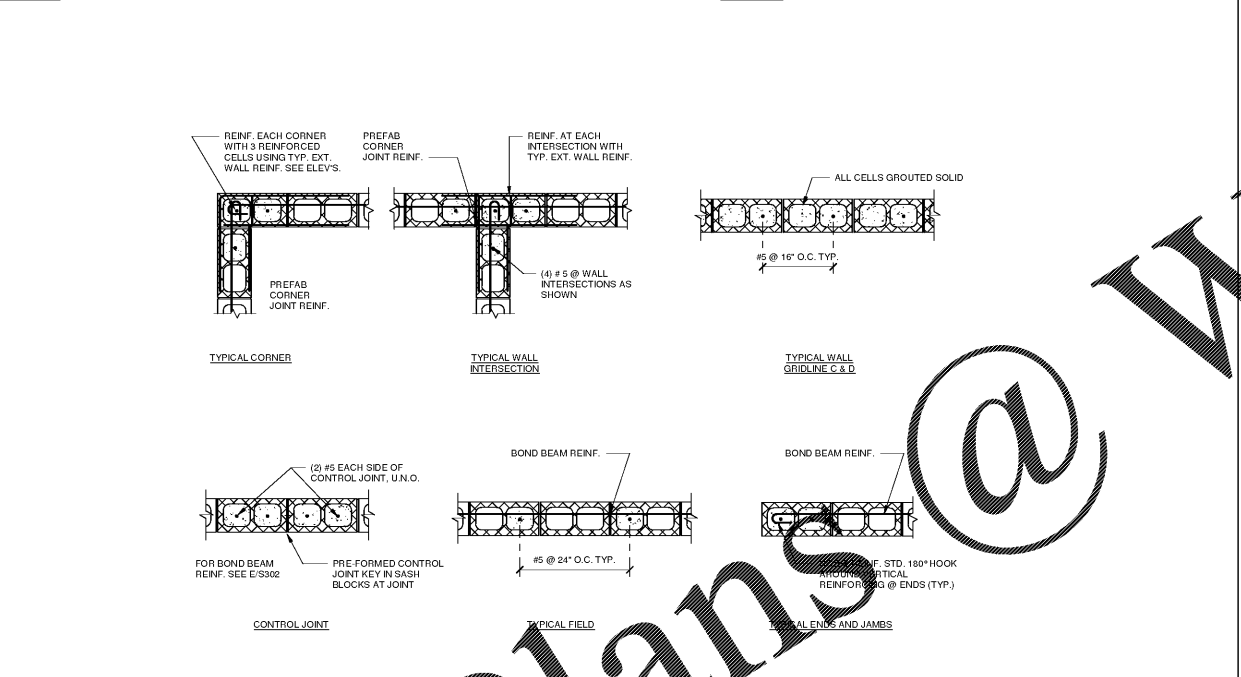

C S303
3/4" - 1'-0"
TYPICAL CMU WALL END & CORNERS

D S303
3/4" - 1'-0"
CMU CONTROL JOINT AT BOND BEAMS

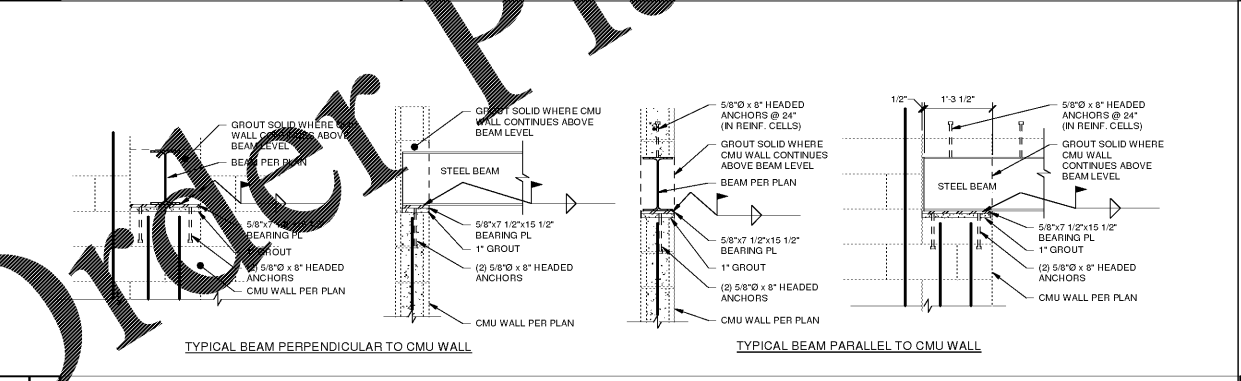

E S303
1/2" - 1'-0"
WF BEAM BEARING ON CMU CONDITIONS

F S303
1/2" - 1'-0"
JOIST BEARING ON PLATE DETAIL

LYNCH
ARCHITECTS
449 East Lake Street
Savannah, GA 31401
Tel: 912.233.1176
Fax: 912.233.5119
www.lyncharchitects.com

PARKER'S CANE BAY
THE PARKER COMPANIES
17 WEST MIDGONQUHIST
DAYTONA BEACH, FL 32114

Parkers

Revisions

NO.	DATE	DESCRIPTION

MASONRY DETAILS

DATE: 2/1/2019
DRAWN BY: [Signature]
CHECKED BY: [Signature]
SCALE: 1/8" = 1'-0"

THARPE
ENGINEERING GROUP
321 W. Congress St. | Suite 301-C | Savannah, GA 31401
912.232.7653 | www.tharpeengineering.com

S303

2/1/2019 9:39:57 AM