

- NOTES:**
- TREE STAKING OPTIONAL, HOWEVER, LANDSCAPE CONTRACTOR RESPONSIBLE FOR MAINTAINING TREES IN AN UPRIGHT (90 DEGREE/ PERPENDICULAR) POSITION FOR 1 YEAR AFTER PLANTING IS COMPLETE OR UNTIL TREE ROOT SYSTEM IS FULLY ESTABLISHED AND STURDY. FINAL TREE STAKING DETAILS AND PLACEMENT TO BE APPROVED BY OWNER'S REPRESENTATIVE.
 - CONTRACTOR SHALL ASSURE PERCOLATION OF ALL PLANTING PITS PRIOR TO INSTALLATION.
 - IN SEMI-IMPERVIOUS SOIL CONDITIONS, ROOTBALL ELEVATION SHALL BE 2" ABOVE FINISH GRADE. COORDINATE WITH OWNER'S REPRESENTATIVE PRIOR TO SETTING ROOTBALL ELEVATIONS.

1 // L2 TREE PLANTING
SCALE: N.T.S.

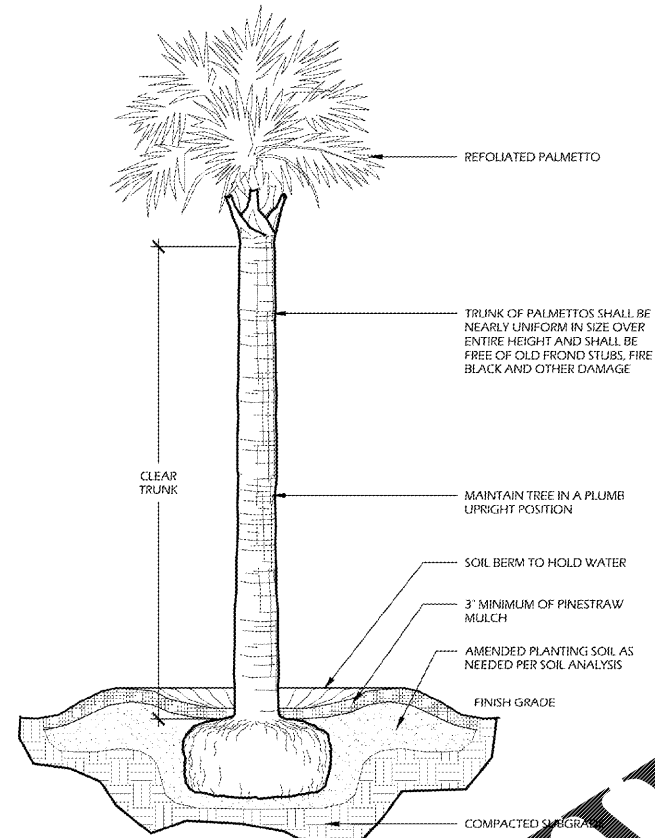

- NOTES:**
- FINAL TREE STAKING DETAILS AND PLACEMENT TO BE APPROVED BY OWNER OR OWNER'S REPRESENTATIVE.
 - CONTRACTOR SHALL ASSURE PERCOLATION OF ALL PLANTING PITS PRIOR TO INSTALLATION.
 - SABAL PALMETTOS SHALL BE REFOOLIATED, PROTECT CABBAGE HEAD FROM DAMAGE.

2 // L2 PALM TREE PLANTING
SCALE: N.T.S.

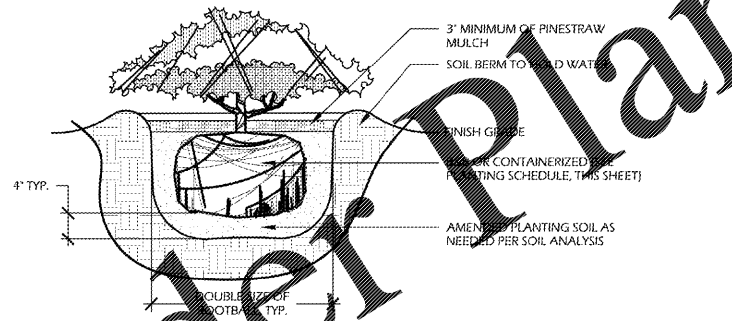

- NOTES:**
- WHEN GROUND COVER AND SHRUBS ARE USED IN BEDS, ENTIRE BED TO BE EXCAVATED TO RECEIVE PLANTING SOIL AND PLANT MATERIAL.
 - CONTRACTOR SHALL ASSURE PERCOLATION OF ALL PLANTING PITS PRIOR TO INSTALLATION.
 - IN SEMI-IMPERVIOUS SOIL CONDITIONS, ROOTBALL ELEVATION SHALL BE 2" ABOVE FINISH GRADE. COORDINATE WITH OWNER'S REPRESENTATIVE PRIOR TO SETTING ROOTBALL ELEVATIONS.

3 // L2 SHRUB PLANTING
SCALE: N.T.S.

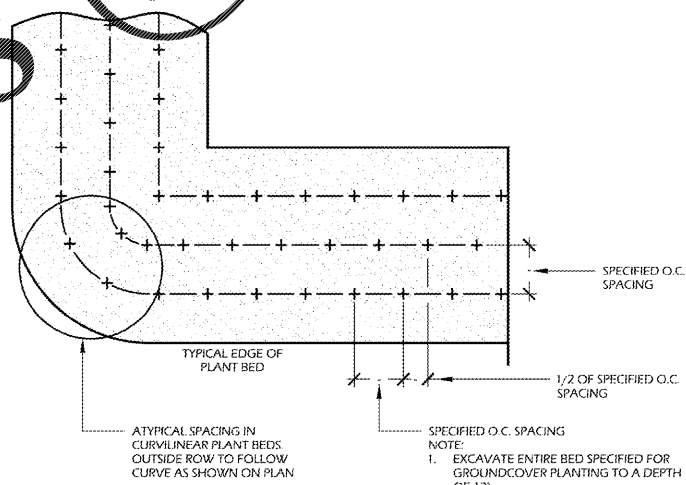

4 // L2 GROUND COVER PLANTING
SCALE: N.T.S.

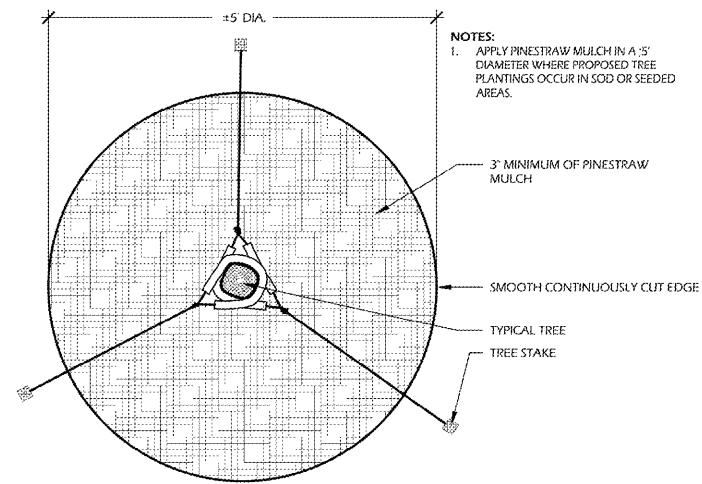

5 // L2 TREE STAKING
SCALE: N.T.S.

SITE DEVELOPMENT PLANS
FOR
PARKERS CONVENIENCE STORE
STATE ROAD (U.S. HWY 176) AND CANE BAY BLVD.
SUMMERVILLE, SOUTH CAROLINA

DATE: JAN. 23, 2019
PROJECT NO.: 1551.21
DRAWN BY: CB
CHECKED BY: DK

SUBMITTAL PLAN,
NOT FOR
CONSTRUCTION

REVISIONS:

DRAWING TITLE
PLANT DETAILS

DRAWING NUMBER

L3 OF 3

© 2018 WJK LTD.
DESIGN CONCEPTS, DRAWING SHEETS,
LOGOS, SPECIFICATIONS, DETAILS,
WRITTEN MATERIAL SHALL NOT BE USED
OR REPRODUCED IN WHOLE OR IN PART
BY ANY FORM WITHOUT PRIOR WRITTEN
CONSENT OF WJK LTD.
THIS SHEET TO SCALE AT: 1/4"=1'-0"

WJK Landscape Architecture
landscape architecture
and planning
www.wjk.com
288 Fremont Blvd., Suite 2031, Raleigh, North Carolina 27601, Tel: 919.289.7242