

PLANT SCHEDULE

Quantity	Abbrev	Botanical Name	Common Name	Height	Spread	Container	Cal/Spacing	Notes
3	ULMP	Ulmus parvifolius	European Elm	-	-	Cont	2.5' cal. min.	Full
2	JUNC	Juniperus chinensis 'Spectra'	Chinese Juniper	30"	15"-18"	3 gal.	-	Full
1	LIGJ2	Ligustrum japonicum	Japanese Privet	4'-6"	3'-4"	30 gal.	-	Tree form
23	LORC	Lonicera chinensis 'Shirley'	Purple Hearted Fringe	30"-36"	12"-18"	7 gal.	-	-
88	PODP	Podocarpus macrophyllus	Podocarpus	12"-15"	15"-18"	3 gal.	-	-
400 sf	ANNL	Grass/Color	Grass/Color	4'-6"	4'-6"	-	12" O.C.	-
2400 sf	SOD	Grass/Color	Empire Zoysia	-	-	-	-	-
2700 sf	MULCH	Mulch	Mulch	-	-	-	-	Mulch type to be approved by Owner (mulch all plant beds and disturbed areas)

LANDSCAPE BUFFER SUMMARY

CANE BAY BLVD - TYPE A BUFFER	REQUIRED	PROPOSED
3 CANOPY TREES PER 100 LINEAR FEET (±219 LF)	7	EXISTING TREES IN BUFFER
4 UNDERSTORY TREES PER 100 LINEAR FEET (±219 LF)	9	EXISTING TREES IN BUFFER
20 SHRUBS PER 100 LINEAR FEET (±219 LF)	44	EXISTING SHRUBS IN BUFFER

NOTE: BERKELEY COUNTY PLANNING AND ZONING DEPARTMENT RESERVES THE RIGHT TO INSPECT BUFFER PLANTINGS AND MAY REQUIRE ADDITIONAL PLANTINGS PRIOR TO C.D. ISSUANCE TO ENSURE ADEQUATE BUFFERING IS IN PLACE.

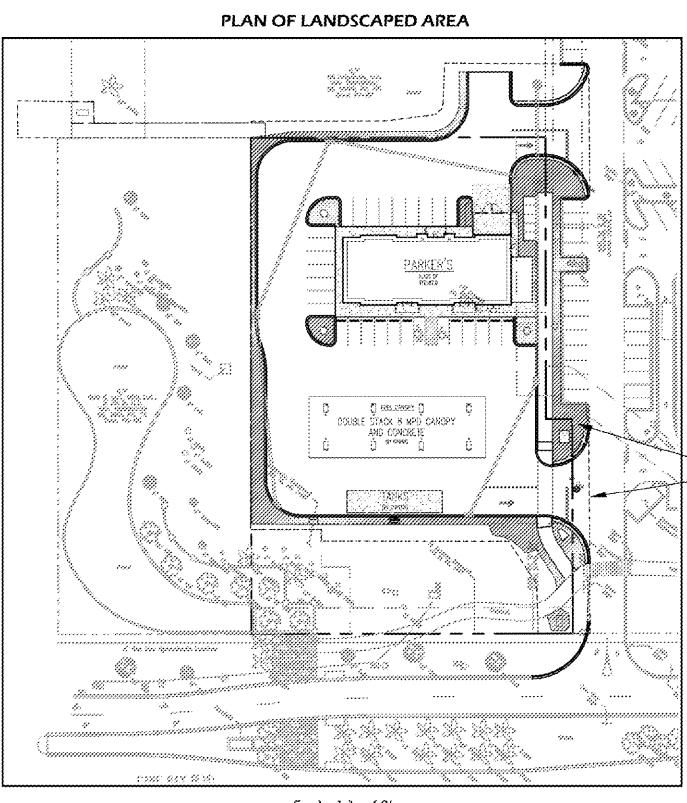

LANDSCAPE DEVELOPMENT SUMMARY

DEVELOPED AREA	72,016 SF
10% OF AREA TO BE LANDSCAPED (REQUIRED)	7,202 SF
AREA OF LANDSCAPE PROPOSED (shown in red on plan at left)	8,351 SF

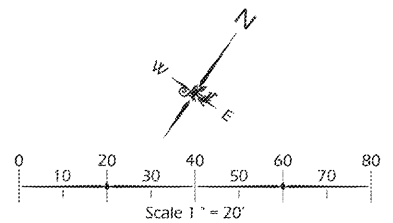

SITE DEVELOPMENT PLANS FOR
PARKERS CONVENIENCE STORE
 STATE ROAD (U.S. HWY 176) AND CANE BAY BLVD.
 SUMMERVILLE, SOUTH CAROLINA

DATE: JAN. 23, 2019
 PROJECT NO.: 1551.21
 DRAWN BY: CB
 CHECKED BY: DK

SUBMITTAL PLAN,
 NOT FOR
 CONSTRUCTION

REVISIONS:

DRAWING TITLE
 PLANTING PLAN

DRAWING NUMBER

L2 OF 3

© 2018 WJK LTD.
 DESIGN CONCEPTS, DRAWINGS, SHEETS, LOGOS, SPECIFICATIONS, DETAILS, WRITTEN MATERIAL SHALL NOT BE REPRODUCED OR REPRODUCED IN ANY FORM WITHOUT PRIOR WRITTEN CONSENT OF WJK LTD.
 THIS SHEET TO SCALE AT .24X36"

WJK
 WJK Landscape Architecture
 408 Phoenician Street, Suite 101, Florence, South Carolina 29501, Tel: 803.799.7943
 www.wjkllc.com