

NO.	DATE	BY	REVISION



PREMIER KINGS, INC.
 5529 CARMICHAEL ROAD
 MONTGOMERY, ALABAMA 36117
 PHONE: (205) 836-1111
 LINDSEY@BKALABAMA.COM

2126 Morris Avenue
 Birmingham, AL 35203
 Phone (205) 322-1751
 Fax (205) 322-1778
 Email info@hplusha.com
 www.hplusha.com



architecture . planning . interior design

Utility Plan

PROJECT # 18026.02
 FCC-60 TALL 00/20 MAKE NOVEMBER 2018 DESIGN RELEASE
BURGER KING RESTAURANT
 STREET ADDRESS
 HARPERSVILLE, AL

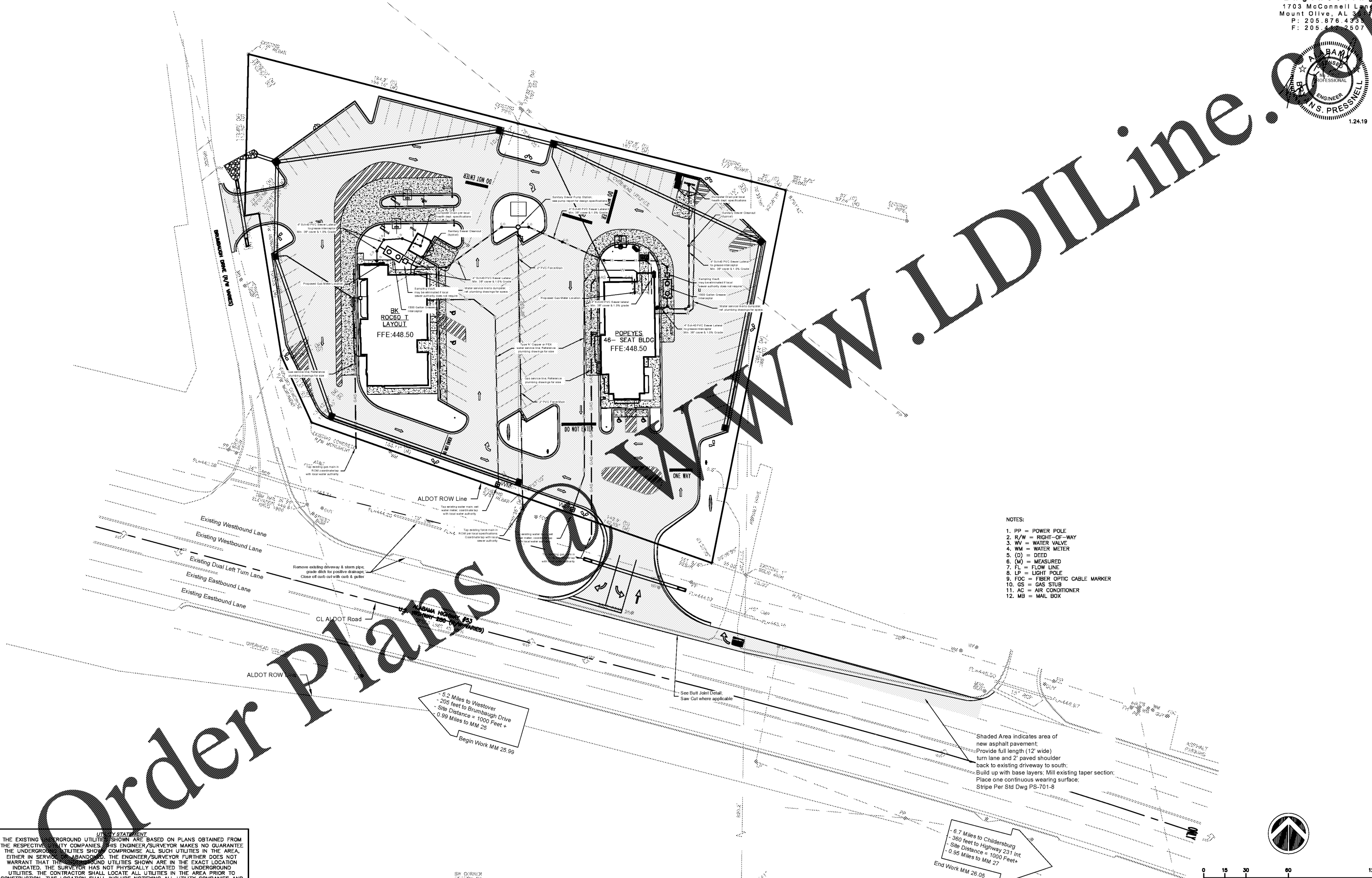

- NOTES:
1. PP = POWER POLE
 2. R/W = RIGHT-OF-WAY
 3. WV = WATER VALVE
 4. WM = WATER METER
 5. (D) = DEED
 6. (M) = MEASURED
 7. FL = FLOW LINE
 8. LP = LIGHT POLE
 9. FOC = FIBER OPTIC CABLE MARKER
 10. GS = GAS STUB
 11. AC = AIR CONDITIONER
 12. MB = MAIL BOX

Shaded Area indicates area of new asphalt pavement:
 - Provide full length (12' wide) turn lane and 2' paved shoulder back to existing driveway to south;
 - Build up with base layers; Mill existing taper section;
 - Place one continuous wearing surface;
 - Stripe Per Std Dwg PS-701-8

- 6.7 Miles to Childersburg
 - 360 Feet to Highway 231 Int.
 - Site Distance = 1000 Feet +
 - 0.95 Miles to MM 27

- 5.2 Miles to Westover
 - 205 feet to Brumbaugh Drive
 - Site Distance = 1000 Feet +
 - 0.99 Miles to MM 25
 - Begin Work MM 25.99

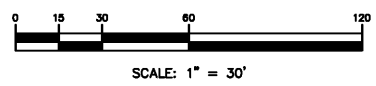

UTILITY STATEMENT
 THE EXISTING UNDERGROUND UTILITIES SHOWN ARE BASED ON PLANS OBTAINED FROM THE RESPECTIVE UTILITY COMPANIES. THIS ENGINEER/SURVEYOR MAKES NO GUARANTEE EITHER IN SERVICE OR ABANDONED. THE ENGINEER/SURVEYOR FURTHER DOES NOT WARRANT THAT THE UNDERGROUND UTILITIES SHOWN ARE IN THE EXACT LOCATION INDICATED. THE SURVEYOR HAS NOT PHYSICALLY LOCATED THE UNDERGROUND UTILITIES. THE CONTRACTOR SHALL LOCATE ALL UTILITIES IN THE AREA PRIOR TO CONSTRUCTION. THIS LOCATION SHALL INCLUDE NOTIFYING ALL UTILITY COMPANIES AND ALABAMA ONE CALL AT 1-800-292-8525. THIS MAY ALSO REQUIRE EXPLORATORY HAND EXCAVATION TO DETERMINE THE EXACT LOCATION OF THE UTILITIES.

Order Plans

WWW.LDILine.com