

**WILSON AIR CENTER  
NORTH TERMINAL**

HCDT  
CHARLOTTE-DORRIS  
INTERNATIONAL AIRPORT  
5327 WOODS FIELD DRIVE  
CHARLOTTE, NC 28203

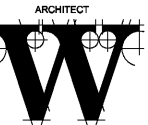

**THE WILSON GROUP  
ARCHITECTS**

PO BOX 5510 CHARLOTTE, NC 28209  
704-331-6747 • www.wgarchitects.com

CIVIL ENGINEER  
**TALBERT, BRIGHT &  
ELLINGTON**  
3525 WHITEHALL PARK DRIVE, SUITE 210  
CHARLOTTE, NC 28273  
(704) 425-8070 FIRM NO.: C-1183

STRUCTURAL ENGINEER  
**STEWART**  
101 N. TRYON ST., SUITE 1400  
CHARLOTTE, NC 28202  
(704) 389-3523 FIRM NO.: C-1051

MECHANICAL, ELECTRICAL, PLUMBING &  
FIRE PROTECTION ENGINEER  
**SABER ENGINEERING**  
2923 S. TRYON ST., SUITE 200  
CHARLOTTE, NC 28203  
(704) 373-0068 FIRM NO.: C-2130

LANDSCAPE ARCHITECT  
**URBAN DESIGN  
PARTNERS**  
1315-EB CENTRAL AVENUE  
CHARLOTTE, NC 28205  
(704) 334-3303 FIRM NO.: C-TBD

COMMUNICATIONS INFRASTRUCTURE  
**DB CONSULTING**  
246 LOVEB FARM ROAD  
BLACKSBURG, SC 29702  
(704) 497-7228 FIRM NO.: C-TBD

REVISIONS

DATE DECEMBER 7, 2018  
PROJECT NUMBER 9197-000

SHEET TITLE  
**ENLARGED  
LEVEL 1  
EQUIPMENT  
FLOOR PLAN**

SHEET NUMBER  
**A-452**

EQUIP. LEGEND	
SPEC. NO.	DESIGNATION
XXXXXX   XXXXXX	

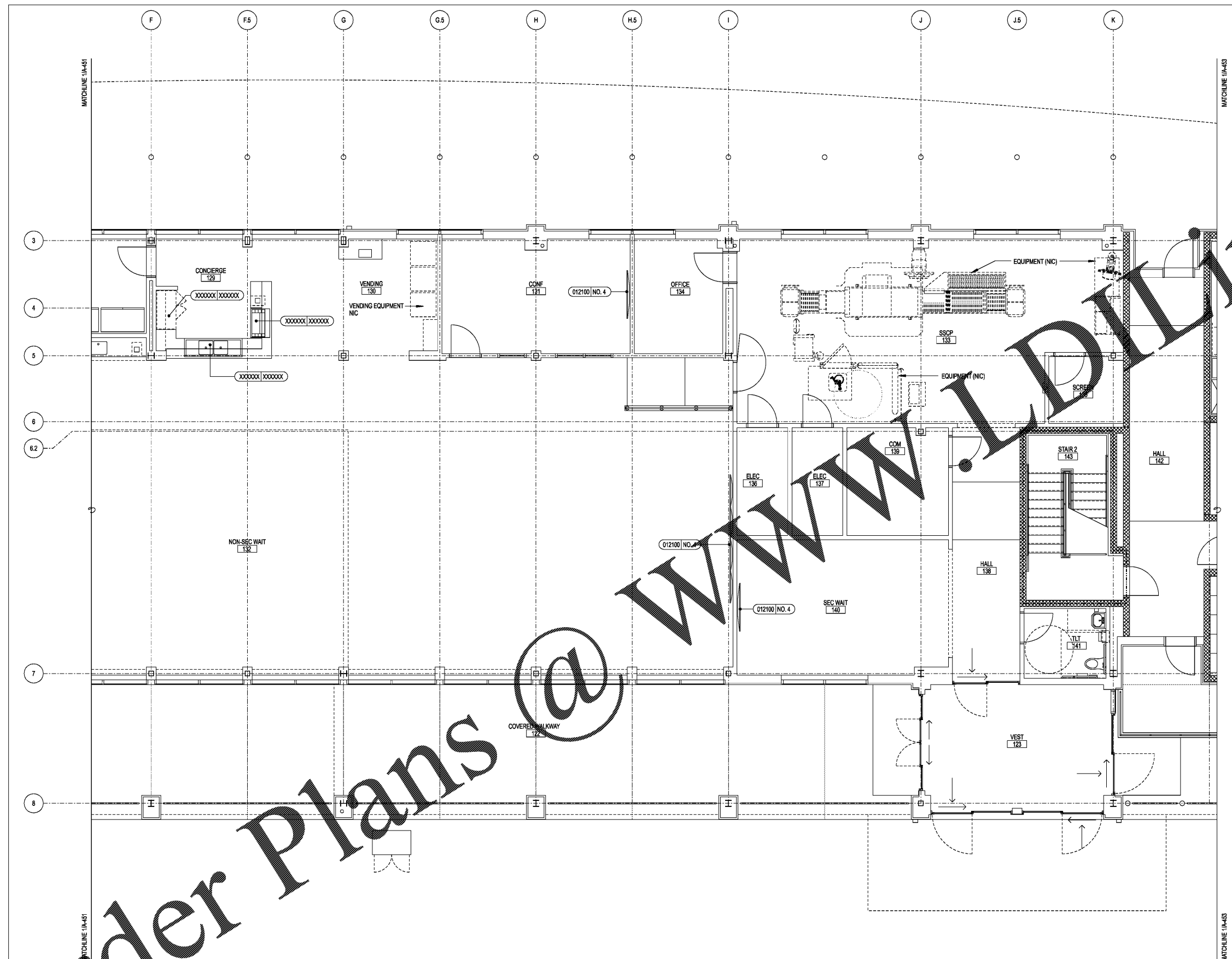

Order Plans @ [www.LDOnline.com](http://www.LDOnline.com)