

THE WILSON GROUP ARCHITECTS

PO BOX 5510 CHARLOTTE, NC 28209  
704-331-8747 • www.twgarchitects.com

CIVIL ENGINEER  
**TALBERT, BRIGHT & ELLINGTON**  
3525 WHITEHALL PARK DRIVE, SUITE 210  
CHARLOTTE, NC 28273  
(704) 425-8070 FIRM NO.: C-1183

STRUCTURAL ENGINEER  
**STEWART**  
101 N. TRYON ST., SUITE 1400  
CHARLOTTE, NC 28202  
(704) 389-3523 FIRM NO.: C-1051

MECHANICAL, ELECTRICAL, PLUMBING & FIRE PROTECTION ENGINEER  
**SABER ENGINEERING**  
2923 S. TRYON ST., SUITE 280  
CHARLOTTE, NC 28203  
(704) 373-0068 FIRM NO.: C-2130

LANDSCAPE ARCHITECT  
**URBAN DESIGN PARTNERS**  
1315-EE CENTRAL AVENUE  
CHARLOTTE, NC 28205  
(704) 334-3303 FIRM NO. C-TBD

COMMUNICATIONS INFRASTRUCTURE  
**DB CONSULTING**  
246 LOVEB FARM ROAD  
BLACKSBURG, SC 29702  
(704) 497-7228 FIRM NO. C-TBD

REVISIONS

DATE DECEMBER 7, 2018  
PROJECT NUMBER 9197-000

SHEET TITLE  
**ENLARGED LEVEL 2 FINISH FLOOR PLAN**

SHEET NUMBER  
**A-446**

FINISH FLOOR PLAN LEGEND			
CPT-1		TR-1	
CPT-2		TR-2	
CPT-3		LVT-1	
EPX-1		SDT-1	

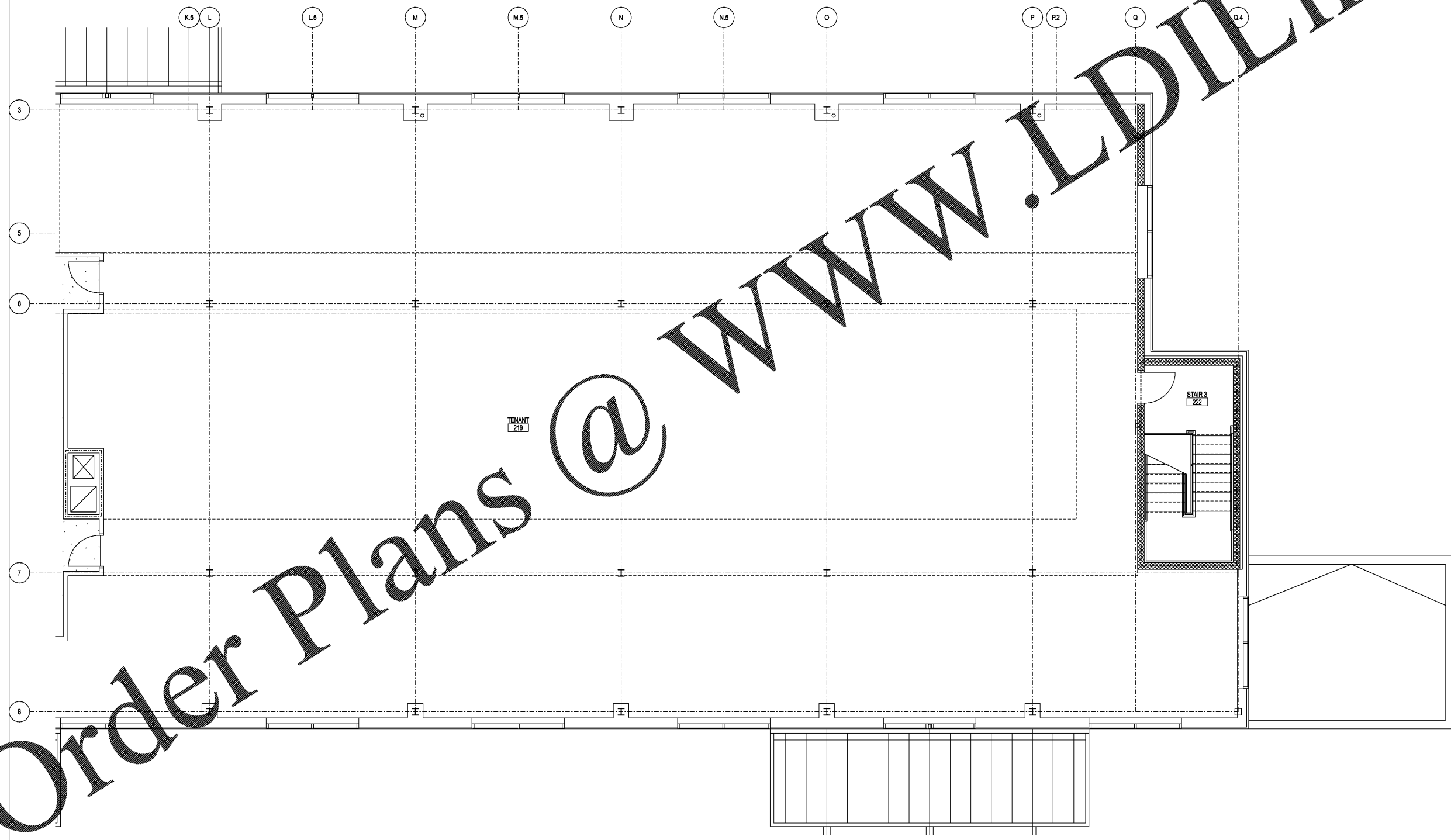

1/4"=1'-0"

Order Plans @ www.LDILine.com