

**WILSON AIR CENTER**

**NORTH TERMINAL**

HCDT  
 CHARLOTTE-DORRIS  
 INTERNATIONAL AIRPORT  
 5327 MERRIS FIELD DRIVE  
 CHARLOTTE, NC 28203



**THE WILSON GROUP**  
 ARCHITECTS

PO BOX 5510 CHARLOTTE, NC 28209  
 704-331-8747 • www.twgarchitects.com

CIVIL ENGINEER  
**TALBERT, BRIGHT & ELLINGTON**

3525 WHITEHALL PARK DRIVE, SUITE 210  
 CHARLOTTE, NC 28273  
 (704) 425-8070 FIRM NO.: C-1183

STRUCTURAL ENGINEER  
**STEWART**

101 N. TRYON ST., SUITE 1400  
 CHARLOTTE, NC 28202  
 (704) 389-3523 FIRM NO.: C-1051

MECHANICAL, ELECTRICAL, PLUMBING &  
 FIRE PROTECTION ENGINEER  
**SABER ENGINEERING**

2923 S. TRYON ST., SUITE 280  
 CHARLOTTE, NC 28203  
 (704) 373-0068 FIRM NO.: C-2130

LANDSCAPE ARCHITECT  
**URBAN DESIGN PARTNERS**

1315-EE CENTRAL AVENUE  
 CHARLOTTE, NC 28205  
 (704) 334-3303 FIRM NO. C-TBD

COMMUNICATIONS INFRASTRUCTURE  
**DB CONSULTING**

246 LOVES FARM ROAD  
 BLACKSBURG, SC 29702  
 (704) 497-7228 FIRM NO. C-TBD

REVISIONS

DATE DECEMBER 7, 2018  
 PROJECT NUMBER 9197-000

SHEET TITLE  
**ENLARGED  
 LEVEL 2  
 FINISH  
 FLOOR PLAN**

SHEET NUMBER  
**A-444**



CPT-1	[Pattern]	TR-1	[Pattern]
CPT-2	[Pattern]	TR-2	[Pattern]
CPT-3	[Pattern]	LVT-1	[Pattern]
EPX-1	[Pattern]	SOT-1	[Pattern]

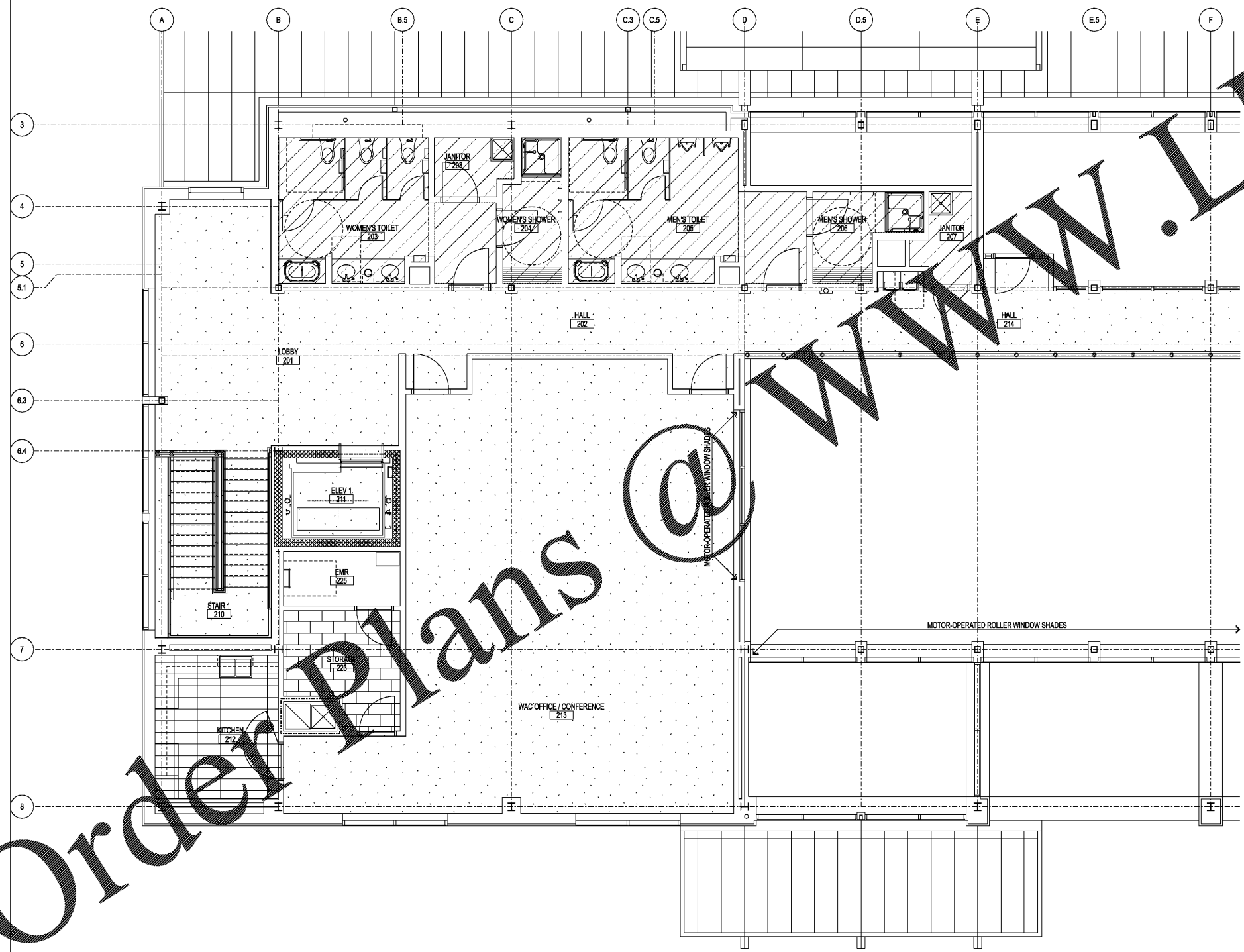

Order Plans @