

THE WILSON GROUP ARCHITECTS

PO BOX 5510 CHARLOTTE, NC 28299
704-331-8747 • www.wilsongroup.com

CIVIL ENGINEER
TALBERT, BRIGHT & ELLINGTON

3525 WHITEHALL PARK DRIVE, SUITE 210
CHARLOTTE, NC 28273
(704) 425-8070 FIRM NO.: C-1183

STRUCTURAL ENGINEER
STEWART

101 N. TRYON ST., SUITE 1400
CHARLOTTE, NC 28202
(704) 889-3523 FIRM NO.: C-1051

MECHANICAL, ELECTRICAL, PLUMBING & FIRE PROTECTION ENGINEER
SABER ENGINEERING

2923 S. TRYON ST., SUITE 280
CHARLOTTE, NC 28203
(704) 373-0088 FIRM NO.: C-2130

LANDSCAPE ARCHITECT
URBAN DESIGN PARTNERS

1315-BB CENTRAL AVENUE
CHARLOTTE, NC 28205
(704) 334-3303 FIRM NO. C-TBD

COMMUNICATIONS INFRASTRUCTURE
DB CONSULTING

248 LOVES FARM ROAD
BLACKSBURG, SC 29702
(704) 497-7228 FIRM NO. C-TBD

REVISIONS

DATE DECEMBER 7, 2018
PROJECT NUMBER 9197-000

SHEET TITLE
ENLARGED
LEVEL 1
FINISH
FLOOR PLAN

SHEET NUMBER
A-443

FINISH FLOOR PLAN LEGEND			
CPT-1	[Pattern]	TR-1	[Pattern]
CPT-2	[Pattern]	TR-2	[Pattern]
CPT-3	[Pattern]	LVT-1	[Pattern]
EPX-1	[Pattern]	SOT-1	[Pattern]

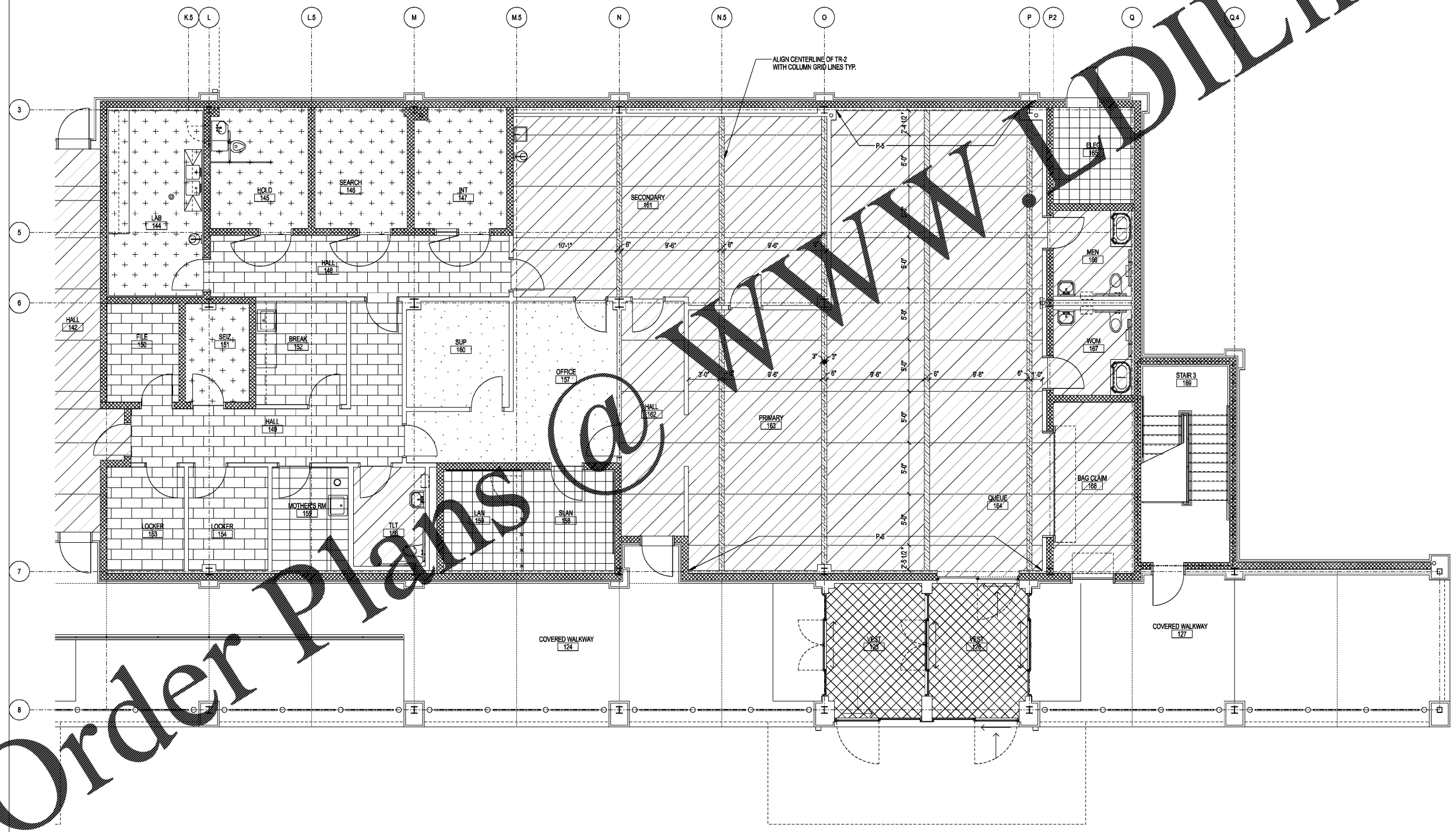

Order Plans @ www.dlLine.com