

THE WILSON GROUP

P O BOX 5510 CHARLOTTE, NC 28209 (704) 331-8747

CIVIL ENGINEER TALBERT, BRIGHT & ELLINGTON 3525 WHITEHALL PARK DRIVE, SUITE 210 CHARLOTTE, NC 28273 (704) 426-6070 FIRM NO. C-1163

STRUCTURAL ENGINEER STEWART 101 N. TRYON ST., SUITE 1400 CHARLOTTE, NC 28202 (704) 909-3523 FIRM NO. C-1051

MECHANICAL, ELECTRICAL, PLUMBING & FIRE PROTECTION ENGINEER SABER ENGINEERING 2823 S. TRYON ST., SUITE 200 CHARLOTTE, NC 28203 (704) 373-0068 FIRM NO. C-2130

LANDSCAPE ARCHITECT URBAN DESIGN PARTNERS 1318-EE CENTRAL AVENUE CHARLOTTE, NC 28205 (704) 334-3303 FIRM NO. C-TBD

COMMUNICATIONS INFRASTRUCTURE DB CONSULTING 246 LIVES FARM ROAD BLACKSBURG, SC 29702 (704) 467-7228 FIRM NO. C-TBD

REVISIONS

DATE DECEMBER 7, 2018 PROJECT NUMBER 9197-000

SHEET TITLE GRADING AND DRAINAGE PLAN

SHEET NUMBER C-401

GRADING AND DRAINAGE NOTES:

- 1. THE CONTRACTOR SHALL VERIFY EXISTING INFORMATION OF ALL EXISTING DRAINAGE STRUCTURES PRIOR TO ORDERING/IN-IT WORK BEGINS.
2. ALL DISTURBED AREAS, INCLUDING THE CONTRACTORS STAGING AREA, HAUL ROUTES, GRADING LIMITS, ETC. SHALL BE RETURNED TO A SMOOTH LINE AND GRADE WITH POSITIVE DRAINAGE. ALL DISTURBED AREAS SHALL BE STABILIZED WITH 500 OR TEMPORARILY WITH SEED. SEE SHEET C-605 FOR SEEDING INFORMATION.
3. ALL STORM INLETS SHALL BE MARKED WITH A FISH LOGO AND "DUMP NO WASTE, DRAINS TO STREAM".
4. ALL GRADING AND EROSION CONTROL MEASURES SHALL BE IN COMPLIANCE WITH NORTH CAROLINA DEPARTMENT OF ENVIRONMENTAL QUALITY.
5. ANY GRADING BEYOND THE PROJECTS DENUDED LIMITS SHOWN ON THE PLANS IS A VIOLATION OF THE STATE'S EROSION CONTROL ORDINANCE AND IS SUBJECT TO A FINE.
6. GROUND STABILIZATION MUST OCCUR WITHIN 7 DAYS OF THE LAST LAND DISTURBING ACTIVITY ON PERIMETER AREAS AND ANY SLOPES STEEPER THAN 3:1. GROUND STABILIZATION MUST OCCUR WITHIN 14 DAYS OF THE LAST LAND DISTURBING ACTIVITY IN ALL OTHER AREAS.
7. ALL SIGNAGE AND PAVEMENT MARKINGS SHALL COMPLY WITH THE MANUAL ON UNIFORM TRAFFIC CONTROL DEVICES, MOST RECENT EDITION.
8. BEFORE YOU DIG, STOP AND CALL THE NC ONE CALL CENTER AT 811.
9. DUE TO THE NATURE OF THE PROJECT, THE REMOVAL OF EXISTING PAVEMENT WILL POTENTIALLY CAUSE WATER INSIDE THE PROJECT TO BE RELEASED DURING AND AFTER RAINFALL EVENTS. LOW POINT SUMPS SHALL BE INSTALLED AND MAINTAINED BY THE CONTRACTOR IN ORDER TO PREVENT WATER FROM ACCUMULATING. AFTER ANY RAINFALL EVENT OR WHEN WATER HAS ACCUMULATED, THE CONTRACTOR SHALL MODIFY THE LOW POINT SUMPS AS NECESSARY. WATER SHALL BE PUMPED TO A FILTER BAG SEQUENCE AND LEVEL. COMPLETELY. WATER SHALL BE PUMPED TO A FILTER BAG (SEE DETAIL) TO REMOVE DIMENSIONAL SALT PRIOR TO IT LEAVING THE PROJECT SITE. UNDER NO CIRCUMSTANCE SHALL WATER BE PUMPED DIRECTLY INTO THE EXISTING STORM DRAINAGE SYSTEM. THE CONTRACTOR SHALL HAVE AN ADEQUATE NUMBER OF FILTER BAGS ON SITE TO TREAT SEDIMENT LADEN RUNOFF. ONCE PUMPED SEDIMENT HAS PASSED THROUGH A SEDIMENT FILTER BAG, IT CAN THEN BE DISCHARGED INTO THE STORM DRAINAGE SYSTEM.
10. SEE SHEET C-605 FOR SEDIMENT AND EROSION CONTROL DETAILS.

STORM DRAINAGE SUMMARY

Table with 3 columns listing storm drain identifiers (e.g., 8-1, 8-2, 8-3), their specifications (e.g., 15" INV. IN=716.32, EX. 15" INV. OUT=716.12), and their respective catchment areas and slopes.

LEGEND

Legend table defining symbols for storm drain identifiers, existing and proposed contours, spot elevations, storm drain structures, inlet protection, overflow outlets, silt fences, silt sack protection, filter socks, storm drain pipes, water, sanitary sewer, and various pavement types.

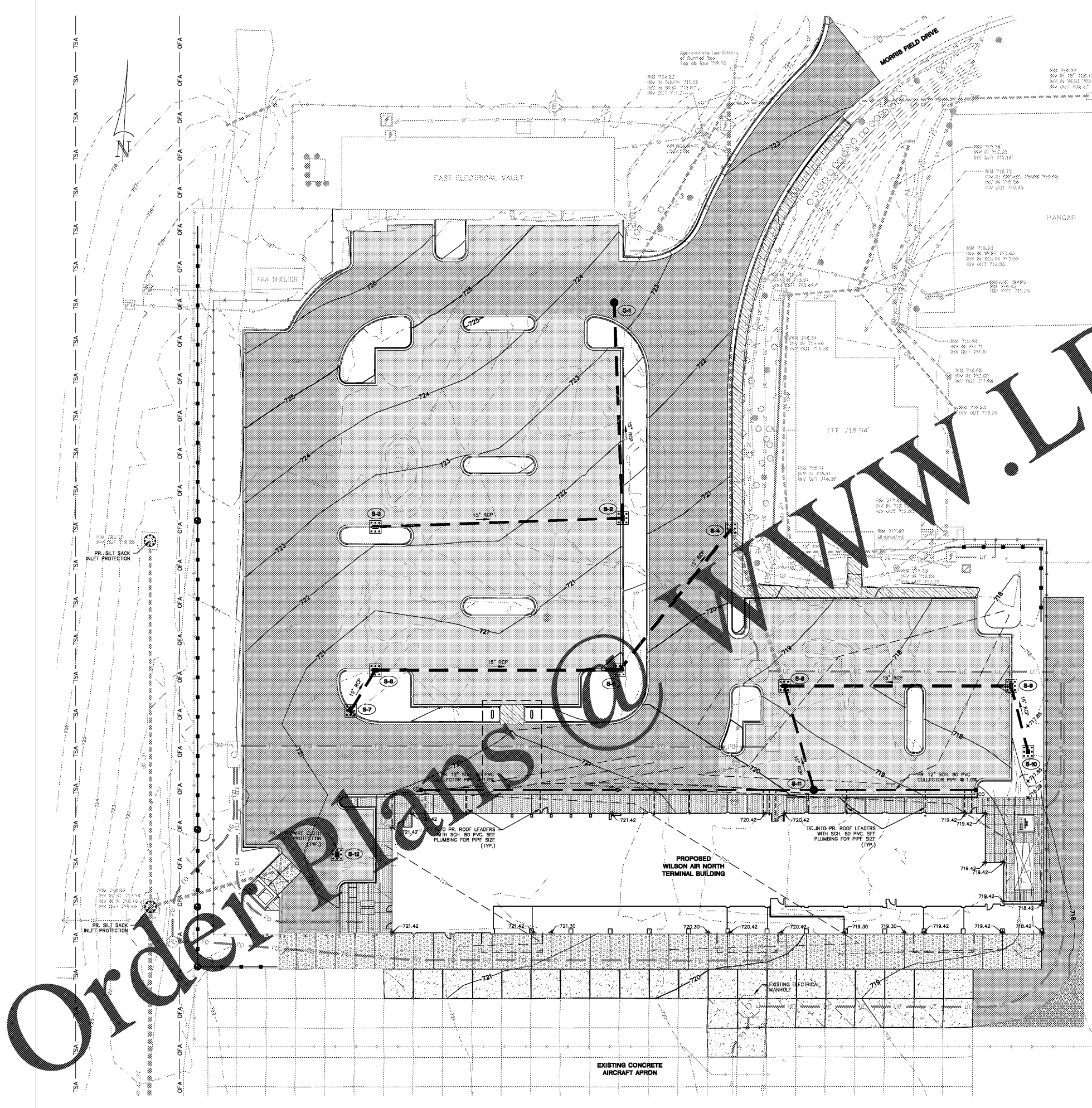
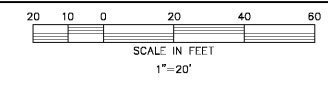

Order Plans

WWW.LDINTELL.COM