

WALL LEGEND

1 HR RATED WALL

LIFE SAFETY PLAN LEGEND

NUMBER OF OCCUPANTS (F)	(X)
EGRESS WIDTH	ACTUAL CLEAR (IN) / ACTUAL (OCC) (F) / MAX (OCC) (G)
MAXIMUM AREA DIAGONAL	(X)
DISTANCE BETWEEN EXITS	REQUIRED (X) / ACTUAL (X)
EXIT ACCESS TRAVEL DISTANCE	ACTUAL (X) / ALLOWABLE (X)
PANIC HARDWARE	(P) DELAYED EGRESS LOCK (D)
ELECT. EGRESS LOCK	(E) HOLD OPEN DEVICES
EXIT	ARROW (X)

FIRE EXTINGUISHER LEGEND

ACTUAL AREA SERVED BY PFE	15.48 SF
HAZARD LEVEL	ORDINARY CLASS ABC
SF/A	1.50 SF
EXTINGUISHER TYPE	FEC (2A-10B-C)
SF/EXTINGUISHER	5.00 SF
NUMBER OF EXTINGUISHERS	3 FEC
MAX. AREA SERVED	11,250 SF
MAX. TRAVEL DISTANCE	75 FT
ACTUAL MAX. TRAVEL DISTANCE	70 FT

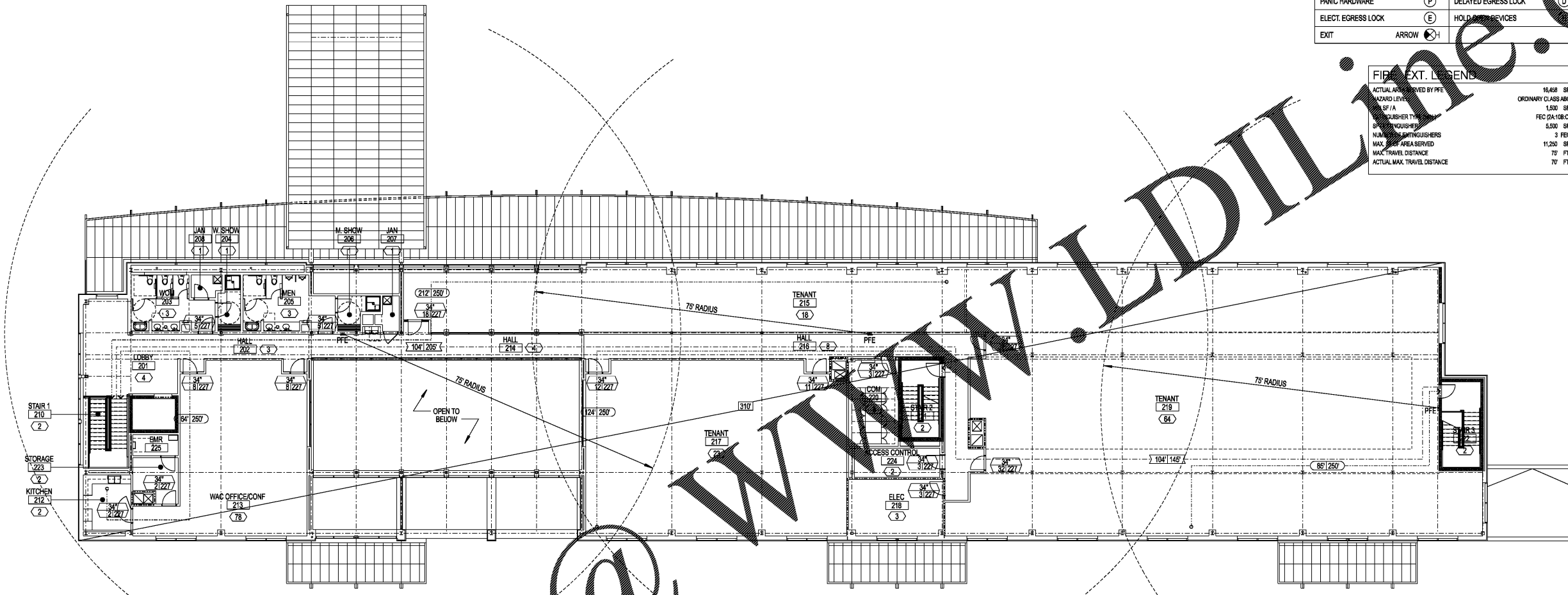

OCCUPANCY SUMMARY

(A)	(B)	(C)	SECOND LEVEL						
			(D)	(E)	(F)	(G)	(H)	(I)	(J)
Room No.	Room Name	Occupancy Type	Area	Area/Occupant	Actual Occupants (D/E)	Stair Inches / Occ.	Stair Inches Req. (F/G)	Other Inches / Occ.	Other Inches Req. (H/I)
201	Lobby	Business	374	100	4	0.3	1.12	0.2	0.75
202	Hall	Business	205	100	3	0.3	0.62	0.2	0.42
203	Women	Business	212	100	3	0.3	0.64	0.2	0.42
204	Women Shower	Business	61	100	1	0.3	0.18	0.2	0.12
205	Men	Business	253	100	3	0.3	0.76	0.2	0.51
206	Men Shower	Business	57	100	1	0.3	0.17	0.2	0.11
207	Janitor	Business	36	100	1	0.3	0.11	0.2	0.07
208	Janitor	Business	30	100	1	0.3	0.09	0.2	0.06
210	Stair 1	Business	166	100	2	0.3	0.50	0.2	0.33
212	Kitchen	Business	141	100	2	0.3	0.42	0.2	0.28
213	WAC Office/Conference	Assembly Unocc.	1,168	15	78	0.3	23.36	0.2	15.57
214	Hall	Business	362	100	4	0.3	1.09	0.2	0.72
215	Tenant (Unfinished)	Business	1,770	100	18	0.3	5.31	0.2	3.54
216	Hall	Business	761	100	8	0.3	2.28	0.2	1.52
217	Tenant (Unfinished)	Business	2,340	100	23	0.3	6.72	0.2	4.48
218	Electrical	Business	270	100	3	0.3	0.81	0.2	0.54
219	Tenant (Unfinished)	Business	6,304	100	64	0.3	18.91	0.2	12.61
220	Communications	Business	227	100	3	0.3	0.68	0.2	0.45
221	Stair 2	Business	168	100	2	0.3	0.50	0.2	0.34
222	Stair 3	Business	171	100	2	0.3	0.51	0.2	0.34
223	Storage	Business	96	100	1	0.3	0.29	0.2	0.19
224	Access Control	Business	137	100	2	0.3	0.41	0.2	0.27
225	EMR	Business	55	100	1	0.3	0.17	0.2	0.11
Sub-Total			15,267		230		65.66		43.77

REVISIONS

DATE: DECEMBER 7, 2018
 PROJECT NUMBER: 9197-000

SHEET TITLE:
SECOND LEVEL LIFE SAFETY PLAN

SHEET NUMBER:
LS-102

Order Plans @