



ARCHITECT
THE WILSON GROUP
ARCHITECTS

PO BOX 8510 CHARLOTTE, NC 28209
704-331-5747 • www.wilsongroup.com

CIVIL ENGINEER
TALBERT, BRIGHT & ELLINGTON

3525 WHITEHALL PARK DRIVE, SUITE 210
CHARLOTTE, NC 28273
(704) 428-6070 FIRM NO. C-1163

STRUCTURAL ENGINEER
STEWART

101 N. TRYON ST., SUITE 1400
CHARLOTTE, NC 28202
(704) 999-3528 FIRM NO. C-1051

MECHANICAL, ELECTRICAL, PLUMBING & FIRE PROTECTION ENGINEER
SABER ENGINEERING

2933 S. TRYON ST., SUITE 280
CHARLOTTE, NC 28203
(704) 373-0068 FIRM NO. C-2130

LANDSCAPE ARCHITECT
URBAN DESIGN PARTNERS

1315-B CENTRAL AVENUE
CHARLOTTE, NC 28205
(704) 334-3303 FIRM NO. C-TBD

COMMUNICATIONS INFRASTRUCTURE
DB CONSULTING

246 LOVES FARM ROAD
BLACKSBURG, SC 29702
(704) 467-7228 FIRM NO. C-TBD

DATE DECEMBER 7, 2018
PROJECT NUMBER 9197-000

SHEET TITLE
FIRST LEVEL LIFE SAFETY PLAN

SHEET NUMBER
LS-101

WALL LEGEND

1 HR RATED WALL

LIFE SAFETY PLAN LEGEND

NUMBER OF OCCUPANTS (F)	(X)
EGRESS WIDTH	ACTUAL CLEAR (W) / ACTUAL (OCC) (F) / MAX (OCC) (G)
MAXIMUM AREA DIAGONAL	(X)
DISTANCE BETWEEN EXITS	REQUIRED (X) / ACTUAL (X)
EXIT ACCESS TRAVEL DISTANCE	ACTUAL (X) / ALLOWABLE (X)
PANIC HARDWARE	(P) DELAYED EGRESS LOCK (D)
ELECT. EGRESS LOCK	(E) HOLD OPEN DEVICES
EXIT	ARROW (X)

FIRE EXTINGUISHER LEGEND

ACTUAL AREA COVERED BY PFE	15827 SF
HAZARD LEVEL	ORDINARY CLASS ABC
TYPE	1.500 SF
TYPE	FEC (2A-10B-C)
TYPE	5.500 SF
NUMBER OF EXTINGUISHERS	3 FEC
MAX. AREA SERVED	11263 SF
MAX. TRAVEL DISTANCE	75 FT
ACTUAL MAX. TRAVEL DISTANCE	70 FT

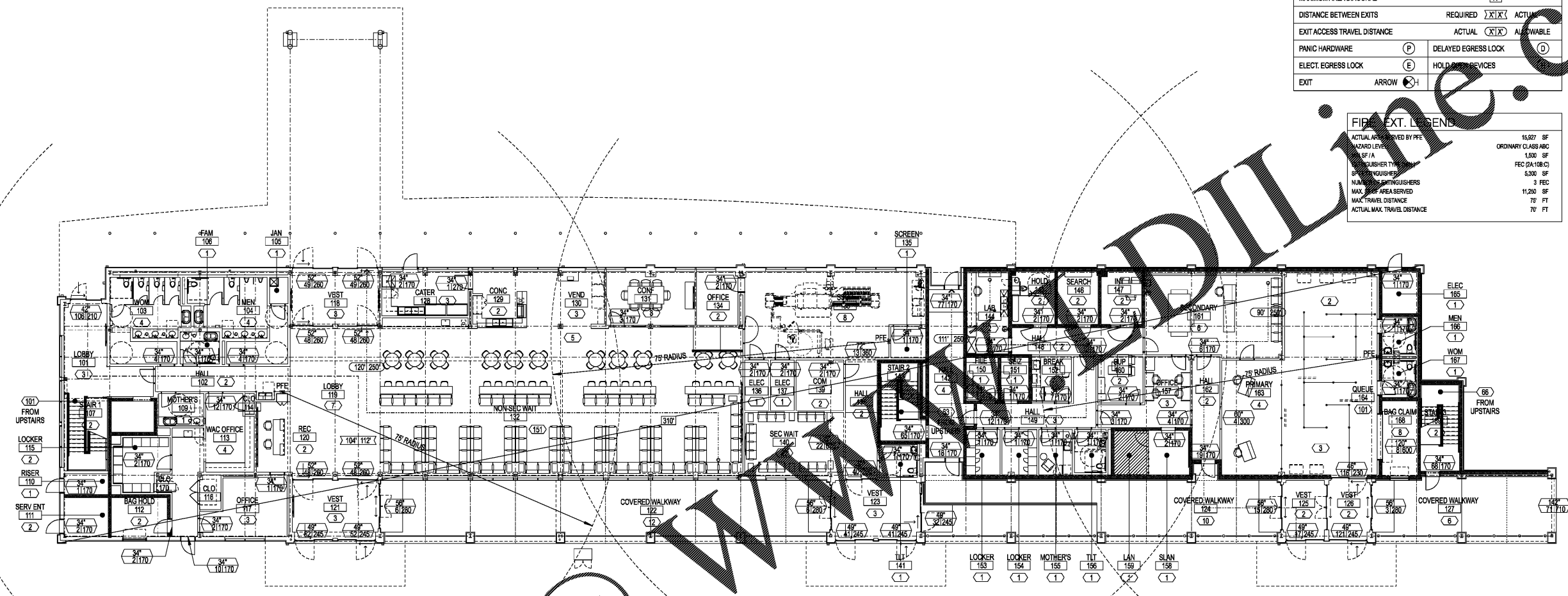

OCCUPANCY SUMMARY

		FIRST LEVEL									
(A)	(B)	(C)	(D)	(E)	(F)	(G)	(H)	(I)	(J)	(K)	(L)
Room No.	Room Name	Occupancy Type	Area	Area/Occupant	Actual Occupants (D/E)	Stair Inches / Occ	Stair Inches Req. (F)(G)	Other Inches / Occ	Other Inches Req. (F)(I)	Other Inches / Occ	Other Inches Req. (F)(L)
101	Lobby	Business	272	100	3	0.3	0.82	0.2	0.54		
102	Hall	Business	150	100	2	0.3	0.57	0.2	0.38		
103	Hall	Business	328	100	4	0.3	0.98	0.2	0.66		
104	Hall	Business	342	100	4	0.3	1.03	0.2	0.69		
105	Janitor	Business	35	100	1	0.3	0.14	0.2	0.07		
106	Family	Business	76	100	1	0.3	0.23	0.2	0.15		
107	Hall	Business	171	100	2	0.3	0.51	0.2	0.34		
108	Waiting Room	Business	82	100	1	0.3	0.25	0.2	0.16		
109	Locker Room	Business	52	100	1	0.3	0.16	0.2	0.10		
110	Service Entrance	Business	92	100	1	0.3	0.28	0.2	0.18		
111	Bag Hold	Business	121	100	2	0.3	0.36	0.2	0.24		
112	WAC Office	Business	353	100	4	0.3	1.06	0.2	0.73		
113	Locker	Business	151	100	2	0.3	0.45	0.2	0.30		
114	Office	Business	229	100	3	0.3	0.72	0.2	0.48		
115	Vestibule	Business	260	100	3	0.3	0.78	0.2	0.52		
116	Locker	Business	572	100	7	0.3	2.02	0.2	1.34		
117	Restroom	Business	120	100	2	0.3	0.39	0.2	0.26		
118	Vestibule	Business	262	100	3	0.3	0.79	0.2	0.52		
119	Covered Walkway	Business	1,346	100	12	0.3	3.44	0.2	2.29		
120	Vestibule	Business	256	100	3	0.3	0.77	0.2	0.51		
121	Covered Walkway	Business	969	100	10	0.3	2.91	0.2	1.94		
122	Vestibule	Business	124	100	2	0.3	0.37	0.2	0.25		
123	Vestibule	Business	124	100	2	0.3	0.37	0.2	0.25		
124	Covered Walkway	Business	537	100	6	0.3	1.61	0.2	1.07		
125	Catering	Business	241	100	3	0.3	0.72	0.2	0.48		
126	Concessions	Business	154	100	2	0.3	0.46	0.2	0.31		
127	Vending	Business	231	100	3	0.3	0.68	0.2	0.42		
128	Conference	Business	349	100	3	0.3	0.72	0.2	0.48		
129	Non-Secure Waiting	Waiting Area	2,252	15	153	0.3	45.04	0.2	30.03		
130	Non-Secure Waiting	Business	457	100	5	0.3	1.25	0.2	0.83		
Sub-Total			17,328		458		127.90		85.27		

OCCUPANCY SUMMARY (CONTINUED)

		FIRST LEVEL									
(A)	(B)	(C)	(D)	(E)	(F)	(G)	(H)	(I)	(J)	(K)	(L)
Room No.	Room Name	Occupancy Type	Area	Area/Occupant	Actual Occupants (D/E)	Stair Inches / Occ	Stair Inches Req. (F)(G)	Other Inches / Occ	Other Inches Req. (F)(I)	Other Inches / Occ	Other Inches Req. (F)(L)
131	SSCP	Business	712	100	8	0.3	2.14	0.2	1.42		
132	Office	Business	121	100	2	0.3	0.36	0.2	0.24		
133	Screening	Business	51	100	1	0.3	0.18	0.2	0.12		
134	Electrical	Business	66	100	1	0.3	0.20	0.2	0.13		
135	Electrical	Business	56	100	1	0.3	0.20	0.2	0.13		
136	Hall	Business	300	100	2	0.3	0.60	0.2	0.40		
137	Communications	Business	128	100	2	0.3	0.38	0.2	0.26		
138	Secure Waiting	Waiting Area	317	15	22	0.3	6.34	0.2	4.23		
139	Toilet	Business	66	100	1	0.3	0.20	0.2	0.13		
140	Hall	Business	326	100	4	0.3	0.98	0.2	0.65		
141	Stair	Business	176	100	2	0.3	0.53	0.2	0.35		
142	Lab	Business	185	100	2	0.3	0.56	0.2	0.37		
143	Hold Room	Business	122	100	2	0.3	0.37	0.2	0.24		
144	Search Room	Business	117	100	2	0.3	0.35	0.2	0.23		
145	Interview Room	Business	112	100	2	0.3	0.25	0.2	0.17		
146	Hall	Business	120	100	2	0.3	0.58	0.2	0.39		
147	Hall	Business	211	100	3	0.3	0.63	0.2	0.42		
148	File Room	Business	79	100	1	0.3	0.24	0.2	0.16		
149	Temp. Seized Storage	Business	70	100	1	0.3	0.21	0.2	0.14		
150	Break Room	Assembly/Standby	99	15	7	0.3	1.98	0.2	1.32		
151	Locker	Business	83	100	1	0.3	0.25	0.2	0.17		
152	Locker	Business	83	100	1	0.3	0.25	0.2	0.17		
153	Mother's Room	Business	81	100	1	0.3	0.24	0.2	0.16		
154	Toilet	Business	75	100	1	0.3	0.23	0.2	0.15		
155	Office	Business	229	100	3	0.3	0.69	0.2	0.46		
156	SLAN	Business	100	100	1	0.3	0.30	0.2	0.20		
157	LAB	Business	39	100	1	0.3	0.24	0.2	0.16		
158	Supervisor	Business	112	100	2	0.3	0.34	0.2	0.22		
159	Secondary	Business	569	100	6	0.3	1.71	0.2	1.14		
160	Hall	Business	150	100	2	0.3	0.45	0.2	0.30		
161	Primary	Business	364	150	4	0.3	1.09	0.2	0.73		
162	Queue	Assembly/Standby	505	5	101	0.3	30.30	0.2	20.20		
163	Processing	Business	229	100	3	0.3	0.69	0.2	0.46		
164	Processing	Business	188	100	2	0.3	0.56	0.2	0.38		
165	Electrical Service	Business	85	100	1	0.3	0.26	0.2	0.17		
166	Men	Business	75	100	1	0.3	0.23	0.2	0.15		
167	Women	Business	75	100	1	0.3	0.23	0.2	0.15		
168	Bag Claim	Baggage Claim	148	20	8	0.3	2.22	0.2	1.48		
169	Stair 3	Business	198	100	2	0.3	0.50	0.2	0.34		
Sub-Total			17,328		458		127.90		85.27		

Order Plans @ WWW.WILSONGROUP.COM