

GENERAL NOTES:

1. CONNECT NEW LIGHTING FIXTURES TO EXISTING LIGHTING CIRCUITS MADE AVAILABLE DURING DEMOLITION.
2. MODIFY THE CEILING GRID AS REQUIRED TO ACCOMMODATE THE NEW CLASSROOM PERIMETER LIGHTING. FILL GAPS WITH ACT TO MATCH EXISTING.

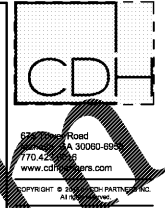

FULTON COUNTY SCHOOL SYSTEM
RIVER EVES ELEMENTARY SCHOOL - RENOVATION
 9000 EVES ROAD
 ROSWELL, GA 30076

PROJECT NO:	18046.00
50% CD'S	08/07/2016
PERMIT SET	09/29/2016
95% CD'S	11/08/2016
BID SET	12/09/2016



CONTRACT DOCUMENT
 ISSUED FOR
 CONSTRUCTION

SHEET TITLE
ELECTRICAL LIGHTING PLAN - SECTION E

SHEET NUMBER
E201E

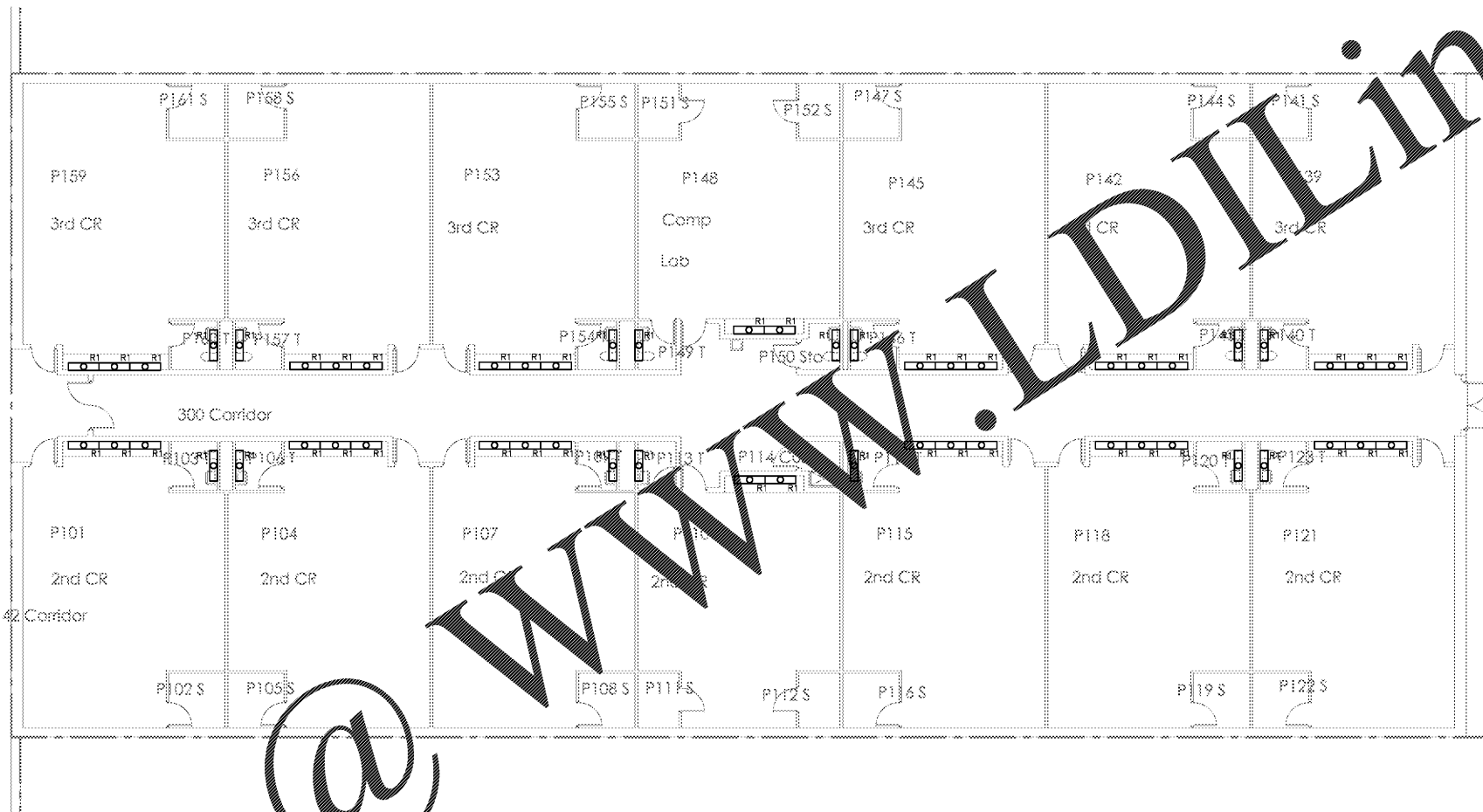

ELECTRICAL LIGHTING PLAN - SECTION E
 SCALE: 1/8" = 1'-0"

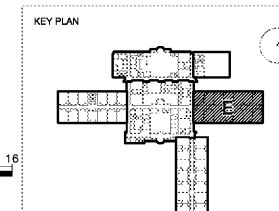
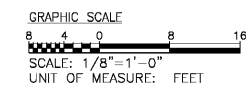

Order Plans @ www.LDLine.com