

GENERAL NOTES:

- 1. CONNECT NEW LIGHTING FIXTURES TO EXISTING LIGHTING CIRCUITS MADE AVAILABLE DURING DEMOLITION.
- 2. MODIFY THE CEILING GRID AS REQUIRED TO ACCOMMODATE THE NEW CLASSROOM PERIMETER LIGHTING. FILL GAPS WITH ACT TO MATCH EXISTING.

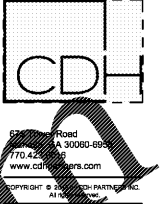

FULTON COUNTY SCHOOL SYSTEM  
 RIVER EVES ELEMENTARY SCHOOL -  
 RENOVATION  
 9800 EVES ROAD  
 ROSWELL, GA 30076

PROJECT NO. 18046.00
50% CD'S 08/07/2016
PERMIT SET 09/29/2016
95% CD'S 11/08/2016
BID SET 12/09/2016



CONTRACT DOCUMENT  
 ISSUED FOR  
 CONSTRUCTION

SHEET TITLE  
 ELECTRICAL  
 LIGHTING PLAN -  
 SECTION C

SHEET NUMBER  
 E201C

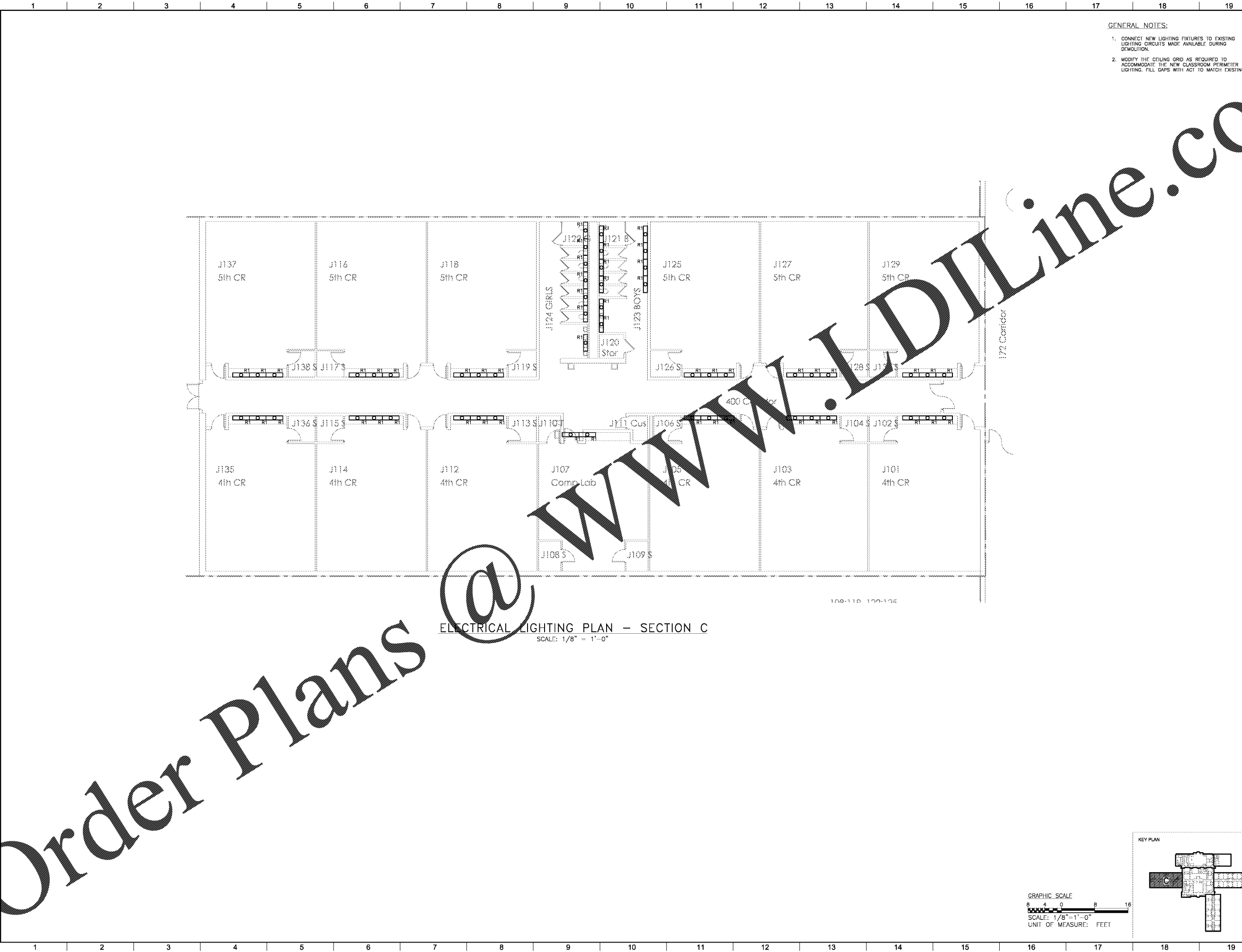

ELECTRICAL LIGHTING PLAN - SECTION C  
 SCALE: 1/8" = 1'-0"

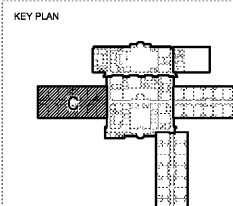
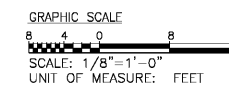

Order Plans @ WWW.LDILine.com