



GENERAL NOTES:

- DEMOLISH LIGHTING FIXTURES INDICATED ON THIS SHEET. FIELD VERIFY EXACT LOCATIONS AND QUANTITIES.
- MAINTAIN EXISTING LIGHTING CIRCUITS TO BE REUSED FOR NEW LIGHTING FIXTURES.
- MAINTAIN CONTROL DEVICES AND WIRING DEVICES TO BE REUSED FOR NEW LIGHTING FIXTURE CONTROL.

CD
 1300 Wood
 A 30000-00
 770.420.3000
 www.cd.com
 COPYRIGHT © 2007 CD PARTNERS, INC. ALL RIGHTS RESERVED

FULTON COUNTY SCHOOL SYSTEM
**RIVER EVES ELEMENTARY SCHOOL -
 RENOVATION**
 9000 EVES ROAD
 ROSWELL, GA 30076

PROJECT NO:	18046.00
50% CD'S	08/07/2016
PERMIT SET	09/29/2016
95% CD'S	11/08/2016
BID SET	12/09/2016



CONTRACT DOCUMENT
 ISSUED FOR
 CONSTRUCTION

SHEET TITLE
**ELECTRICAL LIGHTING PLAN -
 SECTION C -
 DEMOLITION**

SHEET NUMBER

ED201C

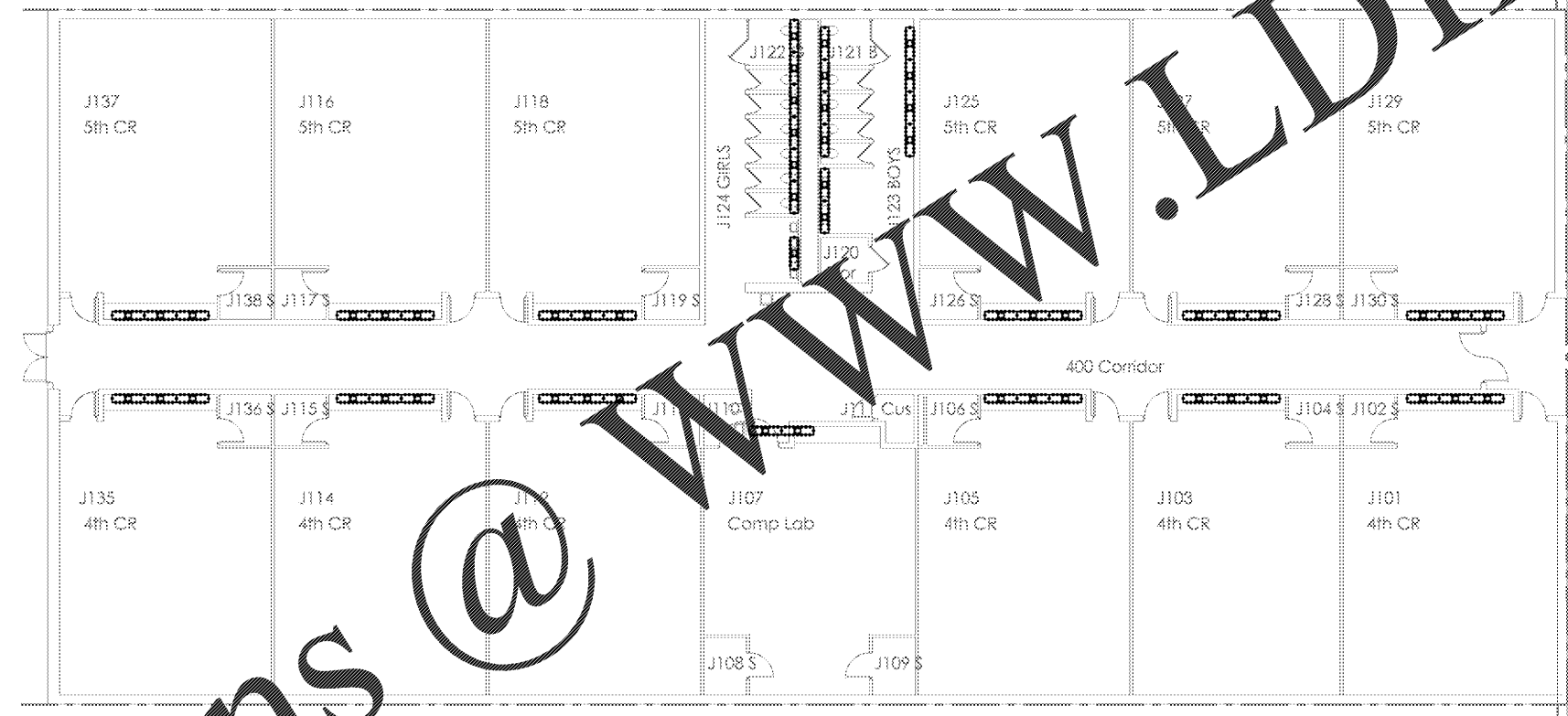

ELECTRICAL LIGHTING PLAN – SECTION C – DEMOLITION
 SCALE: 1/8" = 1'-0"

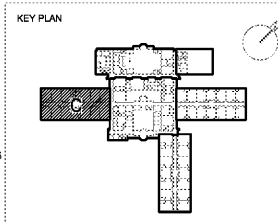
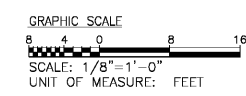

Order Plans

WWW.LDITLine.COM

