

1 2 3 4 5 6 7 8 9 10 11 12 13 14 15 16 17 18 19

GENERAL NOTES:

1. DEMOLISH LIGHTING FIXTURES INDICATED ON THIS SHEET. FIELD VERIFY EXACT LOCATIONS AND QUANTITIES.
2. MAINTAIN EXISTING LIGHTING CIRCUITS TO BE REUSED FOR NEW LIGHTING FIXTURES.
3. MAINTAIN CONTROL DEVICES AND WIRING DEVICES TO BE REUSED FOR NEW LIGHTING FIXTURE CONTROL.

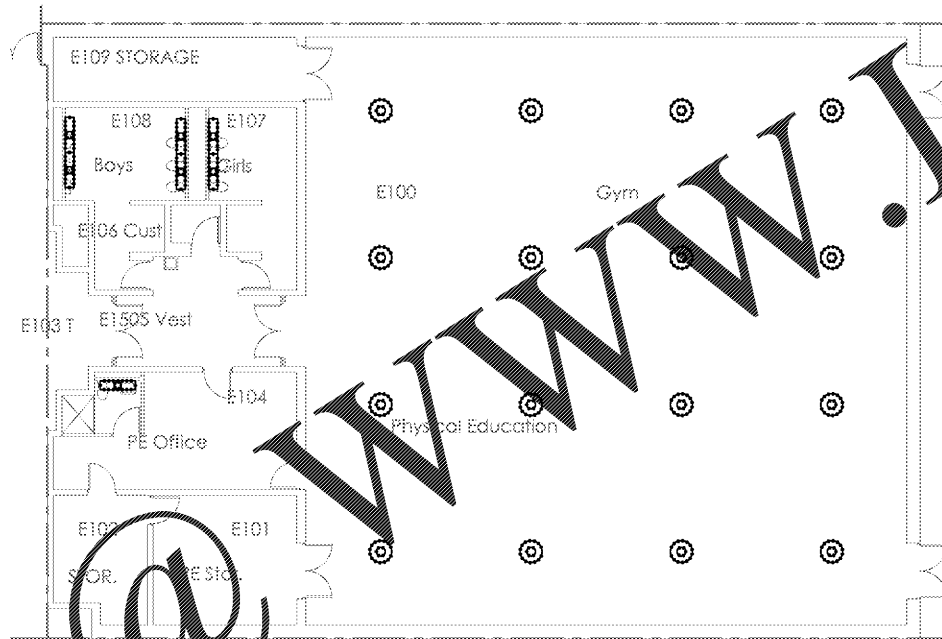

ELECTRICAL LIGHTING PLAN — SECTION B — DEMOLITION
SCALE: 1/8" = 1'-0"

Order Plans

FULTON COUNTY SCHOOL SYSTEM
RIVER EVES ELEMENTARY SCHOOL - RENOVATION
 8000 EVES ROAD
 ROSWELL, GA 30076

PROJECT NO: 18046.00

50% CD'S	08/07/2016
PERMIT SET	09/29/2016
95% CD'S	11/08/2016
BID SET	12/09/2016



CONTRACT DOCUMENT
ISSUED FOR
CONSTRUCTION

SHEET TITLE
ELECTRICAL LIGHTING PLAN - SECTION B - DEMOLITION

SHEET NUMBER
ED201B

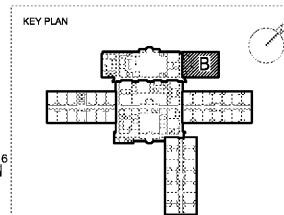
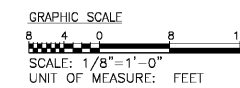

1 2 3 4 5 6 7 8 9 10 11 12 13 14 15 16 17 18 19