



DRAWING NOTES:
① ALTERNATE #1: INSTALL NEW GAS PIPING AND VALVES UP TO THE ROOF TOP UNIT. EXISTING ROOF TOP UNIT TO REMAIN.

FULTON COUNTY SCHOOL SYSTEM
RIVER EVES ELEMENTARY SCHOOL -
RENOVATION
8000 EVES ROAD
ROSWELL, GA 30076

PROJECT NO: 18048.00

30% CDS	08/22/2018
PERMIT SET	09/20/2018
25% CDS	11/08/2018
BID SET	2/09/2019



CONTRACT DOCUMENT
ISSUED FOR
CONSTRUCTION

SHEET TITLE
PLUMBING ROOF
PLAN - SECTION B

SHEET NUMBER
P201B

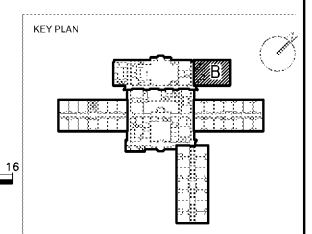
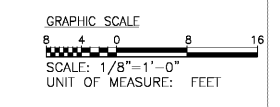
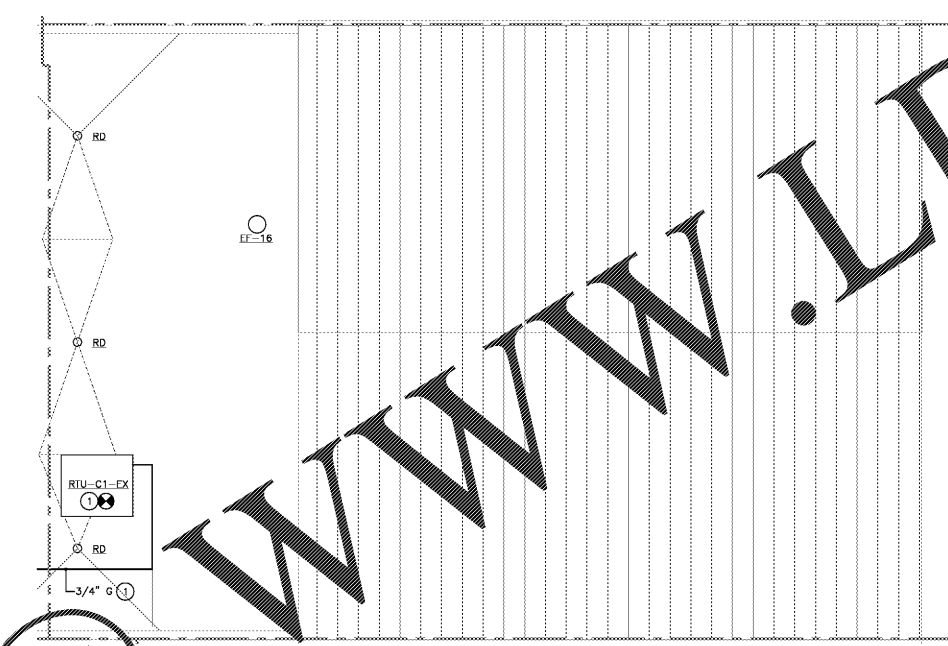

Order Plans @

WWW.LDILine.com