

HVAC REPLACEMENT AT  
**TAYLORSVILLE ELEMENTARY SCHOOL**  
1502 OLD ALABAMA ROAD, TAYLORSVILLE, GEORGIA 30178  
FOR THE BARTOW COUNTY SCHOOL SYSTEM, DR. PHILLIP PAGE, SUPERINTENDENT  
CARTERSVILLE, GEORGIA



THESE DOCUMENTS, AS INSTRUMENTS OF SERVICE, REMAIN THE PROPERTY OF LLDC ARCHITECT AND ENGINEERS. NO PART THEREOF MAY BE REPRODUCED OR USED IN ANY FORM WITHOUT WRITTEN PERMISSION.

NO.	REVISIONS	DATE

CONSTRUCTION DOCUMENT:

FLOOR PLAN WING E - LIGHTING  
SHEET  
**E2.5**  
25 OF 32  
FILE: 18.09  
DATE: 12/14/18

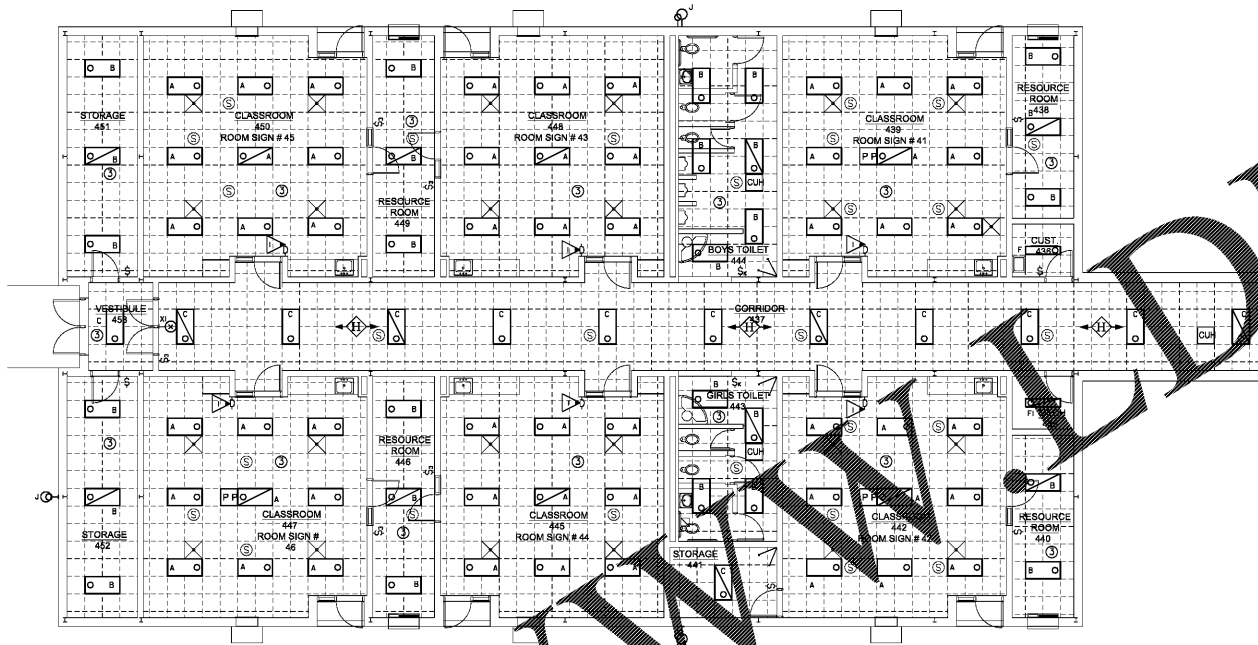

2 FLOOR PLAN WING E - LIGHTING  
E3.5 SCALE: 1/8"=1'-0"

**GENERAL LIGHTING NEW NOTES:**

- A. REMOVE EXISTING SWITCHES AND FACEPLATES. PROVIDE ALL NEW DEVICES AND FACEPLATES. CONFORM WIRING TO MEET OPERATION SHOWN ON NEW WORK PLAN.
- B. REMOVE EXISTING EXIT SIGNS AND EGRESS LIGHT FIXTURES AND REPLACE. CONFORM WIRING TO MEET OPERATION SHOWN ON NEW WORK PLAN.
- C. LIGHT FIXTURES TO BE REPLACED IN AREAS SHOWN. REPLACE FIXTURE AND FIXTURE WHIP TO JUNCTION BOX. FOR FIXTURES IN LAY-IN CEILINGS, PROVIDE ADDITIONAL FACEWAY AND CONDUCTORS AS REQUIRED FOR NEW OCCUPANCY SENSORS, BATTERY UNITS BUILT IN FIXTURES AND NEW DIMMERS IN CLASSROOMS.
- D. PROVIDE UNSWITCHED HOT TO NEW EGRESS FIXTURES FROM CIRCUIT SERVING LIGHTS IN THE AREA TO POWER INTEGRAL BATTERY BALLAST.

**KEYED NOTES:** (THIS SHEET ONLY)

- ▷ REPLACE SWITCH WITH 0-10V DIMMER. PROVIDE ADDITIONAL CONDUCTORS AS REQUIRED.

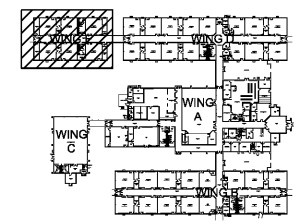

Order Plans @ WWW.LDLine.com