



THESE DOCUMENTS, AS INSTRUMENTS OF SERVICE, REMAIN THE PROPERTY OF THE ARCHITECT AND NO PART THEREOF MAY BE REPRODUCED OR USED IN ANY FORM WITHOUT WRITTEN PERMISSION

Table with columns for DATE, REVISIONS, and NO.

CONSTRUCTION DOCUMENT:

FLOOR PLAN WING D - LIGHTING

SHEET E3.4
27 OF 30

FILE: 18.10
DATE: 12/14/18

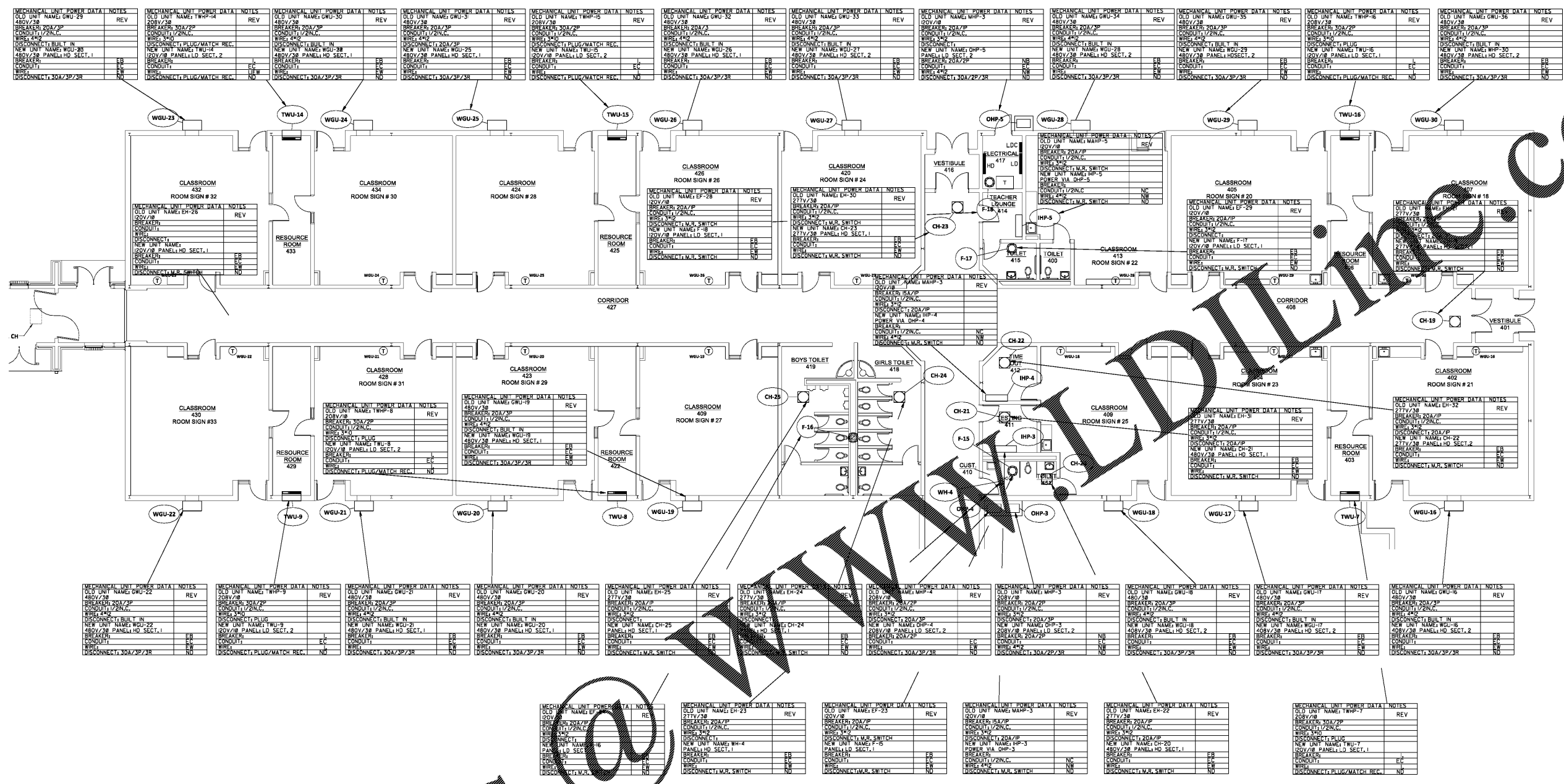

1 FLOOR PLAN WING D - HVAC
E3.4 SCALE: 1/8"=1'-0"

- GENERAL NOTES: (THIS SHEET ONLY)
A. PROVIDE ELECTRICAL CONNECTION TO EACH SMOKE DAMPER AND COMBINATION FIRE/200VOLT SMOKE DAMPER...
B. WALL JUNCTION BOXES AND CONDUIT FOR THERMOSTATS SHALL BE PROVIDED BY ELECTRICAL CONTRACTOR...
C. PROVIDE BACKBOARD TO MOUNT ALL PANELS AND DISCONNECTS.
D. UTILIZE MECHANICAL CURBING FOR ROUTING OF CONDUITS TO ROOF TOP MOUNTED HVAC UNITS...
E. COORDINATE EXACT LOCATIONS OF ALL MECHANICAL EQUIPMENT PRIOR TO ELECTRICAL ROUGH-IN.
F. ALL EXTERIOR FLEXIBLE CONDUIT SHALL BE METALLIC WATERPROOF.
G. VERIFY EXACT LOCATIONS OF ALL EXISTING FIRE ALARM DEVICES AND CONTROL EQUIPMENT PRIOR TO ANY WORK.

- MECHANICAL POWER UNIT DATA NOTES: (THIS SHEET ONLY)
N- NEW UNIT
EX- EXISTING UNIT TO REMAIN AS-IS
ER- EXISTING UNIT TO BE REMOVED AND NOT REPLACED
REV- EXISTING UNIT TO BE REMOVED AND REPLACED
BR- EXISTING BREAKER TO BE REUSED
EC- EXISTING CONDUIT TO BE REUSED
EW- EXISTING WIRE TO BE REUSED
ED- EXISTING DISCONNECT TO BE REUSED
ET- EXISTING THERMOSTAT TO BE USED
RE- EXISTING RECEPTACLE TO BE REPLACED
RW- EXISTING WIRE TO BE REPLACED
RB- EXISTING BREAKER TO BE REPLACED
RT- EXISTING THERMOSTAT TO BE REPLACED
NB- TOTALLY NEW BREAKER
NC- 100% ALL NEW CONDUIT
NW- 100% ALL NEW WIRE
ND- TOTALLY NEW DISCONNECT
NT- TOTALLY NEW THERMOSTAT
SD- PROVIDE DUCT SMOKE DETECTION SUPPLY DUCT
NOTES:
1. UTILIZE ONE POLE OF EXISTING BREAKER, AND UTILIZE EXISTING CONDUCTORS AS REQUIRED PER 2017 NEC.

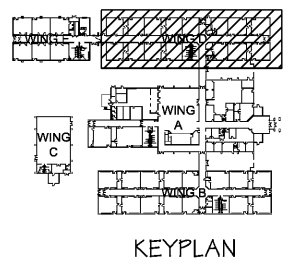

Order Plans