

HYAC & LIGHTING REPLACEMENT AT
**KINGSTON ELEMENTARY
SCHOOL**

240 HARDIN BRIDGE ROAD, KINGSTON, GA 30145
FOR THE BARTOW COUNTY SCHOOL SYSTEM - DR. PHILIP D. PAGE, SUPERINTENDENT
CARTERSVILLE, GEORGIA

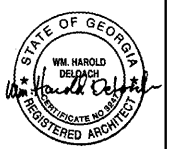

THESE DOCUMENTS,
AS INSTRUMENTS OF
SERVICE, REMAIN THE
PROPERTY OF THE
ARCHITECT AND NO
PART THEREOF MAY BE
USED OR REPRODUCED
IN ANY FORM WITHOUT
WRITTEN PERMISSION

NO.	REVISIONS	DATE

CONSTRUCTION DOCUMENTS

OVERALL FLOOR PLAN

SCALE: 1/8" = 1'-0"

SHEET

A1.01

2 OF 30

FILE: 18.10
DATE: 12/14/18

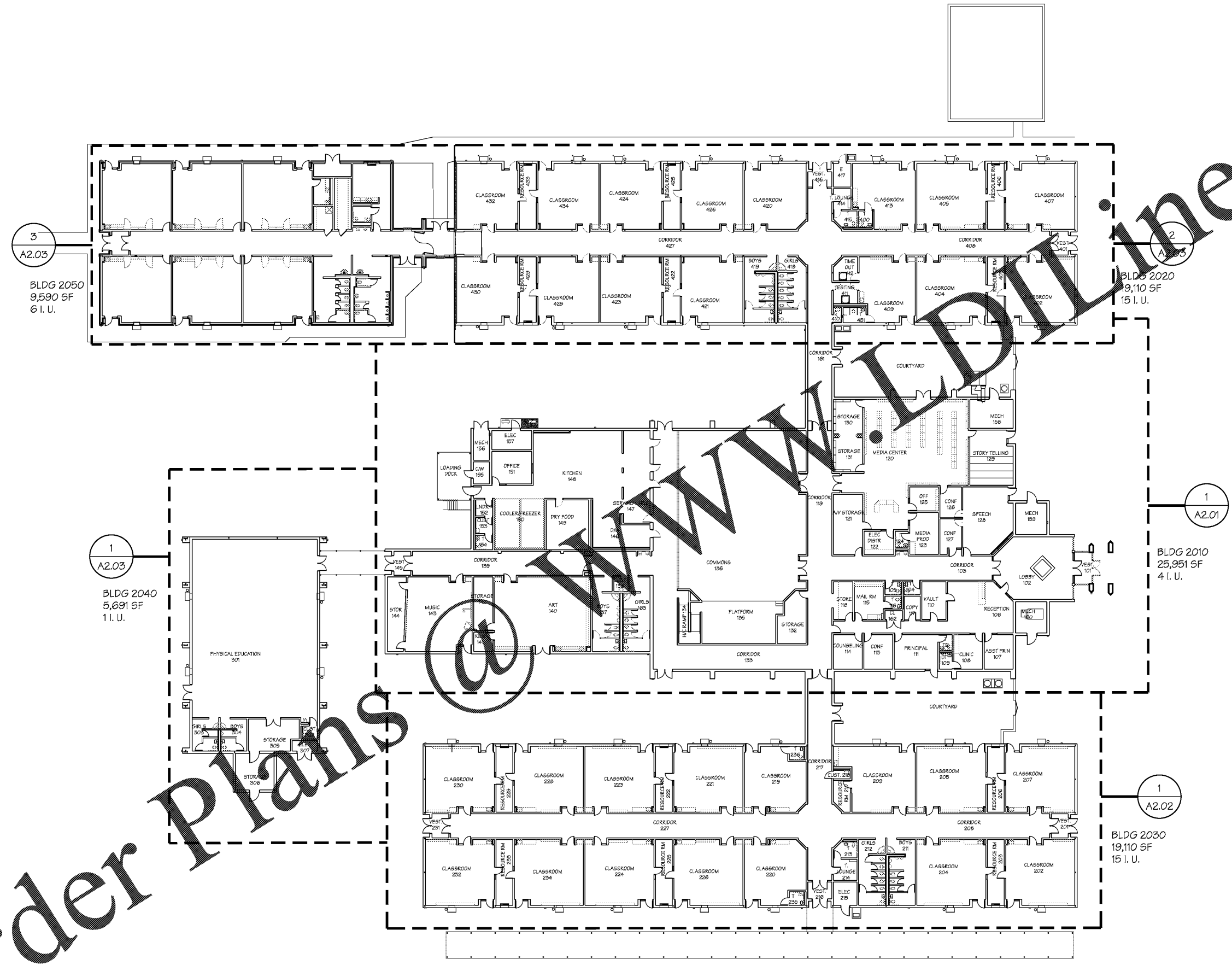

3
A2.03
BLDG 2050
9,590 SF
6 I. U.

2
A2.03
BLDG 2020
19,110 SF
15 I. U.

1
A2.03
BLDG 2040
5,691 SF
11 I. U.

1
A2.01
BLDG 2010
25,951 SF
4 I. U.

1
A2.02
BLDG 2030
19,110 SF
15 I. U.

OVERALL FLOOR PLAN

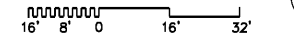

Order Plans