

- CEILING LEGEND**
- NEW ALUMINUM GRID W/ NEW LAY-IN VINYL FACED GYPSUM CEILING TILE TO REMAIN
  - EXISTING GRID W/ EXISTING LAY-IN ACOUSTICAL CEILING TILE TO REMAIN
  - EXISTING 2X2 GRID W/ NEW LAY-IN ACOUSTICAL CEILING TILE
  - LOCATION WHERE AN EXISTING EMERGENCY LIGHT WAS INSTALLED (REMOVED IN DEMOLITION PHASE). INSTALL NEW LAY-IN ACOUSTICAL CEILING TILE IN EXISTING GRID
  - NEW HYAC SUPPLY GRILLE
  - NEW HYAC RETURN
  - EXISTING CEILING MOUNTED EXIT SIGN TO REMAIN
  - EXISTING CEILING MOUNTED SPEAKER TO REMAIN
  - EXISTING CEILING MOUNTED SMOKE DETECTOR
  - EXISTING WIRELESS ACCESS POINT TO REMAIN
  - EXISTING POWER POLE THRU CEILING TO REMAIN
  - EXISTING SECURITY CAMERA TO REMAIN
  - EXISTING CEILING MOUNTED PROJECTOR PLATE TO REMAIN
  - EXISTING CEILING MOUNTED PROJECTOR POST TO REMAIN
  - EXISTING SFRINKLER HEAD TO REMAIN
  - NEW CEILING MOUNTED UNIT HEATER IN EXISTING GRID
  - LIGHT FIXTURE TO BE DEMOLISHED. REMOVE WIRING BACK TO NEAREST J-BOX OR RE-USE FOR NEW LIGHTS
  - NEW 1X4, 2X4, OR 2X2 LIGHT FIXTURE INSTALLED IN EXISTING GRID (EXCEPT WHERE NOTED ON PLANS)
  - NEW WALL MOUNTED LIGHT FIXTURE
  - NEW CLG MOUNTED LIGHT FIXTURE IN EXTG GRID
  - NEW SURFACE MOUNT LIGHT EXTERIOR LIGHT FIXTURE
  - NEW EXTERIOR RECESSED LIGHT FIXTURE IN HARD CEILING

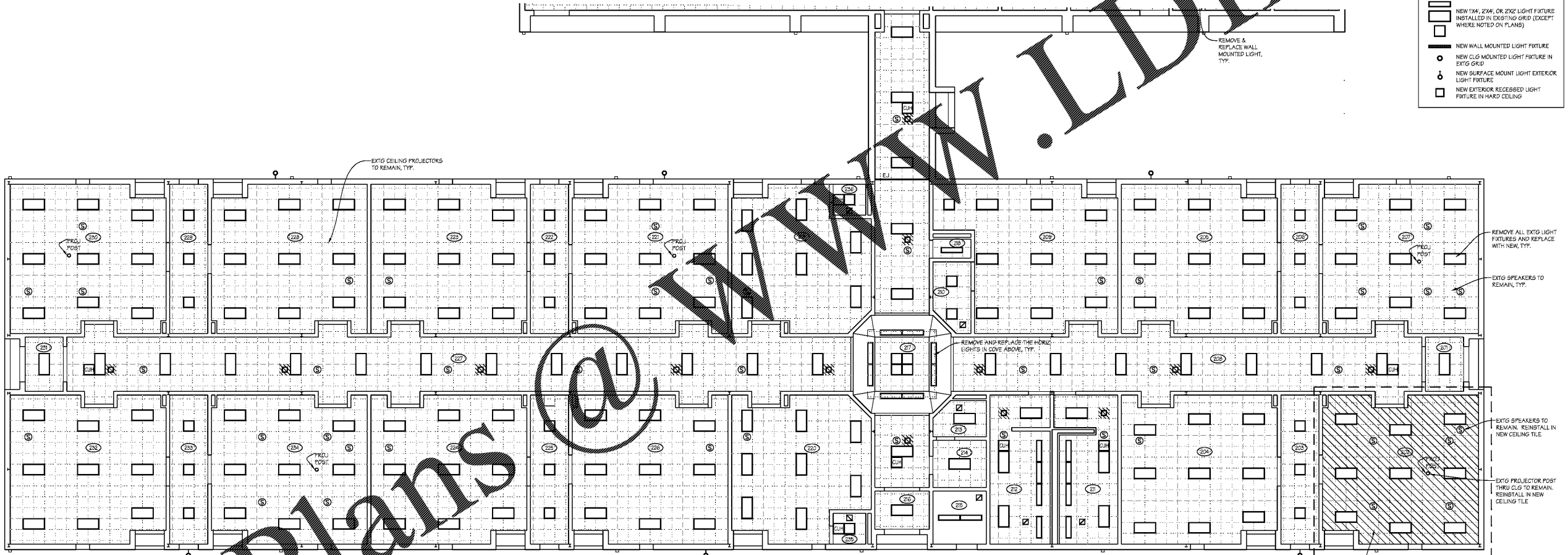

WING B REFLECTED CEILING PLAN

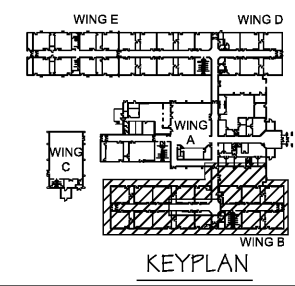

THESE DOCUMENTS, AS INSTRUMENTS OF SERVICE, REMAIN THE PROPERTY OF THE ARCHITECT AND NO PART THEREOF MAY BE USED OR REPRODUCED IN ANY FORM WITHOUT WRITTEN PERMISSION

|           |  |
|-----------|--|
| DATE      |  |
| REVISIONS |  |
| NO.       |  |

CONSTRUCTION DOCUMENTS  
 WING B REFLECTED CEILING PLAN  
 SCALE: 1/8" = 1'-0"  
 SHEET  
**A3.02**  
 7 OF 32  
 FILE: 18.08  
 DATE: 12/14/18

Order Plans

WWW.LDILine.com