

C1 CLUB BAR
 ID.603 SCALE: 1/2" = 1'-0"
 NOTE: 1. REFER TO ID.200A FOR LIGHTING LOCATIONS.
 2. USE HIDDEN SUPPORT BRACKETS M4 AND M51 AS NEEDED FOR SUPPORT.
 3. MITER ALL EDGES OF M18.

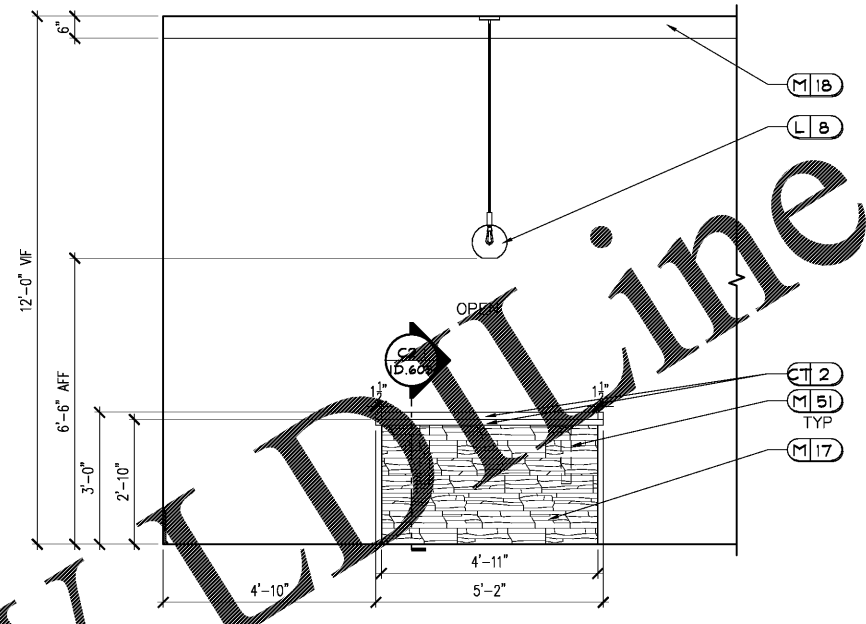

C2 CLUB BAR
 ID.603 SCALE: 1/2" = 1'-0"
 NOTE: 1. REFER TO ID.200A FOR LIGHTING LOCATIONS.
 2. USE HIDDEN SUPPORT BRACKET M51 AS NEEDED FOR SUPPORT.
 3. MITER ALL EDGES OF M18.

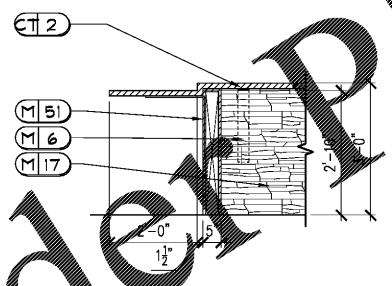

C2.1 SECTION
 ID.603 SCALE: 1/2" = 1'-0"

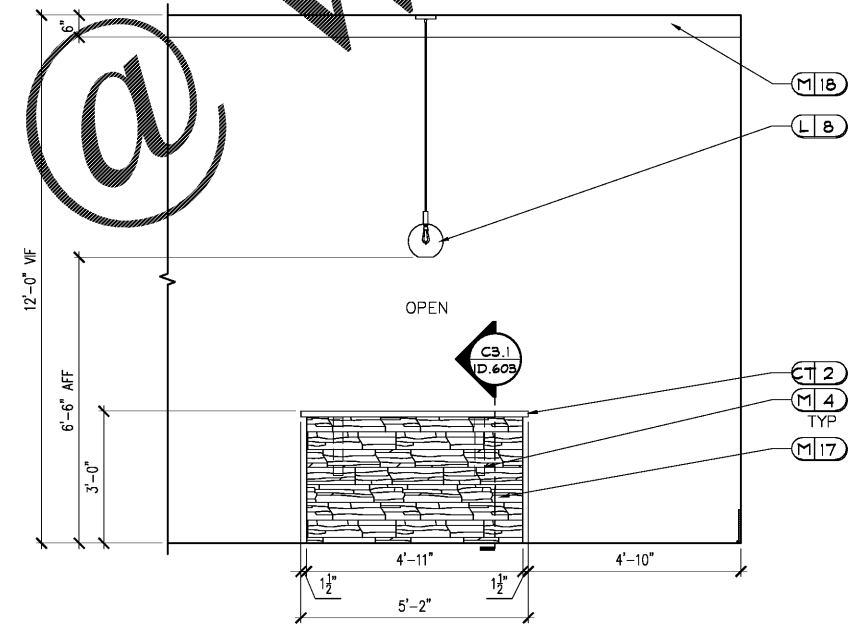

C3 CLUB BAR
 ID.603 SCALE: 1/2" = 1'-0"
 NOTE: 1. REFER TO ID.200A FOR LIGHTING LOCATIONS.
 2. USE HIDDEN SUPPORT BRACKET M4 AS NEEDED FOR SUPPORT.
 3. MITER ALL EDGES OF M18.

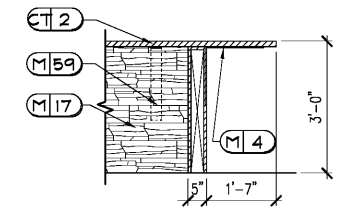

C3.1 SECTION
 ID.603 SCALE: 1/2" = 1'-0"

Order Plans @ WWW.LDILine.com

DEI
 DESIGN ENVIRONMENTS INC.
 100 EAST WASHINGTON ST. SUITE 200
 HUNTSVILLE, AL 35894
 Phone: 770-429-2001
 Fax: 770-429-2002
 Email: info@deiinc.com

LEASING/AMENITY @
 ALEXANDRIA
 HUNTSVILLE, AL
 BOBO FAMILY GROUP

REV.	DATE	REMARKS

RELEASED FOR CONSTRUCTION
 BEGIN DATE: 10/30/18
 RELEASE DATE: 12/28/18
 DESIGNER: NSQ
 CAD DESIGNER: WP
 REVIEWED BY: NSQ, WP, MS

JOB #: 18270
 TITLE: INTERIOR ELEVATIONS & DETAILS
 SHEET: ID.603