

Order Plans @

WWW.DRIVE.COM

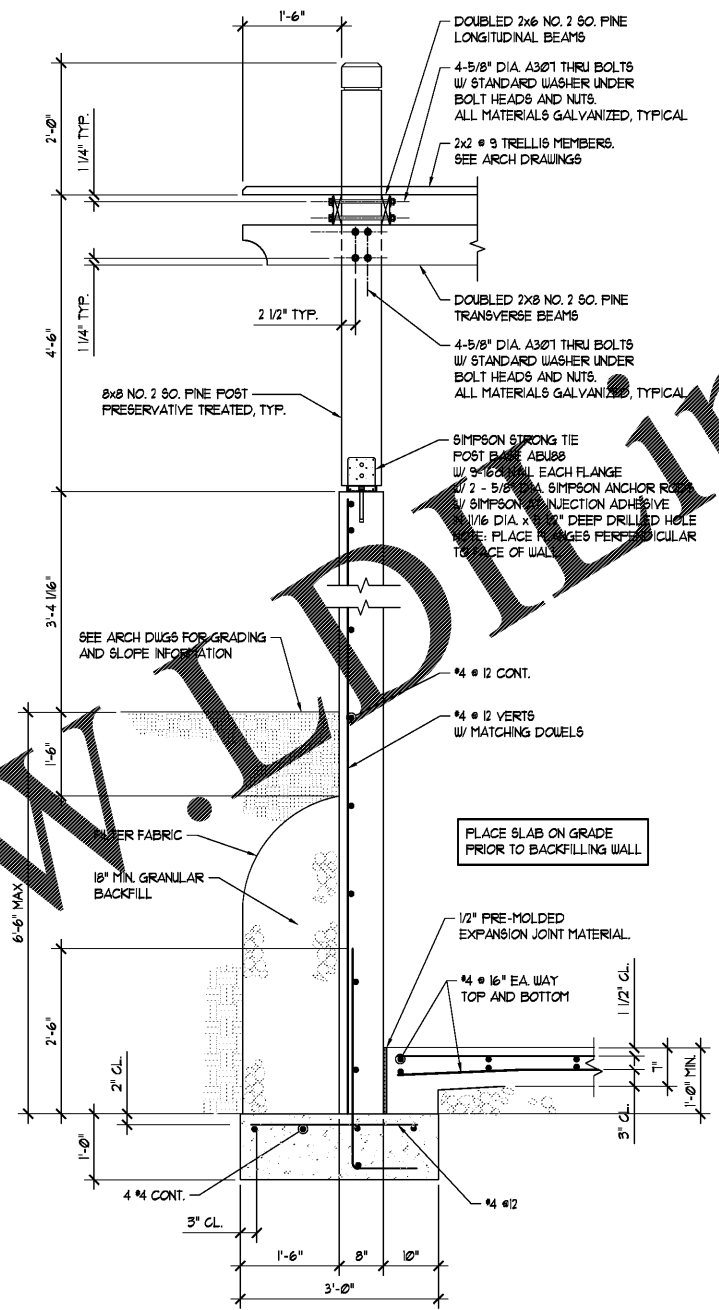

**1**  
S1.6 SECTION TRASH COMPACTOR  
SCALE: 3/4" = 1'-0"  
COORDINATE W/ ARCH DWGS

- TYPICAL FOUNDATION WALL NOTES**
1. WALLS HAVE BEEN DESIGNED FOR AT REST 63 PSF EQUIVALENT AT REST FLUID PRESSURE WITH LEVEL BACKFILL, SLIDING COEFFICIENT OF FRICTION OF 0.40 AND AN ALLOWABLE SOIL BEARING PRESSURE OF 2000 PSF. THESE SOIL PARAMETERS SHALL BE CONFIRMED BY OWNER'S GEOTECHNICAL ENGINEER PRIOR TO PLACEMENT OF STEEL REINFORCING.
  2. PROVIDE FILTER FABRIC BETWEEN GRAVEL AND WALL. PLACE GRANULAR FILL BLANKET AND FILTER FABRIC 15'-0" INSIDE FOOTPRINT OF BUILDING.
  3. ALL EXCAVATIONS FOR FOOTINGS SHALL BE COMPACTED TO 98% DENSITY. PLACEMENT OF ALL FILL SHALL BE MONITORED AND APPROVED BY OWNER'S GEOTECHNICAL ENGINEER. PLACE STRUCTURAL FILL IN LAYERS NOT TO EXCEED 8" IN DEPTH.
  4. CONTRACTOR/OWNER SHALL VERIFY CONSTRUCTION IN THE FIELD. INSPECTION SHALL BE PERFORMED BY A STRUCTURAL ENGINEER REGISTERED IN THE STATE OF GEORGIA. VERIFICATION OF AS-BUILT CONSTRUCTION WILL BE REQUIRED BY JURISDICTION PRIOR TO CERTIFICATE OF OCCUPANCY.
  5. THE ON-SITE MATERIALS MAY BE USED FOR THE STRUCTURAL BACK FILL IS APPROVED BY THE GEOTECHNICAL ENGINEER. PLACE ALL APPROVED BACKFILL MATERIALS PER GENERAL NOTE 2.02.
  6. SLAB ON GRADE. SEE 1/52 FOR SLAB ON GRADE INFORMATION. GROUND SLAB AT LOWER SHALL BE CAST AND ALL WALL BRACES AND DEAD MEN SHALL BE INSTALLED PRIOR TO BACKFILLING WALL. GROUND SLABS AT UPPER AND LOWER SHALL BE CAST PRIOR TO REMOVING WALL BRACES.

DAVID H. SHULL, JR., P.E.  
ALABAMA REGISTRATION #: PE 26201  
IN ASSOCIATION WITH  
SHULL & ASSOCIATES, INC.  
ALABAMA CERTIFICATE OF AUTHORIZATION CA 3177 E  
127 CHURCH STREET NE SUITE 100 MARIETTA, GA 30060  
(404) 459-0585 WWW.SHULLASSOCIATES.COM



**ENGLISH & ASSOCIATES**  
ARCHITECTS, INC.  
3084 MERCER UNIVERSITY DRIVE, SUITE 100  
ATLANTA, GEORGIA 30341  
DENGGLISH@ENGLISHASSOCIATESINC.COM

**JOB PROGRESS:**  
ITEM: 100% Submittal  
DATE: 01.04.19

**REVISIONS:**  
TAG: DATE:

This drawing, as an instrument of service, is and shall remain the property of the Architect of Record and shall not be published, reproduced or used in any way without the written permission of the Architect of Record. DO NOT scale this drawing. All questions to be submitted as a formal request for information to the Architect of Record.

**ALEXANDRIA**  
AN APARTMENT COMMUNITY  
FOR  
**Bobo Family Group**  
HUNTSVILLE, ALABAMA

**JOB NUMBER:**  
DRAWN BY: AV  
CHECKED BY: DHS

**SCHEDULES**

**SHEET NO.**

S1.6