

**ENGLISH & ASSOCIATES ARCHITECTS, INC.**  
 3084 MERCER UNIVERSITY DRIVE, SUITE 100  
 ATLANTA, GEORGIA 30341  
 DENGGLISH@ENGLISHASSOCIATESINC.COM

**JOB PROGRESS:**  
 ITEM: DATE:

**REVISIONS:**  
 TAG: DATE:

This drawing, as an instrument of service, is and shall remain the property of the Architect of Record and shall not be published, reproduced or used in any way without the written permission of the Architect of Record. DO NOT scale this drawing. All questions to be submitted as a formal request for information to the Architect of Record.

**ALEXANDRIA**  
 AN APARTMENT COMMUNITY  
 FOR  
**Bobo Family Group**  
 HUNTSVILLE, ALABAMA

**JOB NUMBER:**  
**DRAWN BY:**  
**CHECKED BY:**

**BUILDING #10**  
**ROOF PLANS**  
**SHEET NO.**

**A4.6**

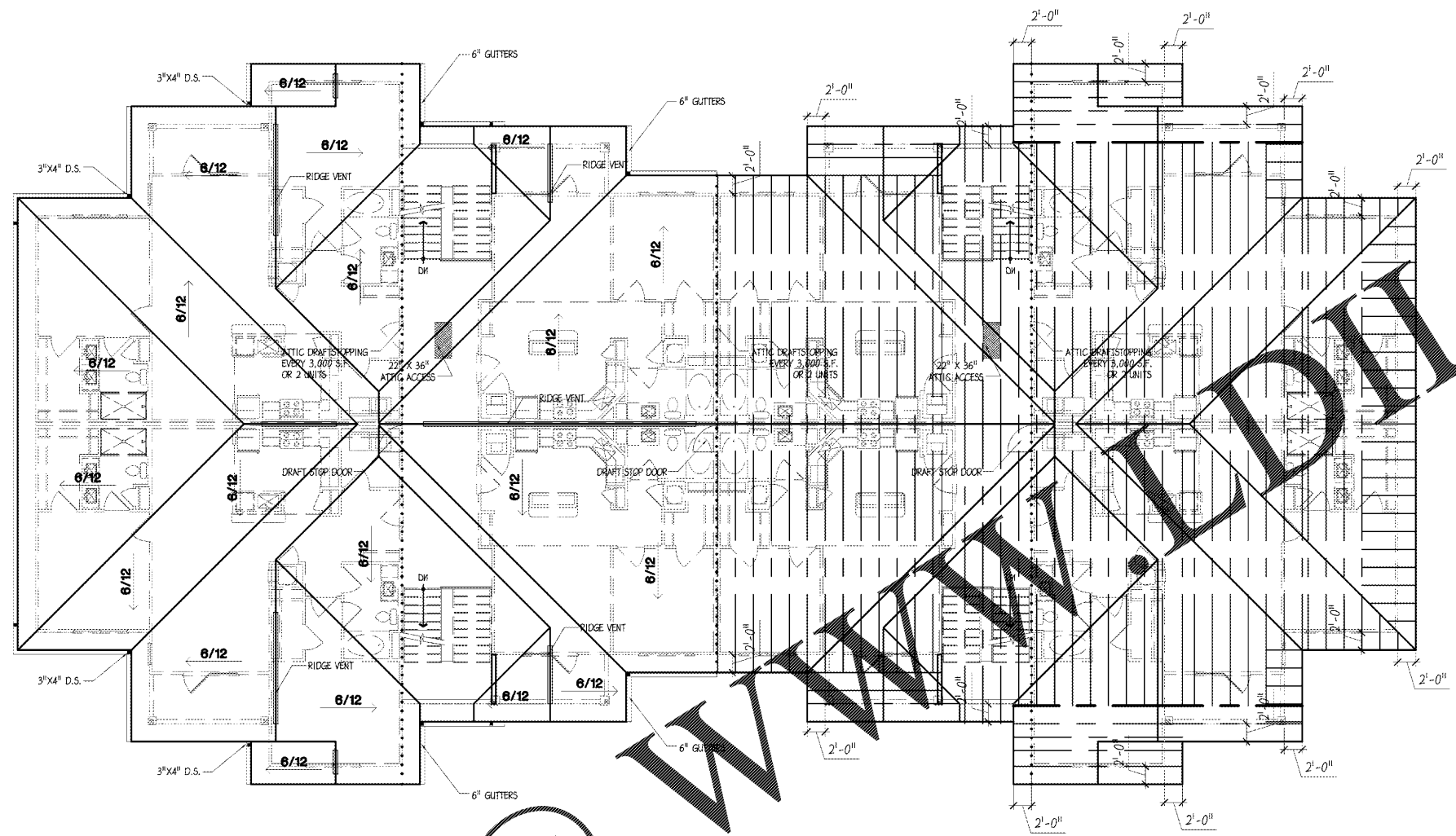

**1 BUILDING #10 - ROOF FRAMING PLAN**  
**A4.6 SCALE: 1/8" = 1'-0"**

**•STRUCTURAL NOTE•**  
 REFER TO STRUCTURAL PLANS FOR ALL UNITS FLOOR & ROOF FRAMING PLANS AND SCHEDULES

**•DRAFT STOP NOTE•**  
 ALL DRAFTSTOPPING SHALL BE LOCATED EVERY 3,000 SQ. FT. OR EVERY 2 UNITS WHICHEVER IS SMALLER AND HAVE A DRAFTSTOP DOOR FOR ACCESS

**•ROOF TRUSS NOTE•**  
 ROOFS TO BE FRAMED WITH PRE-FABRICATED TRUSSES AT 24" O.C. MAX. SPACING PROVIDE ENGINEERED SHOP DRAWINGS FOR REVIEW

- NOTES:**
1. HEAVY DOTTED LINE INDICATES 7/16" OSB DRAFTSTOP -
  2. ALL WOOD POSTS SHOWN IN COLUMNS ARE 6X6 P.T. UNLESS NOTED OTHERWISE.
  3. DIAGONAL GRID HATCHING INDICATES 22X36 ATTIC ACCESS PANEL -
  4. U.N.O. ALL TRUSSES ARE WOOD TRUSSES @ 24" O.C.
  5. ALL ROOF RIDGES TO HAVE RIDGE VENTS.
  6. SEE STRUCTURAL DRAWINGS FOR STUD SCHEDULES
  7. ALL ROOF OVERHANGS ARE SHOWN ON PLANS
  8. REFER TO STRUCTURAL FOR HEADER AND BEAM SCHEDULES
  9. ALL EXTERIOR WOOD FRAMING TO BE PRESSURE TREATED.
  10. ATTICS ARE NOT DESIGNED FOR STORAGE
  11. TRUSS SHOP DRAWINGS SHALL BE AVAILABLE ON THE JOB SITE DURING THE TIMES OF INSPECTION AND SHALL BEAR CLEAR INDICATION THAT THEY HAVE BEEN REVIEWED AND APPROVED BY THE PROJECT STRUCTURAL ENGINEER OF RECORD.
  12. ALL DRAFTSTOPPING SHALL BE IDENTIFIED WITH 1" LETTERS STATING "DRAFTSTOPPING - DO NOT CUT" ACCESS THRU ATTIC DOOR.

**Order Plans**

**WWW.DLINE.COM**