

1 BUILDING #1 - ROOF FRAMING PLAN
 SCALE: 1/8" = 1'-0"

KARP ASSOCIATES, INC.
 24-64 42nd Street, Manhattan, NY 10018
 (212) 784-2100 - Phone
 (212) 784-0189 - Fax

UNIVERSAL FIRE RATED ACCESS DOOR
 Model KRP-150FR
 For Walls and Ceilings

DATE: _____

PROJECT DATA

Project Name: _____
 Architect: _____
 Contractor: _____
 Agent/Client Name: _____
 Design Instructions: _____
 Special Instructions: _____

PROJECT SCHEDULE

QTY	II	W	No. of Units	Finish	Remarks

GENERAL SCOPE:
 The KRP-150FR is installed and rated by Underwriters Laboratories for 1.5 hour "B" label fire wall, and may be used in a 2 hour fire rated wall assembly. Additionally, Underwriters Laboratories rated the KRP-150FR for 3 hours in ceilings.

CONSTRUCTION:

- Frame shall be 18 gauge steel.
- Door shall be 30 gauge steel, welded gate type.
- Frame shall be 15 gauge steel, 1" wide.
- Frame shall be galvanized continuous galvanized.
- Door shall be filled with 2" thick fire rated insulation.
- Door shall have automatic closure, fire self-closing, and operate interior lock release.
- Locks shall be spring loaded sliding bolt type, keyed outside handle, and have side. Door can be prepared for a rim cylinder lock.
- Finish shall be prime coat of cast cellulose acetate, powder, baked enamel. Stainless steel doors shall have 16 oz. zinc.

FIRE-RATED ACCESS DOOR INSTALL IN
BRICK, BLOCK, CONCRETE, TILE OR PLASTER.
 Note: For installation in 3 hour ceiling system, do not use 18" x 18" and longer, extra spacing required with door must be attached from inside of door pan to framing of floor above in such a manner as to brace the door in wall-ceiling.

STANDARD SIZES

DOOR SIZE (18" W/2")	MIN. CEILING OPENING ONLY	NUMBER OF LATCHES	SHIP WT. (LBS.)
30" x 30"	30 3/8" x 24 3/8"	1	6.3
36" x 36"	36 3/8" x 30 3/8"	1	9.1
42" x 42"	42 3/8" x 36 3/8"	1	11.9
48" x 48"	48 3/8" x 42 3/8"	1	14.7
54" x 54"	54 3/8" x 48 3/8"	1	17.5
60" x 60"	60 3/8" x 54 3/8"	1	20.3
66" x 66"	66 3/8" x 60 3/8"	1	23.1
72" x 72"	72 3/8" x 66 3/8"	1	25.9
78" x 78"	78 3/8" x 72 3/8"	1	28.7
84" x 84"	84 3/8" x 78 3/8"	1	31.5
90" x 90"	90 3/8" x 84 3/8"	1	34.3
96" x 96"	96 3/8" x 90 3/8"	1	37.1
102" x 102"	102 3/8" x 96 3/8"	1	39.9
108" x 108"	108 3/8" x 102 3/8"	1	42.7
114" x 114"	114 3/8" x 108 3/8"	1	45.5
120" x 120"	120 3/8" x 114 3/8"	1	48.3
126" x 126"	126 3/8" x 120 3/8"	1	51.1
132" x 132"	132 3/8" x 126 3/8"	1	53.9
138" x 138"	138 3/8" x 132 3/8"	1	56.7
144" x 144"	144 3/8" x 138 3/8"	1	59.5
150" x 150"	150 3/8" x 144 3/8"	1	62.3
156" x 156"	156 3/8" x 150 3/8"	1	65.1
162" x 162"	162 3/8" x 156 3/8"	1	67.9
168" x 168"	168 3/8" x 162 3/8"	1	70.7
174" x 174"	174 3/8" x 168 3/8"	1	73.5
180" x 180"	180 3/8" x 174 3/8"	1	76.3
186" x 186"	186 3/8" x 180 3/8"	1	79.1
192" x 192"	192 3/8" x 186 3/8"	1	81.9
198" x 198"	198 3/8" x 192 3/8"	1	84.7
204" x 204"	204 3/8" x 198 3/8"	1	87.5
210" x 210"	210 3/8" x 204 3/8"	1	90.3
216" x 216"	216 3/8" x 210 3/8"	1	93.1
222" x 222"	222 3/8" x 216 3/8"	1	95.9
228" x 228"	228 3/8" x 222 3/8"	1	98.7
234" x 234"	234 3/8" x 228 3/8"	1	101.5
240" x 240"	240 3/8" x 234 3/8"	1	104.3
246" x 246"	246 3/8" x 240 3/8"	1	107.1
252" x 252"	252 3/8" x 246 3/8"	1	109.9

SECTION A-A

Made with Union Labor

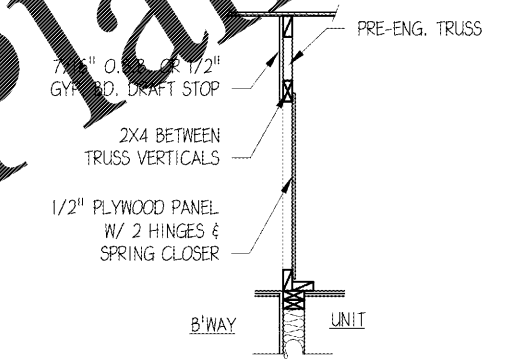

2 DRAFTSTOP - DOOR SECTION
 SCALE: N.T.S.

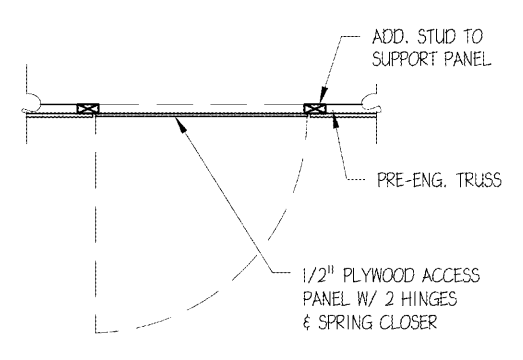

3 DRAFTSTOP - DOOR PLAN
 SCALE: N.T.S.

STRUCTURAL NOTE:
 REFER TO STRUCTURAL PLANS FOR ALL UNITS FLOOR & ROOF FRAMING PLANS AND SCHEDULES

DRAFT STOP NOTE:
 ALL DRAFTSTOPPING SHALL BE LOCATED EVERY 3,000 SQ. FT. OR EVERY 2 UNITS WHICH EVER IS SMALLER AND HAVE A DRAFTSTOP DOOR FOR ACCESS

ROOF TRUSS NOTE:
 ROOFS TO BE FRAMED WITH PRE-FABRICATED TRUSSES AT 24" O.C. MAX. SPACING PROVIDE ENGINEERED SHOP DRAWINGS FOR REVIEW

- NOTES:**
- HEAVY DOTTED LINE INDICATES 7/16" OSB DRAFTSTOP -
 - ALL WOOD POSTS SHOWN IN COLUMNS ARE 6X6 P.T. UNLESS NOTED OTHERWISE.
 - DIAGONAL GRID HATCHING INDICATES 22x36 ATTIC ACCESS PANEL -
 - U.N.O. ALL TRUSSES ARE WOOD TRUSSES @ 24" O.C.
 - ALL ROOF RIDGES TO HAVE RIDGE VENTS.
 - SEE STRUCTURAL DRAWINGS FOR STUD SCHEDULES
 - ALL ROOF OVERHANGS ARE SHOWN ON PLANS
 - REFER TO STRUCTURAL FOR HEADER AND BEAM SCHEDULES
 - ALL EXTERIOR WOOD FRAMING TO BE PRESSURE TREATED.
 - ATTICS ARE NOT DESIGNED FOR STORAGE
 - TRUSS SHOP DRAWINGS SHALL BE AVAILABLE ON THE JOB SITE DURING THE TIMES OF INSPECTION AND SHALL BEAR CLEAR INDICATION THAT THEY HAVE BEEN REVIEWED AND APPROVED BY THE PROJECT STRUCTURAL ENGINEER OF RECORD.
 - ALL DRAFTSTOPPING SHALL BE IDENTIFIED WITH 1" LETTERS STATING "DRAFTSTOPPING - DO NOT CUT" ACCESS THRU ATTIC DOOR.

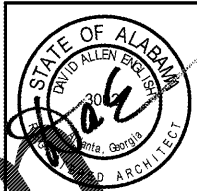

ENGLISH & ASSOCIATES
 ARCHITECTS, INC.

3084 MERCER UNIVERSITY DRIVE, SUITE 100
 ATLANTA, GEORGIA 30341
 DENGGLISH@ENGLISHASSOCIATESINC.COM

JOB PROGRESS:
 ITEM: _____ DATE: _____

REVISIONS:
 TAG: _____ DATE: _____

This drawing, as an instrument of service, is and shall remain the property of the Architect of Record and shall not be published, reproduced or used in any way without the written permission of the Architect of Record. DO NOT scale this drawing. All questions to be submitted as a formal request for information to the Architect of Record.

ALEXANDRIA
 AN APARTMENT COMMUNITY
 FOR
 Bobo Family Group
 HUNTSVILLE, ALABAMA

JOB NUMBER:
DRAWN BY:
CHECKED BY:
BUILDING #1
ROOF PLANS
SHEET NO.

A4.0