

TYPICAL UPPER LEVEL CEILING ASSEMBLY

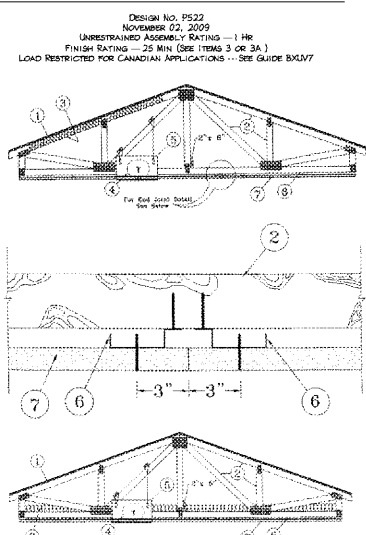

C. BLOCKING - WHERE TRUSS DESIGN DOES NOT PERMIT DIRECT, FULL CONTACT OF THE HANGER BRACKET, A PIECE OF NOMINAL 2" BY 4" IN. LUMBER (BLOCKING), MIN. 6 IN. LONG TO BE FASTENED TO THE HANGER BRACKET AND TO BE SECURED VERTICALLY TO THE SIDE OF THE TRUSS (ITEM 2) AT THE TOP AND BOTTOM OF THE BLOCKING AT EACH STEEL FRAMING MEMBER (ITEM 6B) LOCATION.

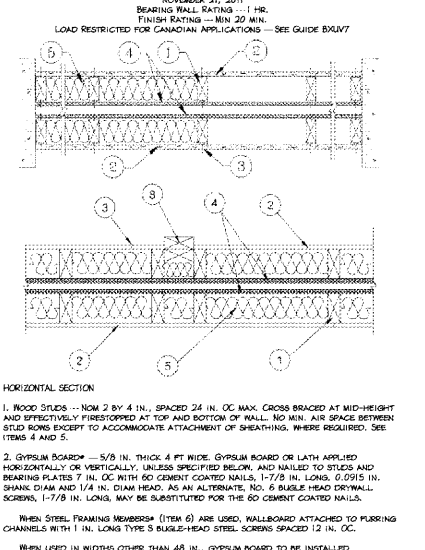

DESIGN NO. 1521
UNRESTRAINED - 20 MIN. (ITEMS 5 & 5A)
FINISH RATINGS - 25 MIN. (SEE ITEMS 3 OR 3A)
LOAD RESTRICTED FOR CANADIAN APPLICATIONS - SEE GUIDE B5/V7

Alternate Installation Placement

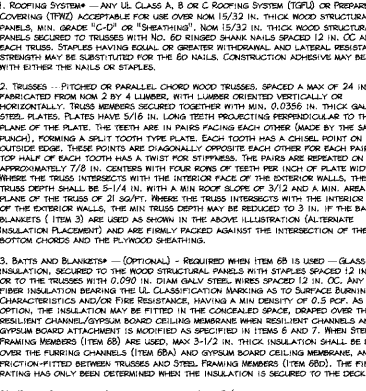

1. ROOFING SYSTEM - ANY UL CLASS A, B OR C ROOFING SYSTEM (TPO) OR PREPARED ROOF COVERING (TPO) ACCEPTABLE FOR USE OVER NOM 15/32 IN. THICK WOOD STRUCTURAL PANELING, MIN. GRADE "C" OR "SHEATHING", NOM 15/32 IN. THICK WOOD STRUCTURAL PANELING OR TRUSSES WITH NOM 60 RIBBED SHANK NAILS SPACED 12 IN. OC ALONG EACH TRUSS, STAPLES HAVING EQUAL OR GREATER WITHDRAWAL AND LATERAL RESISTANCE STRENGTH MAY BE SUBSTITUTED FOR THE 60 NAILS. CONSTRUCTION ADHESIVE MAY BE USED WITH EITHER THE NAIL OR STAPLES.

DESIGN NO. 1521
UNRESTRAINED - 20 MIN. (ITEMS 5 & 5A)
FINISH RATINGS - 25 MIN. (SEE ITEMS 3 OR 3A)
LOAD RESTRICTED FOR CANADIAN APPLICATIONS - SEE GUIDE B5/V7

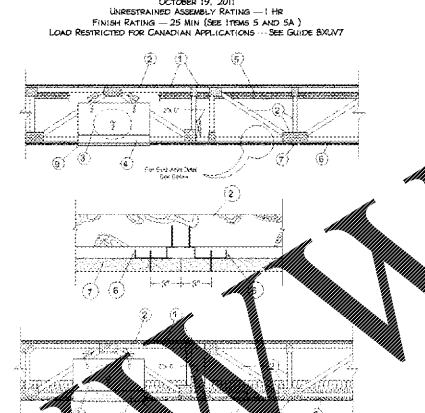

DESIGN NO. 1521
UNRESTRAINED - 20 MIN. (ITEMS 5 & 5A)
FINISH RATINGS - 25 MIN. (SEE ITEMS 3 OR 3A)
LOAD RESTRICTED FOR CANADIAN APPLICATIONS - SEE GUIDE B5/V7

Alternate Installation Placement

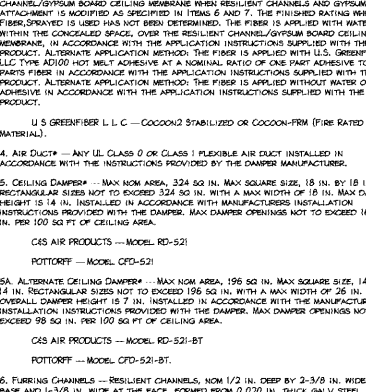

1. ROOFING SYSTEM - ANY UL CLASS A, B OR C ROOFING SYSTEM (TPO) OR PREPARED ROOF COVERING (TPO) ACCEPTABLE FOR USE OVER NOM 15/32 IN. THICK WOOD STRUCTURAL PANELING, MIN. GRADE "C" OR "SHEATHING", NOM 15/32 IN. THICK WOOD STRUCTURAL PANELING OR TRUSSES WITH NOM 60 RIBBED SHANK NAILS SPACED 12 IN. OC ALONG EACH TRUSS, STAPLES HAVING EQUAL OR GREATER WITHDRAWAL AND LATERAL RESISTANCE STRENGTH MAY BE SUBSTITUTED FOR THE 60 NAILS. CONSTRUCTION ADHESIVE MAY BE USED WITH EITHER THE NAIL OR STAPLES.

DESIGN NO. 1521
UNRESTRAINED - 20 MIN. (ITEMS 5 & 5A)
FINISH RATINGS - 25 MIN. (SEE ITEMS 3 OR 3A)
LOAD RESTRICTED FOR CANADIAN APPLICATIONS - SEE GUIDE B5/V7

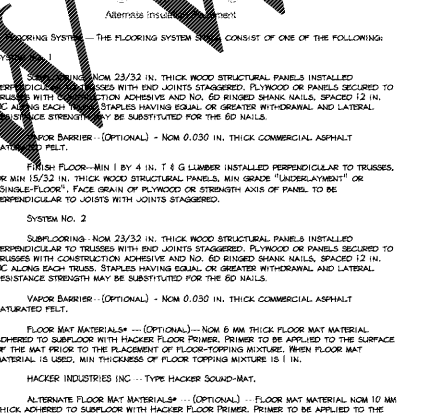

DESIGN NO. 1521
UNRESTRAINED - 20 MIN. (ITEMS 5 & 5A)
FINISH RATINGS - 25 MIN. (SEE ITEMS 3 OR 3A)
LOAD RESTRICTED FOR CANADIAN APPLICATIONS - SEE GUIDE B5/V7

Alternate Installation Placement

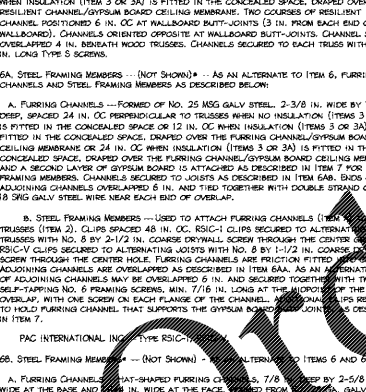

1. ROOFING SYSTEM - ANY UL CLASS A, B OR C ROOFING SYSTEM (TPO) OR PREPARED ROOF COVERING (TPO) ACCEPTABLE FOR USE OVER NOM 15/32 IN. THICK WOOD STRUCTURAL PANELING, MIN. GRADE "C" OR "SHEATHING", NOM 15/32 IN. THICK WOOD STRUCTURAL PANELING OR TRUSSES WITH NOM 60 RIBBED SHANK NAILS SPACED 12 IN. OC ALONG EACH TRUSS, STAPLES HAVING EQUAL OR GREATER WITHDRAWAL AND LATERAL RESISTANCE STRENGTH MAY BE SUBSTITUTED FOR THE 60 NAILS. CONSTRUCTION ADHESIVE MAY BE USED WITH EITHER THE NAIL OR STAPLES.

DESIGN NO. 1521
UNRESTRAINED - 20 MIN. (ITEMS 5 & 5A)
FINISH RATINGS - 25 MIN. (SEE ITEMS 3 OR 3A)
LOAD RESTRICTED FOR CANADIAN APPLICATIONS - SEE GUIDE B5/V7

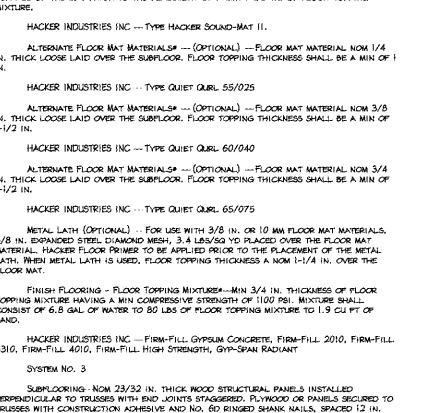

DESIGN NO. 1521
UNRESTRAINED - 20 MIN. (ITEMS 5 & 5A)
FINISH RATINGS - 25 MIN. (SEE ITEMS 3 OR 3A)
LOAD RESTRICTED FOR CANADIAN APPLICATIONS - SEE GUIDE B5/V7

Alternate Installation Placement

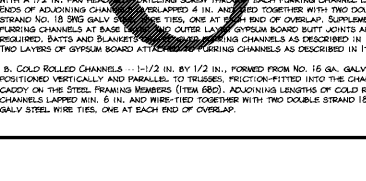

1. ROOFING SYSTEM - ANY UL CLASS A, B OR C ROOFING SYSTEM (TPO) OR PREPARED ROOF COVERING (TPO) ACCEPTABLE FOR USE OVER NOM 15/32 IN. THICK WOOD STRUCTURAL PANELING, MIN. GRADE "C" OR "SHEATHING", NOM 15/32 IN. THICK WOOD STRUCTURAL PANELING OR TRUSSES WITH NOM 60 RIBBED SHANK NAILS SPACED 12 IN. OC ALONG EACH TRUSS, STAPLES HAVING EQUAL OR GREATER WITHDRAWAL AND LATERAL RESISTANCE STRENGTH MAY BE SUBSTITUTED FOR THE 60 NAILS. CONSTRUCTION ADHESIVE MAY BE USED WITH EITHER THE NAIL OR STAPLES.

DESIGN NO. 1521
UNRESTRAINED - 20 MIN. (ITEMS 5 & 5A)
FINISH RATINGS - 25 MIN. (SEE ITEMS 3 OR 3A)
LOAD RESTRICTED FOR CANADIAN APPLICATIONS - SEE GUIDE B5/V7

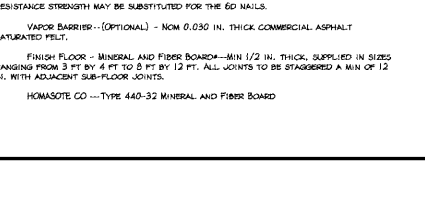

DESIGN NO. 1521
UNRESTRAINED - 20 MIN. (ITEMS 5 & 5A)
FINISH RATINGS - 25 MIN. (SEE ITEMS 3 OR 3A)
LOAD RESTRICTED FOR CANADIAN APPLICATIONS - SEE GUIDE B5/V7

TYPICAL UPPER LEVEL CEILING ASSEMBLY

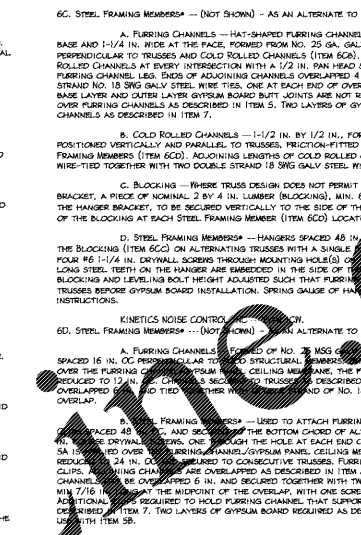

C. BLOCKING - WHERE TRUSS DESIGN DOES NOT PERMIT DIRECT, FULL CONTACT OF THE HANGER BRACKET, A PIECE OF NOMINAL 2" BY 4" IN. LUMBER (BLOCKING), MIN. 6 IN. LONG TO BE FASTENED TO THE HANGER BRACKET AND TO BE SECURED VERTICALLY TO THE SIDE OF THE TRUSS (ITEM 2) AT THE TOP AND BOTTOM OF THE BLOCKING AT EACH STEEL FRAMING MEMBER (ITEM 6B) LOCATION.

Alternate Installation Placement

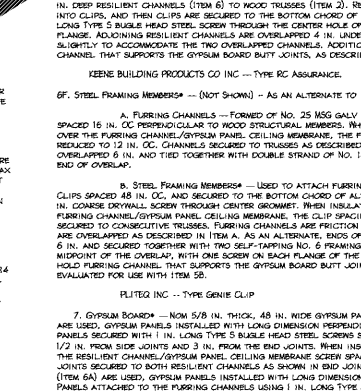

1. ROOFING SYSTEM - ANY UL CLASS A, B OR C ROOFING SYSTEM (TPO) OR PREPARED ROOF COVERING (TPO) ACCEPTABLE FOR USE OVER NOM 15/32 IN. THICK WOOD STRUCTURAL PANELING, MIN. GRADE "C" OR "SHEATHING", NOM 15/32 IN. THICK WOOD STRUCTURAL PANELING OR TRUSSES WITH NOM 60 RIBBED SHANK NAILS SPACED 12 IN. OC ALONG EACH TRUSS, STAPLES HAVING EQUAL OR GREATER WITHDRAWAL AND LATERAL RESISTANCE STRENGTH MAY BE SUBSTITUTED FOR THE 60 NAILS. CONSTRUCTION ADHESIVE MAY BE USED WITH EITHER THE NAIL OR STAPLES.

Alternate Installation Placement

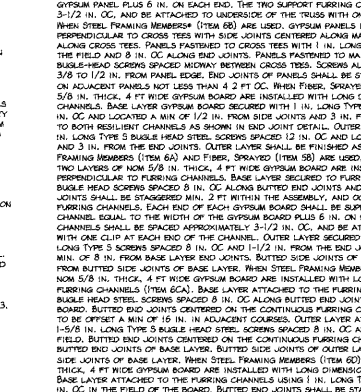

1. ROOFING SYSTEM - ANY UL CLASS A, B OR C ROOFING SYSTEM (TPO) OR PREPARED ROOF COVERING (TPO) ACCEPTABLE FOR USE OVER NOM 15/32 IN. THICK WOOD STRUCTURAL PANELING, MIN. GRADE "C" OR "SHEATHING", NOM 15/32 IN. THICK WOOD STRUCTURAL PANELING OR TRUSSES WITH NOM 60 RIBBED SHANK NAILS SPACED 12 IN. OC ALONG EACH TRUSS, STAPLES HAVING EQUAL OR GREATER WITHDRAWAL AND LATERAL RESISTANCE STRENGTH MAY BE SUBSTITUTED FOR THE 60 NAILS. CONSTRUCTION ADHESIVE MAY BE USED WITH EITHER THE NAIL OR STAPLES.

Alternate Installation Placement

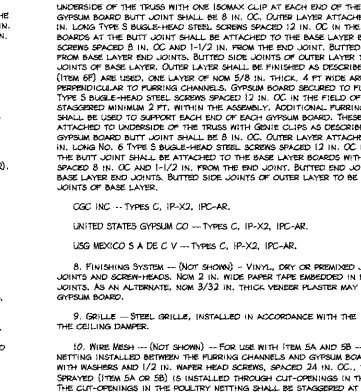

1. ROOFING SYSTEM - ANY UL CLASS A, B OR C ROOFING SYSTEM (TPO) OR PREPARED ROOF COVERING (TPO) ACCEPTABLE FOR USE OVER NOM 15/32 IN. THICK WOOD STRUCTURAL PANELING, MIN. GRADE "C" OR "SHEATHING", NOM 15/32 IN. THICK WOOD STRUCTURAL PANELING OR TRUSSES WITH NOM 60 RIBBED SHANK NAILS SPACED 12 IN. OC ALONG EACH TRUSS, STAPLES HAVING EQUAL OR GREATER WITHDRAWAL AND LATERAL RESISTANCE STRENGTH MAY BE SUBSTITUTED FOR THE 60 NAILS. CONSTRUCTION ADHESIVE MAY BE USED WITH EITHER THE NAIL OR STAPLES.

Alternate Installation Placement



1. ROOFING SYSTEM - ANY UL CLASS A, B OR C ROOFING SYSTEM (TPO) OR PREPARED ROOF COVERING (TPO) ACCEPTABLE FOR USE OVER NOM 15/32 IN. THICK WOOD STRUCTURAL PANELING, MIN. GRADE "C" OR "SHEATHING", NOM 15/32 IN. THICK WOOD STRUCTURAL PANELING OR TRUSSES WITH NOM 60 RIBBED SHANK NAILS SPACED 12 IN. OC ALONG EACH TRUSS, STAPLES HAVING EQUAL OR GREATER WITHDRAWAL AND LATERAL RESISTANCE STRENGTH MAY BE SUBSTITUTED FOR THE 60 NAILS. CONSTRUCTION ADHESIVE MAY BE USED WITH EITHER THE NAIL OR STAPLES.



ENGLISH & ASSOCIATES ARCHITECTS, INC.

3084 MERCER UNIVERSITY DRIVE, SUITE 100 ATLANTA, GEORGIA 30341 DENGUSH@ENGLISHASSOCIATESINC.COM

JOB PROGRESS: ITEM: DATE:

REVISIONS: TAG: DATE:

This drawing, as an instrument of service, is the property of the architect or architect-engineer. It is to be used only for the project and location specified. It is not to be reproduced, copied, or otherwise used in any way without the written permission of the architect or architect-engineer. All questions or requests for information should be referred to the architect or architect-engineer.

ALEXANDRIA AN APARTMENT COMMUNITY FOR Bobo Family Group HUNTSVILLE, ALABAMA

JOB NUMBER: DRAWN BY: CHECKED BY: UL SHEET

SHEET NO. A0.6