

**SITE DATA:**

470 SURFACE PARKING  
 29 EXTERNAL GARAGES (1 HANDICAP)  
 24 TOTAL STORAGE UNITS  
 258 TOTAL UNITS

1.93 SPACES PER UNIT

LEASING OFFICE WITH POOL  
 TRASH COMPACTOR AREA  
 MAIL KIOSK  
 CARWASH/MAINTENANCE BUILDING  
 5 TOTAL GARAGE BUILDINGS

**HANDICAP UNIT DATA:**

REQUIRED 2% OF TOTAL UNITS TO BE H/C ACCESSIBLE

2% OF THE H/C UNITS TO BE ADAPTED FOR THE HEARING/VISUAL IMPAIRED

UNIT A2 (1 BEDROOM) : 2 TOTAL UNITS  
 UNIT B1 (2 BEDROOM) : 3 TOTAL UNITS  
 UNIT C1 (3 BEDROOM) : 1 TOTAL UNITS

6 TOTAL HANDICAP UNITS (MARKED \*H/C\*)  
 3 TOTAL AUDIO/VISUAL UNITS (1 EACH TYPE) (MARKED \*AV\*)

**FAIR HOUSING NOTE:**  
 ALL GROUND FLOOR UNITS TO BE CONSTRUCTED PER THE FAIR HOUSING ACT.

**HANDICAP NOTES:**  
 HC INDICATES TYPE 'B' UNITS TO BE FULLY HANDICAP ACCESSIBLE PER REQUIREMENTS OF 2012 IBC CHAPTER 11 AND ICC/ANSI A117.1

INDICATES COMMON AREAS TO BE HANDICAP ACCESSIBLE AND ADAPTABLE PER ANSI REQUIREMENTS (STATE OF ALABAMA). ALL UNITS TO BE HANDICAP ADAPTABLE PER FAIR HOUSING ACT.

**SPRINKLER NOTES:**

1. ALL APARTMENTS TO BE SPRINKLERED IN ACCORDANCE WITH NFPA 13-R. PROVIDE SHOP DRAWINGS WITH REGISTERED (ALABAMA) ENGINEER'S STAMP FOR APPROVAL.

2. SPRINKLER COVERAGE SHALL INCLUDE BALCONIES, BREEZEWAYS & PATIOS WITH SIDEWALL HEADS.

**COMMERCIAL**

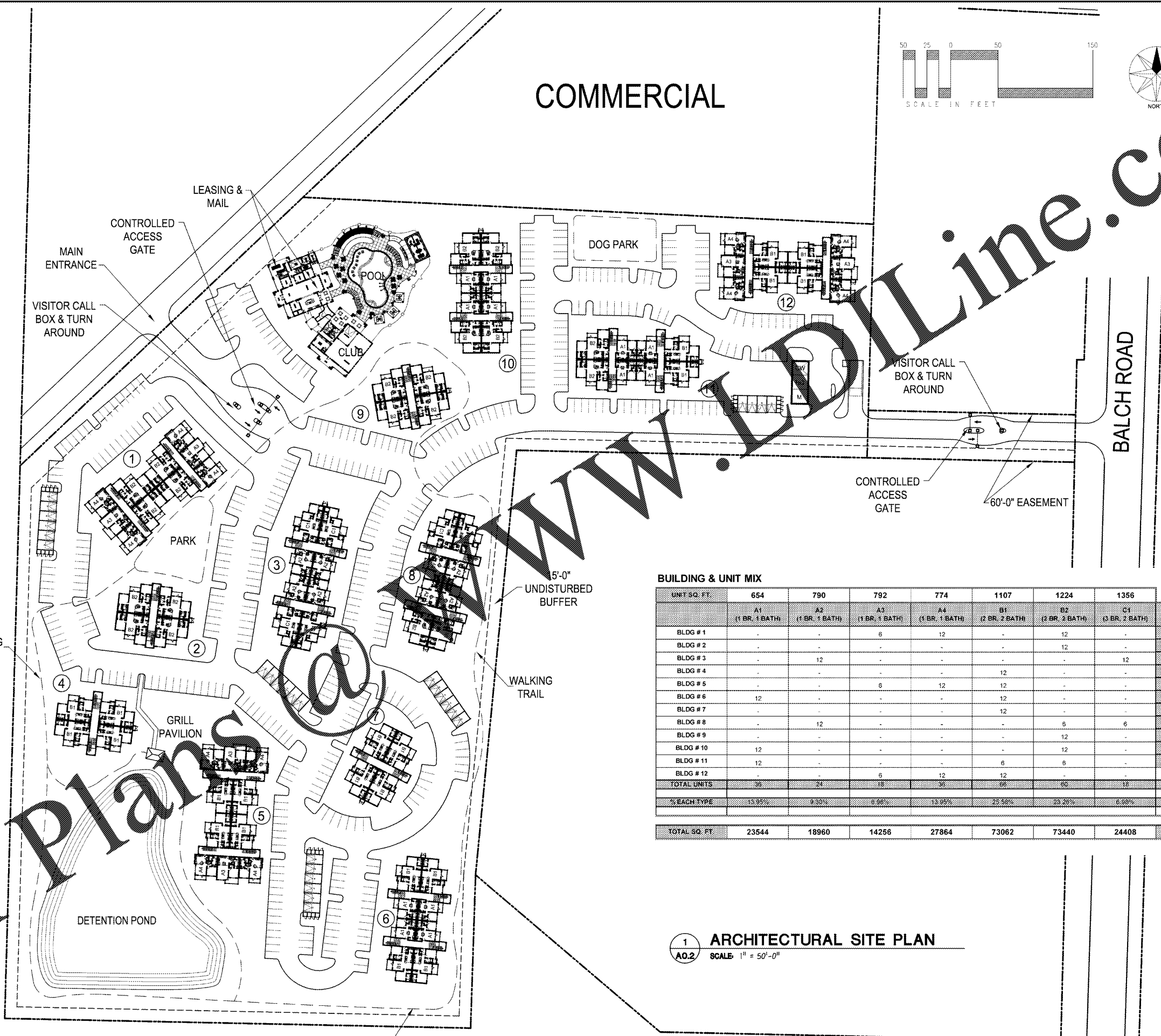
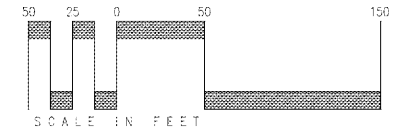

**BUILDING & UNIT MIX**

UNIT SQ. FT.	654	790	792	774	1107	1224	1356	TOTAL UNITS
	A1 (1 BR, 1 BATH)	A2 (1 BR, 1 BATH)	A3 (1 BR, 1 BATH)	A4 (1 BR, 1 BATH)	B1 (2 BR, 2 BATH)	B2 (2 BR, 2 BATH)	C1 (3 BR, 2 BATH)	
BLDG # 1	-	-	6	12	-	12	-	30
BLDG # 2	-	-	-	-	-	12	-	12
BLDG # 3	-	12	-	-	-	-	12	24
BLDG # 4	-	-	-	-	12	-	-	12
BLDG # 5	-	-	6	12	12	-	-	30
BLDG # 6	12	-	-	-	12	-	-	24
BLDG # 7	-	-	-	-	12	-	-	12
BLDG # 8	-	12	-	-	-	6	6	24
BLDG # 9	-	-	-	-	-	12	-	12
BLDG # 10	12	-	-	-	-	12	-	24
BLDG # 11	12	-	-	-	6	6	-	24
BLDG # 12	-	-	6	12	12	-	-	30
<b>TOTAL UNITS</b>	36	24	18	36	66	60	12	258
<b>% EACH TYPE</b>	13.95%	9.30%	6.98%	13.95%	25.58%	23.26%	4.57%	100%
<b>TOTAL SQ. FT.</b>	23544	18960	14256	27864	73062	73440	24408	255534

**1 ARCHITECTURAL SITE PLAN**  
 SCALE: 1" = 50'-0"

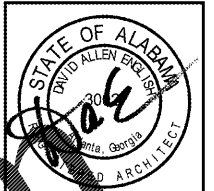

**ENGLISH & ASSOCIATES**  
 ARCHITECTS, INC.  
 3084 MERCER UNIVERSITY DRIVE, SUITE 100  
 ATLANTA, GEORGIA 30341  
 DENGGLISH@ENGLISHASSOCIATESINC.COM

**JOB PROGRESS:**  
 ITEM: DATE:

**REVISIONS:**  
 TAG: DATE:

This drawing, as an instrument of service, is and shall remain the property of the Architect of Record and shall not be published, reproduced or used in any way without the written permission of the Architect of Record. DO NOT scale this drawing. All questions to be submitted as a formal request for information to the Architect of Record.

**ALEXANDRIA**  
 AN APARTMENT COMMUNITY  
 FOR  
**Bobo Family Group**  
 HUNTSVILLE, ALABAMA

**JOB NUMBER:**  
**DRAWN BY:**  
**CHECKED BY:**  
 ARCHITECTURAL SITE PLAN  
 SHEET NO.

**A0.2**