



William J. Akers  
383 Maplewood  
St. Louis, MO 63119  
Phone (314) 772-1192  
Fax (314) 577-2500

Engineering Consultant

SCHEDULE: ROUGH-IN SYMBOLS	
#	NUMERICAL SYMBOL CORRESPONDS TO EQUIPMENT IDENTIFICATION NUMBER. SEE EQUIPMENT PLAN, SHEET A703 AND SCHEDULE SHEET A711.
Q.1	WATER CLOSET (ADA): 1" CW SUPPLY AT 28 3/4" A.F.F. AND OFFSET 4 3/4" FROM CENTER LINE OF FIXTURE
PS	LAVATORY: 1/2" CW & HW SUPPLY AT 20" A.F.F. AND EACH ONE OFFSET 4" FROM CENTER LINE OF FIXTURE
R	URINAL (ADA): 1" SUPPLY AT 40 7/8" A.F.F. AND OFFSET 4 3/4" FROM CENTER LINE OF FIXTURE
o	SUPPLY ROUGH-IN - SEE DOMESTIC WATER ROUGH-IN SCHEDULE FOR SIZE & HEIGHT
.	EQUIPMENT CONNECTION - SEE DOMESTIC WATER ROUGH-IN SCHEDULE FOR SIZE - SEE EQUIPMENT MANUAL FOR FITTING REQUIREMENTS

NOTE: REFER TO ARCHITECTURAL FLOOR PLAN FOR ALL INTERIOR PARTITION LOCATIONS.  
\* ROUGH-INS ARE BASED ON FIXTURES SHOWN IN SCHEDULE ON SHEET P103. CONTACT SUPPLIER TO VERIFY REQUIREMENTS FOR ANY SUBSTITUTION PRIOR TO INSTALLATION.

### DOMESTIC WATER ROUGH-IN SCHEDULE

MARK	ITEM NAME	ROUGH-IN	ROUGH-IN LOCATION	REMARKS
<b>140" HOT WATER &amp; SOFTENED COLD WATER</b>				
011	MOP SINK 24" X 24"	1/2" 140" HW & CW	@ 36" A.F.F.	SEE PLUMBING FIXTURE SCHEDULE FOR FAUCET MODEL NUMBER W/BFP
015	2 COMP SINK FAUCET REDUCED SIZE (SS)	FAUCET WITH 1/2" 140" HW & 1/2" CW	@ 14" A.F.F.	SEE EQUIPMENT SCHEDULE, SHEET A711, FOR FAUCET MODEL NUMBER
019	3 COMP SINK FAUCET REDUCED SIZE (SS)	FAUCET WITH 1/2" 140" HW & 1/2" CW	@ 14" A.F.F.	SEE EQUIPMENT SCHEDULE, SHEET A711, FOR FAUCET MODEL NUMBER
077B	CHEMICAL DISPENSER @ 3-COMP SINK	1/2" 140" HW & CW	@ 10" A.F.F.	INSTALL 1/2" 140" HW & CW ROUGH-INS BELOW SINK W/ VACUUM BREAKERS & BFPs. PROVIDE SHUT OFF VALVES AND TEMPERING VALVE PER ECOLAB TEMPERING VALVE-INSTALL GUIDE. INSTALL TEMPERING VALVE BELOW SINK AND PROVIDE SHUT OFF VALVE ON TEMPERED LINE. DELIVERY WATER TEMPERATURE TO DISPENSER AFTER TEMPERING VALVE SHALL BE BETWEEN 70" AND 120" F.
<b>140" HOT WATER</b>				
027A	DISHWASHER (UPRIGHT)	3/4" 140" HW	@ 72" A.F.F.	EXTEND 3/4" 140" HW FROM ROUGH-IN TO CONNECTION TO EQUIPMENT W/BFP
077A	CHEMICAL DISPENSER @ MOP SINK	1/2" 140" HW	@ 48" A.F.F.	INSTALL 1/2" 140" HW HOSEBIBB W/ VACUUM BREAKER & BFP
077C	CHEMICAL DISPENSER @ DISHWASHER	1/2" 140" HW	@ 48" A.F.F.	INSTALL 1/2" 140" HW HOSEBIBB W/ VACUUM BREAKER & BFP
<b>110" HOT WATER &amp; SOFTENED COLD WATER</b>				
019	DROP-IN SINK FAUCET (COFFEE)	1/2" HW & CW	@ 18" A.F.F.	SEE EQUIPMENT SCHEDULE, SHEET A711, FOR FAUCET MODEL NUMBER
019A	INTEGRAL SINK FAUCET FOR EQ. #403A (ESPRESSO)	1/2" HW & CW	@ 18" A.F.F.	SEE EQUIPMENT SCHEDULE, SHEET A711, FOR FAUCET MODEL NUMBER
019B	2 COMP SINK FAUCET REDUCED SIZE (SS)	1/2" HW & CW	@ 14" A.F.F.	SEE EQUIPMENT SCHEDULE, SHEET A711, FOR FAUCET MODEL NUMBER
021A	WALL MTD SS HAND SINK	1/2" HW & CW	@ 24" A.F.F.	SEE EQUIPMENT SCHEDULE, SHEET A711, FOR FAUCET MODEL NUMBER
<b>SOFTENED COLD WATER &amp; COLD WATER</b>				
025C	WATER FILTER (4 POD)	3/4" SCW	@ 96" A.F.F.	SEE DETAIL ON SHEET P301
025D	WATER SOFTENER	1-1/2" CW INLET & 1-1/2" SW OUTLET	@ 90" A.F.F.	EXTEND 1-1/2" CW FROM ROUGH-INS TO EQUIPMENT CONNECTIONS
<b>DRINKING FILTERED COLD WATER</b>				
023B	DT ICE MACHINE (W/ REMOTE CONDENSER)	1/2" DFCW	@ 110" A.F.F.	EXTEND 1/2" DFCW FROM ROUGH-IN TO EQUIPMENT CONNECTION W/BFP
023P	ICE MACHINE (AIR COOLED/ SELF CONTAINED)	1/2" DFCW	@ 72" A.F.F.	EXTEND 1/2" DFCW FROM ROUGH-INS TO EQUIPMENT CONNECTIONS W/BFP
023A	ICE MACHINE (W/ REMOTE CONDENSER)	1/2" DFCW	@ 100" A.F.F.	EXTEND 1/2" DFCW FROM ROUGH-INS TO EQUIPMENT CONNECTIONS W/BFP
042C	CARBONATOR	1/2" DFCW SHARED W/#054	@ 24" A.F.F.	EXTEND 1/2" DFCW FROM ROUGH-IN TO CONNECTION TO EQUIPMENT W/S.S. BFP
042C	CARBONATOR	1/2" DFCW SHARED W/#054B	@ 24" A.F.F.	EXTEND 1/2" DFCW FROM ROUGH-IN TO CONNECTION TO EQUIPMENT W/S.S. BFP
054	SODA/ICE DISP. (8 HD)	1/2" DFCW SHARED W/#042C	@ 24" A.F.F.	EXTEND 1/2" DFCW FROM ROUGH-IN TO CONNECTION TO EQUIPMENT W/S.S. BFP
054B	SODA/ICE DISP. (8 HD DT)	1/2" DFCW SHARED W/#042C	@ 24" A.F.F.	EXTEND 1/2" DFCW FROM ROUGH-IN TO CONNECTION TO EQUIPMENT W/S.S. BFP
<b>FILTERED COLD WATER</b>				
019C	POT FILLER FAUCET	1/2" FCW	@ 52" A.F.F.	SEE EQUIPMENT SCHEDULE, SHEET A711, FOR FAUCET MODEL NUMBER
044C	DOUBLE WIDE 6 RACK PROOFER	1/2" FCW	@ 84" A.F.F.	EXTEND 1/2" FCW FROM ROUGH-IN TO CONNECTION TO EQUIPMENT W/BFP
048P	DOUBLE RACK OVEN/GAS (BETA)	1/2" FCW	@ 105" A.F.F.	EXTEND 1/2" FCW FROM ROUGH-IN TO CONNECTION TO EQUIPMENT W/BFP
058A	TEA BREWER	1/2" FCW	@ 48" A.F.F.	EXTEND 1/2" FCW FROM ROUGH-IN TO CONNECTION TO EQUIPMENT W/BFP
058P	COFFEE MAKER	1/2" FCW	@ 48" A.F.F.	EXTEND 3/8" FCW FROM ROUGH-IN TO CONNECTION TO EQUIPMENT W/BFP
061	ESPRESSO MACHINE (AUTOMATIC) ON EQ. #403A	1/2" FCW	@ 48" A.F.F.	EXTEND 3/8" FCW FROM ROUGH-IN TO CONNECTION TO EQUIPMENT W/BFP
088A	SOUP RETHERMALIZER	1/2" FCW	@ 12" A.F.F.	EXTEND 1/2" FCW FROM ROUGH-IN TO CONNECTION TO EQUIPMENT W/BFP
088P	WIDE DECK OVEN (2 DECK) WITH STAND	3/4" FCW	16" A.F.F.	EXTEND 3/4" FCW FROM ROUGH-IN TO CONNECTIONS TO EQUIPMENT W/BFP

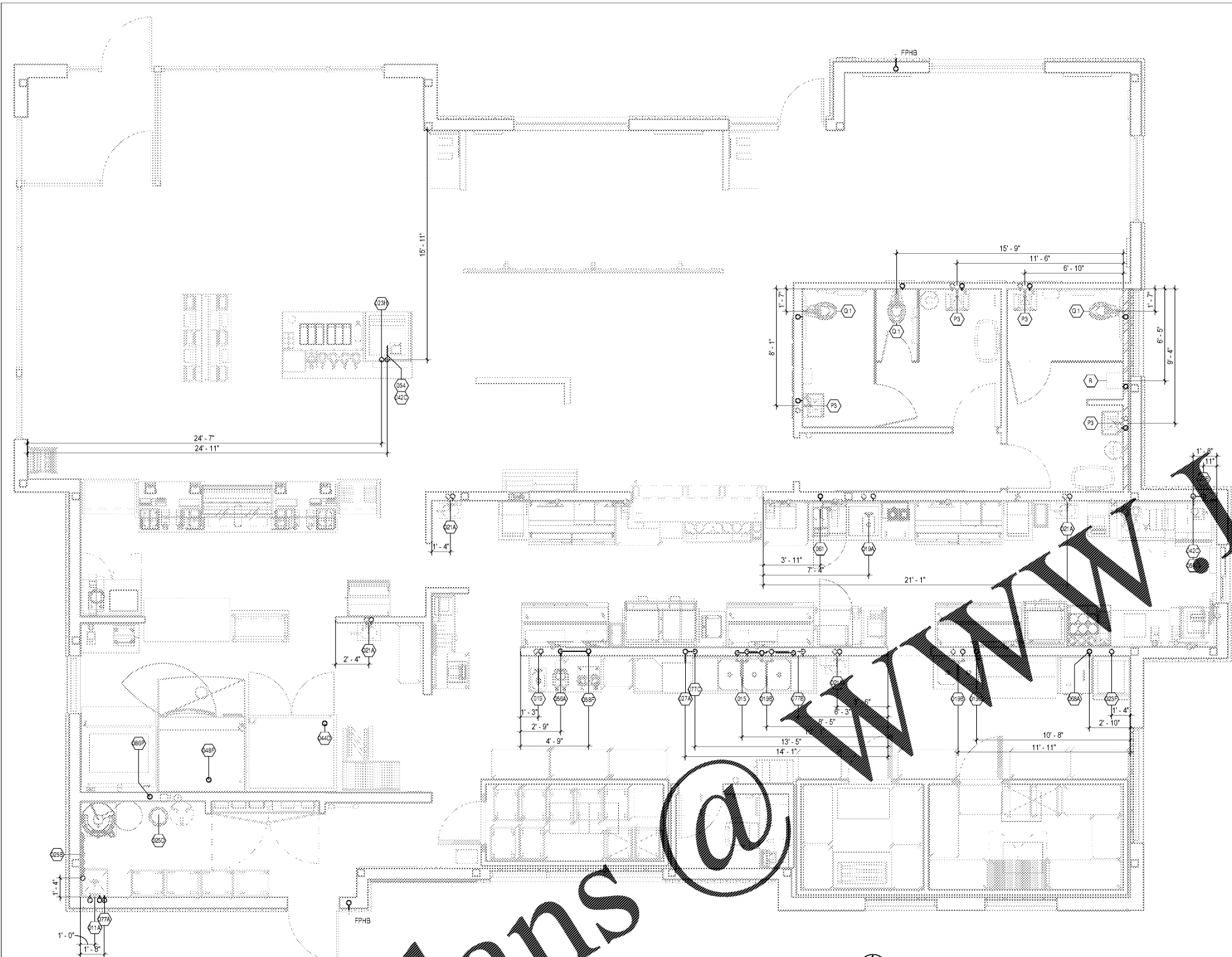

1 DOMESTIC WATER ROUGH-IN PLAN  
1/4" = 1'-0"  
NORTH

Order Plans @

ISSUE FOR REVIEW

**Bakery Cafe #6119**  
6351 MANATEE AVE. W,  
BRADENTON, FL 34209

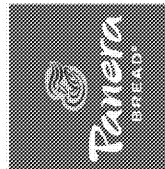

NO.	DESCRIPTION	DATE

### DOMESTIC WATER ROUGH-IN PLAN

Project Number: Sheet Number:  
449-18  
Drawn: C.L.L. Checked: G.S.H.  
Issue Date: 10/01/18  
DPM: DM: CPM:  
BS: DM: ME

# P102