

Copyright © 2018 GreenbergFarrow, Inc. This drawing is the property of the above named Professional Engineer and is not to be used for any purpose other than the specific project and site indicated herein, and cannot be reproduced in any manner without the express written permission from the Professional Engineer.

DATE	DESCRIPTION
08-31-2018	INITIAL PERMIT SET
10-25-2018	CITY COMMENTS
11-09-2018	CITY COMMENTS

IRRIGATION NOTES:

- ALL MAINLINES TO HAVE A MINIMUM OF 18" COVER. (SCHEDULE 40 PVC)
- ALL LATERAL AND SUB-MAIN PIPE TO HAVE A MINIMUM OF 12" COVER. (CLASS 200 PVC PIPE)
- NO ROCKS, BOULDERS, OR OTHER EXTRANEUS MATERIALS TO BE USED IN BACKFILLING OF TRENCH.
- ALL PIPES TO BE INSTALLED AS PER MANUFACTURERS' SPECIFICATIONS.
- ALL THREADED JOINTS TO BE COATED WITH TEFLON TAPE OR LIQUID TEFLON.
- ALL LINES TO BE THOROUGHLY FLUSHED BEFORE INSTALLATION OF SPRINKLER HEADS.
- SPRINKLER AND RELATED EQUIPMENT TO BE INSTALLED AS PER DETAILS.
- ALL ELECTRICAL JOINTS TO BE MADE USING WATERPROOF CONNECTIONS AS SHOWN ON DETAILS.
- ALL EQUIPMENT NOT SPECIFIED INTO THE LEGEND SHALL BE DETERMINED AND FURNISHED BY THE CONTRACTOR.
- NO ELECTRICAL CONNECTIONS SHALL BE MADE IN THE FIELD EXCEPT AT A VALVE CONTROL BOX OR ANOTHER VALVE BOX SPECIFICALLY FOR CONNECTIONS.
- ANY DISCREPANCY BETWEEN THIS SHEET AND OTHERS IN THIS SET MUST BE REFERRED TO THE PROJECT LANDSCAPE ARCHITECT BY THE CONTRACTOR FOR CLARIFICATION BEFORE PROCEEDING WITH THE WORK.
- ALL 24 VOLT WIRE SHALL BE #12 UF/UL FOR COMMON WIRE, AND #14 UF/UL FOR CONTROL WIRES, DIRECT BURIAL, SOLID COPPER.
- CONTRACTOR TO BE RESPONSIBLE FOR PROPER COVERAGE OF AREAS TO BE WATERED I.E. ADJUST HEADS WITH INSUFFICIENT COVERAGE DUE TO BLOCKAGE BY EXISTING OR PROPOSED SITE FEATURES.
- CONTRACTOR TO REFER TO LANDSCAPE PLAN TO KEEP SPRINKLERS EQUIPMENT AND ACCESSORY MATERIAL FROM INTERFERING WITH PROPER PLANTING, I.E. VERIFY ROOTBALL SIZE FOR PLANTING.
- CONTRACTOR SHALL PROVIDE EXPANSION COILS AT EACH WIRE CONNECTION IN VALVE BLOCK (SEE TRENCHING DETAILS).
- CONTRACTOR TO UTILIZE APPROPRIATE AUTOMATIC DRAIN DEVICE WHERE LOW HEAD DRAINAGE MAY OCCUR.
- CONTRACTOR SHALL UTILIZE VALVE I.D. TAGS ON ALL REMOTE CONTROL VALVES.
- 24 VOLT WIRE SHALL BE COLOR CODED COMMON-WHITE, CONTROL-RED.
- CONTRACTOR SHALL INSTALL MANUFACTURERS' RECOMMENDED GROUNDED EQUIPMENT FOR POWER SUPPLY AND VALVE OUTPUT WITH (2) #8 COPPER CLAD GROUND RODS.
- CONTRACTOR SHALL INSTALL GROUNDING PER MANUFACTURERS' RECOMMENDATION ON FAULT GROUND AND LIGHTNING PROTECTION.
- CONTROLLER GROUNDING MUST BE AS PER ASIC REQUIREMENT.
- ALL MATERIAL TO BE SUPPLIED BY CONTRACTOR TO OWNER:
 - TWO WRENCHES FOR DISASSEMBLING AND ADJUSTING EACH TYPE OF VALVE SUPPLIED.
 - TWO KEYS FOR EACH OF THE AUTOMATIC CONTROLLERS.
 - ONE QUICK COUPLER KEY WITH MATCHING HOSE SWIVELS.
- SYSTEM IS DIAGRAMMATIC TO IMPROVE CLARITY. ALL MAINLINE PIPING ELECTRIC VALVES AND WIRING ARE TO BE INSTALLED IN LANDSCAPE AREAS AND WITHIN PROPERTY BOUNDARIES. CONTRACTOR SHALL REFERENCE THE LANDSCAPE PLAN PRIOR TO THE INSTALLATION OF PIPING TO AVOID CONTACT WITH PLANT MATERIALS EXISTING OR NEW.
- CONTRACTOR SHALL INSTALL SPRINKLER EQUIPMENT 12" FROM FOUNDATIONS.
- PRIOR TO BID, IRRIGATION CONTRACTOR SHALL VERIFY RIGHT-OF-WAY AND BACKFLOW REQUIREMENTS. NO LATER THAN FIVE DAYS BEFORE BID SUBMITTALS CONTRACTOR SHALL NOTIFY PROJECT LANDSCAPE ARCHITECT OF ANY CHANGES FROM PLANS AND SPECIFICATIONS.
- IRRIGATION CONTRACTOR SHALL PROVIDE THE OWNER AND LANDSCAPE ARCHITECT WITH A REPRODUCIBLE CROSS MEASURED AS-BUILT DRAWING OF THE INSTALLED IRRIGATION SYSTEM IN AUTOCAD 2010 FORMAT BEFORE FINAL ACCEPTANCE.
- A 1-YEAR WARRANTY PERIOD SHALL BE PROVIDED FOR SYSTEM AFTER SUBSTANTIAL COMPLETION IS ACCEPTED. START UP AND ADJUSTING OF SYSTEM IN SPRING TIME SHALL BE INCLUDED IN THE WARRANTY.
- PRIOR TO BID, CONTRACTOR SHALL VERIFY THAT ALL MATERIALS, INSTALLATION PARAMETERS AND OPERATIONS CONFORM TO ALL APPLICABLE CODES AND ORDINANCES. NO LATER THAN FIVE DAYS BEFORE BID SUBMITTALS CONTRACTOR SHALL NOTIFY IRRIGATION CONSULTANT/DESIGNER OF ANY CHANGES REQUIRED DUE TO CURRENT CODE OR ORDINANCE DISCREPANCIES. IF CONTRACTOR DOES NOT COMPLY TO NOTIFICATION, THE CONTRACTOR SHALL BE RESPONSIBLE FOR ALL NECESSARY INSTALLATION CHANGE AND REDESIGN COSTS FOR NON-COMPLIANCE.
- UNLESS OTHERWISE NOTED, THE CONTRACTOR MUST COMPLETE 2 PRESSURE TESTS OF THE IRRIGATION SYSTEM MAINLINE (BOTH TO SHOW NO DROP IN PRESSURE DURING OPERATION OF TEST):
 - 2-HOUR PRESSURE TEST AT 1.5 TIMES THE SYSTEM STATIC PRESSURE.
 - 24-HOUR PRESSURE TEST AT THE SYSTEM STATIC PRESSURE.
- IRRIGATION INSTALLATION CONTRACTOR SHALL PROVIDE OWNER WITH A COLOR-CODED ZONES DIAGRAM PLAN, 8.5" X 11" LAMINATED SHEETS, TO IDENTIFY CONTROLLER STATION TO THE CONTROL VALVE NUMBER FOR EACH CONTROLLER. TO BE PLACED IN ADHESIVE POUCH ATTACHED INSIDE OF CONTROLLER(S).
- ALL QUANTITIES SHOWN ARE FOR REFERENCE. CONTRACTOR SHALL VERIFY QUANTITIES OF ALL REQUIRED MATERIALS AND EQUIPMENT.

IRRIGATION SCHEDULE

SYMBOL	MANUFACTURER/MODEL/DESCRIPTION
4V 6V 18V	RAIN BIRD 1806-SAM ADJ TURF SPRAY 6.0" POP-UP SPRINKLER WITH CO-MOLDED WIPER SEAL. 1/2" NPT FEMALE THREADED INLET. WITH SEAL-A-MATIC CHECK VALVE.
08HE-VAN 10HE-VAN 12HE-VAN 15HE-VAN	RAIN BIRD 1806-SAM ADJ TURF SPRAY 6.0" POP-UP SPRINKLER WITH CO-MOLDED WIPER SEAL. 1/2" NPT FEMALE THREADED INLET. WITH SEAL-A-MATIC CHECK VALVE.
1401 1402 1404 1408	RAIN BIRD 1806-SAM-1400 FLOOD FLOOD BUBBLER 6.0" POPUP WITH CHECK VALVE
■	RAIN BIRD XCZ-LF-100-PRF LOW FLOW DRIP CONTROL KIT, 1" LOW FLOW VALVE, 3/4" PRESSURE REGULATING RBY FILTER, 1/2" RPSI PRESSURE REGULATOR, .2GPM-5GPM.
●	PIPE TRANSITION POINT IN DRIP BIRD PIPE TRANSITION POINT FROM PVC LATERAL TO DRIP TUBING WITH RBY IN 6" (50MM) DRIP BOX.
■	AREA TO RECEIVE WATER FROM RAIN BIRD TV-06-12 ON-SURFACE LANDSCAPE DRILINE WITH A HEAD-DUTY 25 PSI CHECK VALVE, 0.6 GPH EMITTERS AT 1/2" DRILINE LATERALS SPACED AT 12" APART, WITH EMITTERS OFFSET FOR TRIANGULAR PATTERN. GREAT FOR ELEVATION CHANGE. SPECIFY XF INSERT FITTINGS.
●	RAIN BIRD PEB 1", 1-1/2", 2" PLASTIC INDUSTRIAL VALVES. LOW FLOW OPERATING CAPABILITY, GLOBE CONFIGURATION.
○	DRAIN VALVE
○	WATTS U009 1" REDUCED PRESSURE BACKFLOW PREVENTER
C	RAIN BIRD ESPBLXME WITH (01) ESPLXMS1/2 20 STATION COMMERCIAL CONTROLLER. MOUNTED ON A PLASTIC WALL MOUNT. WITHOUT FLOW SENSING.
RS	HUNTER MINI-CLIK RAIN SENSOR, MOUNT AS NOTED
M	WATER METER 1"
---	IRRIGATION LATERAL LINE: PVC CLASS 200 SDR 21
---	IRRIGATION MAINLINE: PVC CLASS 200 SDR 21
○	Valve Callout
○	Valve Number
○	Valve Flow
○	Valve Size

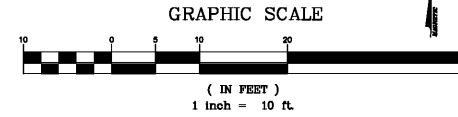
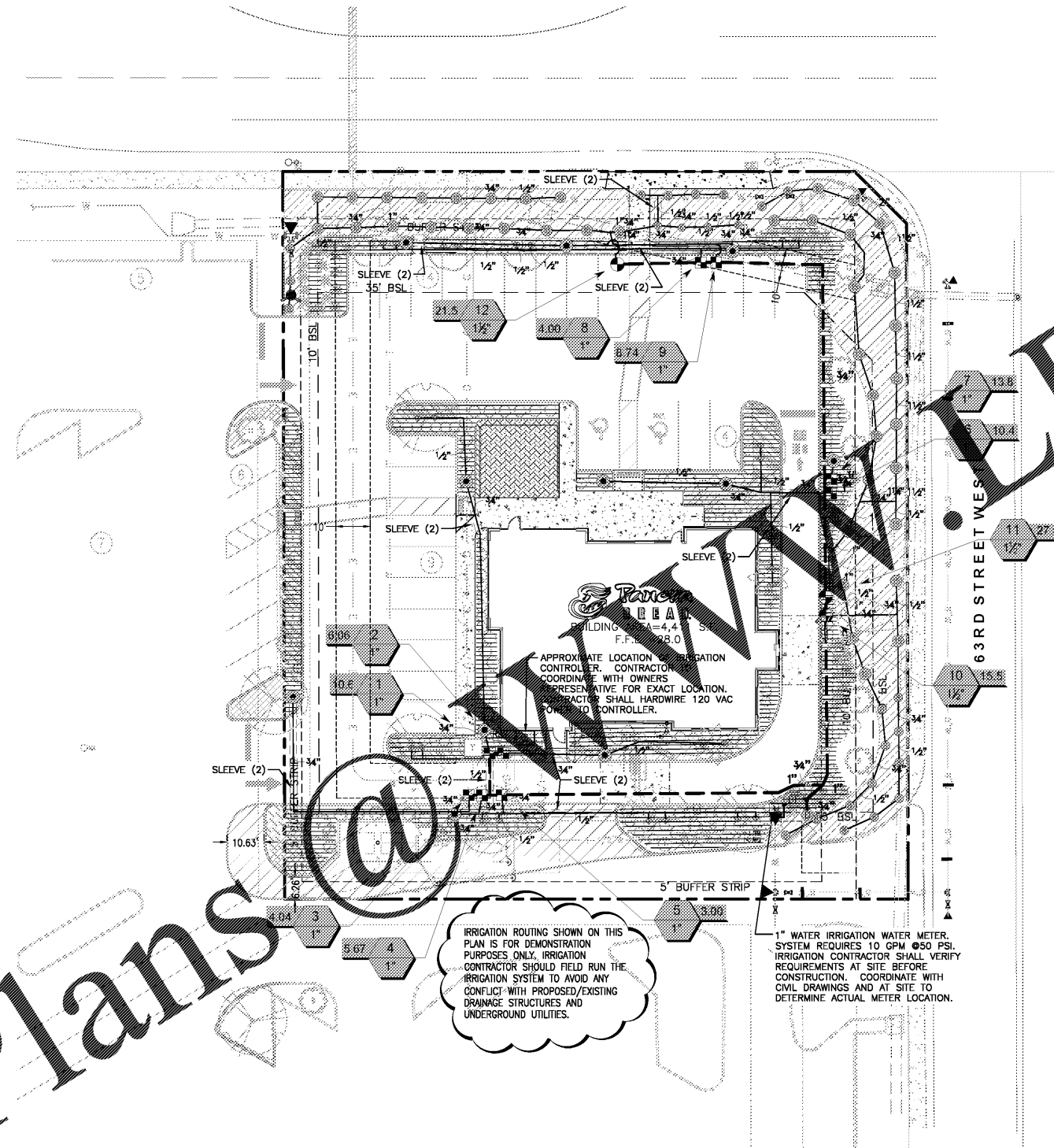

**48 HOURS BEFORE YOU DIG
CALL SUNSHINE
1-800-432-4770
IT'S THE LAW IN FLORIDA**



PROFESSIONAL IN CHARGE
JOHN NOURZAD
PROJECT MANAGER
PROJECT MANAGER
QUALITY CONTROL
CHARLES J. BEADLES
DRAWN BY
ALEX MADDOX

PROJECT
**PANERA
BREAD**

ADDRESS
**BRADENTON
FLORIDA**
6351 MANATEE
AVENUE WEST

CLIENT



PROJECT NUMBER
201807580

SHEET TITLE
IRRIGATION PLAN

SHEET NUMBER
I-1.0