

Copyright © 2018 GreenbergFarrow, Inc. This drawing is the property of the above named Professional Engineer and is not to be used for any purpose other than the specific project and site indicated herein, and cannot be reproduced in any manner without the express written permission from the Professional Engineer.

DATE	DESCRIPTION
08-31-2018	INITIAL PERMIT SET
10-25-2018	CITY COMMENTS
11-09-2018	CITY COMMENTS

**PROFESSIONAL SEAL**

**PROFESSIONAL IN CHARGE**  
JOHN NOURZAD  
**PROJECT MANAGER**  
WILLIAM LOTZ  
**QUALITY CONTROL**  
CHARLES J. BEADLES  
**DRAWN BY**  
ALEX MADDOX

**PROJECT**  
**PANERA BREAD**

**ADDRESS**  
**BRADENTON FLORIDA**  
6351 MANATEE AVENUE WEST

**CLIENT**



**PROJECT NUMBER**  
201807580

**SHEET TITLE**

**LANDSCAPE PLAN**

**SHEET NUMBER**

**L-1.0**

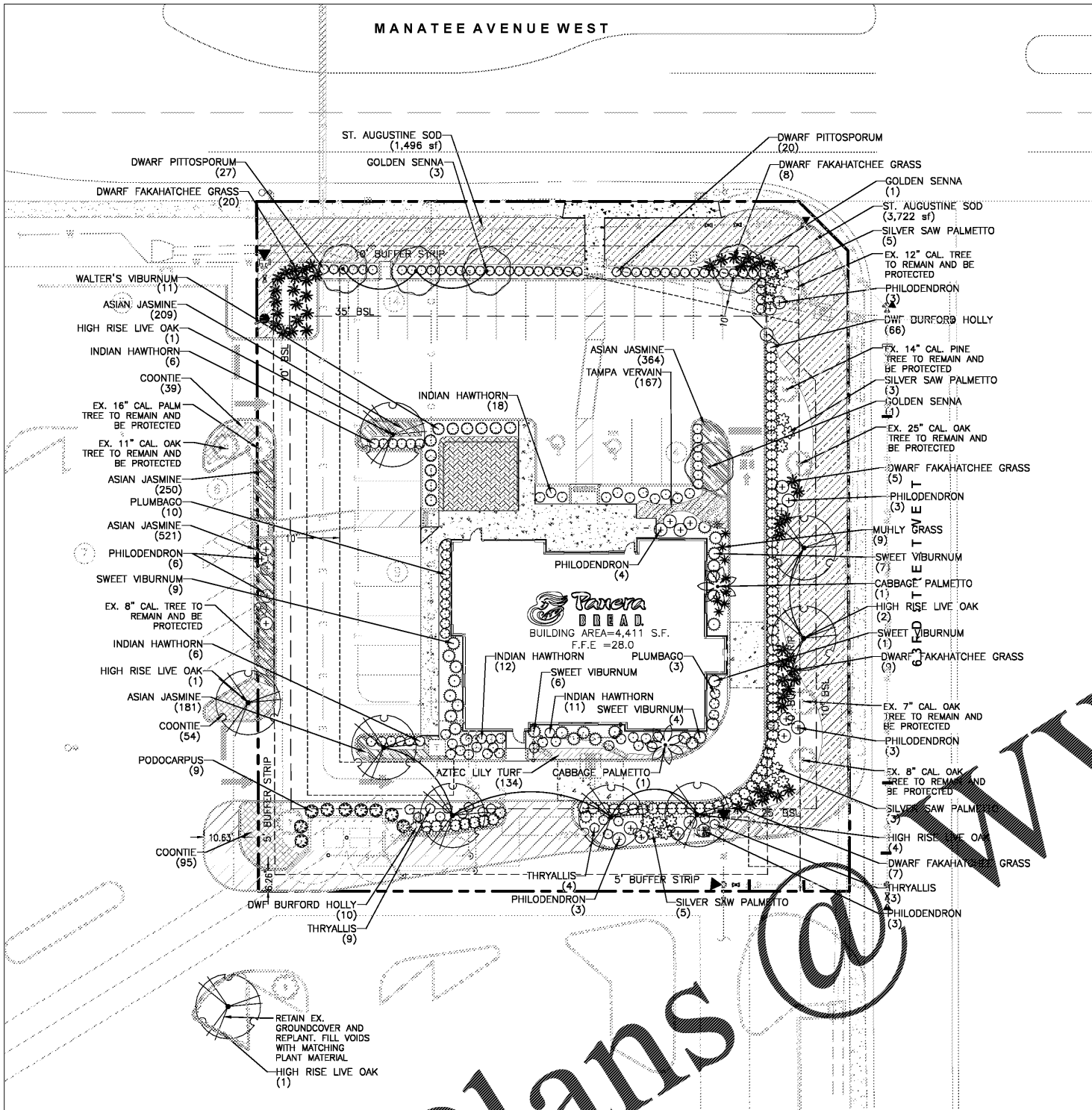

**PLANT SCHEDULE**

TREES	QTY	BOTANICAL NAME / COMMON NAME	CONT	CAL	SIZE	REMARKS
	9	QUERCUS VIRGINIANA 'HIGH RISE' / HIGH RISE LIVE OAK	B & B	3" CAL	12'-15' HT	FULL STRAIGHT TRUNK, MATCHING
	2	SABAL PALMETTO / CABBAGE PALMETTO	B & B		15' OA	STRAIGHT TRUNK
	5	SENNA SURATTENSIS / GOLDEN SENNA	B & B		2-2.5"	
SHRUBS	QTY	BOTANICAL NAME / COMMON NAME	CONT	HEIGHT	REMARKS	
	76	ILEX CORNUTA 'BURFORDII NANA' / DWF BURFORD HOLLY	3 GAL	30" MIN.	FULL TO GROUND	
	9	MUHLENBERGIA CAPILLARIS 'REGAL MIST' TM / MUHLY GRASS	3 GAL	24" MIN.	FULL WELL ROOTED IN POT	
	25	PHILODENDRON X 'XANADU' / PHILODENDRON	5 GAL		FULL WELL ROOTED	
	45	PITOSPORUM TOBIRA 'WHEELER'S DWARF' / DWARF PITOSPORUM	5 GAL			
	13	PLUMBAGO AURICULATA 'IMPERIAL BLUE' / PLUMBAGO	5 GAL	24" MIN.	FULL WELL ROOTED	
	9	PODOCARPUS MACROPHYLLUS / PODOCARPUS	3 GAL	6" MIN.	FULL TO GROUND, BUSHY DENSE	
	53	RHAPHIOLEPIS INDICA 'GULE GREEN' / INDIAN HAWTHORN	5 GAL		FULL	
	16	SERENOA REPENS 'CINEREA' / SILVER SAW PALMETTO	5 GAL		FULL	
	16	THRYSALLIS LAUCA / THRYSALLIS	5 GAL		FULL	
	49	TRIPSACUM DASYLOIDES NANA / DWARF FAKAHATCHEE GRASS	3 GAL			
	27	VIBURNUM AWABUTAI / SWEET VIBURNUM	7 GAL	36" MIN.	FULL MATCHING	
	11	VIBURNUM OBOVATUM / WALTER'S VIBURNUM	7 GAL		FULL	
SHRUBS IN POTS	QTY	BOTANICAL NAME / COMMON NAME	CONT	HEIGHT	REMARKS	
	31	ZAMIA PUMILA / COONTIE	3 GAL		FULL	
GROUND COVERS	QTY	BOTANICAL NAME / COMMON NAME	CONT	REMARKS		
	167	GLANDULARIA TAMPENSIS / TAMPA VERVAIN	4" POT		FULL, DENSE PLANT	
	134	LIRIOPE MUSCARI 'AZTEC' / AZTEC LILY TURF	4" POT			
	1,525	TRACHELOSPERMUM ASIATICUM / ASIAN JASMINE	4" POT			
SOD	QTY	BOTANICAL NAME / COMMON NAME	CONT	REMARKS		
	5,218 SF	STENOTAPHRUM SECUNDATUM 'FLORITAM' / ST. AUGUSTINE SOD	4" POT		CERTIFIED PURE, WEED FREE	

WWW.DIline.com

Landscaping			
<b>Foundation Planting Area North</b>			
	Required	Provided	
100 SF per 1,500 SF of building area	298 sf	1,600 sf	
<b>Interior Parking Landscape Area</b>			
10 SF of landscape area per parking space	130 sf	500 sf	
<b>Interior Parking Landscape Area</b>			
each 500 square feet of vehicular use area (non parking) and one tree for 9,305 SF VUA		457 sf	
<b>Required Tree Planting</b>			
Landscape Buffer	Required	Provided	
North (Front) tree per 50 LF of buffer	4	4	
South (Interior) tree per 50 LF of buffer	3	3	
East (Other) tree per 50 LF of buffer	4	7	5 Existing + 2 Proposed
West (Interior) tree per 75 LF of buffer	3	4	3 Existing + 1 Proposed
<b>Interior Parking Lot Trees</b>			
1 tree for each 400 SF of required interior landscaping	1	4	2 Trees + 2 Palms
<b>Total Number of Trees</b>	15	22	14 Trees, 2 Palms & 8 Existing (Palms = 9%)

TREES REMOVAL AND REPLACEMENT							
Protected species to be removed	Diameter	Acceptable Species	replacement ratio	min Dia	Removed	req.	Replacement
Live / Laurel Oak	4"-7.99"	Live Oak	2:1	2"	1		2
Significant Live / Laurel Oak	8"-30"	Live Oak	4:1	2"	0		0
Grand Tree	30.01" +	Live / Laurel Oak or Sim	10:1	2"	0		0
Significant Stands Live / Laurel Oak		Live Oak or Similar Nati	Per PCD				0
All other Significant Trees	8"-30"	Native	2:1	2"	1		2
All other non-Significant Trees	4"-8"	Native	1:1	2"	0		0
						Trees Req.	4

NOTE: 4 ADDITIONAL HIGH RIDE OAKS ADDED TO PLAN AS REPLACEMENT TREES

48 HOURS BEFORE YOU DIG  
CALL SUNSHINE  
1-800-432-4770  
IT'S THE LAW IN FLORIDA

GRAPHIC SCALE  
1 inch = 10 ft