

NOTICE:
This drawing is the property of the above named Professional Engineer and is not to be used for any purpose other than the specific project and site indicated herein, and cannot be reproduced or transmitted in any form or by any means without the express written permission from the Professional Engineer.

DATE	DESCRIPTION
05-31-2018	INITIAL PERMIT SET
10-25-2018	CITY COMMENTS
11-05-2018	CITY COMMENTS

PROJECT INFORMATION

PROPERTY ADDRESS: 6315 MANATEE AVENUE WEST, BRADENTON, FL
 SITE AREA: 0.865 AC
 DISTURBED AREA: 0.65 AC
 PROPOSED LANDSCAPED AREA: 0.219 AC
 PROPOSED IMPERVIOUS AREA: 0.646 AC
 EXISTING ZONING: SCC (COMMERCIAL CORRIDOR)
 PROPOSED BUILDING AREA: 4,411 SF
 EXISTING USE: BANK
 PROPOSED USE: RESTAURANT
 SEATS PROVIDED: 136 SEATS (96 INTERIOR, 40 EXTERIOR)
 PARKING INFORMATION: PARKING REQUIRED: 15P PER 3 SEATS (45 SPACES)
 PARKING PROVIDED: 45 SPACES (27 ONSITE, 18 OFFSITE)
 BICYCLE SPACE PROVIDED: 2 SPACES

LEGEND

- PROPERTY LINE
- EASEMENT LINE
- BUFFER/SETBACK LINE
- PROPOSED 6 INCH BARRIER CURB
- PARKING SPACE COUNT
- SIGN
- SITE LIGHT POLE
- PROPOSED CONCRETE SIDEWALK
4" PORTLAND CEMENT CONCRETE
- PROPOSED HEAVY DUTY CONCRETE PAVEMENT
(REFERENCE GEOTECH REPORT BY NOVA DATED SEPTEMBER 21, 2018)
28 DAY MINIMUM COMPRESSIVE STRENGTH 4000 PSI
6" MINIMUM CONCRETE PAVEMENT THICKNESS
4" COMPACTED GAB
- PROPOSED STANDARD DUTY ASPHALT PAVEMENT
(REFERENCE GEOTECH REPORT BY NOVA DATED SEPTEMBER 21, 2018)
2" MIN ASPHALTIC CONCRETE (SP-12.5 AND/OR FC 9.5)
LIME ROCK CRUSHED CONCRETE BASE
12" STABILIZED SUB-BASE TYPE "B"
- PROPOSED HEAVY DUTY ASPHALT PAVEMENT
(REFERENCE GEOTECH REPORT BY NOVA DATED SEPTEMBER 21, 2018)
3" MIN ASPHALTIC CONCRETE (SP-12.5 AND/OR FC-9.5)
8" LIME ROCK CRUSHED CONCRETE BASE
12" STABILIZED SUB-BASE TYPE "B"
- RESURFACE & PATCH EXISTING PAVEMENT
(SEE CITY DETAIL SR-1 & SR-6 ON SHEET C-7.2)

SITE KEY NOTES

- S1 6" BARRIER CURB TYPE "D" (SEE FDOT DETAIL SHEET C-7.1)
- S5 HEAVY DUTY CONCRETE PAVING
- S6 STANDARD DUTY ASPHALT PAVING
- S7 HEAVY DUTY ASPHALT PAVING
- S8 CONCRETE SIDEWALK (SEE DETAIL ON SHEET C-7.1).
- S10 SIDEWALK RAMP @ 8.33% MAX. DETECTABLE WARNING DOMES (SEE DETAILS)
- S11 SIDEWALK RAMP
- S14 MONUMENT SIGN (PER ARCH. PLANS)
- S15 DUMPSTER ENCLOSURE (PER ARCH. PLANS)
- S16 ADA ACCESSIBLE PARKING SPACE STRIPING & SYMBOL OF ACCESSIBILITY (SEE CITY DETAIL SHEET C-7.1)
- S17 ACCESSIBLE PARKING SIGN (SEE CITY DETAIL SHEET C-7.1)
- S18 VAN ACCESSIBLE PARKING SIGN (SEE CITY DETAIL SHEET C-7.1)
- S19 "STOP" SIGN
- S20 24" STOP BAR (WHITE)
- S21 DIRECTIONAL TRAFFIC ARROW
- S22 4" PARKING STRIPE (WHITE)
- S23 10" WIDE CONCRETE CURB AT DRIVE-THRU WINDOW WITH 10" TAPER TO 6" WIDE CONCRETE CURB (SEE ARCHITECTURAL PLANS FOR DETAIL).
- S24 4" TRAFFIC LANE STRIPE (WHITE).
- S25 4" WIDE PAINTED STRIPES, 2" ON CENTER @ 45° WHITE).
- S26 6" PEDESTRIAN / HANDICAP CROSSWALK STRIPING (WHITE).
- S30 6" DIA. CONCRETE FILLED STEEL BOLLARDS (SEE ARCH. PLAN FOR DETAIL).
- S32 LANDSCAPE AREA (PER LANDSCAPE PLAN)
- S60 DIRECTIONAL SIGN WITH ARROW (SEE ARCH. PLANS FOR DETAIL)
- S61 DIRECTIONAL DRIVE THRU PAVEMENT MARKING.
- S62 DRIVE THRU CLEARANCE BAR (SEE ARCH. PLANS FOR DETAIL).
- S63 DRIVE THRU PREVIEW BOARD (SEE ARCH. PLANS FOR DETAIL).
- S64 "DRIVE THRU CANOPY & SPEAKER (SEE ARCH. PLANS FOR DETAILS)
- S65 DRIVE THRU MENU BOARD (SEE ARCH PLANS FOR DETAILS)
- S66 THANK YOU /DO NOT ENTER SIGN (SEE ARCH. PLANS FOR DETAILS)
- S68 DRIVE THRU "PULL AHEAD" PARKING SIGN (SEE ARCHITECTURAL PLAN FOR DETAIL).
- S69 RAPID PICK UP SIGN (SEE ARCHITECTURAL PLAN FOR DETAIL)
- S70 OUTDOOR PATIO AREA WITH RAILS (SEE ARCHITECTURAL PLAN FOR DETAIL).
- S71 LIMITS OF SAW CUT LINE/PAVEMENT REMOVAL.
- S79 TIE TO EXISTING
- S80 BICYCLE PARKING RACK (2 SPACES).
- S81 CONCRETE FILLME
- S82 TAPER CURB TO MATCH EXISTING PAVEMENT.
- S83 TAPER CURB FROM 6" TO 0" OVER 2FT.
- S84 TYPICAL ROAD SECTION (PER CITY OF BRADENTON).

SITE NOTES:

1. CONTRACTOR MUST SECURE ALL NECESSARY PERMITS PRIOR TO STARTING WORK.
2. IF THE CONTRACTOR, IN THE COURSE OF THE WORK, FINDS ANY DISCREPANCIES BETWEEN THE PLANS AND THE PHYSICAL CONDITIONS OF THE LOCALITY, OR ANY ERRORS OR OMISSIONS IN THE PLANS OR IN THE LAYOUT AS GIVEN BY THE ENGINEER, IT SHALL BE HIS DUTY TO IMMEDIATELY INFORM THE ENGINEER, IN WRITING, AND THE ENGINEER WILL PROMPTLY VERIFY THE SAME. ANY WORK DONE AFTER SUCH A DISCOVERY, UNTIL AUTHORIZED, WILL BE AT THE CONTRACTOR'S RISK.
3. CONTRACTOR SHALL BE RESPONSIBLE FOR VERIFICATION OF ALL SETBACKS, EASEMENTS, AND DIMENSIONS SHOWN HEREON BEFORE BEGINNING CONSTRUCTION.
4. ALL CONSTRUCTION MATERIALS AND WORKMANSHIP SHALL BE IN ACCORDANCE TO THE STATE AND LOCAL GOVERNMENT AGENCY LATEST CONSTRUCTION SPECIFICATIONS AND DETAILS.
5. ALL HANDICAP SITE FEATURES SHALL BE CONSTRUCTED TO MEET ALL FEDERAL, STATE AND LOCAL CODE.
6. NOTIFY THE CITY INSPECTOR TWENTY-FOUR (24) HOURS BEFORE BEGINNING EACH PHASE OF CONSTRUCTION.
7. THE CONTRACTOR SHALL CAREFULLY PRESERVE BENCHMARKS, REFERENCE POINTS, AND STAKES.
8. ARCHITECTURAL PLANS ARE TO BE USED FOR BUILDING STAKE OUT.
9. ALL DIMENSIONS ARE FROM FACE OF BUILDING, CURB, AND WALL UNLESS OTHERWISE SPECIFIED ON PLANS.
10. CONTRACTOR SHALL MAINTAIN THE SITE IN A MANNER SO THAT WORKMEN AND PUBLIC SHALL BE PROTECTED FROM INJURY, AND ADJOINING PROPERTY PROTECTED FROM DAMAGE.
11. CONTRACTOR IS RESPONSIBLE FOR DAMAGE TO ANY EXISTING ITEM AND/OR MATERIAL INSIDE OR OUTSIDE CONTRACT LIMITS DUE TO CONSTRUCTION OPERATION.]
12. ALL STREET SURFACES, DRIVEWAYS, CULVERTS, CURB AND GUTTERS, ROADSIDE DRAINAGE DITCHES AND OTHER STRUCTURES THAT ARE DISTURBED OR DAMAGED IN ANY MANNER AS A RESULT OF CONSTRUCTION SHALL BE REPLACED OR REPAIRED IN ACCORDANCE WITH THE SPECIFICATIONS.
13. ALL ROAD WORK SHALL BE PERFORMED IN ACCORDANCE WITH THE STATE AND LOCAL GOVERNMENT AGENCY SPECIFICATIONS.
14. STANDARD/HEAVY DUTY PAVEMENT AND CONCRETE SECTIONS SHALL FOLLOW THE RECOMMENDATIONS OF THE GEOTECHNICAL REPORT PREPARED BY NOVA DATED SEPTEMBER 21, 2018.
15. ALL CURB RADII SHALL BE 3' UNLESS OTHERWISE NOTED ON THE PLANS.
16. CONTRACTOR SHALL REFER TO APPROVED ARCHITECTURAL SITE SIGNAGE PLANS FOR DETAILS AND LOCATIONS.
17. CONTRACTOR SHALL REFER TO APPROVED PHOTOMETRIC PLANS FOR LOCATIONS OF LIGHT POLES.
18. ALL LIGHT POLE BASE SHALL BE LOCATED A MINIMUM OF 2'-6" BEHIND FACE OF CURB UNLESS OTHERWISE NOTED ON PLAN.

PROFESSIONAL SEAL

PROFESSIONAL IN CHARGE
JOHN NOURZAD
PROJECT MANAGER
WILLIAM LOTZ
QUALITY CONTROL
CHARLES J. BEADLES
DRAWN BY
TREVOR ANDREY

PROJECT
PANERA BREAD

ADDRESS
BRADENTON FLORIDA
6315 MANATEE AVENUE WEST

CLIENT



PROJECT NUMBER
201807580

SHEET TITLE
SITE PLAN

SHEET NUMBER
C-3.0

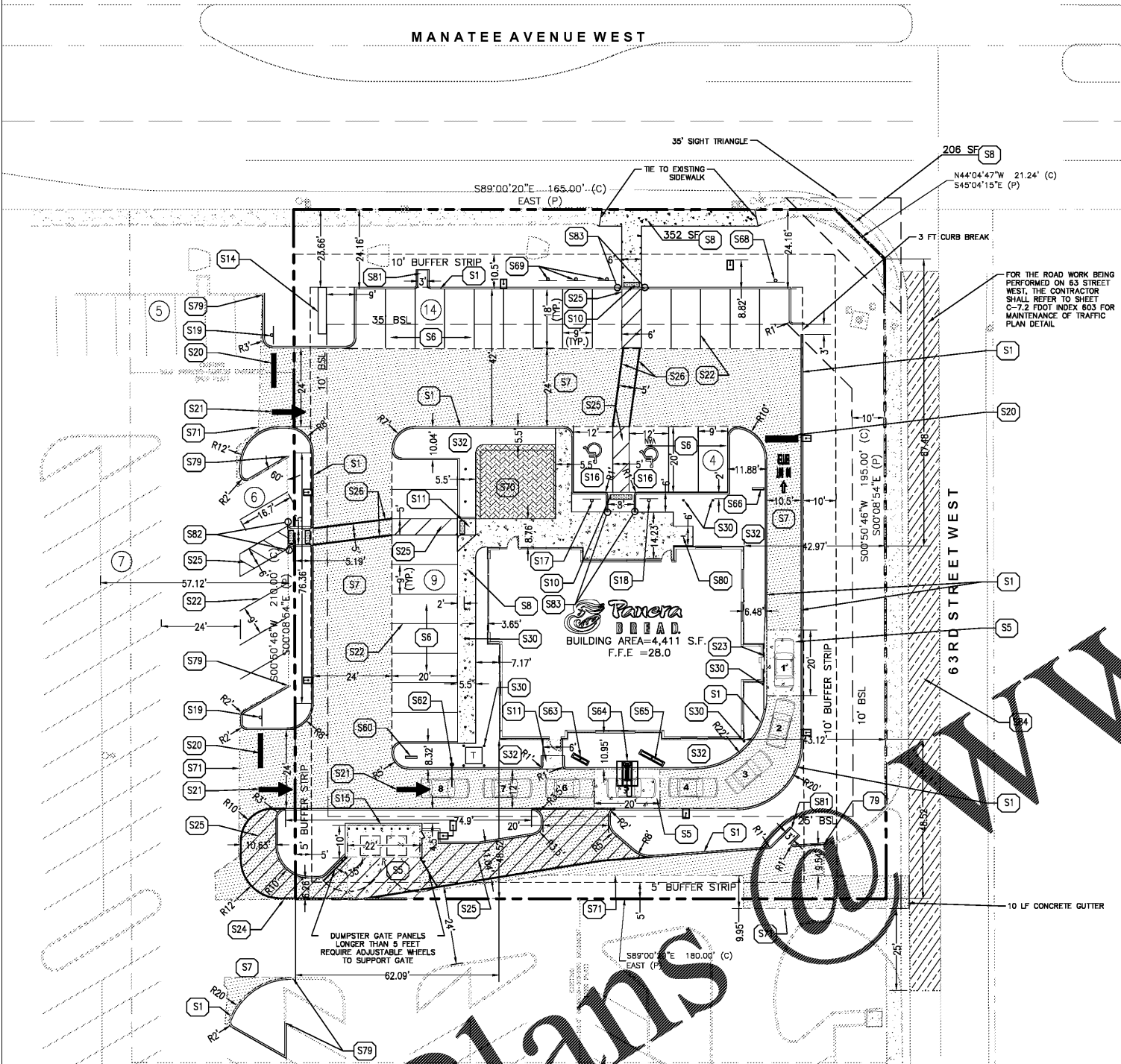

Order Plans

48 HOURS BEFORE YOU DIG
CALL SUNSHINE
1-800-432-4770
IT'S THE LAW IN FLORIDA

